

STATE CORPORATION COMMISSION OF KANSAS
OIL & GAS CONSERVATION DIVISION

WELL COMPLETION OR RECOMPLETION FORM
ACO-1 WELL HISTORY

DESCRIPTION OF WELL AND LEASE

Operator: License # 5418
Name Allen Drilling Company
Address Box 1389
Great Bend, KS 67530
City/State/Zip

(Dry Hole)
Purchaser

Operator Contact Person .. Doug Hoisington
Phone 316-793-5681

Contractor: License # 5418
Name Allen Drilling Company

Wellsite Geologist.. Randy Lilak
Phone 316-793-5681

Designate Type of Completion
 New Well Re-Entry Workover
 Oil SWD Temp Abd
 Gas Inj Delayed Comp.
 Dry Other (Core, Water Supply etc.)

If OWWO: old well info as follows:
Operator
Well Name
Comp. Date Old Total Depth

WELL HISTORY

Drilling Method:
 Mud Rotary Air Rotary Cable
12-19-84 12-31-84 12-31-84
Spud Date Date Reached TD Completion Date
3940
Total Depth PBDT

Amount of Surface Pipe Set and Cemented at 1010 feet
Multiple Stage Cementing Collar Used? Yes No
If yes, show depth set feet
If alternate 2 completion, cement circulated from feet depth to w/ SX cmt

API NO. 15-145-21-174-0000

County Pawnee

S/2 NE SW Sec 28 Twp 21 Rge 16 East West

1650 Ft North from Southeast Corner of Section
3300 Ft West from Southeast Corner of Section
(Note: Locate well in section plat below)

Lease Name Hewson Well # 1-28

Field Name Larned Ext.

Producing Formation D & A

Elevation: Ground 2023 KB 2028

Section Plat

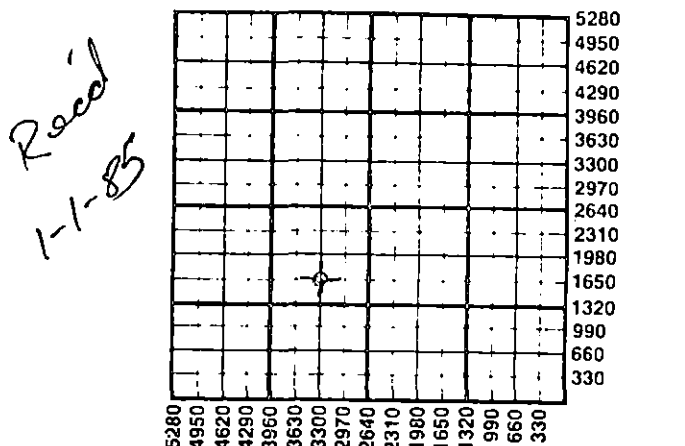

WATER SUPPLY INFORMATION

Disposition of Produced Water: NA Disposal
Docket # Repressuring

Questions on this portion of the ACO-1 call:

Water Resources Board (913) 296-3717

Source of Water:
Division of Water Resources Permit # T84-1005

Groundwater 1750 Ft North from Southeast Corner
(~~WELL~~) DRY 3400 Ft West from Southeast Corner of
HOLE Sec 28 Twp 21 Rge 16 East West

Surface Water Ft North from Southeast Corner
(Stream, pond etc) Ft West from Southeast Corner
Sec Twp Rge East West

Other (explain) Purchased f/ City of Larned
(purchased from city, R.W.D. #)

INSTRUCTIONS: This form shall be completed in duplicate and filed with the Kansas Corporation Commission, 200 Colorado Derby Building, Wichita, Kansas 67202, within 90 days after completion or recompletion of any well. Rule 82-3-130 and 82-3-107 apply. Information on side two of this form will be held confidential for a period of 12 months if requested in writing and submitted with the form. See rule 82-3-107 for confidentiality in excess of 12 months. One copy of all wireline logs and drillers time log shall be attached with this form. Submit CP-4 form with all plugged wells. Submit CP-111 form with all temporarily abandoned wells.

All requirements of the statutes, rules and regulations promulgated to regulate the oil and gas industry have been fully complied with and the statements herein are complete and correct to the best of my knowledge.

Signature [Signature]

Title Vice-President Date 2/28/85

Subscribed and sworn to before me this 28 day of Feb. 1985

Notary Public [Signature]

Date Commission Expires



K.C.C. OFFICE USE ONLY
F Letter of Confidentiality Attached
C Wireline Log Received
C Drillers Timelog Received
Distribution
 KCC SWD/Rep NGPA
 KGS Plug Other
(Specify)

Sec 28 Twp 21 Rge 16

SIDE TWO

Operator Name Allen Drilling Company Lease Name Hewson Well # 1-28

Sec. 28 Twp. 21 Rge. 16 East West County Pawnee

WELL LOG

INSTRUCTIONS: Show important tops and base of formations penetrated. Detail all cores. Report all drill stem tests giving interval tested, time tool open and closed, flowing and shut-in pressures, whether shut-in pressure reached static level, hydrostatic pressures, bottom hole temperature, fluid recovery, and flow rates if gas to surface during test. Attach extra sheet if more space is needed. Attach copy of log.

Drill Stem Tests Taken Yes No
 Samples Sent to Geological Survey Yes No
 Cores Taken Yes No

Formation Description
 Log Sample

DST #1 - 3870-78 Arbuckle 15:15:30:45
 Rec: 120' gassy oil
 330' gas cut water
 SIP: Tool plugged/1263
 FP: Tool plugged/ Tool Plugged
 HP: 1920/1920
 Temp: 119°

Name	Top	Bottom
Base Anhydrite	1022	
Tarkio	2841	
Howard	3048	
Topeka	3125	
Heebner	3407	
Toronto	3427	
Lansing-KC GP	3516	
Base KC	3758	
Conglomerate	3794	
Viola	3802	
Simpson	3810	
Arbuckle	3854	
RTD	3940	

Tool plugged on initial flow,
 Flushed tool on second opening, gas to
 surface in 5 min., gauge 1,036,000 in
 7 min - 1,348,000 in 20 - 1,198,000
 in 30 min and spray mud.

DST #2 - 3892-3899 15:45:30:45
 Rec: 2,000' salt water gas cut
 SIP: 1260/1260
 FP: 176-505/614-857
 HP: 2050/2060

CASING RECORD <input checked="" type="checkbox"/> New <input type="checkbox"/> Used Report all strings set-conductor, surface, intermediate, production, etc.							
Purpose of String	Size Hole Drilled	Size Casing Set (in O.D.)	Weight Lbs/Ft.	Setting Depth	Type of Cement	#Sacks Used	Type and Percent Additives
Surface	12-1/4	8-5/8	23#	1010	HLC 50/50 poz	250 200	3% CC
PERFORATION RECORD				Acid, Fracture, Shot, Cement Squeeze Record			
Shots Per Foot	Specify Footage of Each Interval Perforated			(Amount and Kind of Material Used)		Depth	
TUBING RECORD				Liner Run <input type="checkbox"/> Yes <input type="checkbox"/> No			
Date of First Production		Producing Method					
		<input type="checkbox"/> Flowing <input type="checkbox"/> Pumping <input type="checkbox"/> Gas Lift <input type="checkbox"/> Other (explain).....					
Estimated Production Per 24 Hours	Oil	Gas	Water	Gas-Oil Ratio		Gravity	
	Bbls	MCF	Bbls	CFPB			

METHOD OF COMPLETION

Production Interval

Disposition of gas: Vented Sold Used on Lease

Open Hole Perforation Other (Specify)

Dual Completion Commingled

RECEIVED

STATE CORPORATION COMMISSION

MAR 04 1985

CONSERVATION DIVISION