

15-145-20087-0000

STATE OF KANSAS
STATE CORPORATION COMMISSION
CONSERVATION DIVISION
P. O. BOX 17027
WICHITA, KANSAS 67217

FORM CP-4

WELL PLUGGING RECORD

Pawnee County, Sec. 3 Twp. 23 Rge. 15 (E) (W)X
Location as "NE/CNW/SW" or footage from lines SW/NW/NW
Lease Owner Et Al, Inc.
Lease Name THELMA Well No. 1
Office Address 116 NW Street, St. John, Kansas 67576
Character of Well (completed as Oil, Gas or Dry Hole)
Date well completed 19
Application for plugging filed 19
Application for plugging approved 19
Plugging commenced October 6, 1975
Plugging completed October 23, 1975
Reason for abandonment of well or producing formation Depleted

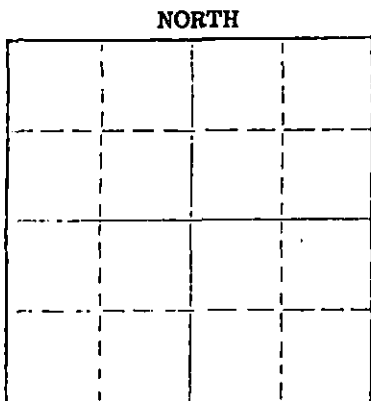

Locate well correctly on above Section Plat

If a producing well is abandoned, date of last production 19
Was permission obtained from the Conservation Division or its agents before plugging was commenced? Yes

Name of Conservation Agent who supervised plugging of this well Leo Massey
Producing formation Depth to top Bottom Total Depth of Well 3020 Feet
Show depth and thickness of all water, oil and gas formations.

OIL, GAS OR WATER RECORDS

CASING RECORD

FORMATION	CONTENT	FROM	TO	SIZE	PUT IN	PULLED OUT
				8 5/8	249	-0-
				4 1/2	2990	1899.65

Describe in detail the manner in which the well was plugged, indicating where the mud fluid was placed and the method or methods used in introducing it into the hole. If cement or other plugs were used, state the character of same and depth placed, from feet to feet for each plug set.

Plugged bottom back to 2150'. Dumped in 15 gallons sand and 5 sacks cement. Shot casing at 1900'. Laid down a total of 60 joints of 4 1/2" casing. Plugged well with 3 sacks hulls, 25 sacks gel and 125 sacks 60/40 Pozmix.

NOV 4 1975

(If additional description is necessary, use BACK of this sheet)

Name of Plugging Contractor Rockhold Engineering, Inc.
Address P. O. Box 698, Great Bend, Kansas 67530

CONSERVATION DIVISION
WICHITA, KANSAS

STATE OF Kansas COUNTY OF Barton

11-4-75

James W. Rockhold (employee of owner) or (owner/operator) of the above-described well, being first duly sworn on oath, says: That I have knowledge of the facts, statements, and matters herein contained and the log of the above-described well as filed and that the same are true and correct. So help me God.

(Signature) James W. Rockhold
Box 698, Gt. Bend, Ks. 67530 (Address)

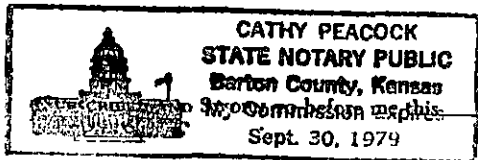

My commission expires September 30, 1979

3rd day of November 1975
Cathy Peacock
Notary Public.

KANSAS DRILLERS LOG

API No. 15 — 145-20087 — 0000
 County Number

S. 3 T. 23S R. 15W W

Loc. SW NW NW

County Pawnee

Operator
Et Al, Inc.

Address
119 Cameron Building, Oklahoma City, Oklahoma 73106

Well No. 1 Lease Name Thelma

Footage Location
2460 feet from (N) 15 line 330 feet from 24 (W) line

Principal Contractor Hellar Drilling Company, Inc. Geologist B. K. Crumpley

Spud Date November 26, 1968 Total Depth 3020' P.B.T.D. 2990'

Date Completed February 11, 1969 Oil Purchaser Gas Only
Kansas-Nebraska

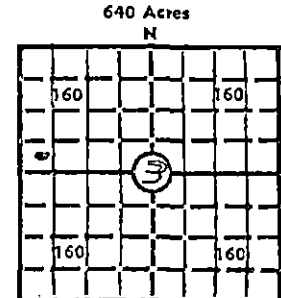

Locate well correctly
 Elev.: Gr. 2003

DF 2006 KB 2008

CASING RECORD

Report of all strings set — surface, intermediate, production, etc.

Purpose of string	Size hole drilled	Size casing set (in O.D.)	Weight lbs/ft.	Setting depth	Type cement	Sacks	Type and percent additives
Surface	12- $\frac{1}{4}$	8- $\frac{5}{8}$	28	249	Pozmix	200	3% HA-5
Production	7- $\frac{7}{8}$	4 $\frac{1}{2}$	9.5	3019	Pozmix	225	15% salt

LINER RECORD

Top, ft. None Bottom, ft. Sacks cement

PERFORATION RECORD

Shots per ft. Howard: 4 Size & type 3-1/8" SDJ Depth interval 2967-73
 Willard: 1 3-1/8 DPJ 2849-52
 " 1 " 2856-59
 Willard 1 " 2861-67
 on 11/15/73

TUBING RECORD

Size 2" EUE Setting depth 2854 Packer set at 2881

ACID, FRACTURE, SHOT, CEMENT SQUEEZE RECORD

Amount and kind of material used	Depth interval treated
<u>500 Gal. MCA</u>	<u>2967-73</u>
<u>500 Gal. MCA</u>	<u>2849-67 overall</u>
<u>2000 lbs. sand in 4000 Gal. gelled salt water</u>	<u>2849-67 overall</u>

RECEIVED
 STATE CORPORATION COMMISSION

SEP 30 1975

INITIAL PRODUCTION

Date of first production 2/20/69 Producing method (flowing, pumping, gas lift, etc.) Flow through tubing

RATE OF PRODUCTION PER 24 HOURS
 Oil None Gas 589 Water None Gas-oil ratio gas well
 bbls. MCF bbls. CFPB

Disposition of gas (vented, used on lease or sold) Sold to Kansas-Nebraska N.G. Co. Inc. Producing interval(s) Howard 2967-73

INSTRUCTIONS: As provided in KCC Rule 82-2-125, within 90 days after completion of a well, one completed copy of this Drillers Log shall be transmitted to the State Geological Survey of Kansas, 4150 Monroe Street, Wichita, Kansas 67209. Copies of this form are available from the Conservation Division, State Corporation Commission, 3830 So. Meridian (P.O. Box 17027), Wichita, Kansas 66217. Phone AC 316-522-2206. If confidential custody is desired, please note Rule 82-2-125. Drillers Logs will be on open file in the Oil and Gas Division, State Geological Survey of Kansas, Lawrence, Kansas 66044.

Operator Et Al, Inc. DESIGNATE TYPE OF COMP.: OIL, GAS, DRY HOLE, SWDW, ETC.: Gas

Well No. 1 Lease Name Thelma

S 3 T23S R 15W^E_W

WELL LOG
 Show all important zones of porosity and contents thereof; cored intervals, and all drill-stem tests, including depth interval tested, cushion used, time tool open, flowing and shut-in pressures, and recoveries. SHOW GEOLOGICAL MARKERS, LOGS RUN, OR OTHER DESCRIPTIVE INFORMATION.

FORMATION DESCRIPTION, CONTENTS, ETC.	TOP	BOTTOM	NAME	DEPTH
Sand and shale	0	250	Herington	1,943
Shale and red bed	250	800	Winfield	2,004
Shale	800	1,500	Towanda	2,066
Shale & anhydrite streaks	1,500	1,885	Ft. Riley	2,108
Shale and lime	1,885	2,517	Wreford	2,219
Lime - water	2,517	2,560	Council Grove	2,286
Shale and lime	2,560	2,849	Cottonwood	2,398
Sand and shale - gas & water	2,849	2,867	Neva	2,460
Shale and lime	2,867	2,960	Foraker	2,517
Lime - gas and water	2,960	3,020	Admire	2,562
			Wabaunsee	2,698
			Langdon	2,758
			Tarkio	2,828
			Willard	2,849
			Elmont	2,890
			Howard	2,960
			TD	3,020

USE ADDITIONAL SHEETS, IF NECESSARY, TO COMPLETE WELL RECORD.

Date Received _____

 Signature
 President
 Title
 September 18, 1975
 Date