

STATE OF KANSAS  
STATE CORPORATION COMMISSION  
Give All Information Completely  
Make Required Affidavit  
Mail or Deliver Report to:  
Conservation Division  
State Corporation Commission  
211 No. Broadway  
Wichita, Kansas

WELL PLUGGING RECORD

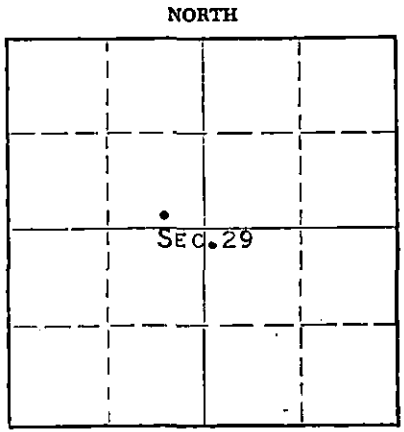

Locate well correctly on above Section Plat

STAFFORD County. Sec. 29 Twp. 23s Rge. 14W (X) (W)  
Location as "NE/CNW/SW" or footage from lines SW SE NW  
Lease Owner PETROLEUM, INC.  
Lease Name BIRDSALL Well No. 3  
Office Address ROUTE 2, GREAT BEND, KANSAS  
Character of Well (completed as Oil, Gas or Dry Hole) DRY HOLE  
Date well completed AUGUST 19 19 63  
Application for plugging filed AUGUST 19 19 63  
Application for plugging approved AUGUST 19 19 63  
Plugging commenced AUGUST 19 19 63  
Plugging completed AUGUST 19 19 63  
Reason for abandonment of well or producing formation NO PRODUCIBLE ZONES

If a producing well is abandoned, date of last production NONE 19  
Was permission obtained from the Conservation Division or its agents before plugging was commenced? YES

Name of Conservation Agent who supervised plugging of this well ARCHIE ELYING  
Producing formation - - Depth to top - - Bottom - - Total Depth of Well 3815 Feet  
Show depth and thickness of all water, oil and gas formations.

OIL, GAS OR WATER RECORDS

CASING RECORD

FORMATION	CONTENT	FROM	TO	SIZE	PUT IN	PULLED OUT
				8-5/8	255.68'	NONE

Describe in detail the manner in which the well was plugged, indicating where the mud fluid was placed and the method or methods used in introducing it into the hole. If cement or other plugs were used, state the character of same and depth placed, from feet to feet for each plug set.

MUDDED UP WITH HEAVY MUD TO 250', FOLLOWED BY WOODEN PLUG AND 1/4 SACK HULLS. PLACED 20' SACKS CEMENT THROUGH DRILL PIPE ONTO HULLS. MUDDED UP WITH HEAVY MUD TO 40', FOLLOWED BY WOODEN PLUG, 1/4 SACK HULLS AND 10 SACKS CEMENT TO BASE OF WELL CELLAR. PLUGGED RAT HOLE WITH 1/4 SACK HULLS AND 2 SACKS CEMENT.

RECEIVED  
STATE CORPORATION COMMISSION

AUG 27 1963

CONSERVATION DIVISION  
Wichita, Kansas

(If additional description is necessary, use BACK of this sheet)  
Name of Plugging Contractor GARVEY DRILLING COMPANY  
Address ROUTE 2, GREAT BEND, KANSAS

STATE OF KANSAS, COUNTY OF BARTON, ss.  
DON SEARLE (employee of owner) or (owner or operator) of the above-described well, being first duly sworn on oath, says: That I have knowledge of the facts, statements, and matters herein contained and the log of the above-described well as filed and that the same are true and correct. So help me God. DON SEARLE, DIST. PROD. SUPT.  
(Signature) [Signature]  
ROUTE 2, GREAT BEND, KANSAS (Address)

SUBSCRIBED AND SWORN to before me this 26TH day of AUGUST, 19 63

My commission expires APRIL 14, 1967 [Signature] Notary Public.

# WELL LOG

15-185-19465-0000

COMPANY Petroleum Inc

SEC. 29 T. 23S R. 14W

FARM Birdsall

NO. 3

LOC. SW SE NW

TOTAL DEPTH 3815'

COUNTY Stafford

COMM. 8-11-63

COMP. 8-19-63

CONTRACTOR Garvey Drilling Company

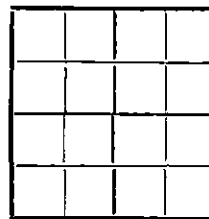

CASING 8 5/8" @ 255.68' w/200 sx

ELEVATION 1964' DF

PRODUCTION D & A

FIGURES INDICATE BOTTOM OF FORMATIONS

185' Sand  
 335' Shale and Red Bed  
 395' Sand  
 872' Red Bed  
 890' Anhydrite  
 950' Shale and Red Bed  
 1740' Shale and Lime  
 1995' Lime and Shale  
 2270' Lime  
 2400' Lime and Shale  
 2450' Shale w/Lime  
 2560' Limey Shale  
 2990' Shale and Lime  
 3505' Lime and Shale  
 3577' Shale  
 3815' Lime  
 3815' RTD

RECEIVED  
STATE CORPORATION COMMISSION

AUG 27 1963

CONSERVATION DIVISION  
Wichita, Kansas

State of Kansas  
County of Barton } ss

I, Sam N. Stephens of Garvey Drilling Company  
upon oath state the above and foregoing is a true and correct copy of the log of the Birdsall #3 well.

Subscribed and sworn to before me this 23rd day of August 19 63

My Commission Expires: April 14th, 1967

  
NOTARY PUBLIC