

WELL PLUGGING RECORD

Give All Information Completely
Make Required Affidavit
Mail or Deliver Report to:
Conservation Division
State Corporation Commission
211 No. Broadway
Wichita, Kansas

BARTON County, Sec. 27 Twp. 20s Rge. (X) 11 (W)

Location as "NE/CNW%SW%" or footage from lines SW NE NW
Lease Owner PETROLEUM, INC.,
Lease Name HAGEN "C" Well No. 1
Office Address ROUTE #2, GREAT BEND, KANSAS
Character of Well (completed as Oil, Gas or Dry Hole) DRY HOLE
Date well completed JULY 25 19 64
Application for plugging filed JULY 25 19 64
Application for plugging approved JULY 25 19 64
Plugging commenced JULY 25 19 64
Plugging completed JULY 26 19 64
Reason for abandonment of well or producing formation NO PRODUCIBLE ZONES

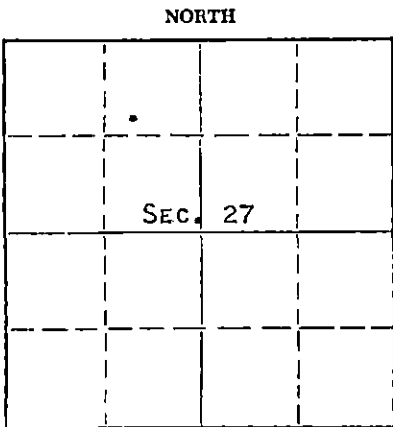

Locate well correctly on above Section Plat

If a producing well is abandoned, date of last production 19
Was permission obtained from the Conservation Division or its agents before plugging was commenced? YES

Name of Conservation Agent who supervised plugging of this well DONALD TRUAN
Producing formation _____ Depth to top _____ Bottom _____ Total Depth of Well 3356' Feet
Show depth and thickness of all water, oil and gas formations.

OIL, GAS OR WATER RECORDS

CASING RECORD

FORMATION	CONTENT	FROM	TO	SIZE	PUT IN	PULLED OUT
				8-5/8"	253'	NONE

Describe in detail the manner in which the well was plugged, indicating where the mud fluid was placed and the method or methods used in introducing it into the hole. If cement or other plugs were used, state the character of same and depth placed, from _____ feet to _____ feet for each plug set.

MUDDED UP WITH HEAVY MUD TO 250', FOLLOWED BY A WOODEN PLUG, 1/4 SACK HULLS AND 25 SACKS CEMENT. MUDDED UP WITH HEAVY MUD TO 40', FOLLOWED BY A WOODEN PLUG, 1/4 SACK HULLS AND 10 SACKS CEMENT TO BASE OF WELL CELLAR.

RECEIVED
STATE CORPORATION COMMISSION

AUG 3 1964

CONSERVATION DIVISION
Wichita, Kansas

(If additional description is necessary, use BACK of this sheet)
Name of Plugging Contractor GARVEY DRILLING CO.
Address ROUTE #2, GREAT BEND, KANSAS

STATE OF KANSAS, COUNTY OF BARTON, ss.
MONTE CHADD (employee of owner) or (owner) of the above-described well, being first duly sworn on oath, says: That I have knowledge of the facts, statements, and matters herein contained and the log of the above-described well as filed and that the same are true and correct. So help me God. MONTE CHADD, DIST. PROD. SUPT.

(Signature) *Monte Chadd*
ROUTE #2, GREAT BEND, KANSAS
(Address)

SUBSCRIBED AND SWORN TO before me this 30TH day of JULY, 19 64

My commission expires APRIL 14, 1967

Arden J. Gules
Notary Public.

WELL LOG

15.009.30886.00.00

COMPANY Petroleum, Inc.

SEC. 27 T.20S R. 11W

FARM Hagen

NO. "C" #1

LOC. SW NE NW

TOTAL DEPTH 3356'

COUNTY Barton

COMM. 7-17-64

COMP. 7-26-64

CONTRACTOR Garvey Drilling Company

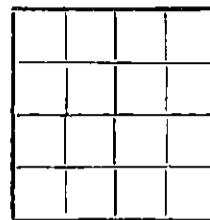

CASING 8 5/8" @ 253' w/309 sx

ELEVATION 1771' DF

PRODUCTION D & A

FIGURES INDICATE BOTTOM OF FORMATIONS

30' Surface Clay
 150' Shale and Sand Streaks
 180' Shale
 253' Red Bed and Shale
 465' Red Bed
 795' Shale and Shells
 1350' Shale and Lime
 1740' Lime and Shale
 2155' Lime
 2245' Shale and Lime Streaks
 2600' Shale and Lime
 2925' Lime
 2940' Shale and Lime
 2960' Lime
 3032' Sandy Lime
 3048' Shale and Lime
 3092' Lime and Shale
 3300' Lime
 3315' Lime and Shale
 3356' Lime
 3356' RTD

RECEIVED
STATE CORPORATION COMMISSION

AUG 3 1964

CONSERVATION DIVISION
Wichita, Kansas

State of Kansas }
 County of Barton } SS

I, Sam N. Stephens of Garvey Drilling Company

upon oath state the above and foregoing is a true and correct copy of the log of the Hagen "C" #1 well.

Sam N. Stephens

Subscribed and sworn to before me this 30th day of July 19 64

My Commission Expires: April 14th, 1967

Archer J. Miles
NOTARY PUBLIC