

15.009 . 14207.00.00

WELL PLUGGING RECORD

Give Information Completely
Make Required Affidavit
Mail or Deliver Report to:
Conservation Division
State Corporation Commission
800 Bittling Building
Wichita, Kansas

Barton County, Sec. 14 Twp. 19 Rge. 15 (E) W(W)

Location as "NE/CNW%SW%" or footage from lines SW NW NE

Lease Owner PETROLEUM, INC.

Lease Name LAWRENCE Well No. 1

Office Address Route 2, Great Bend, Kansas

Character of Well (completed as Oil, Gas or Dry Hole) Dry Hole

Date well completed June 30 19 56

Application for plugging filed July 7 19 56

Application for plugging approved July 11 19 56

Plugging commenced July 18 19 56

Plugging completed July 23 19 56

Reason for abandonment of well or producing formation No Producible

Zones

If a producing well is abandoned, date of last production None 19

Was permission obtained from the Conservation Division or its agents before plugging was commenced? Yes

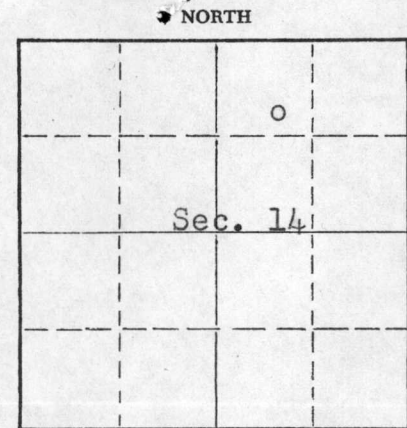

Locate well correctly on above Section Plat

Name of Conservation Agent who supervised plugging of this well R.M. Brundege Hoisington, Kansas

Producing formation ----- Depth to top --- Bottom --- Total Depth of Well 3653 Feet

Show depth and thickness of all water, oil and gas formations.

OIL, GAS OR WATER RECORDS

CASING RECORD

FORMATION	CONTENT	FROM	TO	SIZE	PUT IN	PULLED OUT
Reagan Sand	Water & little oil	3582'	3586'	8 5/8" OD	908'	None
Gorham Sand	Water & little oil	3551'	3560'	5 1/2" OD	3651'	2985'

Describe in detail the manner in which the well was plugged, indicating where the mud fluid was placed and the method or methods used in introducing it into the hole. If cement or other plugs were used, state the character of same and depth placed, from _____ feet to _____ feet for each plug set.

(Plugged back to 3565')

Filled hole with crushed rock from 3565' to 3540', and placed 5 sacks of cement on top of rock. Mudded up to 300' and made solid rock bridge on top of mud. Placed 20 sacks of cement on top of rock bridge and mudded up to 35'. Made solid rock bridge at 35' and filled hole to base of well cellar with 10 sacks of cement.

(If additional description is necessary, use BACK of this sheet)

Name of Plugging Contractor Morgan Well Plugging Service
Address 102 West 18th Street, Hutchinson, Kansas

STATE OF KANSAS, COUNTY OF BARTON, ss.
DON SEARLE (employee of owner) or (owner or operator)

well, being first duly sworn on oath, says: That I have knowledge of the facts, statements, and matters herein contained and the log of the above-described well as filed and that the same are true and correct. So help me God.

(Signature) Don Searle
ROUTE 2, GREAT BEND, KANSAS (Address)

SUBSCRIBED AND SWORN TO before me this 25th day of July, 19 56

Led E. Brown Notary Public.

My commission expires July 11, 1960

PLUGGING
FILE SEC. 14 T. 19 R. 15W
BOOK PAGE 78 LINE 42

RECEIVED
STATE CORPORATION COMMISSION
JUL 27 1956
7-27-56
CONSERVATION DIVISION
Wichita, Kansas

15.009 . 14207.00.00

WELL LOG

COMPANY **Petroleum, Inc.**

SEC. **14** T. **19S** R. **15W**

FARM **LAWRENCE** NO. **1**

LOC. **SW NW NE**
990' FNL
2310' FEL

TOTAL DEPTH **3653'**

COUNTY **Barton**

COMM. **May 31, 1956** COMP. **June 13, 1956**

CONTRACTOR **Garvey Drilling Company**

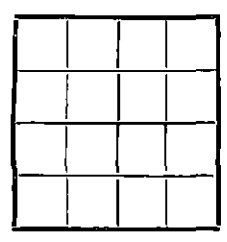

CASING **8-5/8" @ 908' w/40 sax**
5-1/2" @ 3651 w/75 sax

ELEVATION **1948 RB**

PRODUCTION **Abandoned**

FIGURES INDICATE BOTTOM OF FORMATIONS

40	Soil & Clay
130	Sand & Shale
350	Shale
460	Sand
725	Red Bed
909	Anhydrite
1400	Shale & Shells
3308	Lime & Shale
3395	Lime
3440	Lime & Chert
3454	Lime
3515	Lime & Shale with Chert
3557	Lime & Shale
3565	Lime & Sand
3582	Arbuckle
3625	Lime
3653	Granite Wash

Sample Tops

Anhydrite	900 (+1048)
Heebner	3171 (-1223)
Lansing	3260 (-1312)
Conglomerate	3504 (-1556)
Gorham	3555 (-1607)
Arbuckle	3564 (-1616)
Reagan	3583 (-1635)
Granitewash	3623 (-1675)

RTD 3653'

State of KANSAS }
County of SEDGWICK } ss:

PLUGGING
FILE SEC. 14 T. 19 R. 15W
BOOK PAGE 78 LINE 42

I, Cullen Thomas of Petroleum, Inc.

upon oath state that the above and foregoing is a true and correct copy of the log of the LAWRENCE #1 well

Cullen Thomas

Subscribed and sworn to before me this 25th day of June 19 56

My Commission Expires: September 2, 1959

Frances Sloan
NOTARY PUBLIC

FRANCES SLOAN, Notary Public
My Commission expires Sept. 2, 1959