

15-145-00446-0000

STATE OF KANSAS  
STATE CORPORATION COMMISSION

WELL PLUGGING RECORD

Give All Information Completely  
Make Required Affidavit  
Mail or Deliver Report to:  
Conservation Division  
State Corporation Commission  
800 Bittling Building  
Wichita, Kansas

OR

FORMATION PLUGGING RECORD

Strike out upper line  
when reporting plug-  
ging of formations.

Pawnee County, Sec. 20 Twp. 23S Rge. (E) 15 (W)

Location as "NE $\frac{1}{4}$ NW $\frac{1}{4}$ SW $\frac{1}{4}$ " or footage from lines. SW $\frac{1}{4}$  NE $\frac{1}{4}$  NE $\frac{1}{4}$

Lease Owner. Skelly Oil Company

Lease Name. Frank Hall Estate Well No. 1

Office Address. Box 391, Hutchinson, Kansas

Character of Well (completed as Oil, Gas or Dry Hole) Dry Hole

Date well completed. November 15 1945

Application for plugging filed. November 16 1945

Application for plugging approved. November 20 1945

Plugging commenced. November 16 1945

Plugging completed. November 16 1945

Reason for abandonment of well or producing formation. Dry Hole

If a producing well is abandoned, date of last production. 19

Was permission obtained from the Conservation Division or its agents before plugging was commenced? Yes

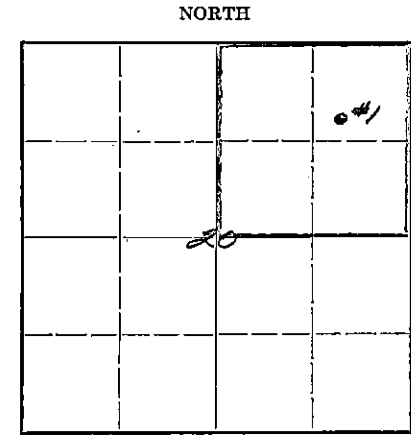

Locate well correctly on above  
Section Plat

Name of Conservation Agent who supervised plugging of this well. H. W. Kerr

Producing formation. Depth to top. Bottom. Total Depth of Well. 4171' Feet

Show depth and thickness of all water, oil and gas formations.

OIL, GAS OR WATER RECORDS

CASING RECORD

| Formation     | Content | From  | To | Size      | Put In  | Pulled Out |
|---------------|---------|-------|----|-----------|---------|------------|
| Lansing Lime  | Dry     | 3662' |    | 8-5/8" OD | 955' 0" | None       |
| Conglomerate  | "       | 4007' |    |           |         |            |
| Viola Lime    | "       | 4063' |    |           |         |            |
| Arbuckle Lime | "       | 4157' |    |           |         |            |

Describe in detail the manner in which the well was plugged, indicating where the mud fluid was placed and the method or methods used in introducing it into the hole. If cement or other plugs were used, state the character of same and depth placed, from \_\_\_\_\_ feet to \_\_\_\_\_ feet for each plug set.

Mud laden fluid 4171' to 4071'  
 45 sacks of cement 4071' to 3820'  
 Mud laden fluid 3820' to 200'  
 Wood plug and 20 sacks cement 200' to 150'  
 Mud laden fluid 150' to 20'  
 Wood plug and 10 sacks cement 20' to 6'  
 Surface soil 6' to 0.

PLUGGING  
FILE 20 23 15W  
BOOK PAGE 33 LINE 34

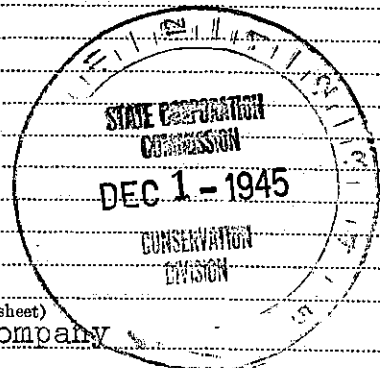

(If additional description is necessary, use BACK of this sheet)

Correspondence regarding this well should be addressed to. Skelly Oil Company  
Address. Box 391, Hutchinson, Kansas

STATE OF KANSAS, COUNTY OF RENO, ss.  
H. E. Wamsley (employee of owner)

being first duly sworn on oath, says: That I have knowledge of the facts, statements, and matters herein contained and the log of the above-described well as filed and that the same are true and correct. So help me God.

(Signature)

Box 391, Hutchinson, Kansas (Address)

SUBSCRIBED AND SWORN to before me this 29th day of November, 1945

My commission expires April 7, 1947. Notary Public.

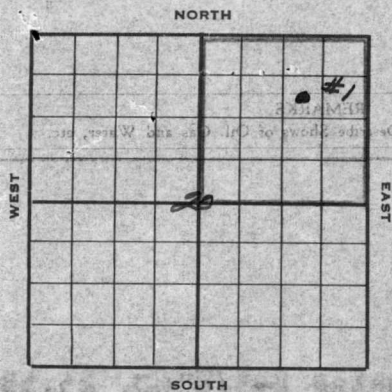

# SKELLY OIL COMPANY

## Well Record

Lease Name and No. **Frank Hall Estate** Well No. **1** Elev. **2039'DF**  
 Lease Description **NE/4 Sec. 20-23S-15W, Pawnee County, Kansas**  
 Location made **October 11 19 45** by **Pawnee County Engineer**  
**990** feet from North line **990** feet from East line **NE/4**  
 feet from South line feet from West line of **Sec. 20**

Work com'd **Oct. 12 19 45** Rig comp'd **Oct. 17 19 45** Drlg. com'd **Oct. 24 19 45** Drlg. comp'd **Nov. 14 19 45**

Rig Contractor **HAT Drilling Company**

Drilling Contractor **HAT Drilling Company, Great Bend, Kansas**

Rotary Drilling from **Top** to **4171'** Cable Tool Drilling from to

Commenced Producing **Dry Hole** 19 { Initial Prod. before shot or acid **Dry Hole** Bbls.  
 Initial Prod. after shot or acid Bbls.

Dry Gas Well Press Volume Cu. ft.

Casing Head Gas Pressure Volume Cu. ft.

Braden Head ( Size ) Gas Pressure Volume Cu. ft.

Braden Head ( Size ) Gas Pressure Volume Cu. ft.

PRODUCING FORMATION **Dry Hole** (Name) Top Bottom TOTAL DEPTH **4171'**

### CASING RECORD

| Size                                      | Wt.          | Thds.     | Where Set   | PULLED OUT |      |     | LEFT IN   |            |          | KIND                | Cond'n | CEMENTING  |                    |
|---|--------------|-----------|-------------|------------|------|-----|-----------|------------|----------|---------------------|--------|------------|--------------------|
|   |              |           |             | Jts.       | Feet | In. | Jts.      | Feet       | In.      |                     |        | Sacks Used | Method Employed    |
| <b>8-5/8"OD</b>                           | <b>25.55</b> | <b>8V</b> | <b>951'</b> |            |      |     | <b>41</b> | <b>955</b> | <b>0</b> | <b>Lapweld RI A</b> |        | <b>300</b> | <b>Halliburton</b> |
| <b>(8-5/8"OD casing set 6' in collar)</b> |              |           |             |            |      |     |           |            |          |                     |        |            |                    |

Liner Set at Length Perforated at

Liner Set at Length Perforated at

Packer Set at Size and Kind

Packer Set at Size and Kind

### SHOT OR ACID TREATMENT RECORD

|                                     | FIRST       | SECOND      | THIRD       | FOURTH      |
|-------------------------------------|-------------|-------------|-------------|-------------|
| Date                                |             |             |             |             |
| Acid Used                           |             |             |             |             |
| Size Shot                           |             |             |             |             |
| Shot Between                        | Ft. and Ft. | Ft. and Ft. | Ft. and Ft. | Ft. and Ft. |
| Size of Shell                       |             |             |             |             |
| Put in by (Co.)                     |             |             |             |             |
| Length anchor                       |             |             |             |             |
| Distance below Cas'g                |             |             |             |             |
| Damage to Casing or Casing Shoulder |             |             |             |             |

### SIGNIFICANT GEOLOGICAL FORMATIONS

| NAME                 | Top          | Bottom | GAS  |    | OIL  |    | REMARKS |
|----------------------|--------------|--------|------|----|------|----|---------|
|                      |              |        | From | To | From | To |         |
| <b>Lansing Line</b>  | <b>3662'</b> |        |      |    |      |    |         |
| <b>Conglomerate</b>  | <b>4007'</b> |        |      |    |      |    |         |
| <b>Viola Line</b>    | <b>4063'</b> |        |      |    |      |    |         |
| <b>Arhuckle Line</b> | <b>4157'</b> |        |      |    |      |    |         |

### CLEANING OUT RECORDS

|     | DATE COMMENCED | DATE COMPLETED | PROD. BEFORE | PROD. AFTER | REMARKS                        |
|-----|----------------|----------------|--------------|-------------|--------------------------------|
| 1st |                |                |              |             | See Reverse for other details. |
| 2nd |                |                |              |             | " " " " "                      |
| 3rd |                |                |              |             | " " " " "                      |
| 4th |                |                |              |             | " " " " "                      |

### PLUGGING BACK AND DEEPENING RECORDS

|     | Date Commenced | Date Completed | No. Feet Plugged Back or Deepened | Prod. Before | Prod. After | REMARKS                        |
|-----|----------------|----------------|-----------------------------------|--------------|-------------|--------------------------------|
| 1st |                |                |                                   |              |             | See Reverse for other details. |
| 2nd |                |                |                                   |              |             | " " " " "                      |
| 3rd |                |                |                                   |              |             | " " " " "                      |
| 4th |                |                |                                   |              |             | " " " " "                      |

(See Reverse for Record of Formation)



# RECORD OF FORMATIONS

FORMATION      TOP      BOTTOM      REMARKS  
Indicate Casing Points, Describe Shows of Oil, Gas and Water, etc.

|                               |      |      |  |
|-------------------------------|------|------|--|
| Surface soil                  | 0    | 13   | Indicate Casing Points, Describe Shows of Oil, Gas and Water, etc. |
| Sand and clay                 | 13   | 120  |  |
| Shale and shells              | 120  | 410  |  |
| Shale and bed bed             | 410  | 460  |  |
| Shale                         | 460  | 520  |  |
| Shale and bed bed             | 520  | 675  |  |
| Shale                         | 675  | 952  |  |
| Red bed                       | 952  | 980  |  |
| Anhydrite                     | 980  | 1025 |  |
| Shale and shells              | 1025 | 1675 |  |
| Salt and shells               | 1675 | 1780 |  |
| Lime and shale                | 1780 | 1890 |  |
| Shale and shells              | 1890 | 1940 |  |
| Lime and shale                | 1940 | 1970 |  |
| Lime                          | 1970 | 2085 |  |
| Sandy lime                    | 2085 | 2110 |  |
| Lime                          | 2110 | 2165 |  |
| Broken lime                   | 2165 | 2300 |  |
| Lime and shale                | 2300 | 2355 |  |
| Blue shale                    | 2355 | 2550 |  |
| Grey shale                    | 2550 | 2620 |  |
| Broken lime and shale         | 2620 | 2720 |  |
| Shale                         | 2720 | 2795 |  |
| Shale and lime                | 2795 | 2930 |  |
| Broken lime                   | 2930 | 3005 |  |
| Lime and shale                | 3005 | 3010 |  |
| Broken lime and shale         | 3010 | 3070 |  |
| Lime                          | 3070 | 3090 |  |
| Lime and shale                | 3090 | 3140 |  |
| Lime                          | 3140 | 3240 |  |
| Broken lime                   | 3240 | 3460 |  |
| Lime                          | 3460 | 3550 |  |
| Shale                         | 3550 | 3662 | TOP LAMING LINE 3662'  |
| Lime                          | 3662 | 3920 |  |
| Shale                         | 3920 | 4050 | TOP CONCRETE 4007'   |
| Lime and chert                | 4050 | 4081 | TOP VIOLA LINE 4052'   |
| Chert and shale               | 4081 | 4085 |  |
| Lime                          | 4085 | 4115 |  |
| Shale                         | 4115 | 4157 | TOP ARBUCKLE LINE 4157'  |
| Coarsely crystalline dolomite | 4157 | 4168 | No porosity or saturation  |
| Same                          | 4168 | 4171 | Good porosity, no saturation                                       |

TOTAL DEPTH      1171'

Since no commercial shows of oil or gas were encountered in drilling to this depth, regular authority was granted on November 15, 1945, to plug and abandon the well.

On November 16, 1945, the well was plugged as follows:

|                                  |       |    |       |
|----------------------------------|-------|----|-------|
| Filled hole with mud laden fluid | 4171' | to | 4071' |
| 45 sacks of cement               | 4071' | to | 3820' |
| mud laden fluid                  | 3820' | to | 200'  |
| Good plug and 10 sacks of cement | 200'  | to | 150'  |
| fluid laden mud                  | 150'  | to | 20'   |
| Good plug and 10 sacks of cement | 20'   | to | 6'    |
| fluid laden mud                  | 6'    | to | 0'    |

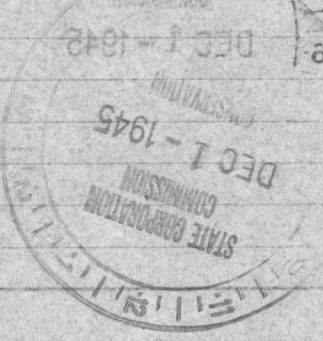

| DATE COMMENCED | DATE COMPLETED | PROD. AFTER | REMARKS |
|----------------|----------------|-------------|---------|
|                |                | 0           | 1750'   |
|                |                | 0           | 2000'   |
|                |                | 0           | 2250'   |
|                |                | 0           | 2500'   |
|                |                | 0           | 2750'   |
|                |                | 0           | 3000'   |
|                |                | 0           | 3250'   |

PLUGGING  
FILE 20 23 157  
BOOK PAGE 33 34

