

STATE CORPORATION COMMISSION OF KANSAS
OIL & GAS CONSERVATION DIVISION

WELL COMPLETION OR RECOMPLETION FORM
ACO-1 WELL HISTORY

DESCRIPTION OF WELL AND LEASE

Operator: license # 5430
name ENERGY THREE, INC.
address P.O. Box 1505
GREAT BEND, KANSAS 67530
City/State/Zip

Operator Contact Person CHARLES DIXON
Phone AC316-792-5968

Contractor: license # 5836
name BIG THREE DRILLING, INC.

Wellsite Geologist KENT EWONUS
Phone AC316-264-0016

Designate Type of Completion
 New Well Re-Entry Workover

Oil SWD Temp Abd
 Gas Inj Delayed Comp.
 Dry Other (Core, Water Supply etc.)

if OWWO: old well info as follows:

Operator
Well Name
Comp. Date Old Total Depth
Wichita, Kansas

WELL HISTORY

Drilling Method: Mud Rotary Air Rotary Cable
11-29-84 12-5-84 3-6-85
Spud Date Date Reached TD Completion Date
3454' 3404'
Total Depth PBDT
Amount of Surface Pipe Set and Cemented at 220 feet
Multiple Stage Cementing Collar Used? Yes No
If Yes, Show Depth Set feet
If alternate 2 completion, cement circulated from feet depth to w/ SX cmt

API NO. 15 - 159-21,932-0000

County RICE

CENT. NW NE Sec 36 Twp 21S Rge 9 East West

4620 Ft North from Southeast Corner of Section
1980 Ft West from Southeast Corner of Section
(Note: locate well in section plat below)

Lease Name HALTOM Well# 1

Field Name Fitzpatrick

Producing Formation MISS. CHERT CONG.

Elevation: Ground 1651' KB 1656'

Section Plat

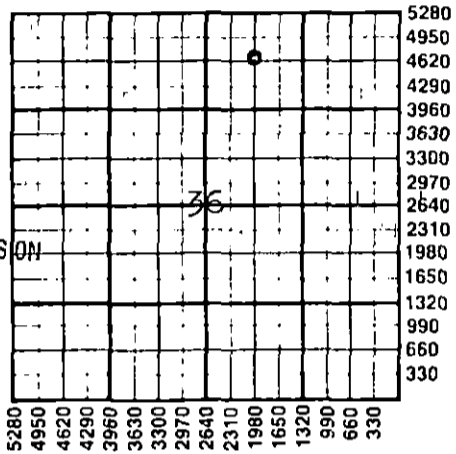

RECEIVED
APR 30 1985
STATE CORPORATION COMMISSION
CONSERVATION DIVISION
Wichita, Kansas

WATER SUPPLY INFORMATION

Source of Water:
Division of Water Resources Permit # 186
 Groundwater 4480 Ft North From Southeast Corner and
1650 Ft. West From Southeast Corner of
Sec 36 Twp 21S Rge 9W East West
 Surface Water Ft North From Southeast Corner and
Ft West From Southeast Corner
Sec Twp Rge East West
 Other (explain)
(purchased from city, R.W.D.#)

Disposition of Produced Water: Disposal Repressuring
Docket #

INSTRUCTIONS: This form shall be completed in duplicate and filed with the Kansas Corporation Commission, 200 Colorado Derby Building, Wichita, Kansas 67202, within 90 days after completion or recompletion of any well. Rules 82-3-130 and 82-3-107 apply.

Information on side two of this form will be held confidential for a period of 12 months if requested in writing and submitted with the form. See rule 82-3-107 for confidentiality in excess of 12 months.

One copy of all wireline logs and drillers time log shall be attached with this form. Submit CP-4 form with all plugged wells. Submit CP-111 form with all temporarily abandoned wells.

All requirements of the statutes, rules, and regulations promulgated to regulate the oil and gas industry have been fully complied with and the statements herein are complete and correct to the best of my knowledge.

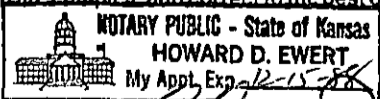

Signature Charles Dixon

Title EXECUTIVE VICE-PRESIDENT Date 4-29-85

Subscribed and sworn to before me this 29th day of APRIL 19 85

Notary Public Howard D. Ewert

Date Commission Expires DECEMBER 15, 1988

K.C.C. OFFICE USE ONLY
F Letter of Confidentiality Attached
C Wireline Log Received
C Drillers Timelog Received
Distribution
 KCC SWD/Rep NGPA
 KGS Plug Other (Specify)

Sec. 36 Twp. 21S Rge. 9W

Operator Name ENERGY THREE, INC. Lease Name HALTOM Well# 1 SEC. 36 TWP. 21S RGE. 9W West

WELL LOG

INSTRUCTIONS: Show important tops and base of formations penetrated. Detail all cores. Report all drill stem tests giving interval tested, time tool open and closed, flowing and shut-in pressures, whether shut-in pressure reached static level, hydrostatic pressures, bottom hole temperature, fluid recovery, and flow rates if gas to surface during test. Attach extra sheet if more space is needed. Attach copy of log.

Drill Stem Tests Taken Yes No
 Samples Sent to Geological Survey Yes No
 Cores Taken Yes No

Formation Description
 Log Sample

D.S.T. # 1 FROM 3028' TO 3066'
 TIMES = 30 - 45 - 45 - 60
 RECOVERED 15' WATERY MUD W/ SHOW OF OIL
 INITIAL FLOW PRESSURE = 67 - 57
 FINAL FLOW PRESSURE = 57 - 57
 INITIAL SHUTIN PRESS. = 212 #
 FINAL SHUTIN PRESS. = 86 #

D.S.T. # 2 FROM 3324' TO 3355'
 TIMES = 45 - 45 - 75 - 90
 RECOVERED 90' GAS CUT MUD
 INITIAL FLOW PRESSURE = 347 - 157
 FINAL FLOW PRESSURE = 337 - 135
 INITIAL SHUTIN PRESS. = 694 #
 FINAL SHUTIN PRESS. = 685 #

Name	Top	Bottom
HEEBNER	2813'	(- 1157)
TORONTO	2828'	(- 1172)
DOUGLAS SHALE	2844'	(- 1188)
BROWN LIME	2956'	(- 1300)
LANS.-KC	2986'	(- 1330)
SWOPE	3222'	(- 1566)
K.C. BASE	3304'	(- 1648)
MISS. CHERT CONG.	3334'	(- 1678)
KINDERHOOK SHALE	3404'	(- 1748)
LOG T.D.	3454'	

CASING RECORD new used

Report all strings set - conductor, surface, intermediate, production, etc.

Purpose of string	size hole drilled	size casing set (in O.D.)	weight lbs/ft.	setting depth	type of cement	# sacks used	type and percent additives
SURFACE	12 1/4"	8 5/8"	20#	220'	60/40 Poz.	180	3% C.C., 2% GEL
PRODUCTION	7 7/8"	4 1/2"	10.5#	3453'	REG. Poz.	200	18% SALT, 3/4% HALAD.

PERFORATION RECORD

Acid, Fracture, Shot, Cement Squeeze Record

shots per foot	specify footage of each interval perforated	(amount and kind of material used)	Depth
4	3335' TO 3343'	500 GAL. 10% F.E., 10,500 # 20/40 SAND; 9000 # 10.20 SAND	SAME

TUBING RECORD

size set at packer at Liner Run Yes No

Date of First Production SHUT IN Producing method flowing pumping gas lift Other (explain)

Estimated Production Per 24 Hours	Oil	Gas	Water	Gas-Oil Ratio	Gravity
	---	600,000 Cu. Ft.	??		
	Bbls	MCF	T Bbls	CFPB	

METHOD OF COMPLETION

PRODUCTION INTERVAL

Disposition of gas: vented sold used on lease
 open hole perforation other (specify)
 Dually Completed. Commingled

..... 3335' TO 3343'