

EFFECTIVE DATE: 3-2-92
DISTRICT # 4
SGA? Yes No

State of Kansas

OWWO

FORM MUST BE SIGNED
ALL BLANKS MUST BE FILLED

NOTICE OF INTENTION TO DRILL

Must be approved by the K.C.C. five (5) days prior to commencing well

Expected Spud Date: 02 11 92
month day year

Spot NE NW SE Sec. 11 Twp. 16 S. Rg. 12 East West

OPERATOR: License # 30124
Name: Scavenger Oil Co., Inc.
Address: 6565 S. Dayton St., Ste 2350
City/State/Zip: Englewood, Co. 80111-6137
Contact Person: David H. Penrose
Phone: (303) 799-8105

2310 feet from South line of Section
1650 feet from East line of Section
IS SECTION X REGULAR IRREGULAR

(NOTE: Locate well on the Section Plat on Reverse Side)
County: Barton
Lease Name: N. J. Weber well # 6
Field Name: Kraft-Prusa
Is this a Prorated/Spaced Field? yes no
Target Formation(s): Arbuckle
Nearest lease or unit boundary: 330
Ground Surface Elevation: 1900 feet MSL
Water well within one-quarter mile: yes no
Public water supply well within one mile: yes no
Depth to bottom of fresh water: 190
Depth to bottom of usable water: 320
Surface Pipe by Alternate: X 1 2
Length of Surface Pipe 260 feet
Length of Conductor pipe required: n/a
Projected Total Depth: 3335 feet
Formation at Total Depth: Arbuckle
Water Source for Drilling Operations: well farm pond other
DWR Permit #: n/a
Will Cores Be Taken? yes no
If yes, proposed zone: n/a

CONTRACTOR: License # 5418
Name: Allen Drilling Co.

Well Drilled For: Well Class: Type Equipment:
 Oil Enh Rec XX Infield XY Mud Rotary
 Gas Storage Pool Ext Air Rotary
XXX OWWO Disposal Wildcat Cable
 Seismic; # of Holes Other

If OWWO: old well information as follows:
Operator: NCRA
Well Name: NJ Weber "A" #6
Comp. Date: 7/1948 old total depth 3335 feet

Directional, Deviated or Horizontal wellbore? yes no
If yes, true vertical depth: n/a
Bottom Hole Location: n/a

AFFIDAVIT

Exception

The undersigned hereby affirms that the drilling, completion and eventual plugging of this well will comply with K.S.A. 55-101, et. seq.
It is agreed that the following minimum requirements will be met:

1. Notify the appropriate district office prior to spudding of well;
2. A copy of the approved notice of intent to drill shall be posted on each drilling rig;
3. The minimum amount of surface pipe as specified below shall be set by circulating cement to the top; in all cases surface pipe shall be set through all unconsolidated materials plus a minimum of 20 feet into the underlying formation;
4. If the well is dry hole, an agreement between the operator and the district office on plug length and placement is necessary prior to plugging;
5. The appropriate district office will be notified before well is either plugged or production casing is cemented in;
6. IF AN ALTERNATE II COMPLETION, PRODUCTION PIPE SHALL BE CEMENTED FROM BELOW ANY USABLE WATER TO SURFACE WITHIN 120 DAYS OF SPUD DATE. IN ALL CASES, NOTIFY DISTRICT OFFICE PRIOR TO ANY CEMENTING.

I hereby certify that the statements made herein are true and to the best of my knowledge and belief.

Date: 2/7/92 Signature of Operator or Agent: David H. Penrose Title: President

FOR KCC USE:
API # 15- 009-01,051-00-03
Conductor pipe required: None feet
Minimum surface pipe required: 260 feet per Alt. (1)
Approved by: MW 2-26-92
This authorization expires: 8-26-92
(This authorization void if drilling not started within 6 months of effective date.)
Spud date: _____ Agent: _____

RECEIVED
STATE CORPORATION COMMISSION
FEB 12 1992
CONSERVATION DIVISION
WICHITA, KANSAS
RESERVED
STATE CORPORATION COMMISSION

- REMEMBER TO-
- File Drill Pit Application (form COP-1) with Intent to Drill;
 - File Completion Form ACO-1 within 120 days of spud date;
 - File acreage attribution plat according to field prorations orders;
 - Notify appropriate district office 48 hours prior to workover or re-entry;
 - Submit plugging report (CP-4) after plugging is completed;
 - Obtain written approval before disposing or injecting salt water.

Mail to: Conservation Division, 200 Colorado Derby Building, 202 W. First St., Wichita, Kansas 67202-1243
Conservation Division
Wichita, Kansas

Handwritten initials and marks: 11, 16, 18

PLAT OF ACREAGE ATTRIBUTABLE TO A WELL IN A PRORATED OR SPACED FIELD

If the intended well is in a prorated or spaced field, please fully complete this side of the form. If the intended well is in a prorated or spaced field, complete the plat below showing that the well will be properly located in relationship to other wells producing from the common source of supply. Please show all the wells within 1 mile of the boundaries of the proposed acreage attribution unit for gas wells and within 1/2 mile of the boundaries of the proposed acreage attribution unit for oil wells.

API NO. 15- _____
 OPERATOR Scavenger Oil Co., Inc. LOCATION OF WELL: COUNTY Barton
 LEASEN. J. Weber 2310 feet from south/north line of section
 WELL NUMBER No. 6 1650 feet from east/west line of section
 FIELD Kraft-Prusa SECTION T1 TWP 16S RG 12W

NUMBER OF ACRES ATTRIBUTABLE TO WELL 10 IS SECTION X REGULAR or _____ IRREGULAR
 QTR/QTR/QTR OF ACREAGE NE NE SE IF SECTION IS IRREGULAR, LOCATE WELL FROM NEAREST
CORNER BOUNDARY.

Section corner used: NE NW SE SW

PLAT

(Show location of the well and shade attributable acreage for prorated or spaced wells.)
 (Show footage to the nearest lease or unit boundary line.)

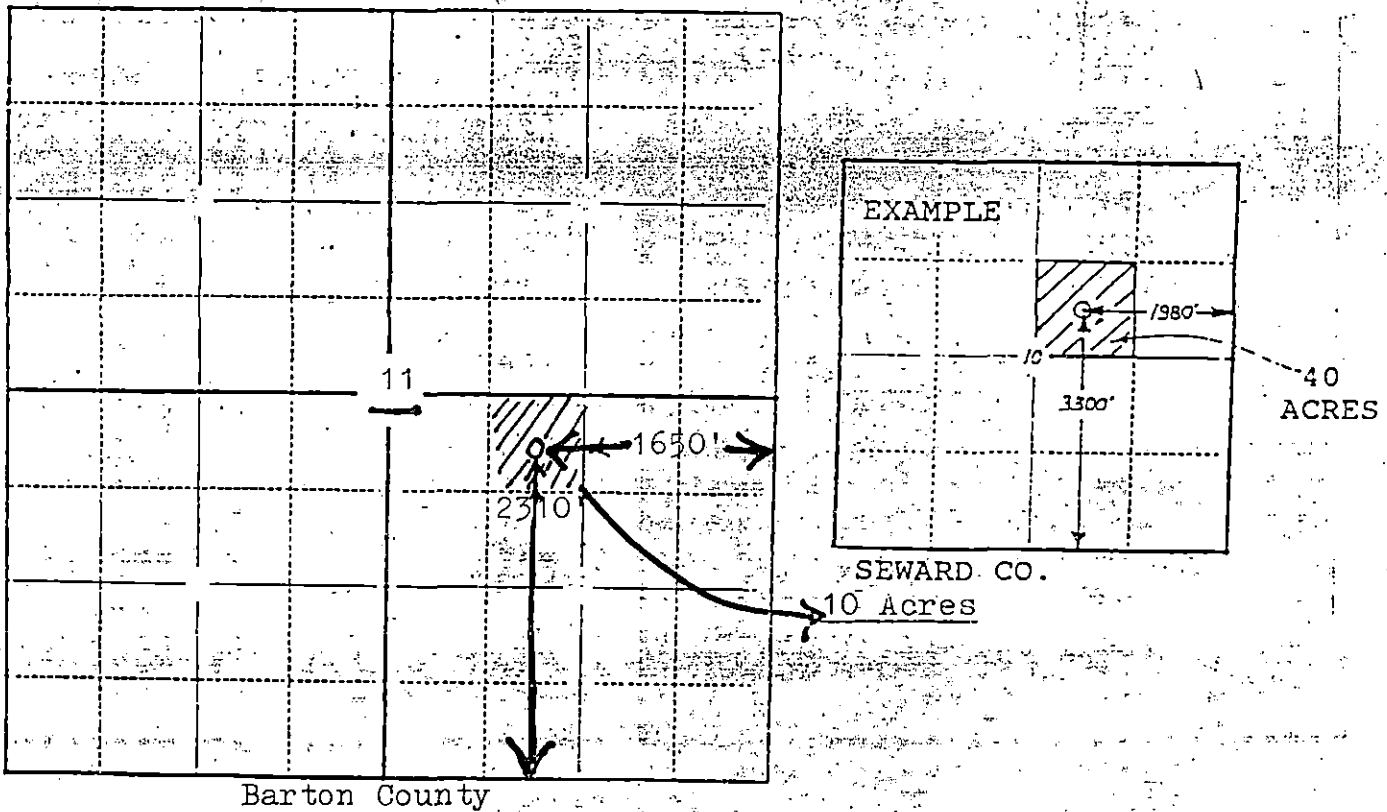

In plotting the proposed location of the well you must show:

- 1) The manner in which you are using the depicted plat by identifying section lines, i.e. 1 section, 1 section with 8 surrounding sections, 4 sections, etc.;
- 2) the distance of the proposed drilling location from the section's south/north and east/west lines; and
- 3) the distance to the nearest lease or unit boundary line.