

STATE CORPORATION COMMISSION OF KANSAS  
OIL & GAS CONSERVATION DIVISION  
WELL COMPLETION OR RECOMPLETION FORM  
ACO-1 WELL HISTORY  
DESCRIPTION OF WELL AND LEASE

S

API NO. 15-159-22,161-0000  
County... Rice  
165' S  
W/2 SE NW Sec. 9 Twp. 21 Rge. 10 East West

Operator: License # 4661  
Name Galloway Petroleum Exploration, Inc.  
Address 300 Broadway Plaza Bldg.  
City/State/Zip Wichita, KS 67202

3135 Ft North from Southeast Corner of Section  
3630 Ft West from Southeast Corner of Section  
(Note: Locate well in section plat below)

Purchaser

Lease Name Snider "B" Well #. 1-9

Operator Contact Person Casey Galloway  
Phone 316-267-7355

Field Name

Producing Formation

Elevation: Ground 1721 1726 KB

Contractor: License # 5929  
Name Duke Drilling Co., Inc.

Wellsite Geologist Casey Galloway  
Phone (316) 267-7355

Designate Type of Completion  
 New Well  Re-Entry  Workover  
 Oil  SWD  Temp Abd  
 Gas  Inj  Delayed Comp.  
 Dry  Other (Core, Water Supply etc.)

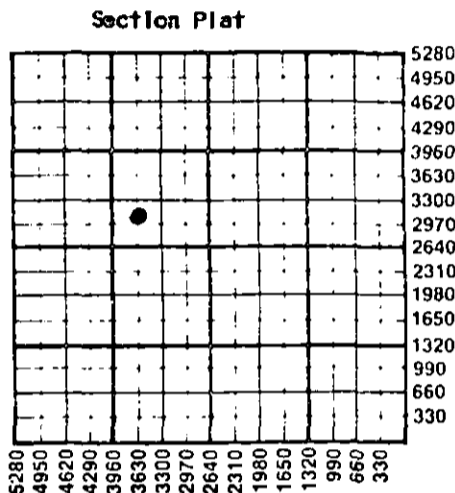

If OWWO: old well info as follows:  
Operator  
Well Name  
Comp. Date Old Total Depth

WATER SUPPLY INFORMATION

Disposition of Produced Water:  Disposal  
Docket #  Repressuring

WELL HISTORY

Drilling Method:  
 Mud Rotary  Air Rotary  Cable

Questions on this portion of the ACO-1 call:

Water Resources Board (913) 296-3717  
Source of Water:  
Division of Water Resources Permit #. 186-372

11-14-86... 11-20-86... 11/21/86...  
Spud Date Date Reached TD Completion Date  
3450'  
Total Depth PBDT

Groundwater 3135 Ft North from Southeast Corner  
(Well) 3630 Ft West from Southeast Corner of  
Sec 9 Twp 21 Rge 10 East West  
 Surface Water... Ft North from Southeast Corner  
(Stream, pond etc)... Ft West from Southeast Corner  
Sec Twp Rge East West  
 Other (explain)  
(purchased from city, R.W.D. #)

Amount of Surface Pipe Set and Cemented at 208' feet  
Multiple Stage Cementing Collar Used?  Yes  No  
If yes, show depth set... feet  
If alternate 2 completion, cement circulated  
from... feet depth to... w/... SX cmt  
Cement Company Name  
Invoice #

INSTRUCTIONS: This form shall be completed in triplicate and filed with the Kansas Corporation Commission, 200 Colorado Derby Building, Wichita, Kansas 67202, within 120 days of the spud date of any well. Rule 82-3-130, 82-3-107 and 82-3-106 apply. Information on side two of this form will be held confidential for a period of 12 months if requested in writing and submitted with the form. See rule 82-3-107 for confidentiality in excess of 12 months. One copy of all wireline logs and drillers time log shall be attached with this form. Submit CP-4 form with all plugged wells. Submit CP-111 form with all temporarily abandoned wells.

All requirements of the statutes, rules and regulations promulgated to regulate the oil and gas industry have been fully complied with and the statements herein are complete and correct to the best of my knowledge.

Signature Casey F. Galloway  
Title President Date 12/4/86

K.C.C. OFFICE USE ONLY  
F  Letter of Confidentiality Attached  
C  Wireline Log Received  
C  Drillers Timelog Received  
Distribution  
 KCC  SWD/Rep  NGPA  
 KGS  Plug  Other  
(Specify)

Subscribed and sworn to before me this 4th day of December 1986  
Notary Public Susan Kendall  
Date Commission Expires 10/6/87



STATE COM.

DEC 5 1986

CONSERVATION DIVISION  
Wichita, Kansas

Form ACO-1 (5-86)

12-586

Sec. 9, Twp. 21, Rge. 10, W/2

SIDE TWO

Operator Name ..... Galloway Petroleum Exploration, Inc. Lease Name..... Snider "B"..... Well #... 1-9..

Sec..... 9..... Twp..... 21..... Rge..... 10.....  East  West County..... Rice.....

WELL LOG

INSTRUCTIONS: Show important tops and base of formations penetrated. Detail all cores. Report all drill stem tests giving interval tested, time tool open and closed, flowing and shut-in pressures, whether shut-in pressure reached static level, hydrostatic pressures, bottom hole temperature, fluid recovery, and flow rates if gas to surface during test. Attach extra sheet if more space is needed. Attach copy of log.

Drill Stem Tests Taken  Yes  No  
 Samples Sent to Geological Survey  Yes  No  
 Cores Taken  Yes  No

Formation Description  
 Log  Sample

DST #1 2420-2556 30-30-30-30  
 Rec. 1400' water, IFP 158-550, FFP 614-699,  
 SIP 900-900, HP 1357/1336

DST #2 3064-3096 30-30-30-30  
 Rec. 10' mud, IFP 31/31, FFP 31/31, SIP 52-42,  
 HP 1678/1657

DST #3 3315-3360 30-30-30-30  
 Rec. 10' mud, IFP 31/31, FFP 31/31, SIP 222-169  
 HP 1851-1829

Name	Top	Bottom
Anhydrite	387	410
Tarkio	2256	2330
Howard	2478	2538
Severy Sand	2543	2556
Heebner	2870	2876
Brown Lime	3006	3012
Lansing	3027	3265
Simpson	3346	3401
Arbuckle	3401	

CASING RECORD <input checked="" type="checkbox"/> New <input type="checkbox"/> Used							
Report all strings set-conductor, surface, intermediate, production, etc.							
Purpose of String	Size Hole Drilled	Size Casing Set (In O.D.)	Weight Lbs/Ft.	Setting Depth	Type of Cement	#Sacks Used	Type and Percent Additives
Surface	12 1/2"	8-5/8"	20#	208'	60/40 poz	180	2% gel 3% cc
PERFORATION RECORD				Acid, Fracture, Shot, Cement Squeeze Record			
Shots Per Foot	Specify Footage of Each Interval Perforated			(Amount and Kind of Material Used)			Depth
TUBING RECORD		Size	Set At	Packer at	Liner Run	<input type="checkbox"/> Yes <input type="checkbox"/> No	
Date of First Production		Producing Method					
		<input type="checkbox"/> Flowing <input type="checkbox"/> Pumping <input type="checkbox"/> Gas Lift <input type="checkbox"/> Other (explain).....					
Estimated Production Per 24 Hours	Oil	Gas	Water	Gas-Oil Ratio	Gravity		
	Bbls	MCF	Bbls	CFPB			

METHOD OF COMPLETION Production Interval

Disposition of gas:  Vented  Open Hole  Perforation  
 Sold  Other (Specify) .....  
 Used on Lease  Dually Completed .....  
 Commingled