

STATE CORPORATION COMMISSION OF KANSAS  
OIL & GAS CONSERVATION DIVISION  
WELL COMPLETION OR RECOMPLETION FORM  
ACO-1 WELL HISTORY  
DESCRIPTION OF WELL AND LEASE

Operator: License # 04973  
Name Vantage Petroleum, Inc.  
Address P. O. Box 553  
Great Bend, KS 67530-0553  
City/State/Zip

Purchaser N/A

Operator Contact Person Thomas Larson  
Phone (316) 792-3664

Contractor: License # 08241  
Name Emphasis Oil Operations

Wellsite Geologist Robert Stolzle  
Phone (316) 682-8844

Designate Type of Completion  
 New Well  Re-Entry  Workover  
 Oil  SWD  Temp Abd  
 Gas  Inj  Delayed Comp.  
 Dry  Other (Core, Water Supply etc.)

If OWNQ: old well info as follows:  
Operator  
Well Name  
Comp. Date Old Total Depth

WELL HISTORY

Drilling Method:  
 Mud Rotary  Air Rotary  Cable  
11-05-88 11-11-88 N/A 11-11-88  
Spud Date Date Reached TD Completion Date  
4122 N/A  
Total Depth PBTD

Amount of Surface Pipe Set and Cemented at 552 feet  
Multiple Stage Cementing Collar Used? Yes  No  
If yes, show depth set feet  
If alternate 2 completion, cement circulated from feet depth to w/ SX cmt  
Cement Company Name  
Invoice # 81-E D+0

API NO. 15-145-21,287-0000

County Paynee

SW SE SW 19 23 15 East  
irregular section  
X West

330 Ft North from Southeast Corner of Section  
3670 Ft West from Southeast Corner of Section  
(Note: Locate well in section plat below)

Lease Name Campbell Well # 1

Field Name Benson (ext.)

Producing Formation N/A

Elevation: Ground 2040 ft. 2045 ft. KB

Section Plat

Table with 10 columns and 10 rows representing a section plat grid. The right side of the grid is labeled with elevations from 5280 to 330. A dot is marked in the grid at the intersection of the 3600 and 3300 elevation lines.

RECEIVED  
MAY 8 1989  
STATE CORPORATION COMMISSION  
CONSERVATION DIVISION  
Wichita, Kansas

WATER SUPPLY INFORMATION

Disposition of Produced Water: Disposal  
Docket # Repressuring

Questions on this portion of the ACO-1 call:  
Water Resources Board (913) 296-3717  
Source of Water:  
Division of Water Resources Permit # T88-540

Groundwater 400 Ft North from Southeast Corner  
(Well) 3600 Ft West from Southeast Corner of  
Sec 19 Twp 23 Rge 15 East  West  
 Surface Water Ft North from Southeast Corner  
(Stream, pond etc) Ft West from Southeast Corner  
Sec Twp Rge East West  
 Other (explain) (purchased from city, R.W.D. #)

INSTRUCTIONS: This form shall be completed in triplicate and filed with the Kansas Corporation Commission, 200 Colorado Derby Building, Wichita, Kansas 67202, within 120 days of the spud date of any well. Rule 82-3-130, 82-3-107 and 82-3-106 apply. Information on side two of this form will be held confidential for a period of 12 months if requested in writing and submitted with the form. See rule 82-3-107 for confidentiality in excess of 12 months. One copy of all wireline logs and drillers time log shall be attached with this form. Submit CP-4 form with all plugged wells. Submit CP-111 form with all temporarily abandoned wells.

All requirements of the statutes, rules and regulations promulgated to regulate the oil and gas industry have been fully complied with and the statements herein are complete and correct to the best of my knowledge.

Signature Thomas C. Larson  
Title President Date 5-5-89

Subscribed and sworn to before me this 5th day of May 1989  
Notary Public Austin Boyd

Date Commission Expires March 30, 1992



K.C.C. OFFICE USE ONLY  
F Letter of Confidentiality Attached  
C  Wireline Log Received  
C  Drillers Timelog Received  
Distribution  
 KCC  SWD/Rep  NGPA  
 KGS  Plug  Other  
(Specify)  
5-8-89 X1  
Form ACO-1 (5-86)

Sec 9, Twp 23 Rge 15

**SIDE TWO**

Operator Name Vantage Petroleum, Inc. Lease Name Campbell Well # 1

Sec. 19 Twp. 23 Rge. 15  East  West County Pawnee

**WELL LOG**

**INSTRUCTIONS:** Show important tops and base of formations penetrated. Detail all cores. Report all drill stem tests giving interval tested, time tool open and closed, flowing and shut-in pressures, whether shut-in pressure reached static level, hydrostatic pressures, bottom hole temperature, fluid recovery, and flow rates if gas to surface during test. Attach extra sheet if more space is needed. Attach copy of log.

Drill Stem Tests Taken  Yes  No  
 Samples Sent to Geological Survey  Yes  No  
 Cores Taken  Yes  No

**Formation Description**  
 Log  Sample

Name	Top	Bottom
Anhydrite	981 (+1064)	1005
Topeka LS	3114 (-1069)	nc
Heebner Shale	3492 (-1447)	3498
Toronto LS	3516 (-1471)	3533
Brown Lime	3622 (-1577)	3626
Lansing-Kansas City	3630 (-1585)	3889
Marmaton LS	3975 (-1930)	4000
Viola	4011 (-1966)	4049
Simpson Shale	4049 (-2004)	4081
Arbuckle Dolomite	4081 (-2036)	nde
TD	4122 (-2077)	

DST#1-3687-3723-15/30/60/100 1st open FST 68/92, SB1", SIP 992, 2nd open FTP 150/335, strong blow in 4", SIP 1001. Rec 65' oil and gas cut muddy water, 120' oil & gas cut watery mud, 60' water with slight show oil, 420' water. HP 1871/1774, T113F.  
 DST#2-3990-4075-15/30/60/105 1st open FST 34/34, weak blow throughout, SIP 63, 2nd open FTP 35/38, WBT, SIP 205, Rec 40' slightly gas cut mud. HP 1952/1932, T117F.

CASING RECORD <input checked="" type="checkbox"/> New <input type="checkbox"/> Used							
Report all strings set-conductor, surface, intermediate, production, etc.							
Purpose of String	Size Hole Drilled	Size Casing Set (in O.D.)	Weight Lbs/Ft.	Setting Depth	Type of Cement	#Sacks Used	Type and Percent Additives
Surface pipe	12-1/4	8-5/8	20	552	50/50poz	325	2%gel, 3%CC
PERFORATION RECORD				Acid, Fracture, Shot, Cement Squeeze Record			
Shots Per Foot	Specify Footage of Each Interval Perforated			(Amount and Kind of Material Used)		Depth	
TUBING RECORD				Liner Run	<input type="checkbox"/> Yes <input type="checkbox"/> No		
Date of First Production	Producing Method						
N/A	<input type="checkbox"/> Flowing <input type="checkbox"/> Pumping <input type="checkbox"/> Gas Lift <input type="checkbox"/> Other (explain).....						
Estimated Production Per 24 Hours	Oil	Gas	Water	Gas-Oil Ratio	Gravity		
	Bbls	MCF	Bbls	CFPB			

**METHOD OF COMPLETION**

**Production Interval**

Disposition of gas:  Vented  Open Hole  Perforation  
 Sold  Other (Specify) .....  
 Used on Lease  Dually Completed .....  
 Commingled .....

VANTAGE PETROLEUM  
 CAMPBELL LEASE  
 SW ¼, SECTION 19, T23S, R15W  
 PAWNEE COUNTY, KANSAS

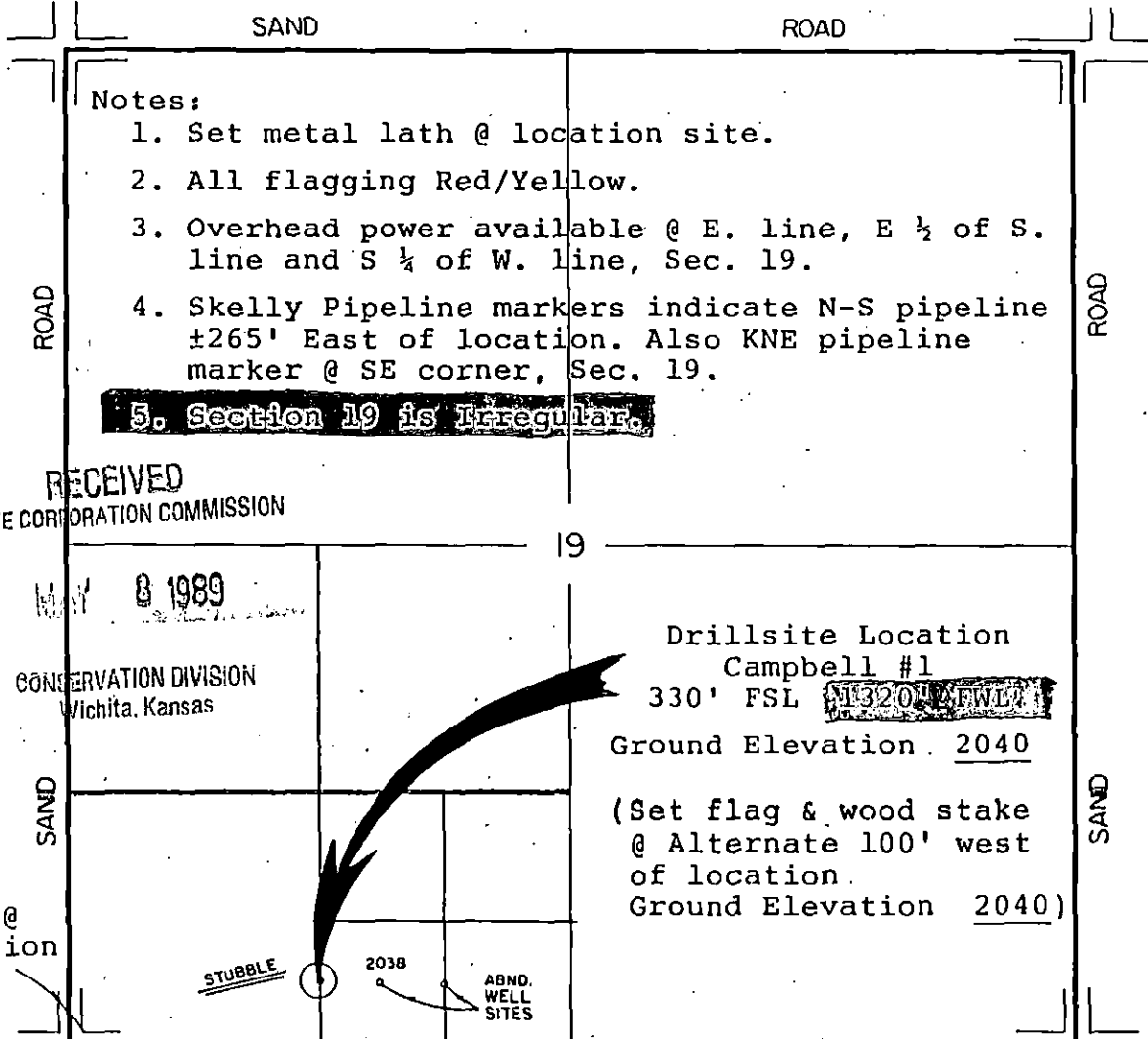

Notes:

1. Set metal lath @ location site.
2. All flagging Red/Yellow.
3. Overhead power available @ E. line, E ½ of S. line and S ¼ of W. line, Sec. 19.
4. Skelly Pipeline markers indicate N-S pipeline ±265' East of location. Also KNE pipeline marker @ SE corner, Sec. 19.
5. Section 19 is Irregular.

RECEIVED  
 STATE CORPORATION COMMISSION

NOV 8 1989  
 CONSERVATION DIVISION  
 Wichita, Kansas

Drillsite Location  
 Campbell #1  
 330' FSL  
 Ground Elevation 2040  
 (Set flag & wood stake  
 @ Alternate 100' west  
 of location.  
 Ground Elevation 2040)

flagged @  
 intersection

4 miles to  
 Hwy 19

flagged road  
 opposite location

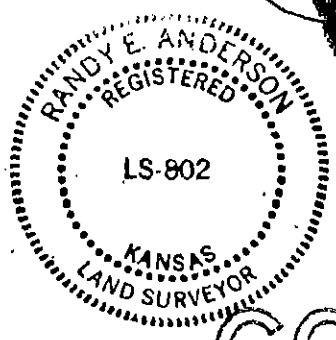
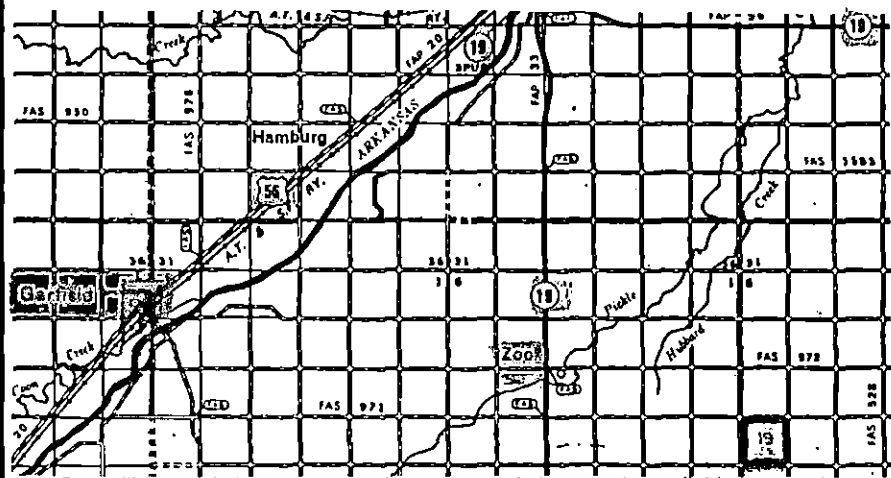
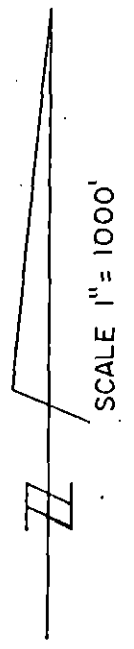

COPY

Randy E. Anderson  
 Randy E. Anderson, R.L.S. 802

Date October 31, 1988

\*Controlling data is based upon the best maps and photographs available to us and upon a regular section of land containing 640 acres.  
 \*Aerial Photographs available at the U.S. A.S.C.S. Office located at the County Seat.  
 \*Elevations derived from National Geodetic Vertical Datum.