

FOR KCC USE:

EFFECTIVE DATE: 12-15-93  
DISTRICT # 4  
35A7, Yes, No

2

FORM C-1 7/91  
FORM MUST BE TYPED  
FORM MUST BE STICKE  
ALL BLANKS MUST BE FILLED

State of Kansas  
NOTICE OF INTENTION TO DRILL

Must be approved by the K.C.C. five (5) days prior to commencing well

Expected Spud Date 12 13 93  
month day year

Spot SW SW NE Sec 15 Twp 16 S. Rg 12 X East West

OPERATOR: License # 31120  
Name: Pelican Hill Oil & Gas, Inc.  
Address: 2139 Ave. Espada  
City/State/Zip: San Clemente, CA 92672  
Contact Person: Allen Gross  
Phone: 714-498-2101

2310 feet from South North line of Section  
2310 feet from East West line of Section  
IS SECTION X REGULAR IRREGULAR

(NOTE: Locate well on the Section Plat on Reverse Side)  
County: Barton  
Lease Name: Hoffman  
Field Name: Beaver

CONTRACTOR: License #  
Name: Allen Drilling Co.

Is this a Protected/Spaced Field? X yes no  
Target Formation(s): Arbuckle  
Nearest lease or unit boundary: 330' F.W.L.

Well Drilled For: Well Class: Type Equipment:  
X Oil ... Inh Rec ... X Infield X Mud Rotary  
Gas ... Storage ... Pool Ext. ... Air Rotary  
CWMO ... Disposal ... Wildcat ... Cable  
Seismic: # of Holes ... Other

Ground Surface Elevation: feet MSL  
Water well within one-quarter mile: yes X no  
Public water supply well within one mile: yes X no

Depth to bottom of fresh water: 270  
Depth to bottom of usable water: 330

Surface Pipe by Alternate: 1 (850) 2 350  
Length of Surface Pipe Planned to be set: NONE

Length of Conductor pipe required: 3300  
Projected Total Depth: 3300

Formation at Total Depth: Arbuckle  
Water Source for Drilling Operations:

... well ... farm pond X other  
DWR Permit #:

Will Cores Be Taken? yes no  
If yes, proposed zone:

Directional, Deviated or Horizontal wellbore? yes X no  
If yes, true vertical depth:  
Bottom Hole Location:

AFFIDAVIT

The undersigned hereby affirms that the drilling, completion and eventual plugging of this well will comply with K.S.A. 55-101, et. seq.  
It is agreed that the following minimum requirements will be set:

RECEIVED  
STATE CORPORATION COMMISSION  
DEC 20 1993

- 1. Notify the appropriate district office prior to spudding of well;
- 2. A copy of the approved notice of intent to drill shall be posted on each drilling rig;
- 3. The minimum amount of surface pipe as specified below shall be set by circulating cement to which top Kansas all cases surface pipe shall be set through all unconsolidated materials plus a minimum of 20 feet into the underlying formation;
- 4. If the well is dry hole, an agreement between the operator and the district office on plug length and placement is necessary prior to plugging;
- 5. The appropriate district office will be notified before well is either plugged or production casing is cemented in;
- 6. IF AN ALTERNATE IS COMPLETED, PRODUCTION PIPE SHALL BE CEMENTED FROM BELOW ANY USABLE WATER TO SURFACE WITHIN 120 DAYS OF SPUD DATE. IN ALL CASES, NOTIFY DISTRICT OFFICE PRIOR TO ANY CEMENTING.

I hereby certify that the statements made herein are true and to the best of my knowledge and belief.  
Date: 12/9/93 Signature of Operator or Agent: Allen J. Gross Title: President

FOR KCC USE:  
API # 15- 009-24573 0000  
Conductor pipe required NONE feet  
Minimum surface pipe required 350 feet per Alt. 1 2  
Approved by: 12/10/93  
This authorization expires: 6-10-94  
(This authorization void if drilling not started within 6 months of effective date.)  
Spud date: Agent:

REMEMBER TO:

- File Drill Plat Application (form CDP-1) with Intent to Drill;
- File Completion Form ACD-1 within 120 days of spud date;
- File acreage attribution plat according to field production orders;
- Notify appropriate district office 48 hours prior to workover or re-entry;
- Submit plugging report (CP-6) after plugging is completed;
- Obtain written approval before disposing or injecting salt water.

Mail to: Conservation Division, 200 Colorado Derby Building, 202 W. First St., Wichita, Kansas 67202-1286.

15  
16  
12

IN ALL CASES PLOT THE INTENDED WELL ON THE PLAT BELOW.

PLAT OF ACREAGE ATTRIBUTABLE TO A WELL IN A PRORATED OR SPACED FIELD

If the intended well is in a prorated or spaced field, please fully complete this side of the form. If the intended well is in a prorated or spaced field complete the plat below showing that the well will be properly located in relationship to other wells producing from the common source of supply. Please show all the wells within 1 mile of the boundaries of the proposed acreage attribution unit for gas wells and within 1/2 mile of the boundaries of the proposed acreage attribution unit for oil wells.

API NO. 15- \_\_\_\_\_  
OPERATOR Pelican Hill Oil & Gas, Inc.  
LEASE Hoffman  
WELL NUMBER 1  
FIELD Beaver

LOCATION OF WELL: COUNTY Barton  
2310 feet from south/north line of section  
2310 feet from east/west line of section  
SECTION 15 TWP 16 RG 12

NUMBER OF ACRES ATTRIBUTABLE TO WELL 10  
QTR/QTR/QTR OF ACREAGE SW - SW - NE

IS SECTION N REGULAR? YES IF SECTION IS IRREGULAR, LOCATE WELL FROM NEAREST CORNER BOUNDARY.

Section names: SW SE NW NE

PLAT

(Show location of the well and shade attributable acreage for prorated or spaced wells. (Show footage to the nearest lease or unit boundary line.)

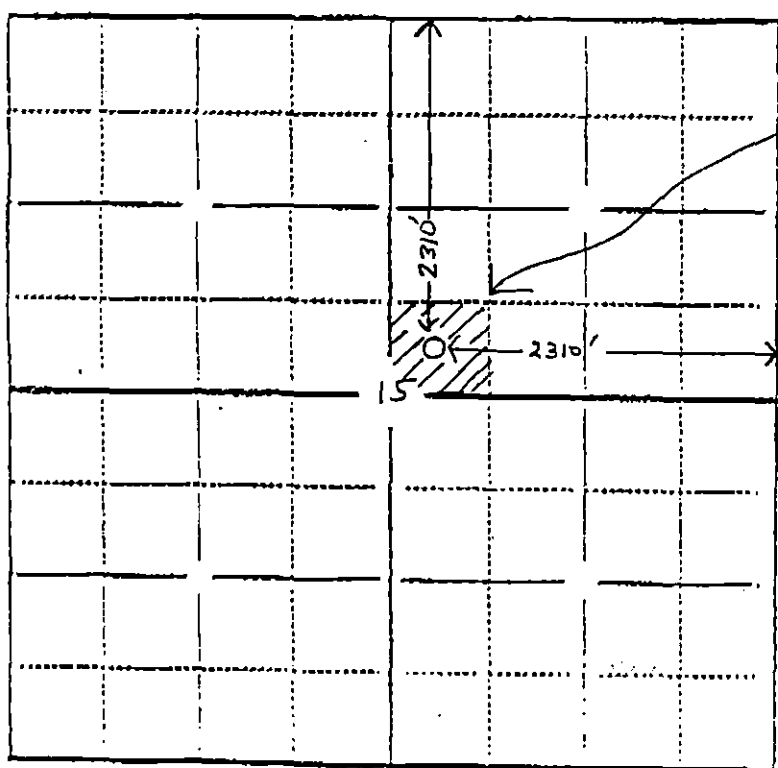

BARTON CO.

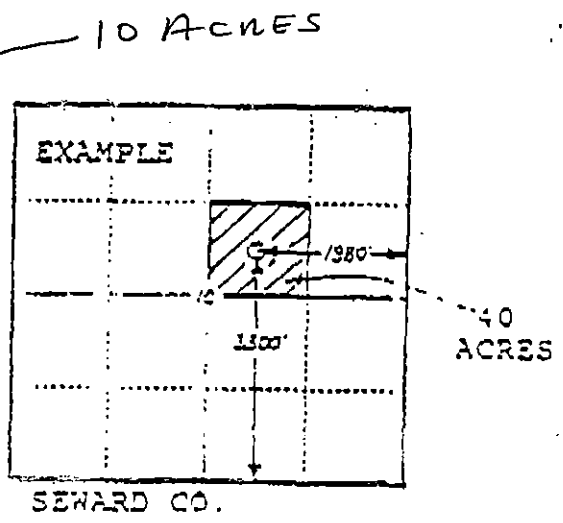

In plotting the proposed location of the well, you must show:

- 1) The manner in which you are using the depicted plat by identifying section lines and sections, 1 section, 1 section with 8 surrounding sections, 4 sections, etc.;
- 2) the distance of the proposed drilling location from the section's east/west lines; and
- 3) the distance to the nearest lease or unit boundary line.

RECEIVED  
DEC 20 1993  
12/20/93  
CONSERVATION DIVISION  
Wichita, Kansas