

STATE OF KANSAS
STATE CORPORATION COMMISSION

Form CP-4

Give All Information Completely
Make Required Affidavit
Mail or Deliver Report to:
Conservation Division
State Corporation Commission
212 No. Market
Wichita, Kansas

WELL PLUGGING RECORD

STAFFORD County, Sec. 20 Twp. 21s Rge. 13 (W)

Location as "NE/CNW/SW" or footage from lines NE NW NE

Lease Owner PETROLEUM, INC.

Lease Name KOOPMAN Well No. 1

Office Address R.R. #2, GREAT BEND, KANSAS

Character of Well (completed as Oil, Gas or Dry Hole) OIL

Date well completed DEC. 19 19 49

Application for plugging filed SEPT. 26 19 68

Application for plugging approved SEPT. 27 19 68

Plugging commenced SEPT. 27 19 68

Plugging completed SEPT. 27 19 68

Reason for abandonment of well or producing formation DEPLETION OF PRODUCING ZONE

If a producing well is abandoned, date of last production MARCH 14 19 68

Was permission obtained from the Conservation Division or its agents before plugging was commenced? YES

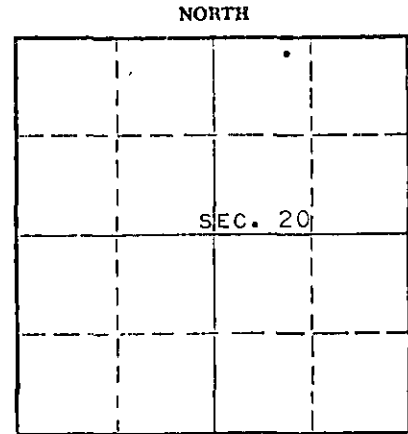

Locate well correctly on above Section Plat

Name of Conservation Agent who supervised plugging of this well R. J. WARREN

Producing formation ARBUCKLE Depth to top Bottom Total Depth of Well 3680 Feet

Show depth and thickness of all water, oil and gas formations.

OIL, GAS OR WATER RECORDS

CASING RECORD

| FORMATION | CONTENT | FROM | TO | SIZE | PUT IN | PULLED OUT |
|-----------|------------------------------|------|----|-------|--------|------------|
| ARBUCKLE | SLIGHT AMOUNT OF OIL & WATER | | | 8-5/8 | 303 | NONE |
| | | | | 5-1/2 | 3674 | NONE |
| | | | | | | |
| | | | | | | |
| | | | | | | |
| | | | | | | |
| | | | | | | |
| | | | | | | |
| | | | | | | |

Describe in detail the manner in which the well was plugged, indicating where the mud fluid was placed and the method or methods used in introducing it into the hole. If cement or other plugs were used, state the character of same and depth placed, from feet to feet for each plug set.

SAND FROM 3674' TO 3650', 5 SACKS CEMENT, HEAVY MUD TO 400', 25'
ROCK BRIDGE FROM 400' TO 375' CEMENT ON TOP OF BRIDGE TO BASE OF
WELL CELLAR.

RECEIVED
STATE CORPORATION COMMISSION
OCT 4 - 1968
CONSERVATION DIVISION
Wichita, Kansas

(If additional description is necessary, use BACK of this sheet)

Name of Plugging Contractor RALPH COMSTOCK PIPE PULLING, INC.,

Address 320 N. PARK. STAFFORD, KANSAS

STATE OF KANSAS, COUNTY OF BARTON, ss. MONTE CHADD (employee of owner) or (owner or operator) of the above-described

well, being first duly sworn on oath, says: That I have knowledge of the facts, statements and matters herein contained and the log of the above-described well as filed and that the same are true and correct. So help me God.

(Signature) Lawrence Proffitt, DIST. PROD. FOREMAN
R. R. #2, GREAT BEND, KANSAS
(Address)

SUBSCRIBED AND SWORN TO before me this 3 day of OCTOBER, 1968

Richard M. Danks Notary Public.

WELL LOG BUREAU - KANSAS GEOLOGICAL SOCIETY
 508 E. Hardeck, Wichita, Kansas

COPY

Company - PETRO., INC.
 Farm - Koopman

No. 1

SEC. 20 T. 21 R. 13W
 NE NW NE

Total Depth. 3679
 Comm. 11-30-49 Comp. 12-14-49
 Shot or Treated.
 Contractor. Stag Drlg. Co.
 Issued. 5-13-50

County. Stafford
 KANSAS

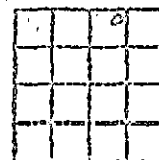

Elevation. _____

Production. Pot. 311 bbls.

CASING:
 8 5/8" surface 303'
 5 1/2" 3675'
 ALL MEASUREMENTS FROM TOP OF ROTARY BUSHING.
 Figures Indicate Bottom of Formations.

| | |
|-------------------------------|------|
| SURFACE gravel | 35 |
| lime sdy & p.t. iron | 55 |
| sand strks. p.t. iron | 118 |
| shale | 150 |
| shale, shells | 220 |
| sand, shale | 301 |
| shells | 303 |
| shale, shells, strks red rock | 410 |
| red bed | 795 |
| anhyd. | 810 |
| shale, shells | 1570 |
| lime, shale | 1710 |
| lime brkn | 1790 |
| lime | 1933 |
| lime, shale | 1957 |
| lime | 1975 |
| lime sdy | 2050 |
| shale, lime | 2715 |
| lime | 3170 |
| lime, sale | 3330 |
| lime | 3590 |
| Viola, chert | 3622 |
| Simpson sand | 3673 |
| lime R.T.D. ? | 3675 |
| Time | 3679 |
| Total Depth | |

RECEIVED
 STATE CORPORATION COMMISSION
 OCT 4 - 1968
 CONSERVATION DIVISION
 Wichita, Kansas

| | |
|------------|------|
| Tops: | |
| Anhyd. | 795 |
| Heebner | 3216 |
| Tornnto | 3233 |
| Brown lime | 3335 |
| Lansing | 3344 |
| Viola | 3590 |
| Simpson | 3619 |
| Arbuckle | 3673 |

D.S.T. 3469-78
 op. 1 hr. rec. 60' oil cut mud.