

STATE OF KANSAS  
STATE CORPORATION COMMISSION

Give All Information Completely  
Make Required Affidavit  
Mail or Deliver Report to:  
Conservation Division  
State Corporation Commission  
211 No. Broadway  
Wichita, Kansas

WELL PLUGGING RECORD

NORTH

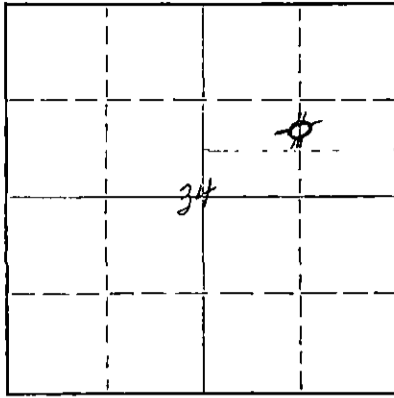

Locate well correctly on above  
Section Plat

Stafford County. Sec. 34 Twp. 21 Rge. (E) 12 (W)  
Location as "NE/CNWKSWK" or footage from lines N/2 S/2 NE/4  
Lease Owner Thos. H. Allan and Cooperative Refinery Ass'n.  
Lease Name Siefkes "A" Well No. 2  
Office Address 925 Union Center, Wichita 2, Kansas  
Character of Well (completed as Oil, Gas or Dry Hole) Dry Hole  
Date well completed June 30 19 56  
Application for plugging filed June 30 19 56  
Application for plugging approved June 30 19 56  
Plugging commenced June 30 19 56  
Plugging completed June 30 19 56  
Reason for abandonment of well or producing formation Dry Hole

If a producing well is abandoned, date of last production \_\_\_\_\_ 19\_\_\_\_  
Was permission obtained from the Conservation Division or its agents before plugging was commenced? Yes

Name of Conservation Agent who supervised plugging of this well R. M. Brundage  
~~Bottom~~ formation Conglomerate Depth to top 3568 ~~feet~~ Total Depth of Well 3700 Feet  
Show depth and thickness of all water, oil and gas formations.

OIL, GAS OR WATER RECORDS

CASING RECORD

FORMATION	CONTENT	FROM	TO	SIZE	PUT IN	PULLED OUT
				8 5/8"	250'	None

Describe in detail the manner in which the well was plugged, indicating where the mud fluid was placed and the method or methods used in introducing it into the hole. If cement or other plugs were used, state the character of same and depth placed, from \_\_\_\_\_ feet to \_\_\_\_\_ feet for each plug set.

3700 - 240 Heavy Rotary Mud  
240 - 200 Bridged with 1/3 sack of hulls & 20 sacks of cement  
200 - 38 Heavy Mud  
38 - Surface Bridged with 1/3 sack hulls & 10 sacks of cement

(If additional description is necessary, use BACK of this sheet)

Name of Plugging Contractor Thos. H. Allan  
Address 925 Union Center, Wichita 2, Kansas

STATE OF KANSAS, COUNTY OF SEDGWICK, ss.  
THOS. H. ALLAN (owner or operator) or (owner or operator) of the above-described well, being first duly sworn on oath, says: That I have knowledge of the facts, statements, and matters herein contained and the log of the above-described well as filed and that the same are true and correct. So help me God.

(Signature) Thos. H. Allan  
925 Union Center, Wichita 2, Kansas  
(Address)

SUBSCRIBED AND SWORN TO before me this 3rd day of July, 19 56  
Oris M. Stewart  
Notary Public.

My commission expires June 14, 1958

PLUGGING  
FILE SEC. 34 T. 21 R. 12W  
BOOK PAGE 76 L. 3

7-5-1956  
STATE CORPORATION COMMISSION  
Wichita, Kansas

15.185.11487.0000

8 5/8" @ 250' - 175 Sx

ALLAN & C.R.A. #2 SIEFKES "A"  
N 1/2 S 1/2 NE 1/4 34-21-12W  
Stafford County, Kansas  
COMM: 6/20/56 COMPL: 6/30/56  
CONTRACTOR: Tom Allan  
ELEV: 1854 RB

I.P. D & A

All Depths From Rotary Bushings

0 - 35 Sand & Soil  
 85 Sand  
 150 Sandy Clay  
 170 Gravel  
 250 Red Rock  
 640 Red Beds  
 660 Anhydrite  
 900 Red Shale  
 1100 Shale  
 1400 Salt & Shale  
 1600 Shale & Anhydrite  
 1862 Lime & Shale  
 1892 Cherty Fossiliferous L.  
 1900 Red Shale  
 2200 Lime & Shale  
 2800 Shale & Shells  
 2875 Sand & Shale  
 3139 Lime  
 3144 Black Shale  
 3149 Lime  
 3153 Shale  
 3173 Lime  
 3272 Shale  
 3282 Brown Lime  
 3290 Shale  
 3300 Lime  
 3310 Shale & Lime  
 3330 Lime  
 3335 Cherty Lime  
 3380 Lime  
 3400 Cherty Lime  
 3420 Lime  
 3424 Oolitic Lime  
 3433 Lime  
 3435 Oolitic Lime  
 3451 Lime  
 3455 Oolitic Lime  
 3471 Lime  
 3480 Oolitic - Dk Oil Stained  
 3503 Lime  
 3514 Shale  
 3522 Lime  
 3538 Shale  
 3541 Fine Grain Sandstone  
 3568 Shale  
 3571 Red Mud & V. C. Chert  
 3600 Red Shale  
 3623 Red & Green Shale

3640 Red Mud & V.C. Weathered Chert  
 3689 Red & Green Shale  
 3700 (T.D.) Red Mud & V.C. Weathered Chert

D.S.T. 3471 - 3487  
 10' Dead O.C.M./60 Min.  
 B.H.P. 52#/20 Min.

FORMATIONS:

640 (41214) Top Anhydrite  
 1892 (-38) Base F. F.  
 3139 (-1285) Top Heebner  
 3272 (-1418) Top Brown Lime  
 3290 (-1436) Top Lansing  
 3568 (-1714) Top Conglomerate

I certify that the above is a true and correct copy of the well log on the above test.

Tom Allan

Subscribed and sworn to before me this 3rd day of July, 1956

Ocie M. Stewart  
Notary Public

My Commission expires June 14, 1958.

PLUGGING			
FILE	SEC	34 T 21	212W
BOOK	PAGE	76	LINE 3