

STATE OF KANSAS
STATE CORPORATION COMMISSION

Give All Information Completely
Make Required Affidavit
Mail or Deliver Report to:
Conservation Division
State Corporation Commission
211 No. Broadway
Wichita, Kansas

WELL PLUGGING RECORD

STAFFORD County, Sec. 28 Twp. 21S Rge. 14W (W)

Location as "NE/CNW/SW" or footage from lines SW NW SW

Lease Owner PETROLEUM, INC.

Lease Name SMITH "A-F" Well No. 1

Office Address ROUTE 2, GREAT BEND, KANSAS

Character of Well (completed as Oil, Gas or Dry Hole) DRY HOLE

Date well completed SEPTEMBER 18 19 61

Application for plugging filed SEPTEMBER 18 19 61

Application for plugging approved SEPTEMBER 18 19 61

Plugging commenced SEPTEMBER 18 19 61

Plugging completed SEPTEMBER 18 19 61

Reason for abandonment of well or producing formation NO PRODUCIBLE ZONES.

If a producing well is abandoned, date of last production NONE 19

Was permission obtained from the Conservation Division or its agents before plugging was commenced? YES

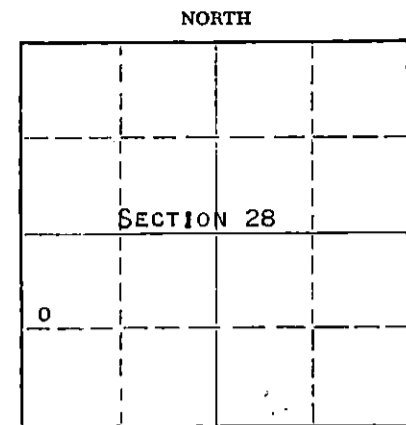

Locate well correctly on above Section Plat

Name of Conservation Agent who supervised plugging of this well FRED W. HAMPEL

Producing formation Depth to top Bottom Total Depth of Well 3830 Feet

Show depth and thickness of all water, oil and gas formations.

OIL, GAS OR WATER RECORDS

CASING RECORD

FORMATION	CONTENT	FROM	TO	SIZE	PUT IN	PULLED OUT
				8-5/8"	260'	NONE

Describe in detail the manner in which the well was plugged, indicating where the mud fluid was placed and the method or methods used in introducing it into the hole. If cement or other plugs were used, state the character of same and depth placed, from feet to feet for each plug set.

MUDDING UP WITH HEAVY MUD TO 240' FOLLOWED BY WOODEN PLUG AND 1/2 SACK HULLS. PLACED 20 SACKS CEMENT THROUGH DRILL PIPE ONTO HULLS. MUDDING UP WITH HEAVY MUD TO 35' FOLLOWED BY WOODEN PLUG, 1/2 SACK HULLS AND 10 SACKS CEMENT TO BASE OF WELL CELLAR.

WASHED DOWN HOLE ON SEPTEMBER 23, 1961, SET 3827' 4 1/2" CASING. PRODUCING FROM SIMPSON SAND.

RECEIVED
STATE CORPORATION COMMISSION

OCT 23 1961

CONSERVATION DIVISION
Wichita, Kansas

10-23-1961

(If additional description is necessary, use BACK of this sheet)

Name of Plugging Contractor GARVEY DRILLING COMPANY

Address ROUTE 2, GREAT BEND, KANSAS

STATE OF KANSAS, COUNTY OF BARTON, ss.

DON SEARLE (employee of owner) or (contractor) of the above-described

well, being first duly sworn on oath, says: That I have knowledge of the facts, statements, and matters herein contained and the log of the above-described well as filed and that the same are true and correct. So help me God.

(Signature) Don Searle

ROUTE 2, GREAT BEND, KANSAS

(Address)

SUBSCRIBED AND SWORN TO before me this 20TH day of OCTOBER, 19 61

My commission expires APRIL 14, 1963

Arthur J. Male
Notary Public.



WELL LOG

COMPANY PETROLEUM, INCORPORATED

SEC. 28 T. 21S R. 14W

FARM SMITH "AF" NO. 1

LOC. SW, NW, SW

TOTAL DEPTH 3830'

COUNTY STAFFORD CO., KANSAS

COMM. September 8, 1961 COMP. September 18, 1961

CONTRACTOR GARVEY DRILLING COMPANY

CASING 8-5/8" @ 260' w/225 sax.

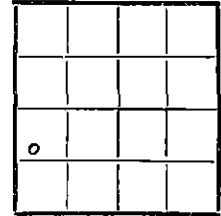

ELEVATION 1944' DF

PRODUCTION D & A

FIGURES INDICATE BOTTOM OF FORMATIONS

260	Surface soil, shale & sand
665	Shale & red bed
865	Red bed & shale
890	Anhydrite
1565	Shale & shells
1820	Shale & lime
3190	Lime & shale
3830	Lime
3830	T. D.

RECEIVED
STATE CORPORATION COMMISSION

OCT 23 1961

CONSERVATION DIVISION
Wichita, Kansas

State of KANSAS }
 County of BARTON } SS

I, VERNE A. MORRIS of GARVEY DRILLING COMPANY

upon oath state the above and foregoing is a true and correct copy of the log of the #1 SMITH "AF" well.

Verne A. Morris

Subscribed and sworn to before me this 19th day of October 1961

My Commission Expires: April 14, 1963

Arthur J. Miles
NOTARY PUBLIC