

15.195.00999.00.00

STATE OF KANSAS  
STATE CORPORATION COMMISSION

WELL PLUGGING RECORD

Give All Information Completely  
Make Required Affidavit  
Mail or Deliver Report to:  
Conservation Division  
State Corporation Commission  
212 North Market, Insurance Bldg.  
Wichita, Kansas

Trego County. Sec. 35 Twp. 14S Rge. (E) 21(W)  
Location as "NE/CNW/SW" or footage from lines SE NW  
Lease Owner JOHN O. FARMER, INC.  
Lease Name HOLTSINGER "B" Well No. 3  
Office Address Russell, Kansas  
Character of Well (completed as Oil, Gas or Dry Hole) Dry  
Date well completed 2/1 1960  
Application for plugging filed 2/1 1960  
Application for plugging approved 2/1 1960  
Plugging commenced 2/1 1960  
Plugging completed 2/1 1960  
Reason for abandonment of well or producing formation Dry

NORTH

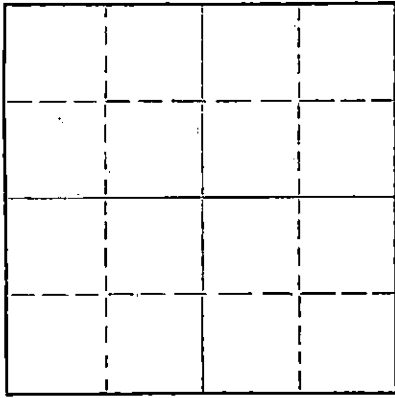

Locate well correctly on above  
Section Plat

If a producing well is abandoned, date of last production 19  
Was permission obtained from the Conservation Division or its agents before plugging was commenced? yes

Name of Conservation Agent who supervised plugging of this well Gilbert Leiker  
Producing formation \_\_\_\_\_ Depth to top \_\_\_\_\_ Bottom \_\_\_\_\_ Total Depth of Well 3865 Feet  
Show depth and thickness of all water, oil and gas formations.

OIL, GAS OR WATER RECORDS

CASING RECORD

FORMATION	CONTENT	FROM	TO	SIZE	PUT IN	PULLED OUT
				8-5/8"	166'	None

Describe in detail the manner in which the well was plugged, indicating where the mud fluid was placed and the method or methods used in introducing it into the hole. If cement or other plugs were used, state the character of same and depth placed, from \_\_\_\_\_ feet to \_\_\_\_\_ feet for each plug set.

150 sacks cement used pump truck - squeezed

RECEIVED  
STATE CORPORATION COMMISSION

FEB 17 1961

CONSERVATION DIVISION  
Wichita, Kansas

2-17-1960

(If additional description is necessary, use BACK of this sheet)

Name of Plugging Contractor JOHN O. FARMER, INC.  
Address Russell, Kansas

STATE OF Kansas, COUNTY OF Russell, ss.  
I, JOHN O. FARMER (owner or operator) of the above-described well, being first duly sworn on oath, says: That I have knowledge of the facts, statements, and matters herein contained and the log of the above-described well as filed and that the same are true and correct. So help me God.

(Signature) John O. Farmer  
Russell, Kansas (Address)

SUBSCRIBED AND SWORN to before me this 8th day of February, 19 60

My commission expires October 11, 1962  
Lucille Kennedy Notary Public.



OPERATOR JOHN O. FARMER, INC.

FORMATION RECORD

Give detailed description and thickness of all formation drilled through, contents of sand, whether dry, water, oil or gas.

ADDRESS Russell, Kansas

WELL NO. 3 COUNTY Trego SEC. 35 TWP 14S. RGE. 21W

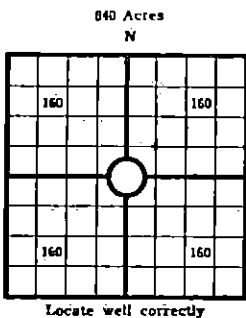

840 Acres  
N  
COUNTY Trego, SEC. 35, TWP. 14S, RGE. 21W  
COMPANY OPERATING JOHN O. FARMER, INC.  
OFFICE ADDRESS Russell, Kansas  
DRILLING STARTED 1/21/60, DRILLING FINISHED 2/1, 19 60  
DATE OF FIRST PRODUCTION \_\_\_\_\_ COMPLETED \_\_\_\_\_  
WELL LOCATED SE  $\frac{1}{4}$  NW  $\frac{1}{4}$  \_\_\_\_\_ North of South  
Line and \_\_\_\_\_ ft. East of West Line of Quarter Section  
Elevation (Relative to sea level) DERRICK FLOOR 2089 GROUND 2087  
CHARACTER OF WELL (Oil, gas or dryhole) \_\_\_\_\_

OIL OR GAS SANDS OR ZONES

Name	From	To	Name	From	To
1			4		
2			5		
3			6		

Perforating Record If Any

Shot Record

Formation	From	To	No. of Shots	Formation	From	To	Size of Shot

CASING RECORD

Amount Set						Amount Pulled		Packer Record	
Size	Wt.	Thds.	Make	Ft.	In.	Ft.	In.	Size	Length
* $\frac{3}{8}$									
8-5/8				166					

Liner Record: Amount \_\_\_\_\_ Kind \_\_\_\_\_ Top \_\_\_\_\_ Bottom \_\_\_\_\_

CEMENTING AND MUDDING

Size	Amount Set		Sacks Cement	Chemical		Method of Cementing	Amount	Mudding Method	Results (See Note)
	Ft.	In.		Gal.	Make				
8-5/8	166		135						

Note: What method was used to protect sands if outer strings were pulled? \_\_\_\_\_

NOTE: Were bottom hole plugs used? \_\_\_\_\_ If so, state kind, depth set and results obtained \_\_\_\_\_

TOOLS USED

Rotary Tools were used from \_\_\_\_\_ feet to \_\_\_\_\_ feet  
Cable tools were used from \_\_\_\_\_ feet to \_\_\_\_\_ feet, and from \_\_\_\_\_ feet to \_\_\_\_\_ feet, and from \_\_\_\_\_ feet to \_\_\_\_\_ feet

Type Rig \_\_\_\_\_

INITIAL PRODUCTION TEST

Describe initial test: whether by flow through tubing or casing or by pumping \_\_\_\_\_

Amount of Oil Production \_\_\_\_\_ bbls. Size of choke, if any \_\_\_\_\_ Length of test \_\_\_\_\_ Water

Production \_\_\_\_\_ bbls. Gravity of oil \_\_\_\_\_ Type of Pump if pump is used, describe \_\_\_\_\_

Formation	Top	Bottom	Formation	Top	Bottom
Surface	0	75	FARM NAME:		
Shale	75	625	HOLTSINGER "B" #3		
Shale & sand & redbed	625	1225	ELEVATION: 2091 RB		
Shale	1225	1400	TOPS: SAMPLE & LOG SAME		
Shale & redbed	1400	1405	Anhydrite		1405
Anhydrite	1405	1446	Heebner		3380
Shale & shells	1446	1800	Toronto		3400
Shale & lime	1800	2290	Lansing		3420
Lime & shale	2290	2365	B/KC		3668
Shale & lime	2365	2525	Marmaton chert		3756
Lime & shale	2525	2620	Cherokee sand		3818
Shale & lime	2620	2830	T.D.		3865
Lime & shale	2830	2950			
Shale & lime	2950	3175	D & A		
Lime & shale	3175	3290			
Shale & lime	3290	3440			
Lime & shale	3440	3790			
Cong. cherty	3790	3860			
Lime & chert	3860	3865			
T.D.		3865			

FEB 17 1960  
CONSERVATION DIVISION  
Wichita Kansas

I, the undersigned, being first duly sworn upon oath, state that this well record is true, correct and complete according to the records of this office and to the best of my knowledge and belief.

John O. Farmer President  
Name and title of representative of company

Subscribed and sworn to before me this 8th day of February, 1960

My Commission expires 10/11/62  
Notary Public.