

Give All Information Completely
Make Required Affidavit
Mail or Deliver Report to:
Conservation Division
State Corporation Commission
212 North Market, Insurance Bldg.
Wichita, Kansas

WELL PLUGGING RECORD

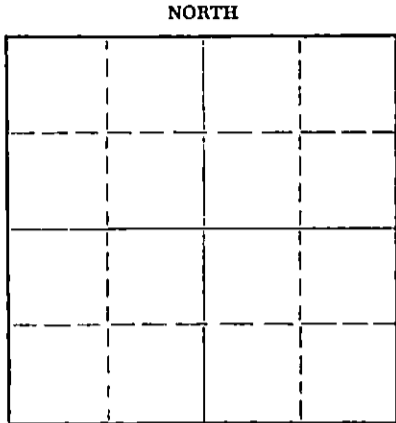

Locate well correctly on above Section Plat

Trego County. Sec. 21 Twp. 14s Rge. 21w (E) (W)
Location as "NE/CNWxSWx" or footage from lines NE, NE, NW,
Lease Owner John O. Farmer, Inc.
Lease Name Augustine "B" Well No. 1
Office Address P.O. Box 352, Russell, Kansas
Character of Well (completed as Oil, Gas or Dry Hole) Dryhole
Date well completed 10/16 1968
Application for plugging filed 10/17 1968
Application for plugging approved 10/17 1968
Plugging commenced 10/17 1968
Plugging completed 1:30 P.M. 10/17 1968
Reason for abandonment of well or producing formation _____

If a producing well is abandoned, date of last production _____ 19____
Was permission obtained from the Conservation Division or its agents before plugging was commenced? Yes

Name of Conservation Agent who supervised plugging of this well W. L. Nichols, Morland, Kansas
Producing formation _____ Depth to top _____ Bottom _____ Total Depth of Well 3982 Feet
Show depth and thickness of all water, oil and gas formations.

OIL, GAS OR WATER RECORDS

CASING RECORD

FORMATION	CONTENT	FROM	TO	SIZE	PUT IN	PULLED OUT

Describe in detail the manner in which the well was plugged, indicating where the mud fluid was placed and the method or methods used in introducing it into the hole. If cement or other plugs were used, state the character of same and depth placed, from _____ feet to _____ feet for each plug set.

Plug # 1 800' 100 sx. cement
Plug # 2 180' 20 sx. cement
Plug # 3 40's 10 sx. cement
Completed: 1:30 P.M. W. L. Nichols State Plugger

RECEIVED
STATE CORPORATION COMMISSION
OCT 22 1968
CONSERVATION DIVISION
Wichita, Kansas

(If additional description is necessary, use BACK of this sheet)
Name of Plugging Contractor John O. Farmer, Inc.
Address P.O. Box 352, Russell, Kansas

STATE OF KANSAS, COUNTY OF RUSSELL, ss.
JOHN O. FARMER, president (employee of owner) or (owner or operator) of the above-described well, being first duly sworn on oath, says: That I have knowledge of the facts, statements, and matters herein contained and the log of the above-described well as filed and that the same are true and correct. So help me God.

(Signature) John O. Farmer
P.O. Box 352, Russell, Kansas
(Address)

Subscribed and sworn to before me this 18th day of October, 1968

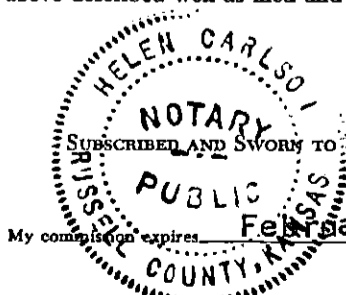

Helen Carlson
Notary Public.

OPERATOR John O. Farmer, Inc.

ADDRESS Box 352, Russell, Ks.

FORMATION RECORD

Give detailed description and thickness of all formation drilled through, contents of sand, whether dry, water, oil or gas.

FARM NAME AUGUSTINE "B" WELL NO. 1 COUNTY Trego SEC. 21 TWP. 14S RGE. 21W

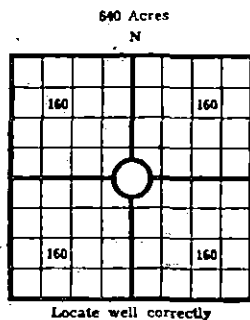

640 Acres
N

COUNTY Trego SEC. 21 TWP. 14S RGE. 21W
COMPANY OPERATING John O. Farmer, Inc.
OFFICE ADDRESS Box 352, Russell, Ks.
DRILLING STARTED 10/6, 1968 DRILLING FINISHED 0/17, 1968
DATE OF FIRST PRODUCTION _____ COMPLETED _____
WELL LOCATED NE 1/4 NE 1/4 NE 1/4, North of South
Line and _____ ft. East of West Line of Quarter Section
Elevation (Relative to sea level) DERRICK FLOOR 2163 GROUND 2160
CHARACTER OF WELL (Oil, gas or dryhole) Dryhole

OIL OR GAS SANDS OR ZONES

Name	From	To	Name	From	To
1			4		
2			5		
3			6		

Perforating Record If Any

Shot Record

Formation	From	To	No. of Shots	Formation	From	To	Size of Shot

CASING RECORD

Amount Set						Amount Pulled		Packer Record			
Size	Wt.	Thds.	Make	Ft.	In.	Ft.	In.	Size	Length	Depth Set	Make

Liner Records: Amount _____ Kind _____ Top _____ Bottom _____

CEMENTING AND MUDDING

Size	Amount Set		Sacks Cement	Chemical		Method of Cementing	Amount	Mudding Method	Results (See Note)
	Ft.	In.		Gal.	Make				
8 5/8"	154'	115	sx.						

Note: What method was used to protect sands if outer strings were pulled?

NOTE: Were bottom hole plugs used? _____ If so, state kind, depth set and results obtained

TOOLS USED

Rotary Tools were used from 0 feet to R.T.D. Cable tools were used from _____ feet to _____ feet, and from _____ feet to _____ feet, and from _____ feet to _____ feet, and from _____ feet to _____ feet.

Type Rig Rotary

INITIAL PRODUCTION TEST

Describe initial test: whether by flow through tubing or casing or by pumping _____

Amount of Oil Production _____ bbls. Size of choke, if any _____ Length of test _____ Water Production _____ bbls. Gravity of oil _____ Type of Pump if pump is used, describe _____

Formation	Top	Bottom	Formation	Top	Bottom
Surface		160			
Sand shale	160	930			
Shale sand	930	1150			
Shale	1150	1520			
Anhydrite	1520	1555			
Shale shells	1555	2320			
Shale lime	2320	2580			
Lime shale	2580	2970			
Shale lime	2970	3380			
Lime shale	3380	3660			
Lime	3660	3895			
Lime chert	3895	3920			
Lime	3920	3982			
			Log Tops		Top
			Heebner		3480'
			Toronto		3499'
			Lansing		3517'
			Base Kansas City		3768'
			Marmaton		3861'
			Conglomerate		3939'
			Arbuckle		3960'
			Log T.D.		3980'
			R.T.D.		3982'

RECEIVED
STATE CORPORATION COMMISSION
OCT 22 1968
CONSERVATION DIVISION
Wichita, Kansas

I, the undersigned, being first duly sworn upon oath, state that this well record is true, correct and complete according to the records of this office and to the best of my knowledge and belief.

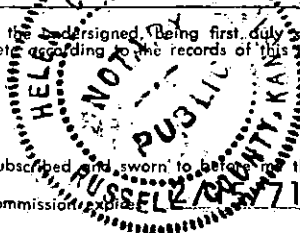

John O. Farmer
Name and title of representative of company
President

Subscribed and sworn to before me this 18 day of October, 1968

Helen Carlson
Notary Public.

Helen Carlson