

STATE OF KANSAS
STATE CORPORATION COMMISSION

Form CP-4

Give All Information Completely
Make Required Affidavit
Mail or Deliver Report to:
Conservation Division
State Corporation Commission
212 No. Market
Wichita, Kansas 67202

WELL PLUGGING RECORD

STAFFORD County, Sec. 34 Twp. 21 S. Rge. 14 E. XEX (W)

Location as "NE/CNW/SE/SW" or footage from lines. NW SE NE

Lease Owner PETROLEUM, INC.,

Lease Name HICKMAN L-KC Well No. 2-1

Office Address R.R. #2, GREAT BEND, KANSAS

Character of Well (completed as Oil, Gas or Dry Hole) OIL WELL

Date well completed SEPTEMBER 19 52

Application for plugging filed NOVEMBER 11 19 71

Application for plugging approved NOVEMBER 12 19 71

Plugging commenced NOVEMBER 12 19 71

Plugging completed NOVEMBER 26 19 71

Reason for abandonment of well or producing formation CEASED INJECTION OF FLUID

If a producing well is abandoned, date of last production FEBRUARY 15 19 66

Was permission obtained from the Conservation Division or its agents before plugging was commenced? YES

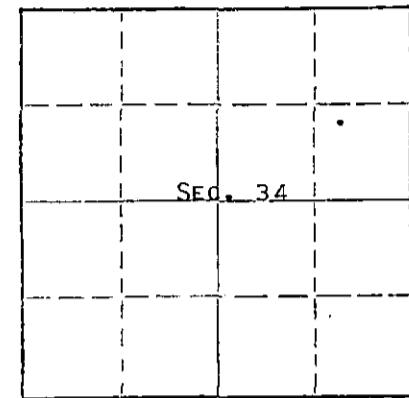

Locate well correctly on above Section Plat

Name of Conservation Agent who supervised plugging of this well G. R. BIBERSTEIN

Producing formation _____ Depth to top _____ Bottom _____ Total Depth of Well 3801 Feet

Show depth and thickness of all water, oil and gas formations.

OIL, GAS OR WATER RECORDS

CASING RECORD

FORMATION	CONTENT	FROM	TO	SIZE	PUT IN	PULLED OUT
	SMALL AMOUNT OF WATER			8-5/8"	UNKNOWN	NONE
				5-1/2"	3798'	263'

Describe in detail the manner in which the well was plugged, indicating where the mud fluid was placed and the method or methods used in introducing it into the hole. If cement or other plugs were used, state the character of same and depth placed, from _____ feet to _____ feet for each plug set.

PLUGGED BACK TOTAL DEPTH 3450', DUMPED SAND FROM 3450' TO 3425', 5 SACKS CEMENT FROM 3425' TO 3385'. GLOBE OILWELL CEMENTING, INC., PUMPED 2 SACKS OF HULLS, 15 SACKS GEL AND 100 SACKS CEMENT TO BASE OF WELL CELLAR.

STATE RECEIVED
CONSERVATION COMMISSION
DEC 7 1971
WICHITA, KANSAS

12-7-1971

(If additional description is necessary, use BACK of this sheet)

Name of Plugging Contractor SANTA FE PIPE & SUPPLY, INC.,

Address BOX 562, GREAT BEND, KANSAS

STATE OF KANSAS, COUNTY OF BARTON, ss.

MONTE CHADDA (employee of owner) or (owner or operator) of the above-described well, being first duly sworn on oath, says: That I have knowledge of the facts, statements, and matters herein contained and the log of the above-described well as filed and that the same are true and correct. So help me God. MONTE CHADDA, DIST. PROD. SUPT.

(Signature) *Monte Chadda*

R.R. #2, GREAT BEND, KANSAS

(Address)

SUBSCRIBED AND sworn to before me this 6 day of DECEMBER, 19 71

Richard H. Deemler
Notary Public.

My commission expires MAY 28, 1973