

STATE OF KANSAS  
STATE CORPORATION COMMISSION

Form CP-4

Give All Information Completely  
Make Required Affidavit  
Mail or Deliver Report to:  
Conservation Division  
State Corporation Commission  
212 No. Market  
Wichita, Kansas 67202

WELL PLUGGING RECORD

STAFFORD County, Sec. 34 Twp. 21 S Rge. 14 K&X (W)

Location as "NE/CNW&SW" or footage from lines. SW NW NE

Lease Owner PETROLEUM, INC.,

Lease Name HICKMAN L-KG UNIT Well No. 1-2

Office Address R.R. #2, GREAT BEND, KANSAS

Character of Well (completed as Oil, Gas or Dry Hole) OIL WELL

Date well completed APRIL 3 19 51

Application for plugging filed OCTOBER 13 19 71

Application for plugging approved OCTOBER 14 19 71

Plugging commenced OCTOBER 21 19 71

Plugging completed NOVEMBER 26 19 71

Reason for abandonment of well or producing formation DEPLETION OF COMMERCIAL ZONE

If a producing well is abandoned, date of last production OCTOBER 8 19 71

Was permission obtained from the Conservation Division or its agents before plugging was commenced? YES

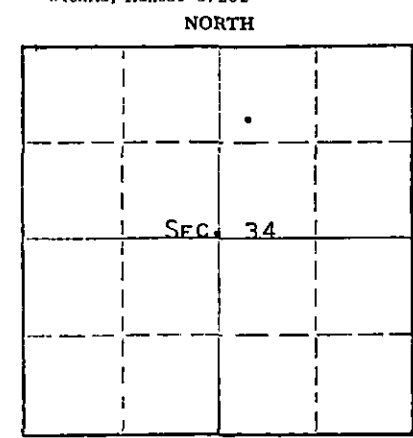

Locate well correctly on above Section Plat

Name of Conservation Agent who supervised plugging of this well G. R. BIBERSTEIN

Producing formation KANSAS CITY Depth to top Bottom Total Depth of Well 3800' Feet

Show depth and thickness of all water, oil and gas formations.

OIL, GAS OR WATER RECORDS

CASING RECORD

FORMATION	CONTENT	FROM	TO	SIZE	PUT IN	PULLED OUT
KANSAS CITY	SMALL AMOUNT			8-5/8"	252'	NONE
	WATER & OIL			5-1/2"	3799'	3084'

Describe in detail the manner in which the well was plugged, indicating where the mud fluid was placed and the method or methods used in introducing it into the hole. If cement or other plugs were used, state the character of same and depth placed, from feet to feet for each plug set.

PLUGGED BACK TOTAL DEPTH 3590'. SANDED HOLE FROM 3590' TO 3520'. DUMPED 5 SACKS CEMENT FROM 3520' TO 3480'. GLOBE OILWELL CEMENTING, INC., PUMPED 2 SACKS OF HULLS, 15 SACKS OF GEL AND 100 SACKS CEMENT TO BASE OF WELL CELLAR.

RECEIVED  
STATE CORPORATION COMMISSION  
DEC 7 1971  
CONSERVATION DIVISION  
Wichita, Kansas

(If additional description is necessary, use BACK of this sheet)

Name of Plugging Contractor SANTA FE PIPE & SUPPLY, INC.,

Address BOX 562, GREAT BEND, KANSAS 67530

STATE OF KANSAS, COUNTY OF BARTON, ss.  
MONTE CHADD (employee of owner) or (owner or operator) of the above-described well, being first duly sworn, deposes and says: That I have knowledge of the facts, statements, and matters herein contained and the log of the above-described well as filed and that the same are true and correct. So help me God.  
MONTE CHADD, DIST. PROD. SUPT.

(Signature)

R.R. #2, GREAT BEND, KANSAS

(Address)

SUBSCRIBED AND SWORN to before me this 6 day of DECEMBER 19 71

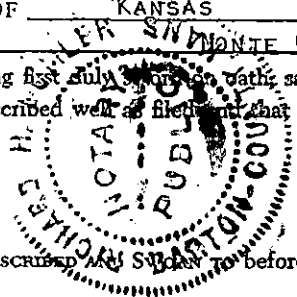

Richard H. Duncanson  
Notary Public.

My commission expires MAY 28, 1973

KANSAS WELL LOG BUREAU-- KANSAS GEOLOGICAL SOCIETY

COPY

508 EAST MURDOCK - WICHITA, KANSAS

COMPANY PETROLEUM, INC

SEC. 34 T. 21 R. 14W  
 LOC. SW NW NE

FARM Smith "A"

NO. 2

1-2

TOTAL DEPTH 3800'

COMM. 3-12-51

COMP. 3-25-51

SHOT OR TREATED

CONTRACTOR Garvey Oil

ISSUED 5-5-51

COUNTY Stafford  
 KANSAS

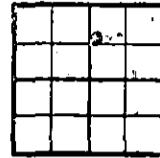

CASING

8-5/8" 238'  
 5 1/2" 3799'

ELEVATION 1942 R. B.

PRODUCTION BHB 1790 bbls.

FIGURES INDICATE BOTTOM OF FORMATIONS

shale	20
sand & shells	230
shale	238
sand	250
red rock & shale	280
soft sand	350
red rock & sand	630
red bed	836
anhydrite	859
shale & shells	1300
salt & shale	1460
shale & shells	1700
lime & shale	2290
shale	2445
shale & shells	2800
shale & lime	3115
lime	3165
lime & shale	3435
lime	3659
shale & sand	3755
shale & sandy lime	3773
arbuckle lime	3800 R. T. D.
Total depth	

Tops:	
Heebner	3275
Brown Lime	3396
Lansing	3405
P. B. C.	3667
Viola	3672
Simpson	3723
Arbuckle	3773

RECEIVED  
 STATE CORPORATION COMMISSION  
 DEC 7 1971  
 CONSERVATION DIVISION  
 Wichita, Kansas