

STATE OF KANSAS
STATE CORPORATION COMMISSION

Give All Information Completely
Make Required Affidavit
Mail or Deliver Report to:
Conservation Division
State Corporation Commission
211 No. Broadway
Wichita, Kansas

15.185.12422.0000

WELL PLUGGING RECORD

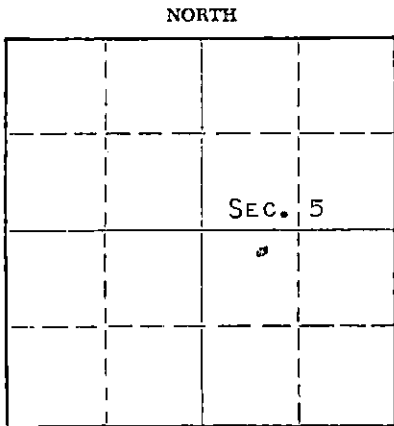

Locate well correctly on above Section Plat

STAFFORD County, Sec. 5 Twp. 21S Rge. 13W (X) (W)
Location as "NE/CNW/SW" or footage from lines NE NW SE
Lease Owner PETROLEUM, INC.
Lease Name NEWCOMBE "G" Well No. 1
Office Address ROUTE 2, GREAT BEND, KANSAS
Character of Well (completed as Oil, Gas or Dry Hole) DRY HOLE
Date well completed APRIL 13, 19 62
Application for plugging filed APRIL 13, 19 62
Application for plugging approved APRIL 13, 19 62
Plugging commenced APRIL 13, 19 62
Plugging completed APRIL 13, 19 62
Reason for abandonment of well or producing formation NO PRODUCIBLE FORMATIONS

If a producing well is abandoned, date of last production ----- 19
Was permission obtained from the Conservation Division or its agents before plugging was commenced? YES

Name of Conservation Agent who supervised plugging of this well W. L. LACKAMP, JR.
Producing formation ----- Depth to top ----- Bottom ----- Total Depth of Well 3329 Feet
Show depth and thickness of all water, oil and gas formations.

OIL, GAS OR WATER RECORDS

CASING RECORD

FORMATION	CONTENT	FROM	TO	SIZE	PUT IN	PULLED OUT
				8-5/8"	323	NONE

Describe in detail the manner in which the well was plugged, indicating where the mud fluid was placed and the method or methods used in introducing it into the hole. If cement or other plugs were used, state the character of same and depth placed, from ----- feet to ----- feet for each plug set.

MUDDED UP WITH HEAVY MUD TO 275' FOLLOWED BY A WOODEN PLUG.
PLACED 20 SACKS OF CEMENT THROUGH DRILL PIPE ON TOP OF THE WOODEN PLUG. MUDDED UP WITH HEAVY MUD TO 35' FOLLOWED BY A WOODEN PLUG. PLACED 10 SACKS OF CEMENT ON TOP OF WOODEN PLUG TO THE BASE OF THE WELL CELLAR.

RECEIVED
STATE CORPORATION COMMISSION

APR 30 1962

CONSERVATION DIVISION
Wichita, Kansas

(If additional description is necessary, use BACK of this sheet)

Name of Plugging Contractor GARVEY DRILLING COMPANY
Address ROUTE 2, GREAT BEND, KANSAS

STATE OF KANSAS, COUNTY OF BARTON, ss.
DON SEARLE (employee of owner) or (XXXXXX) of the above-described well, being first duly sworn on oath, says: That I have knowledge of the facts, statements, and matters herein contained and the log of the above-described well as filed and that the same are true and correct. So help me God.
(Signature) DON SEARLE, DIST. PROD. SUPT.
ROUTE 2, GREAT BEND, KANSAS
(Address)

SUBSCRIBED AND SWORN TO before me this 27TH day of APRIL, 19 62

My commission expires APRIL 14, 1963.

Notary Public.



WELL LOG

15.185.12422.0000

COMPANY PETROLEUM, INCORPORATED

SEC. 5 T. 21S R. 13W

FARM NEWCOMBE "G" NO. 1

LOC. NE, NW, SE

TOTAL DEPTH 3329'

COUNTY STAFFORD CO., KANSAS

COMM. April 8, 1962

COMP. April 13, 1962

CONTRACTOR GARVEY DRILLING COMPANY

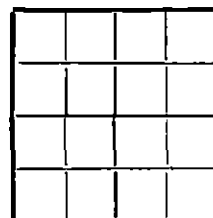

CASING 8-5/8" @ 323' w/225 sax.

ELEVATION 1900' D.F.

PRODUCTION D & A

FIGURES INDICATE BOTTOM OF FORMATIONS

90	Surface sand & shale
130	Hard sand
140	Sand & shale
155	Hard sand
245	Shale
295	Sand w/shale streaks
323	Shale
790	Red bed & shale
815	Anhydrite
1585	Shale & shells
1680	Shale & lime
2140	Lime
2215	Lime & shale
3000	Shale & lime
3329	Lime & shale
3329	T. D.

RECEIVED
 STATE CORPORATION COMMISSION
 Apr 30 1962
 CONSERVATION DIVISION
 Wichita, Kansas

State of KANSAS }
 County of BARTON } SS

I, VERNE A. MORRIS of GARVEY DRILLING COMPANY

upon oath state the above and foregoing is a true and correct copy of the log of the #1 NEWCOMBE "G" well.

Subscribed and sworn to before me this 25th day of April 1962

My Commission Expires: April 14, 1963

Verne A. Morris

Arthur J. Wiles

 NOTARY PUBLIC