

STATE CORPORATION COMMISSION OF KANSAS
OIL & GAS CONSERVATION DIVISION

WELL COMPLETION OR RECOMPLETION FORM
ACO-1 WELL HISTORY

DESCRIPTION OF WELL AND LEASE

Operator: License # 9800
Name Double R Oil Company
Address P.O. Box 506
City/State/Zip McCook, Nebraska 69001

Purchaser

Operator Contact Person Bob Arends
Phone 308 278-2061

Contractor: License # 6394
Name Mohawk Drilling, Inc.

Wellsite Geologist Richard G. Smith
Phone 316 792-2871

Designate Type of Completion
 New Well Re-Entry Workover

Oil SWD Temp Abd
 Gas Inj Delayed Comp.
 Dry Other (Core, Water Supply etc.)

If OWWO: old well info as follows:
Operator
Well Name
Comp. Date Old Total Depth

WELL HISTORY

Drilling Method:
 Mud Rotary Air Rotary Cable
5-3-85 5-8-85 5-9-85
Spud Date Date Reached TD Completion Date
3723'
Total Depth PBTD

Amount of Surface Pipe Set and Cemented at 264 feet
Multiple Stage Cementing Collar Used? Yes No
If yes, show depth set feet
If alternate 2 completion, cement circulated from feet depth to w/ SX cmt

API NO. 15-185-22,214,0000
County Stafford
W/2 NE SW Sec. 23 Twp 21 Rge 12 East West

1980 Ft North from Southeast Corner of Section
3630 Ft West from Southeast Corner of Section
(Note: Locate well in section plat below)

Lease Name Widener East Well # 1

Field Name Sandra

Producing Formation

Elevation: Ground 1843 KB 1853
Section Plat

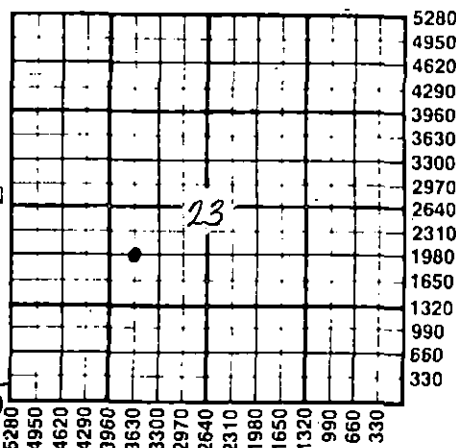

RECEIVED
STATE CORPORATION COMMISSION
JUN 13 1985
6-13-1985

WATER SUPPLY INFORMATION

Disposition of Produced Water: Disposal Repressuring
Docket #

Questions on this portion of the ACO-1 call:
Water Resources Board (913) 296-3717

Source of Water:
Division of Water Resources Permit # T 85-453

Groundwater 1920 Ft North from Southeast Corner
(Well) 3730 Ft West from Southeast Corner of
Sec 23 Twp 21 Rge 12 East West

Surface Water Ft North from Southeast Corner
(Stream, pond etc) Ft West from Southeast Corner
Sec Twp Rge East West

Other (explain)
(purchased from city, R.W.D. #)

INSTRUCTIONS: This form shall be completed in duplicate and filed with the Kansas Corporation Commission, 200 Colorado Derby Building, Wichita, Kansas 67202, within 90 days after completion or recompletion of any well. Rule 82-3-130 and 82-3-107 apply. Information on side two of this form will be held confidential for a period of 12 months if requested in writing and submitted with the form. See rule 82-3-107 for confidentiality in excess of 12 months. One copy of all wireline logs and drillers time log shall be attached with this form. Submit CP-4 form with all plugged wells. Submit CP-111 form with all temporarily abandoned wells.

All requirements of the statutes, rules and regulations promulgated to regulate the oil and gas industry have been fully complied with and the statements herein are complete and correct to the best of my knowledge.

Signature Roger W. P...
Title Sec.-treas. Date 5/24/85

Subscribed and sworn to before me this 24th day of May 1985
Notary Public James H. ...
Date Commission Expires 26 February 1986

K.C.C. OFFICE USE ONLY
F Letter of Confidentiality Attached
C Wireline Log Received
C Drillers Timelog Received
Distribution
 KCC SWD/Rep NGPA
 KGS Plug Other (Specify)

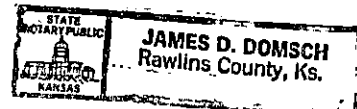

Sec 23 Twp 21 Rge 12

SIDE TWO

Operator Name Double R Oil Company Lease Name Widener East Well # 1

Sec. 23 Twp. 21 Rge. 12 East West County Stafford

WELL LOG

INSTRUCTIONS: Show important tops and base of formations penetrated. Detail all cores. Report all drill stem tests giving interval tested, time tool open and closed, flowing and shut-in pressures, whether shut-in pressure reached static level, hydrostatic pressures, bottom hole temperature, fluid recovery, and flow rates if gas to surface during test. Attach extra sheet if more space is needed. Attach copy of log.

Drill Stem Tests Taken Yes No
 Samples Sent to Geological Survey Yes No
 Cores Taken Yes No

Formation Description
 Log Sample

DST #1 3619-3640 15/45/15/45 times
 very weak blow 1st opening
 no blow second opening - flushed tool
 no results
 Recovered 2 ft oil spotted mud
 IHP 1860
 IFP 32-32
 ICIP 96
 FFP 32-32
 FCIP 75
 FHP 1850

Name	Top	Bottom
Anhydrite	632	+1221
Topeka	2838	- 985
Heebner	3126	-1273
Toronto	3146	-1293
Douglas	3158	-1305
Brown Lime	3260	-1407
Lansing	3280	-1427
Base Kansas City	3500	-1647
Viola	3550	-1697
Simpson	3560	-1707
Arbuckle	3610	-1757
RTD	3723	-1870

DST #2 3619-3723 30/60/30/60 times
 increasing blow to bottom bucket
 1st open
 increasing blow to bottom of bucket
 2nd open
 Recovered 1 ft free oil
 170 ft oil spotted mud
 90 ft watery mud w/oil spots

IHP 1945 FHP 1945
 IFP 75-107 FFP 140-150
 ICIP 1059 FCIP 953

CASING RECORD New Used
 Report all strings set-conductor, surface, intermediate, production, etc.

Purpose of String	Size Hole Drilled	Size Casing Set (In O.D.)	Weight Lbs/Ft.	Setting Depth	Type of Cement	#Sacks Used	Type and Percent Additives
Surface (N)	12 1/4"	8 5/8"	24#	264'	60/40 Poz	225	2% Gel 3% CC

PERFORATION RECORD		Acid, Fracture, Shot, Cement Squeeze Record	
Shots Per Foot	Specify Footage of Each Interval Perforated	(Amount and Kind of Material Used)	Depth

TUBING RECORD Size Set At Packer at Liner Run Yes No

Date of First Production D&A Producing Method Flowing Pumping Gas Lift Other (explain).....

Estimated Production Per 24 Hours	Oil Bbls	Gas MCF	Water Bbls	Gas-Oil Ratio	Gravity

METHOD OF COMPLETION Production Interval

Disposition of gas: Vented Open Hole Perforation
 Sold Other (Specify)
 Used on Lease Dually Completed
 Commingled