

STATE CORPORATION COMMISSION OF KANSAS
OIL & GAS CONSERVATION DIVISION
WELL COMPLETION OR RECOMPLETION FORM
ACO-1 WELL HISTORY
DESCRIPTION OF WELL AND LEASE

API NO. 15-185-22,550-0000
County... Stafford
C.S./2..SE..SW. Sec.23.. Twp.21..Rge.12.. X East West

Operator: License # 6039
Name L. D. Drilling, Inc.
Address R.R. 1 Box 183 B
Great Bend, Kansas 67530
City/State/Zip

330 Ft North from Southeast Corner of Section
3300 Ft West from Southeast Corner of Section
(Note: Locate well in section plat below)

Purchaser Koch Oil Company

Lease Name Austin Well # 1

Field Name Sandra

Operator Contact Person L. D. Davis
Phone (316) 793-3051

Producing Formation Arbuckle

Elevation: Ground 1834 KB 1839

Contractor: License # 6039
Name L. D. Drilling, Inc.

Wellsite Geologist Kim Shoemaker
Phone (316) 682-1537

Designate Type of Completion
X New Well Re-Entry Workover
X Oil SWD Temp Abd
Gas Inj Delayed Comp.
Dry Other (Core, Water Supply etc.)

If OWWO: old well info as follows:
Operator
Well Name
Comp. Date Old Total Depth

RECEIVED
STATE CORPORATION COMMISSION
FEB 2 1989
CONSERVATION DIVISION
Wichita Kansas

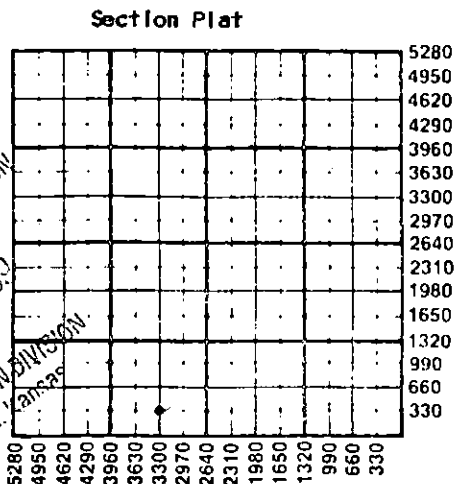

2-2-1989

WATER SUPPLY INFORMATION

Disposition of Produced Water: Disposal
Docket # Repressuring

Questions on this portion of the ACO-1 call:
Water Resources Board (913) 296-3717

Source of Water:
Division of Water Resources Permit #

Groundwater...Ft North from Southeast Corner
(Well) ...Ft West from Southeast Corner of
Sec Twp Rge East West

Surface Water...Ft North from Southeast Corner
(Stream, pond etc)...Ft West from Southeast Corner
Sec Twp Rge East West

Other (explain)...from land owner irrigation well
(purchased from city, R.W.D. #)

WELL HISTORY

Drilling Method:
X Mud Rotary Air Rotary Cable
11-9-88 11-17-88 11-26-88
Spud Date Date Reached TD Completion Date
3716'
Total Depth PBT

Amount of Surface Pipe Set and Cemented at 350 feet
Multiple Stage Cementing Collar Used? Yes No
If yes, show depth set...feet
If alternate 2 completion, cement circulated
from...feet depth to...w/...SX cmt
Cement Company Name
Invoice #

INSTRUCTIONS: This form shall be completed in triplicate and filed with the Kansas Corporation Commission, 200 Colorado Derby Building, Wichita, Kansas 67202, within 120 days of the spud date of any well. Rule 82-3-130, 82-3-107 and 82-3-106 apply. Information on side two of this form will be held confidential for a period of 12 months if requested in writing and submitted with the form. See rule 82-3-107 for confidentiality in excess of 12 months. One copy of all wireline logs and drillers time log shall be attached with this form. Submit CP-4 form with all plugged wells. Submit CP-111 form with all temporarily abandoned wells.

All requirements of the statutes, rules and regulations promulgated to regulate the oil and gas industry have been fully complied with and the statements herein are complete and correct to the best of my knowledge.

Signature L. D. Davis
Title President Date 12-22-88

Subscribed and sworn to before me this 22nd day of December 1988
Notary Public Bessie M. Dewerff
Date Commission Expires 5-20-89

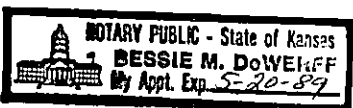

K.C.C. OFFICE USE ONLY
F Letter of Confidentiality Attached
C Wireline Log Received
C Drillers Timelog Received
Distribution
KCC SWD/Rep NGPA
KGS Plug Other
(Specify)
2-2-89
Form ACO-1 (5-86)

Sec 23 Twp 21 Rge 12

Operator Name L. D. Drilling, Inc. Lease Name..... Austin Well #..... 1

Sec...23..... Twp...21..... Rge...12..... East West County..... Stafford.....

WELL LOG

INSTRUCTIONS: Show important tops and base of formations penetrated. Detail all cores. Report all drill stem tests giving interval tested, time tool open and closed, flowing and shut-in pressures, whether shut-in pressure reached static level, hydrostatic pressures, bottom hole temperature, fluid recovery, and flow rates if gas to surface during test. Attach extra sheet if more space is needed. Attach copy of log.

Drill Stem Tests Taken Yes No
 Samples Sent to Geological Survey Yes No
 Cores Taken Yes No

Formation Description
 Log Sample

DST #1 3310-3345 Times: 45-45-45-45
 Blow: 1st open: weak bldg to strong blow through out
 2nd open: weak bldg to strong blow through out
 Recovery: 1055' GIP, 155' vsocm
 IFP: 35-47 FFP: 58-58 ISIP: 766 FSIP: 695

DST #2 3372-3392 Times: 45-45-45-45
 Blow: 1st open: blow of bb
 2nd open: blow of bb
 Recovery: 1320' GIP, 110' O&GCM, 20% oil
 IFP: 23-35 FFP: 34-47 ISIP: 872 FSIP: 801

DST #3 3392-3430 Times: 45-45-45-45
 Blow: 1st Open: blt to bb in 15 min.
 2nd open: off bb through out
 Recovery: 330' GIP: 75' O&GCM, 18% oil
 IFP: 35-35 FFP: 47-47
 ISIP: 896 FSIP: 848

Name	Top	Bottom
Heebner	3102	(-1262)
Toronto	3120	(-1281)
Douglas	3134	(-1295)
Brown Lime	3232	(-1393)
L K/C	3248	(-1409)
B. K/C	3481	(-1642)
Viola	3515	(-1676)
Arbuckle	3603	(-1764)

CASING RECORD <input type="checkbox"/> New <input type="checkbox"/> Used							
Report all strings set-conductor, surface, intermediate, production, etc.							
Purpose of String	Size Hole Drilled	Size Casing Set (In O.D.)	Weight Lbs/Ft.	Setting Depth	Type of Cement	#Sacks Used	Type and Percent Additives
..... Surface	12 1/4"	8 5/8"	20#	350	60/40 Poz	235	2% Gel, 3% C
..... Production	7 7/8"	5 1/2"		3715	50/50 Poz	150	8% salt, .75% 5# Gilsonite
PERFORATION RECORD				Acid, Fracture, Shot, Cement Squeeze Record			
Shots Per Foot	Specify Footage of Each Interval Perforated			(Amount and Kind of Material Used)		Depth	
4 SPF each	3673-3675, 3664-3666, 3659-3661 3618-3620, 3614-3616, 3609-3611			300 gal. 28% NE acid			
TUBING RECORD				Liner Run <input type="checkbox"/> Yes <input type="checkbox"/> No			
Date of First Production		Producing Method					
November 26, 1988		<input type="checkbox"/> Flowing <input checked="" type="checkbox"/> Pumping <input type="checkbox"/> Gas Lift <input type="checkbox"/> Other (explain).....					
Estimated Production Per 24 Hours		Oil	Gas	Water	Gas-Oil Ratio	Gravity	
5 Bbls			MCF	20 Bbls	CFPB		

METHOD OF COMPLETION Vented Open Hole Perforation Solid Other (Specify) 3611-3618
 Used on Lease Dually Completed Commingled

