

15-009-19403-00-00

STATE OF KANSAS
STATE CORPORATION COMMISSION

Form CP-4

Give All Information Completely
Make Required Affidavit
Mail or Deliver Report to:
Conservation Division
State Corporation Commission
211 No. Broadway
Wichita, Kansas

WELL PLUGGING RECORD

Barton County, Sec. 4 Twp. 16s Rge. 3 (E) 13 (W)

Location as "NE/CNW&SW" or footage from lines. C E/2 SE SE
Lease Owner Petroleum, Inc.
Lease Name Schultz 'E' Well No. 1
Office Address Route 2, Great Bend, Kansas 67530
Character of Well (completed as Oil, Gas or Dry Hole) Dry Hole
Date well completed December 3, 1964
Application for plugging filed December 3, 1964
Application for plugging approved December 3, 1964
Plugging commenced December 3, 1964
Plugging completed December 3, 1964
Reason for abandonment of well or producing formation No producible zones

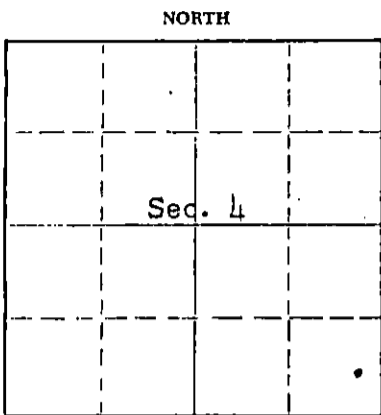

Locate well correctly on above
Section Plat

If a producing well is abandoned, date of last production _____ 19____
Was permission obtained from the Conservation Division or its agents before plugging was commenced? Yes

Name of Conservation Agent who supervised plugging of this well Donald Truan, 634 Sunset, Russell, Kansas
Producing formation _____ Depth to top _____ Bottom _____ Total Depth of Well 3080' Feet
Show depth and thickness of all water, oil and gas formations.

OIL, GAS OR WATER RECORDS

CASING RECORD

FORMATION	CONTENT	FROM	TO	SIZE	PUT IN	PULLED OUT
				8-5/8"	326'	None

Describe in detail the manner in which the well was plugged, indicating where the mud fluid was placed and the method or methods used in introducing it into the hole. If cement or other plugs were used, state the character of same and depth placed, from _____ feet to _____ feet for each plug set.

Mudded up with heavy mud thru drill pipe to 320'
followed by a wooden plug, 1/4 sack hulls and
25 sacks cement. Mudded up with heavy mud to
40' followed by a wooden plug, 1/4 sack hulls
and 10 sacks cement to base of well cellar.

RECEIVED
STATE CORPORATION COMMISSION
DEC 21 1964
12-21-64
CONSERVATION DIVISION
Wichita, Kansas

(If additional description is necessary, use BACK of this sheet)
Name of Plugging Contractor Garvey Drilling Company
Address Route 2, Great Bend, Kansas

STATE OF Kansas, COUNTY OF Barton, ss.
Monte Chadd (employee of owner) or (~~conservation agent~~) of the above-described well, being first duly sworn on oath, says: That I have knowledge of the facts, statements, and matters herein contained and the log of the above-described well as filed and that the same are true and correct. So help me God. Monte Chadd, Dist. prod. Supt.
(Signature) Monte Chadd

Route 2, Great Bend, Kansas 67530
(Address)

Subscribed and Sworn to before me this 16th day of December 19 64

My commission expires October 19, 1968

Notary Public.

WELL LOG

COMPANY Petroleum, Inc

SEC. 4 T.16S R. 13W

FARM Schultz

NO. E-1

LOC. E/2 SE SE

TOTAL DEPTH 3080'

COUNTY Barton

COMM. 11-27-64

COMP. 12-3-64

CONTRACTOR Garvey Drilling Company

CASING 8 5/8" @ 326' w/225 sx

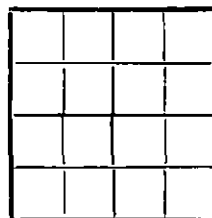

ELEVATION 1898' KB

PRODUCTION D & A

FIGURES INDICATE BOTTOM OF FORMATIONS

120' Surface Clay and Sand
326' Shale
600' Shale and Red Bed
850' Red Bed
885' Anhydrite
1210' Red Bed and Shale
1570' Shale and Shells
1855' Lime
2415' Lime and Shale
2615' Shale and Lime
2750' Lime and Shale
2945' Shale and Lime
3080' Lime
3080' RTD

RECEIVED
STATE CORPORATION COMMISSION

DEC 21 1964

CONSERVATION DIVISION
Wichita, Kansas

State of Kansas }
County of Barton } 83

I, Sam N. Stephens of Garvey Drilling Company

upon oath state the above and foregoing is a true and correct copy of the log of the Schultz E-1 well.

Sam N. Stephens

Subscribed and sworn to before me this 7th day of December 19 64

My Commission Expires: October 19, 1968

Deane P. Freeman
NOTARY PUBLIC