

STATE CORPORATION COMMISSION OF KANSAS
OIL & GAS CONSERVATION DIVISION
WELL COMPLETION OR RECOMPLETION FORM
ACO-1 WELL HISTORY
DESCRIPTION OF WELL AND LEASE

API NO. 15-..... 097-20,670 -00-02
County..... Kiowa
..... NW .. NW .. SW Sec. 11 Twp. 28S. Rge. 16 .. East
..... XX West

Operator: License # 5171
Name TXO Production Corp.
Address 155 N. Market, Suite 1000
City/State/Zip Wichita, Kansas 67202

2310 Ft North from Southeast Corner of Section
4950 Ft West from Southeast Corner of Section
(Note: Locate well in section plat below)

Purchaser..... Permian

Lease Name..... ROSS "F" Well #..... 1
Field Name..... Wellsford

Operator Contact Person Doug Clark
Phone 316 269-7600

Producing Formation..... Bern Limestone

Contractor: License # 5107
Name H-30 Drilling

Elevation: Ground..... 2121' KB..... 2129'

Wellsite Geologist Earl Moore
Phone 316 263-0901

Designate Type of Completion
___ New Well ___ Re-Entry X Workover

___ Oil ___ SWD ___ Temp Abd
X Gas ___ Inj ___ Delayed Comp.
___ Dry ___ Other (Core, Water Supply etc.)

If DWNO: old well info as follows:
Operator
Well Name
Comp. Date Old Total Depth.....

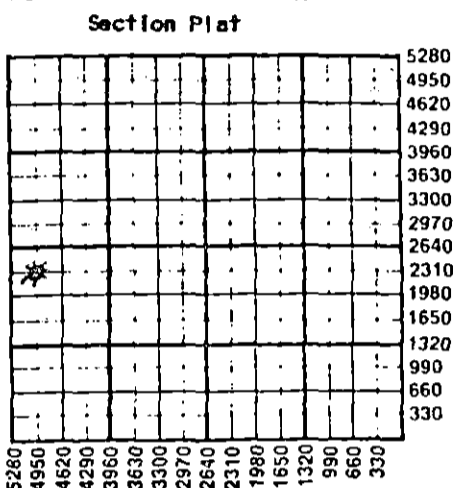

WATER SUPPLY INFORMATION
Disposition of Produced Water: ___ Disposal
Docket # ___ Repressuring

WELL HISTORY

Drilling Method:
X Mud Rotary ___ Air Rotary ___ Cable
8-8-80 8-18-80 8-18-85
Spud Date Date Reached TD Completion Date
4820' 3520' 9-21-80 - Oil
Total Depth PBTD
Amount of Surface Pipe Set and Cemented at.....feet
Multiple Stage Cementing Collar Used? ___ Yes X No
If yes, show depth set.....feet
If alternate 2 completion, cement circulated N/A
from.....feet depth to.....w/.....SX cmt
Cement Company Name
Invoice #

Questions on this portion of the ACO-1 call:
KCC 8-17-86 Water Resources Board (913) 296-3717
Source of Water:
Division of Water Resources Permit #.....
___ Groundwater.....Ft North from Southeast Corner
(Well)Ft West from Southeast Corner of
Sec Twp Rge ___ East ___ West
___ Surface Water.....Ft North from Southeast Corner
(Stream,pond etc).....Ft West from Southeast Corner
Sec Twp Rge ___ East ___ West
___ Other (explain).....
(purchased from city, R.W.D. #)

INSTRUCTIONS: This form shall be completed in triplicate and filed with the Kansas Corporation Commission, 200 Colorado Derby Building, Wichita, Kansas 67202, within 120 days of the spud date of any well. Rule 82-3-130, 82-3-107 and 82-3-106 apply. Information on side two of this form will be held confidential for a period of 12 months if requested in writing and submitted with the form. See rule 82-3-107 for confidentiality in excess of 12 months. One copy of all wireline logs and drillers time log shall be attached with this form. Submit CP-4 form with all plugged wells. Submit CP-111 form with all temporarily abandoned wells.

All requirements of the statutes, rules and regulations promulgated to regulate the oil and gas industry have been fully complied with and the statements herein are complete and correct to the best of my knowledge.

Signature Doug Clark
Title..... District Geologist Date 8-18-86

Subscribed and sworn to before me this 18 day of August 1986.
Notary Public STEPHANIE R. STUBER
Date Commission Expires 8-31-88

K.C.C. OFFICE USE ONLY
F ___ Letter of Confidentiality Attached
C ___ Wireline Log Received
C ___ Drillers Timelog Received
Distribution
✓ KCC ___ SWD/Rep ___ NGPA
✓ KGS ___ Plug ___ Other
(Specify)

Form ACO-1 (5-86)
8-20-86
AUG 20 1986

Sec. 11, Twp. 28 N. Rge. 16 W.

Operator Name TXO Production Corp. Lease Name ROSS "F" Well # 1

Sec. 11 Twp. 28S Rge. 16 East West County Kiowa

WELL LOG

INSTRUCTIONS: Show important tops and base of formations penetrated. Detail all cores. Report all drill stem tests giving interval tested, time tool open and closed, flowing and shut-in pressures, whether shut-in pressure reached static level, hydrostatic pressures, bottom hole temperature, fluid recovery, and flow rates if gas to surface during test. Attach extra sheet if more space is needed. Attach copy of log.

Drill Stem Tests Taken Yes No
 Samples Sent to Geological Survey Yes No
 Cores Taken Yes No

Formation Description
 Log Sample

DST #1, 4630-71' (Cherokee):
 IFP/30"=126-126 psig, GTs in 6", 295 MCFD
 ISIP/60"=254 psig.
 FFP/45"=126-126 psig, 381 MCFD.
 FSIP/90"=254 psig.
 Rec: 90' Mud

Name	Top	Bottom
Herington	2373	- 244
Winfield	2432	- 303
Towanda	2500	- 371
Ft. Riley	2552	- 423
Cottonwood	2870	- 741
Foraker	3025	- 896
Onaga	3150	-1021
Indian Cave	3172	-1043
Waubunsee	3187	-1058
Stotler	3336	-1207
Howard	3540	-1411
Topeka	3644	-1515
Heebner	3992	-1863
Lansing	4150	-2021
Marmaton	4517	-1388
Pawnee	4594	-2465
Cherokee	4632	-2503
Mississippian	4679	-2550
Kinderhook	4702	-2573
Viola	4798	-2669

DST #2, 4681-95' (Mississippi):
 IFP/60"=63-63 psig, GTS in 4", 73 decr. to 12.5 MCFD
 ISIP/60"=591 psig.
 FFP/90"=63-63 psig, 16.7 decr. to 2.3 MCFD.
 FSIP/120"=466 psig.
 Rec: 60' Mud

DST #3, 4696-4710' (Mississippi):
 IFP/30"=63-52 psig, weak blow, died in 15".
 ISIP/60"=73 psig.
 FFP/30"=52-52 psig.
 FSIP/60"=63 psig.
 Rec: 20' Mud

CASING RECORD <input checked="" type="checkbox"/> New <input type="checkbox"/> Used							
Report all strings set-conductor, surface, intermediate, production, etc.							
Purpose of String	Size Hole Drilled	Size Casing Set (In O.D.)	Weight Lbs/Ft.	Setting Depth	Type of Cement	#Sacks Used	Type and Percent Additives
Surface	12-1/4"	8-5/8"		429'		375	
Production	7-7/8"	4-1/2"	10.5	4816 KB		150	

PERFORATION RECORD		Acid, Fracture, Shot, Cement Squeeze Record	
Shots Per Foot	Specify Footage of Each Interval Perforated	(Amount and Kind of Material Used)	Depth
1 JSPE (8 holes)	4/26-30' & 4/18-21'	750 gals 7-1/2% NEA	4726-30' & 4718-21'
2 JSPE (17 holes)	4681-89'	486,000 scf N2 & 20,000# sd	4681-89'
		500 gals 15% HCl	
		571,000 scf N2, 160,000# 20-40 sd	
		7500# 10-20 sd in 70-quality foam (see attached)	

TUBING RECORD	Size	Set At	Packer at	Liner Run	<input type="checkbox"/> Yes <input checked="" type="checkbox"/> No
	2-3/8"	3444'		N/A	

Date of First Production	Producing Method
8-16-86	<input type="checkbox"/> Flowing <input type="checkbox"/> Pumping <input type="checkbox"/> Gas Lift <input type="checkbox"/> Other (explain).....

Estimated Production Per 24 Hours	Oil	Gas	Water	Gas-Oil Ratio	Gravity
	0 BO Bbls	1344 MCFD MCF	0 BWBbls		CFPB

METHOD OF COMPLETION

Production Interval

Disposition of gas: Vented Sold Used on Lease
 Open Hole Perforation Other (Specify)
 Dually Completed Commingled

3470-73'
 (Bern Limestone)

15-097-2067000-02

Ross "F" #1
ACO-1 Attachment
August 18, 1986

Set CIBP @ 4606'
Perfed 3470-73' w/4 JSPF (13 holes)
Treated w/250 gals 15% with additives.

OK
CONF. DIV. WICHITA, KS

8-20-86