

Give All Information Completely  
Make Required Affidavit  
Mail or Deliver Report to:  
Conservation Division  
State Corporation Commission  
211 No. Broadway  
Wichita, Kansas

WELL PLUGGING RECORD

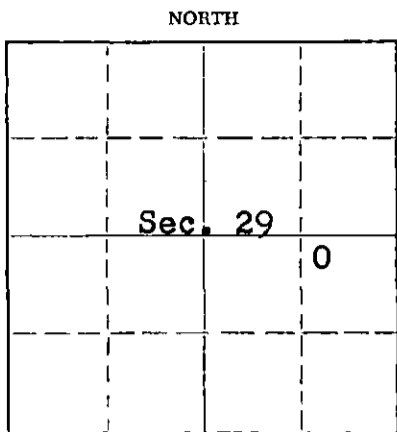

Locate well correctly on above Section Plat

STAFFORD County. Sec. 29 Twp. 21 Rge. 13  W (W)  
Location as "NE/CNW/SW" or footage from lines. NW NE SE  
Lease Owner PETROLEUM, INC.  
Lease Name KELLER "A" Well No. 2  
Office Address ROUTE 2, GREAT BEND, KANSAS  
Character of Well (completed as Oil, Gas or Dry Hole) OIL  
Date well completed October 10, 19 50  
Application for plugging filed March 12, 19 58  
Application for plugging approved March 14, 19 58  
Plugging commenced March 19, 19 58  
Plugging completed March 27, 19 58  
Reason for abandonment of well or producing formation Depletion of producible zones  
If a producing well is abandoned, date of last production Sept. 10 19 57  
Was permission obtained from the Conservation Division or its agents before plugging was commenced? Yes

Name of Conservation Agent who supervised plugging of this well Frank Broadfoot, St. John, Kansas  
Producing formation Kansas City Depth to top 3362' Bottom --- Total Depth of Well 3723 Feet  
Show depth and thickness of all water, oil and gas formations.

OIL, GAS OR WATER RECORDS

CASING RECORD

FORMATION	CONTENT	FROM	TO	SIZE	PUT IN	PULLED OUT
Kansas City	Water and little Oil	3388'	3392'	8-5/8"	212.68'	None
		3381'	3383'	5-1/2"	3766'	2860'

Describe in detail the manner in which the well was plugged, indicating where the mud fluid was placed and the method or methods used in introducing it into the hole. If cement or other plugs were used, state the character of same and depth placed, from \_\_\_\_\_ feet to \_\_\_\_\_ feet for each plug set.

Filled hole with crushed rock from 3723' to 3325' and placed 5 sacks cement on top of rock. Mudded up to 175' and made solid rock bridge at 175', placed 20 sacks cement on top of rock bridge. Mudded up to 35' and made solid rock bridge at 35', filled hole to base of well cellar with 10 sacks cement.

4-10-1958

RECEIVED  
STATE CORPORATION COMMISSION

APR 10 1958

CONSERVATION DIVISION  
Wichita, Kansas

(If additional description is necessary, use BACK of this sheet)  
Name of Plugging Contractor Morgan Well Plugging Service  
Address 102 West 18th Street, Hutchinson, Kansas

STATE OF KANSAS, COUNTY OF BARTON, ss.  
Don Searle (employee of owner) or (~~owner~~) of the above-described well, being first-duly sworn on oath, says: That I have knowledge of the facts, statements, and matters herein contained and the log of the above-described well as filed and that the same are true and correct. So help me God.

(Signature) Don Searle  
Route 2, Great Bend, Kansas  
(Address)

SUBSCRIBED AND SWORN TO before me this 4th day of April, 19 58

Del. T. Besser  
Notary Public.

My commission expires July 11, 1960



PLUGG 3  
FILE SEC 291 21 1/2 W  
BOOK PAGE 896 2

WELL LOG KELLER 'A' #2

Petroleum, Inc., Lease Owner

Section 29, Twp. 21S, Rge. 13W

Carvey Oil, Contractor

Location: NW NE SE

Rotary Total Depth: 3767'

County: Stafford, Kansas

Commenced: September 19, 1950

Elevation: 1907 D.F.

Completed: September 30, 1950

Casing: 207' of 8 5/8"  
3766' of 5 1/2"

Figures below indicate bottom of formation:

		<u>Tops</u>	
50	Surface Clay		
80	Sand		
100	Sand & Shale	772	Schl. Anhydrite
105	Sandstone	3225	Heebner
850	Shale & Shells	3245	Toronto
1720	Lime & Shale	3261	Base Oread
1785	Lime	3349	Br. Lime
1895	Shale & Shells	3362	Lansing
1975	Lime & Shale	3579	B.K.C.
2560	Shale	3620	P.B.C.
2630	Lime & Shale	3622	Viola
2715	Shale & Shells	3671	Simpson sh.
2778	Lime & Shale	3717	Arbuckle
3395	Lime		
3622	Lime & Shale		
3636	Chert		
3670	Shale		
3703	Shale & Lime		
3717	Shale		
3738	Lime		
3767	R.T.D.		

D.S.T. #1, 3379-95, open 1 hr., rec. 120' mud and gas cut oil. BHOP 730#

D.S.T. #2, 3402-55, open 1 hr., rec. 270' slightly oil cut muddy water / 600' oily water / 300' clear water BHOP 1270# in 15 min.

D.S.T. #3, 3505-22, open 1 hr. rec. 1620' water. BHOP 1120# in 15 min.

I hereby certify that this is a true and correct log of the above mentioned well.

PETROLEUM, INC.

<b>PLUGGING</b> FILE SEC 29 T 21 R 13 W BOOK PAGE 29 LINE 2
-------------------------------------------------------------------

STATE OF KANSAS: : SS.  
SEDGWICK COUNTY:

Eric H. Jager

Subscribed to and sworn to before me, a Notary Public in said County and State this 7th day of October, 1950.

Notary Public

My Commission expires: October 27, 1952