

STATE OF KANSAS
STATE CORPORATION COMMISSION

WELL PLUGGING RECORD

Give All Information Completely
Make Required Affidavit
Mail or Deliver Report to
Conservation Division
State Corporation Comm.
245 North Water
Wichita, KS 67202

Stafford County, Sec. 4 Twp. 21S Rge. 14 E/W
Location as "NE/CNW $\frac{1}{4}$ SW $\frac{1}{4}$ " or footage from lines

NE NW NE
Lease Owner C-G DRILLING CO., INC.
Lease Name LANGER Well No. 1
Office Address 1107 DOUGLAS BLDG, WICHITA, KS 67202

Character of Well (Completed as Oil, Gas or Dry Hole)
DRY HOLE

Date Well completed 4/16/80 19
Application for plugging filed 4/16/80 19
Application for plugging approved 4/16/80 19
Plugging commenced 4/16/80 19
Plugging completed 4/16/80 19

Reason for abandonment of well or producing formation
Too low structurally

If a producing well is abandoned, date of last production
19

Was permission obtained from the Conservation Division or
its agents before plugging was commenced? Yes

Name of Conservation Agent who supervised plugging of this well Wm T. Owen

Producing formation Depth to top Bottom Total Depth of Well 3585

Show depth and thickness of all water, oil and gas formations.

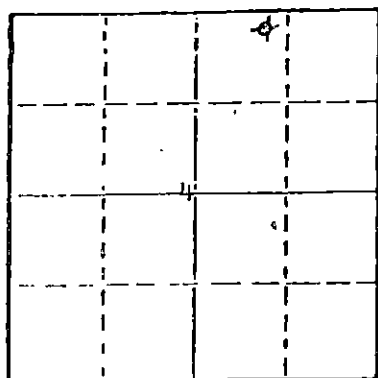

Locate well correctly on above
Section Plot

OIL, GAS OR WATER RECORDS

CASING RECORD

FORMATION	CONTENT	FROM	TO	SIZE	PUT IN	PULLED OUT
				8 5/8"	820.84	None

Describe in detail the manner in which the well was plugged, indicating where the mud fluid was placed and the method or methods used in introducing it into the hold. If cement or other plugs were used, state the character of same and depth placed, from feet to feet for each plug set.

FILLED WITH HEAVY MUD TO 780'. Set
PLUG. PUT IN 50 SXS CEMENT. FILLED
WITH HEAVY MUD TO 40'. SET PLUG.
PUT IN 10 SXS CEMENT. FILL WITH
HEAVY MUD TO TOP WITH 5 SXS CEMENT.

DATE RECEIVED
APR 25 1980
STATE CORPORATION COMMISSION
DIVISION
Wichita, Kansas

(If additional description is necessary, use BACK of this sheet)

Name of Plugging Contractor C-G DRILLING CO., INC.

STATE OF KANSAS COUNTY OF SEDGWICK
G F GALLOWAY (employee of owner) or (owner or operator)

of the above-described well, being first duly sworn on oath, says: That I have knowledge of the facts, statements, and matters herein contained and the log of the above-described well as filed and that the same are true and correct. So help me God.

(Signature) G F Galloway
1107 Douglas Bldg, Wichita, KS 67202
(Address)

SUBSCRIBED AND SWORN TO before me this 21st day of April, 1980

Debra L Heersche
Debra L Heersche Notary Public.

My commission expires March 3, 1984



KANSAS DRILLERS LOG

S. 4 T. 21S R. 14 R
W

API No. 15 — 185 — 21042.0000
County Number

Loc. NE NW NE
County Stafford

Operator
C-G DRILLING CO., INC.

Address
1107 Douglas Bldg, Wichita, KS 67202

Well No. 1 Lease Name Langer

Footage Location
330 feet from (N) (S) line 1650 feet from (E) (W) line

Principal Contractor C-G DRILLING CO., INC. Geologist Jerry JESPERSEN

Spud Date 4/10/80 Total Depth 3585' P.B.T.D.

Date Completed 4/16/80 Oil Purchaser

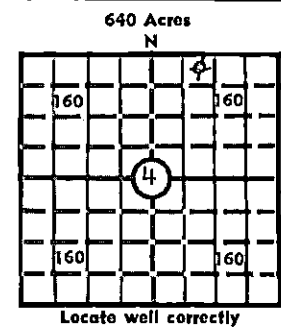

Elev.: Gr. _____
DF _____ KB 1914

CASING RECORD

Report of all strings set — surface, intermediate, production, etc.

Purpose of string	Size hole drilled	Size casing set (in O.D.)	Weight lbs/ft.	Setting depth	Type cement	Sacks	Type and percent additives
SURFACE	12 1/4"	8 5/8"	24#	266'	Common	425	3% CC 2% Gel

LINER RECORD

PERFORATION RECORD

Top, ft.	Bottom, ft.	Sacks cement	Shots per ft.	Size & type	Depth interval

TUBING RECORD

Size	Setting depth	Packer set at

ACID, FRACTURE, SHOT, CEMENT SQUEEZE RECORD

Amount and kind of material used	Depth interval treated

INITIAL PRODUCTION

Date of first production _____ Producing method (flowing, pumping, gas lift, etc.) _____

RATE OF PRODUCTION PER 24 HOURS	Oil	Gas	Water	Gas-oil ratio
	bbls.	MCF	bbls.	CFPB

Disposition of gas (vented, used on lease or sold) _____ Producing interval (s) _____

INSTRUCTIONS: As provided in KCC Rule 82-2-125, within 90 days after completion of a well, one completed copy of this Drillers Log shall be transmitted to the State Geological Survey of Kansas, 4150 Monroe Street, Wichita, Kansas 67209. Copies of this form are available from the Conservation Division, State Corporation Commission, 3830 So. Meridian (P.O. Box 17027), Wichita, Kansas 66217. Phone AC 316-522-2206. If confidential custody is desired, please note Rule 82-2-125. Drillers Logs will be on open file in the Oil and Gas Division, State Geological Survey of Kansas, Lawrence, Kansas 66044.

Operator
C-G DRILLING CO., INC.

DESIGNATE TYPE OF COMP.: OIL, GAS,
DRY HOLE, SWDW, ETC.:
DRY HOLE

Well No. 1 Lease Name LANGER

S 4 T 21S R 14WE W

WELL LOG

Show all important zones of porosity and contents thereof; cored intervals, and all drill-stem tests, including depth interval tested, cushion used, time tool open, flowing and shut-in pressures, and recoveries.

SHOW GEOLOGICAL MARKERS, LOGS RUN, OR OTHER DESCRIPTIVE INFORMATION.

FORMATION DESCRIPTION, CONTENTS, ETC.	TOP	BOTTOM	NAME	DEPTH
ANHYDRITE	810	+1104		
TOPEKA	2832	-918		
HEEBNER	3182	-1268		
TORONTO	3197	-1283		
DOUGLAS	3216	-1302		
BROWN LIME.	3288	-1374		
LANSING	3300	-1386		
B/KANSAS CITY	3524	-1610		
SIMPSON SAND	3535	-1621		
ARBUCKLE	3573	-1659		
RTD	3585			
<p>DST #1: 3524-3545' 15-45-15-45 REC 80' THIN MUD, W/FEW OIL SPOTS IBHP 90#, FBHP 79#, IFP 79#, FFP 79#</p>				

USE ADDITIONAL SHEETS, IF NECESSARY, TO COMPLETE WELL RECORD.

Date Received	<i>Debra Heersche</i>
	Signature
	Debra Heersche, Office Mgr
	Title
	4/23/80
	Date