

15-009-05017-00-00

WELL PLUGGING RECORD

STATE OF KANSAS
STATE CORPORATION COMMISSION

Give All Information Completely
Make Required Affidavit
Mail or Deliver Report to:
Conservation Division
State Corporation Commission
800 Bitting Building
Wichita, Kansas

FORMATION PLUGGING RECORD

Strike out upper line
when reporting plug-
ging off formations.

County Sec. 5 Twp 16 Rge. 13 (E) (W)

Location as "NE $\frac{1}{4}$ NW $\frac{1}{4}$ SW $\frac{1}{4}$ " or footage from lines 18 18 18

Lease Owner W. L. R. Co.

Lease Name Kath... Well No. 1

Office Address State Corporation Commission, 800 Bitting Bldg

Character of Well (completed as Oil, Gas or Dry Hole) oil well

Date well completed Sept 17 1948

Application for plugging filed ordered 19

Application for plugging approved OK 19

Plugging commenced order 1948

Plugging completed Nov 7 1948

Reason for abandonment of well or producing formation Not enough oil

If a producing well is abandoned, date of last production Oct 25 1948

Was permission obtained from the Conservation Division or its agents before plugging was commenced? yes

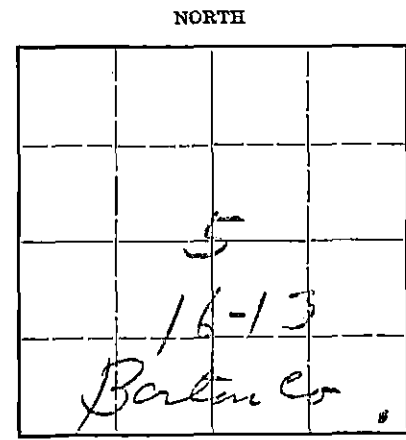

Locate well correctly on above Section Plat

Name of Conservation Agent who supervised plugging of this well C. D. Slough

Producing formation Reddish shale Depth to top 3385 Bottom 3405 Total Depth of Well 3405 Feet

Show depth and thickness of all water, oil and gas formations.

OIL, GAS OR WATER RECORDS

CASING RECORD

Formation	Content	From	To	Size	Put In	Pulled Out
				8 5/8	227'	none
				5 1/2	3385'	2344'

Describe in detail the manner in which the well was plugged, indicating where the mud fluid was placed and the method or methods used in introducing it into the hole. If cement or other plugs were used, state the character of same and depth placed, from _____ feet to _____ feet for each plug set.

Dumped 10 bags of cement in bottom of hole with dump bucket. Filled well with mud to 227' set wood plug at 227' and dumped 15 bags of cement in plug. Filled hole with mud to 3385' with wood plug at 3385' and dumped 10 bags of cement at 3385' cement to bottom of hole.

RECEIVED
STATE CORPORATION COMMISSION
WICHITA, KANSAS

(If additional description is necessary, use BACK of this sheet)

Correspondence regarding this well should be addressed to _____

Address _____

WELL LOG

LEASE: Kosar

ELEVATION: 1930'

WELL NO. 1

LOCATION: SE SE SE Sec. 5-16-13W
Barton County, Kansas

CASING RECORD:

8-5/8" at 227' Cemented
5 1/2" at 3385' Cemented

LEASE OWNER: Delta Production Co.

LEASE OPERATOR: Rapid Drilling Co.

CONTRACTOR: Rapid Drilling Co.

FORMATION

FIGURE INDICATES
BOTTOM OF FORMATION

Surface Soil	35	
Shale Shell Sand	195	
Red Bed and Shells	230	
8-5/8" Casing at 227'		
Cemented w/100 sacks		
Red Bed and Shale	348	
Sand and Shells	490	
Red Bed and Shells	545	
Red Bed	790	
Red Bed and Shells	883	
Anhydrite Lime	918	
Shale and Shells	1325	
Shale and Salt	1550	
Shale and Lime	1785	
Lime	1815	
Shale and Lime	2070	3385
Lime	2105	1130
Shale and Lime	2870	1095
Lime	3035	
Lime Broken	3145	
Top KC 3142		
Lime	3340	
Shale	3385	
Lime	3386	
Top Arbuckle 3385		
5-1/2" Casing at 3385		
Cemented W/150 sacks		
Total Depth Rotary hole 3385'		
Lime	3397	
Drilled w/cable tools 3386 to 3397		
TOTAL DEPTH	<u>3397</u>	

3397

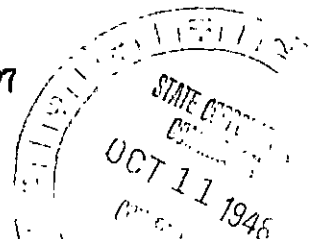

I, Lynn Duke, of the Rapid Drilling Company being first duly sworn on oath, state: That I have Knowledge of the facts, statements and matters herein contained and that the same are true and correct.

Lynn Duke
Vice-Pres. Rapid Drilling Co.

Subscribed and sworn to before me this 8th day of October, 1948.

My Commission Expires: Sept. 7, 1952 Glenn H. Banker
Notary public

WELL LOG

LEASE: Kosar

ELEVATION: 1930'

WELL NO. 1

LOCATION: SE SE SE Sec. 5-16-13W
Barton County, Kansas

CASING RECORD:

8-5/8" at 227' Cemented
5 1/2" at 3385' Cemented

LEASE OWNER: Delta Production Co.

LEASE OPERATOR: Rapid Drilling Co.

CONTRACTOR: Rapid Drilling Co.

FORMATION

FIGURE INDICATES
BOTTOM OF FORMATION

Surface Soil
Shale Shell Sand
Red Bed and Shells
0-5/8" Casing at 227'
Cemented w/100 sacks

Red Bed and Shale
Sand and Shells
Red Bed and Shells
Red Bed

Red Bed and Shells
Anhydrite Lime
Shale and Shells
Shale and Salt
Shale and Lime
Lime

Shale and Lime
Lime
Shale and Lime
Lime
Lime broken
Top KC 3242

Lime
Shale
Lime

Top Arbuckle 3385
5-1/2" Casing at 3385
Cemented w/150 sacks
Total Depth Rotary hole 3385'

Lime
Drilled w/cable tools 3386 to 3405
TOTAL DEPTH

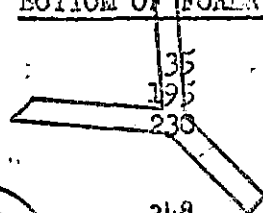

COPY

NOV 21 1948
ST. LOUIS
COMMISSION
101245

I, Lynn Duke, of the Rapid Drilling Company
being first duly sworn on oath, state: That I have knowledge of the
facts, statements and matters herein contained and that the same are
true and correct.

PLUGGING

Vice-Pres. Rapid Drilling Co.

Subscribed and sworn to before me this _____ day of _____, 1948.

My Commission Expires: _____

Notary Public