

STATE OF KANSAS
STATE CORPORATION COMMISSION

WELL PLUGGING RECORD

Give All Information Completely
Make Required Affidavit
Mail or Deliver Report to:
Conservation Division
State Corporation Commission
800 Bittling Building
Wichita, Kansas

Stafford County, Sec. 15 Twp. 21S Rge. (E) 13 (W)

Location as "NE/CNW $\frac{1}{4}$ SW $\frac{1}{4}$ " or footage from lines NW $\frac{1}{4}$ SW $\frac{1}{4}$ SW $\frac{1}{4}$

Lease Owner Skelly Oil Company

Lease Name Charles F. Herb Well No. 1

Office Address Box 1650, Tulsa, Oklahoma

Character of Well (completed as Oil, Gas or Dry Hole) Dry Hole

Date well completed May 31, 1950

Application for plugging filed June 1, 1950

Application for plugging approved June 3, 1950

Plugging commenced June 1, 1950

Plugging completed June 1, 1950

Reason for abandonment of well or producing formation Dry Hole

If a producing well is abandoned, date of last production 19

Was permission obtained from the Conservation Division or its agents before plugging was commenced? Yes (verbally)

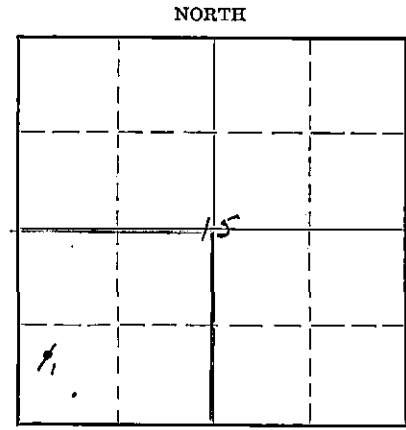

Locate well correctly on above Section Plat

Name of Conservation Agent who supervised plugging of this well Mr. C. D. Stough

Producing formation Depth to top Bottom Total Depth of Well 3745 Feet

Show depth and thickness of all water, oil and gas formations.

OIL, GAS OR WATER RECORDS

CASING RECORD

Formation	Content	From	To	OD Size	Put In	Pulled Out
Arbuckle Lime	Dry	3714'	3745'	8-5/8"	749' 0"	None

Describe in detail the manner in which the well was plugged, indicating where the mud fluid was placed and the method or methods used in introducing it into the hole. If cement or other plugs were used, state the character of same and depth placed, from feet to feet for each plug set.

25 sacks of cement 3745' to 3670'
Mud laden fluid 3670' to 250'
Wood plug 250'
15 sacks of cement 250' to 205'
Mud laden fluid 205' to 30'
Wood Plug 30'
10 sacks of cement 30' to 6'
Surface soil 6' to 0'

RECORDED
INDEXED
JUN 23 1950
STATE CORPORATION COMMISSION
KANSAS

(If additional description is necessary, use BACK of this sheet)

Correspondence regarding this well should be addressed to Skelly Oil Company
Address Box 391
Hutchinson, Kansas

STATE OF Kansas, COUNTY OF Reno, ss.
H. E. Wamsley (employee of owner) of the above-described well,

being first duly sworn on oath, says: That I have knowledge of the facts, statements, and matters herein contained and the log of the above-described well as filed and that the same are true and correct. So help me God.

(Signature) [Signature]
Box 391, Hutchinson, Kansas (Address)

SUBSCRIBED AND SWORN to before me this 22nd day of June, 1950

My commission expires April 7, 1951

[Signature] Notary Public.

PLUGGING
FILE SEC-15T-21R-13W
BOOK PAGE-9-LINE-4

SKELLY OIL COMPANY

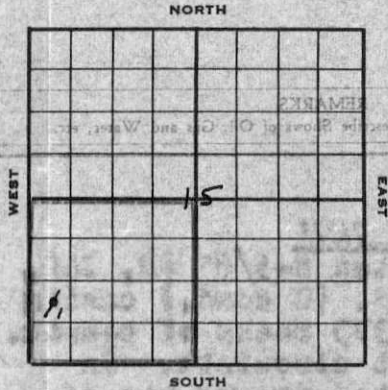

Well Record

Lease Name and No. Chas. F. Herb Well No. 1 Elev. 1887'
 Lease Description SW/4 Section 15-21S-13W
Stafford County, Kansas

Location made May 15, 19 50 by H. G. Coshaw
 feet from North line 990 feet from East line SW/4
 feet from South line 330 feet from West line of Sec. 15

Work com'd 5/17 19 50 Rig com'd 5/18 19 50 Drlg. com'd 5/18 19 50 Drlg. com'd 5/31 19 50

Rig Contractor Claude Wentworth Drilling Co., Inc.

Drilling Contractor Claude Wentworth Drilling Co., Inc., Tulsa, Oklahoma

Rotary Drilling from 0' to 3745' Cable Tool Drilling from _____ to _____

Commenced Producing DRY HOLE 19 _____
 Initial Prod. before shot or acid _____ Bbls.
 Initial Prod. after shot or acid _____ Bbls.

Dry Gas Well Press. _____ Volume _____ Cu. ft.

Casing Head Gas Pressure _____ Volume _____ Cu. ft.

Braden Head (_____ Size) Gas Pressure _____ Volume _____ Cu. ft.

Braden Head (_____ Size) Gas Pressure _____ Volume _____ Cu. ft.

PRODUCING FORMATION DRY HOLE (Name) Top _____ Bottom _____ TOTAL DEPTH 3745'

CASING RECORD

OD Size	Wt.	Thds.	Where Set	PULLED OUT			LEFT IN			KIND	Cond'n	CEMENTING	
				Jts.	Feet	In.	Jts.	Feet	In.			Sacks Used	Method Employed
<u>8-5/8" 24.5</u>	<u>PE</u>	<u>755'</u>					<u>19</u>	<u>749</u>	<u>0</u>	<u>R3 SS</u>	<u>0</u>	<u>375</u>	<u>Halliburton</u>
<u>(8-5/8" casing set 6" in cellar)</u>													

Liner Set at _____ Length _____ Perforated at _____

Liner Set at _____ Length _____ Perforated at _____

Packer Set at _____ Size and Kind _____

Packer Set at _____ Size and Kind _____

SHOT OR ACID TREATMENT RECORD

Date	FIRST		SECOND		THIRD		FOURTH	
	Gals. Qts.	Gals. Qts.	Gals. Qts.	Gals. Qts.	Gals. Qts.	Gals. Qts.	Gals. Qts.	
Shot Between	Ft. and Ft.	Ft. and Ft.	Ft. and Ft.	Ft. and Ft.	Ft. and Ft.	Ft. and Ft.	Ft. and Ft.	
Size of Shell								
Put in by (Co.)								
Length anchor								
Distance below Cas'g								
Damage to Casing or Casing Shoulder								

SIGNIFICANT GEOLOGICAL FORMATIONS

NAME	Top	Bottom	GAS		OIL		REMARKS
			From	To	From	To	
<u>Heobner Shale</u>	<u>3197'</u>						
<u>Toronto Lime</u>	<u>3217'</u>						
<u>Brown Lime</u>	<u>3326'</u>						
<u>Lansing Lime</u>	<u>3340'</u>						
<u>Simpson Shale</u>	<u>3697'</u>						
<u>Arbuckle Lime</u>	<u>3714'</u>						

CLEANING OUT RECORDS

	DATE COMMENCED	DATE COMPLETED	PROD. BEFORE	PROD. AFTER	REMARKS
1st					See Reverse for other details.
2nd					" " " " "
3rd					" " " " "
4th					" " " " "

PLUGGING BACK AND DEEPENING RECORDS

	Date Commenced	Date Completed	No. Feet Plugged Back or Deepened	Prod. Before	Prod. After	REMARKS
1st						See Reverse for other details.
2nd						" " " " "
3rd						" " " " "
4th						" " " " "

(See Reverse for Record of Formation)

RECORD OF FORMATIONS

FORMATION	TOP	BOTTOM	REMARKS
Surface soil, clay and sand	0	57	
Sand and pyrites of iron	57	100	
Red bed and shells	100	747	
Anhydrite	747	755	
<p>Reamed hole to 13-3/8" casing at 755' with 375 sacks of cement. Cement did not circulate. On May 20, cemented around top of 8-5/8" casing with 160 sacks of cement.</p>			
Shale and shells	755	1610	
Line	1610	2065	
Lime and shale	2065	2720	
Shale	2720	2825	
Line	2825	3005	
Broken lime	3005	3090	
Line	3090	3250	
Lime and shale	3250	3325	
Line	3325	3345	
Slightly porous lime	3345	3348	
Line	3348	3381	
Slightly porous lime	3381	3386	
Line	3386	3462	
Porous lime	3462	3473	
Line	3473	3483	
Shale and lime	3483	3515	
Cherty conglomerate	3515	3663	
Red cherty conglomerate	3663	3697	
Cherty shale and sand	3697	3714	
Fine to coarse crystalline dolomite	3714	3724	
Buff, medium fine to coarsely crystalline dolomite	3724	3729	
Grey coarsely crystalline dolomite	3729	3745	

TOTAL DEPTH 3745'

Since no oil or gas in commercial quantity was encountered in drilling to 3745', regular authority was granted to plug and abandon the well.

On June 1, 1950, the well was plugged as follows:

PLUGGING
 FILE SEC 15 T 21 R 13a
 BOOK PAGE 9 LINE 4

25 sacks of cement	3745' to 3670'
fluid mud	3670' to 250'
plug	250'
25 sacks of cement	250' to 202'
fluid mud	202' to 10'
plug	10'
10 sacks of cement	10' to 6'
surface soil	6' to 0'

Plugged and abandoned June 1, 1950

SLOPE TEST DATA: Tests were taken at 250' intervals from 250' to 2120' inclusive, with no deviation from vertical noted.

CLEANING OUT RECORDS

DATE COMMENCED	DATE COMPLETED	PROD. BEFORE	PROD. AFTER	REMARKS
				See Remarks for other details
				"
				"
				"

PLUGGING BACK AND DEEPENING RECORDS

DATE COMMENCED	DATE COMPLETED	PROD. BEFORE	PROD. AFTER	REMARKS
				See Remarks for other details
				"
				"
				"

(See Remarks for Record of Formations)

2120' to 250'
 250' to 10'
 10' to 0'

2120' to 250'
 250' to 10'
 10' to 0'