

SIDE ONE

STATE CORPORATION COMMISSION OF KANSAS
OIL & GAS CONSERVATION DIVISION

WELL COMPLETION OR RECOMPLETION FORM
ACO-1 WELL HISTORY

DESCRIPTION OF WELL AND LEASE

Operator: license # 5198
name A. Scott Ritchie
address 125 N. Market
Suite 950
City/State/Zip Wichita, KS 67202

Operator Contact Person Jake Miller
Phone (316) 267-4375

Contractor: license #
name

Wellsite Geologist none
Phone

PURCHASER MACoCounty Gas

Designate Type of Completion
 New Well Re-Entry Workover

Oil SWD Temp. Abd
 Gas (ORIGINALLY WAS AN OIL WELL) Inj Delayed Comp.
 Dry Other (Core, Water Supply etc.)

old well info as follows:
Operator A. Scott Ritchie
Well Name #1 Unruh
Comp. Date 12-19-75 Old Total Depth 3495' RTD

WELL HISTORY

Drilling Method: Mud Rotary Air Rotary Cable
12/6/75 12/19/75 6/12/85
Spud Date Date Reached TD Completion Date

3495' 3240'
Total Depth PBD

Amount of Surface Pipe Set and Cemented at 160' feet

Multiple Stage Cementing Collar Used? Yes No

If Yes, Show Depth Set feet

If alternate 2 completion, cement circulated from feet depth to w/ SX cmt

API NO. 15- 113-20,320.0000
County McPherson
SE SE NE (location) Sec. 23 Twp. 21S Rge. 2

2970 Ft North from Southeast Corner of Section
330 Ft West from Southeast Corner of Section
(Note: locate well in section plat below)

Lease Name Unruh Well# 1

Field Name Winsinger West

Producing Formation Mississippi Osage

Elevation: Ground KB

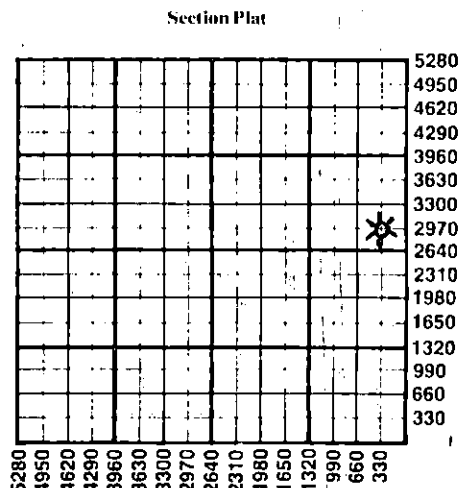

WATER SUPPLY INFORMATION

Source of Water:
Division of Water Resources Permit #
 Groundwater Ft North From Southeast Corner and (Well) Ft. West From Southeast Corner of Sec Twp Rge East West
 Surface Water Ft North From Southeast Corner and (Stream, Pond etc.) Ft West From Southeast Corner Sec Twp Rge East West
 Other (explain) (purchased from city, R.W.D.#)

Disposition of Produced Water: Disposal Repressuring
Docket #

INSTRUCTIONS: This form shall be completed in duplicate and filed with the Kansas Corporation Commission, 200 Colorado Derby Building, Wichita, Kansas 67202, within 90 days after completion or recompletion of any well. Rules 82-3-130 and 82-3-107 apply.
Information on side two of this form will be held confidential for a period of 12 months if requested in writing and submitted with the form. See rule 82-3-107 for confidentiality in excess of 12 months.
One copy of all wireline logs and drillers time log shall be attached with this form. Submit CP-4 form with all plugged wells. Submit CP-111 form with all temporarily abandoned wells.

All requirements of the statutes, rules, and regulations promulgated to regulate the oil and gas industry have been fully complied with and the statements herein are complete and correct to the best of my knowledge.

Signature Jack F. Miller
Title Petroleum Engineer Date 8/22/85

Subscribed and sworn to before me this 22nd day of August 19 85

Notary Public Linda K. Rice
Date Commission Expires 6/07/88

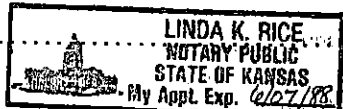

K.C.C. OFFICE USE ONLY
F Letter of Confidentiality Attached
C Wireline Log Received
C Drillers Timelog Received
Distribution
 KCC SWD/Rep NGPA
 KGS Plug Other (Specify)

RECEIVED STATE CORPORATION COMMISSION Form ACO-1 (7-84)

SEP 30 1985 9-30-1985
CONSERVATION DIVISION
Wichita, Kansas

Sec. 23 Twp. 21S Rge. 2

Operator Name A. Scott Ritchie Lease Name _____ Well# _____ SEC _____ TWP _____ RGE _____ East West

WELL LOG

INSTRUCTIONS: Show important tops and base of formations penetrated. Detail all cores. Report all drill stem tests giving interval tested, time tool open and closed, flowing and shut-in pressures, whether shut-in pressure reached static level, hydrostatic pressures, bottom hole temperature, fluid recovery, and flow rates if gas to surface during test. Attach extra sheet if more space is needed. Attach copy of log.

Drill Stem Tests Taken Yes No
 Samples Sent to Geological Survey Yes No
 Cores Taken Yes No

Formation Description
 Log Sample

Name Top Bottom

Original Drill Stem Test results are listed on the 1st ACO-1 form that is attached.

See attached ACO-1 form.

CASING RECORD new used

Report all strings set - conductor, surface, intermediate, production, etc.

Purpose of string	size hole drilled	size casing set (in O.D.)	weight lbs/ft.	setting depth	type of cement	# sacks used	type and percent additives
See attached ACO-1 form.							

PERFORATION RECORD

shots per foot specify footage of each interval perforated

Acid, Fracture, Shot, Cement Squeeze Record

(amount and kind of material used) Depth

2 SSB	2986' to 2990'	Acidized w/250 gal. of MCA with FE sequestering agent	2986'-90'
-------	----------------	---	-----------

TUBING RECORD

size set at packer at Liner Run Yes No

Date of First Production 6/12/85 Producing method flowing pumping gas lift Other (explain)

Estimated Production Per 24 Hours	Oil Bbls	Gas MCF	Water Bbls	Gas-Oil Ratio CFPB	Gravity
		47.4			

Disposition of gas: vented sold used on lease

METHOD OF COMPLETION
 open hole perforation other (specify) _____
 Dually Completed.
 Commingled

PRODUCTION INTERVAL

2986' - 2990'

KANSAS DRILLERS LOG

S. 23 T. 21s R. 2 ^E/_W
 Loc. SE SE NE
 County McPherson

API No. 15 — McPherson — 113-20,320
 County Number

Operator
A. Scott Ritchie

Address
Suite 950, 125 North Market, Wichita, Kansas 67202

Well No. 1 Lease Name Unruh

Footage Location
 feet from (N) (S) line _____ feet from (E) (W) line _____

Principal Contractor Blackstone Drilling, Inc. Geologist Walter Innes Phillips

Spud Date 12-6-75 Total Depth 3495' P.B.T.D. _____

Date Completed 12-19-75 Oil Purchaser NCRA

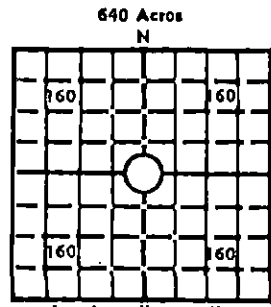

Elev.: Gr. 1487'
 DF 1490' KB 1492'

CASING RECORD

Report of all strings set— surface, intermediate, production, etc.

Purpose of string	Size hole drilled	Size casing set (in O.D.)	Weight lbs/ft.	Setting depth	Type cement	Sacks	Type and percent additives
Surface		8-5/8"		160'		150	
Production		5 1/2"		3414'		175	

LINER RECORD

PERFORATION RECORD

Top, ft.	Bottom, ft.	Sacks cement	Shots per ft.	Size & type	Depth interval
			4	D. P. jets	3338'-3343'

TUBING RECORD

Size	Setting depth	Packer set at

ACID, FRACTURE, SHOT, CEMENT SQUEEZE RECORD

Amount and kind of material used	Depth interval treated
300 gallons 15% intensified acid 2000 gallons 15% NE acid	3338'-3343'

INITIAL PRODUCTION

Date of first production <u>1-14-76</u>	Producing method (flowing, pumping, gas lift, etc.) <u>pumping</u>
RATE OF PRODUCTION PER 24 HOURS	Oil <u>25</u> bbls. Gas <u>0</u> MCF Water _____ bbls. Gas-oil ratio <u>N/A</u> CFPB
Disposition of gas (vented, used on lease or sold) <u>N/A</u>	Producing interval (s) <u>RECEIVED Hunton</u>

STATE CORPORATION COMMISSION

INSTRUCTIONS: As provided in KCC Rule 82-2-125, within 90 days after completion of a well, one completed copy of this Drillers Log shall be transmitted to the State Geological Survey of Kansas, 4150 Monroe Street, Wichita, Kansas 67209. Copies of this form are available from the Conservation Division, State Corporation Commission, 3830 So. Meridian (P.O. Box 17027), Wichita, Kansas 67217. Phone AC 316-522-2206. If confidential custody is desired, please note Rule 82-2-125. Drillers Logs will be on open file in the Oil and Gas Division, State Geological Survey of Kansas, Lawrence, Kansas 66044.

Operator A. Scott Ritchie		DESIGNATE TYPE OF COMP.: OIL, GAS, DRY HOLE, SWDW, ETC.:
Well No. 1	Lease Name Unruh	oil
23 T 21s R 2 W		

WELL LOG

Show all important zones of porosity and contents thereof; cored intervals, and all drill-stem tests, including depth interval tested, cushion used, time tool open, flowing and shut-in pressures, and recoveries.

SHOW GEOLOGICAL MARKERS, LOGS RUN, OR OTHER DESCRIPTIVE INFORMATION.

FORMATION DESCRIPTION, CONTENTS, ETC.	TOP	BOTTOM	NAME	DEPTH
DST #1 2937'-2996' Gas to surface in 6'. On first open period gauged: in 10 min. 106 MCF; 20 min. 137 MCF; 30 min. 137 MCF. On second period open gauged: 10 min. 137 MCF; 20 min. 169 MCF; 30 min. 195 MCF; 40 min. 220 MCF; 50 min. 472 MCF; 60 min. 283 MCF; 65 min. 283 MCF; 70 min. 369 MCF; 75 min. 319 MCF; 80 min. 283 MCF; 85 min. 242 MCF; 90 min. 263 MCF; 95 min. 325 MCF Rec. 355' gas cut mud. IFP: 61-144#/30"; FFP: 102-185#/95" IBHP: 914#/1' ; FBHP: 894#/1'				
DST #2 2986'-3011' Gas to surface in 3". On first open period, gauged: 10 min. 311 MCF; 20 min. 311 MCF; 30 min. 311 MCF. On second open period, gauged: 10 min. 268 MCF; 20 min. 311 MCF; 30 min. 287 MCF; 40 min. 287 MCF; 50 min. 287 MCF. At 50 min. flowed mud to surface; shut in. Rec. 100' gas cut mud and 1000' gas cut muddy water and water. IFP: 246-329#/30"; FFP: 329-493#/50" IBHP: 874#/60"; FBHP: 874#/60"				
DST #3 3330'-3345' Weak steady blow. Rec. 1270' gas in pipe, 40' free oil, 120' very heavily oil cut mud, 60' heavily oil cut mud, 60' oil cut mud. 280' total. IFP: 61-82#/30"; FFP: 61-123#/90" IBHP: 854#/60"; FBHP: 814#/60"; BHT; 106°				
DST #4 3458'-3475' Weak blow. Rec. 15' mud with few specks scum oil. IFP: 41-41#/30"; FFP: 41-61#/20" IBHP: 164#/30"; FBHP: 226#/30"; BHT: 106°				
			<u>ELECTRIC LOG TOPS</u>	
			Lansing	2310' (- 818)
			Mississippi	2954' (-1462)
			Miss. Osage	2985' (-1493)
			Kinderhook	3257' (-1765)
			Misner	3334' (-1842)
			Hunton	3340' (-1848)
			Maquoketa	3350' (-1858)
			Viola	3432' (-1940)
			Simpson	3458' (-1966)
			RTD	3495' (-1993)

USE ADDITIONAL SHEETS, IF NECESSARY, TO COMPLETE WELL RECORD.

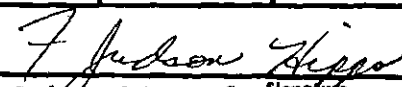
Date Received	
	 F. Judson Higgs for A. Scott Ritchie Geologist
	Title 11-2-77 Date