

STATE CORPORATION COMMISSION OF KANSAS
OIL & GAS CONSERVATION DIVISION
WELL COMPLETION OR RECOMPLETION FORM
ACO-1 WELL HISTORY
DESCRIPTION OF WELL AND LEASE

API NO. 15- Completed 7-11-55

County... Stafford

SW SW NE Sec. 4... Twp. 21... Rge. 13... East West

2970 Ft North from Southeast Corner of Section
2310 Ft West from Southeast Corner of Section
(Note: Locate well in section plat below)

Operator: License # 5238
Name Petroleum, Inc.
Address P.O. Box 1447
City/State/Zip Great Bend, KS, 67530

Lease Name... Sharp

Purchaser... Koch Oil

Field Name... Shaeffer

Operator Contact Person Terry Naylor
Phone 316-793-8471

Producing Formation... L-KC

Elevation: Ground... 1889... KB... 1892

Contractor: License #
Name Hilton Drilg. Co.

Wellsite Geologist... Unknown
Phone

Designate Type of Completion
New Well Re-Entry Workover

Oil SWD Temp Abd
Gas X Inj Delayed Comp.
X Dry Other (Core, Water Supply etc.)

If O/W/O: old well, info as follows:
Operator
Well Name
Comp. Date Old Total Depth

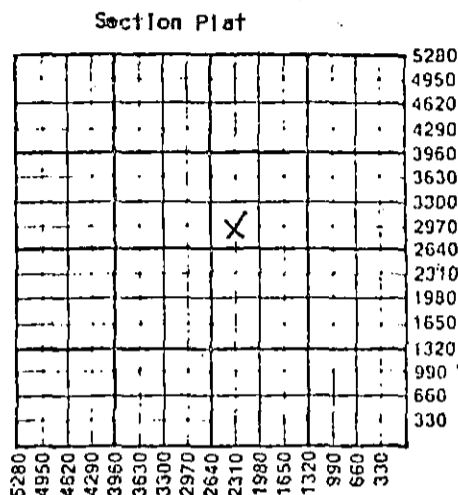

WATER SUPPLY INFORMATION
Disposition of Produced Water: Disposal
Docket # E-11894 X Repressuring

WELL HISTORY

Drilling Method:
X Mud Rotary Air Rotary Cable

6-28-55 7-11-55 9-4-56
Spud Date Date Reached TD Completion Date

3628 3593
Total Depth PBD

Amount of Surface Pipe Set and Cemented at 147 feet
Multiple Stage Cementing Collar Used? Yes X No
If yes, show depth set... feet
If alternate 2 completion, cement circulated from... feet depth to... w/... SX cmt
Cement Company Name
Invoice #

Questions on this portion of the ACO-1 call:
Water Resources Board (913) 296-3717
Source of Water:
Division of Water Resources Permit # NA
Groundwater... Ft North from Southeast Corner (Well) ... Ft West from Southeast Corner of Sec Twp Rge East West
Surface Water... Ft North from Southeast Corner (Stream, pond etc)... Ft West from Southeast Corner Sec Twp Rge East West
Other (explain) (purchased from city, R.W.D. #)

INSTRUCTIONS: This form shall be completed in triplicate and filed with the Kansas Corporation Commission, 200 Colorado Derby Building, Wichita, Kansas 67202, within 120 days of the spud date of any well. Rule 82-3-130, 82-3-107 and 82-3-106 apply. Information on side two of this form will be held confidential for a period of 12 months if requested in writing and submitted with the form. See rule 82-3-107 for confidentiality in excess of 12 months. One copy of all wireline logs and drillers time log shall be attached with this form. Submit CP-4 form with all plugged wells. Submit CP-111 form with all temporarily abandoned wells.

All requirements of the statutes, rules and regulations promulgated to regulate the oil and gas industry have been fully complied with and the statements herein are complete and correct to the best of my knowledge.

Signature Terry Naylor

Title Dist. Prod. Supt. Date 6-26-87

Subscribed and sworn to before me this 26th day of June 1987

Notary Public Juan D. Munz

Date Commission Expires 11-9-88

K.C.C. OFFICE USE ONLY
F Letter of Confidentiality Attached
C Wireline Log Received
C Drillers Timelog Received
Distribution
KCC SWD/Rep NGPA
KGS Plug Other (Specify)

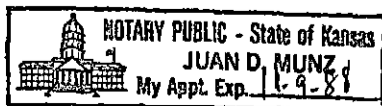

6-30-87

CONSERVATION DIVISION
Wichita, Kansas

Sec. 4, Twp. 21, Rge. 13

Operator Name Petroleum, Inc. Lease Name Sharp Well # 1

Sec. 4 Twp. 21 Rge. 13 East West County Stafford

WELL LOG

INSTRUCTIONS: Show important tops and base of formations penetrated. Detail all cores. Report all drill stem tests giving interval tested, time tool open and closed, flowing and shut-in pressures, whether shut-in pressure reached static level, hydrostatic pressures, bottom hole temperature, fluid recovery, and flow rates if gas to surface during test. Attach extra sheet if more space is needed. Attach copy of log.

Drill Stem Tests Taken Yes No
 Samples Sent to Geological Survey Yes No
 Cores Taken Yes No

Formation Description
 Log Sample

Name Top Bottom

SEE ATTACHED

CASING RECORD <input type="checkbox"/> New <input type="checkbox"/> Used							
Report all strings set-conductor, surface, intermediate, production, etc.							
Purpose of String	Size Hole Drilled	Size Casing Set (In O.D.)	Weight Lbs/Ft.	Setting Depth	Type of Cement	#Sacks Used	Type and Percent Additives
Surface	12 $\frac{1}{2}$	8-5/8		147		175	
Production	7-7/8	5 $\frac{1}{2}$		3628		100	

PERFORATION RECORD		Acid, Fracture, Shot, Cement Squeeze Record	
Shots Per Foot	Specify Footage of Each Interval Perforated	(Amount and Kind of Material Used)	Depth
	3527-31, 3519-23		

TUBING RECORD	Size	Set At	Packer at	Liner Run	<input type="checkbox"/> Yes <input type="checkbox"/> No
P&A					

Date of First Production	Producing Method
P&A	<input type="checkbox"/> Flowing <input type="checkbox"/> Pumping <input type="checkbox"/> Gas Lift <input type="checkbox"/> Other (explain).....

Estimated Production Per 24 Hours	Oil	Gas	Water	Gas-Oil Ratio	Gravity
	Bbls	MCF	Bbls	CFPB	
	P&A				

METHOD OF COMPLETION

Production Interval

Disposition of gas: Vented Open Hole Perforation
 Sold Other (Specify) P&A
 Used on Lease Dually Completed
 Comingled

4-21-13W

WELL LOG BUREAU—KANSAS GEOLOGICAL SOCIETY
508 East Murdock, Wichita, Kansas

Company- HILTON DRILLING CO.
Farm- Sharp No. 1
Shaeffer #3-1

SEC. 4 T. 21 R. 13W
SW SW NE

Total Depth. 3630'
Comm. 6-28-55 Comp. 7-11-55
Shot or Treated.
Contractor.
Issued. 8-11-56

County Stafford
KANSAS

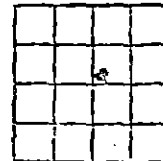

Elevation. 1889' DF

Production. 80 BOPD

CASING:

8 5/8" 147' cem w/175 sx
5 1/2" 3628' cem w/100 sx

Figures indicate Bottom of Formations.

shale, sand	100
shale	140
sand pyrite	175
shale, red rock	730
anhydrite	755
shells, shale, red rock	1300
shells; shale	1515
shells, shale, lime	1650
shale, lime	2950
lime	2975
shale, lime	3015
lime	3200
shale, lime	3373
lime	3630
Total Depth	

Tops: Scout	
Heebner	3150
Lansing	3285
Arbuckle	3580

RECEIVED
STATE CORPORATION COMMISSION

JUN 30 1987

CONSERVATION DIVISION
Wichita, Kansas