

STATE OF KANSAS
STATE CORPORATION COMMISSION
200 Colorado Derby Building
Wichita, Kansas 67202

WELL PLUGGING RECORD
K.A.R.-82-3-117

API NUMBER 15-055-20,384.0000

LEASE NAME Lang

WELL NUMBER 4

3960' Ft. from S Section Line

1320' Ft. from E Section Line

SEC. 22 TWP. 21 RGE. 34 (K) or (W)

COUNTY Finney

Date Well Completed 1-17-80

Plugging Commenced 7-11-91

Plugging Completed 7-16-91

TYPE OR PRINT
NOTICE: Fill out completely
and return to Cons. Div.
office within 30 days.

LEASE OPERATOR Petroleum Production Mgmt. Inc.

ADDRESS 209 E. Williams, Su. 200, Wichita, Ks. 67202

PHONE# (316) 265-4561 OPERATORS LICENSE NO. 6234

Character of Well Gas

(Oil, Gas, D&A, SWD, Input, Water Supply Well)

The plugging proposal was approved on 7-12-1991 (date)

by Mr. Steve Durant (KCC District Agent's Name).

Is ACO-1 filed? yes If not, is well log attached? _____

Producing Formation Towanda Depth to Top 2747' Bottom 2752 T.D. 2755

Show depth and thickness of all water, oil and gas formations.

OIL, GAS OR WATER RECORDS

CASING RECORD

RECEIVED
STATE CORPORATION COMMISSION

Formation	Content	From	To	Size	Put in	Pulled out
Surface				8 5/8"	372'	0'
Production				4 1/2"	2755	1200'

Describe in detail the manner in which the well was plugged, indicating where the mud fluid was placed and the method or methods used in introducing it into the hole. If cement or other plugs were used, state the character of same and depth placed, from ___ feet to ___ feet each set.
Bridge Plug set @ 2,000 - Pump 80 Sk. cement 1150' to 900'
Mud 900' to 400' - Circulate cement 400' to 0' w/110 Sk. cement
Lay down 4 1/2" casing - put bridge & 10 Sk. 40' to 3', Cut off 8 5/8" @ 3' and cap

(If additional description is necessary, use BACK of this form.)

Name of Plugging Contractor MIDWEST CASING PULLING SERVICE License No. 6497

Address Box F, Sublette, Ks. 67877

NAME OF PARTY RESPONSIBLE FOR PLUGGING FEES: Petroleum Production Mgmt. Inc.

STATE OF KANSAS COUNTY OF Haskell, ss.

I, Edgar J. Eyes (Employee of Operator) or (Operator) of above-described well, being first duly sworn on oath, says: That I have knowledge of the facts, statements, and matters herein contained and the log of the above-described well as filed that the same are true and correct, so help me God.

(Signature) Edgar J. Eyes

(Address) Box F, Sublette, Ks. 67877

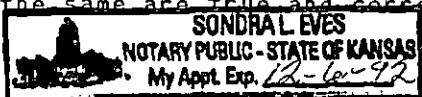

SUBSCRIBED AND SWORN TO before me this 22nd day of July, 1991

Sondra L. Eyes
Notary Public

My Commission Expires: 12-10-92

KANSAS

WELL COMPLETION REPORT AND
DRILLER'S LOG

S. 22 T. 21 R. 34 ^{EX}
W
Loc. C NE/4
County Finney

API No. 15 — 055 — 20,384 .0000
County Number

Operator
THE MAURICE L. BROWN COMPANY

Address
200 Sutton Place, Wichita, Kans. 67202

Well No. 4 Lease Name Lang

Footage Location
1320 feet from (N) (S) line 1320 feet from (E) (W) line

Principal Contractor Abercrombie Drlg, Inc. Geologist Ray Palmer

Spud Date 9-5-79 Date Completed 9-12-79 Total Depth 2755 P.B.T.D. 2710

Directional Deviation _____ Oil and/or Gas Purchaser ?

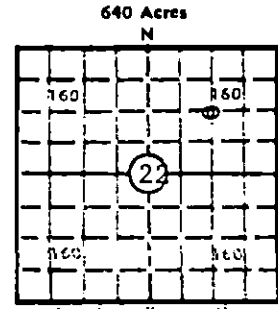

Elev.: Gr. 2958
DF 2963 KR 2965

CASING RECORD

Report of all strings set— surface, intermediate, production, etc.

Purpose of string	Size hole drilled	Size casing set (in O.D.)	Weight lbs/ft.	Setting depth	Type cement	Sacks	Type and percent additives
Surf	12 1/4"	8-5/8"	23#	372	HLC Class H	150 150	3% cc + 1/2# F.C./sk " "
Prod.	7-7/8"	4 1/2"	9 1/2#	2755	HLC 65/35 Pozmix	175 150	10# Gil/sk " " +10% sal

LINER RECORD

PERFORATION RECORD

Top, ft.	Bottom, ft.	Sacks cement	Shots per ft.	Size & type	Depth interval
			3	4 J. J.	2647-2652

TUBING RECORD

Size	Setting depth	Packer set at
2-3/8"	2682	NONE

ACID, FRACTURE, SHOT, CEMENT SQUEEZE RECORD

Amount and kind of material used	Depth interval treated
500 bbl acid Aqua Frac w/15,000# sd.	2647-2652

RECEIVED
STATE CORPORATION COMMISSION
JUN 20 1980

INITIAL PRODUCTION

Date of first production	Producing method (flowing, pumping, gas lift, etc.)	CONSERVATION DIVISION
S.I. Gas well		Wichita, Kansas
RATE OF PRODUCTION PER 24 HOURS	Oil bbls. Gas MCF Water bbls. Gas-oil ratio CFPB	
Disposition of gas (vented, used on lease or sold)	Producing interval (s)	
	2647-2652	

INSTRUCTIONS: As provided in KCC Rule 82-2-125, within 90 days after completion of a well, one completed copy of this Drillers Log shall be transmitted to the State Geological Survey of Kansas, 4150 Monroe Street, Wichita, Kansas 67209. Copies of this form are available from the Conservation Division, State Corporation Commission, 245 No. Water, Wichita, Kansas 67202. Phone AC 316-522-2206. If confidential custody is desired, please note Rule 82-2-125. Drillers Logs will be on open file in the Oil and Gas Division, State Geological Survey of Kansas, Lawrence, Kansas 66044.

Operator THE MAURICE L. BROWN COMPANY		DESIGNATE TYPE OF COMP.: OIL, GAS, DRY HOLE, SWDOW, ETC.:
Well No. 4	Lease Name Lang	Gas
S <u>22</u> T <u>21</u> R <u>34</u> ^{XEC} _W		

WELL LOG

Show all important zones of porosity and contents thereof; cored intervals, and all drill-stem tests, including depth interval tested, cushion used, time tool open, flowing and shut-in pressures, and recoveries.

SHOW GEOLOGICAL MARKERS, LOGS RUN, OR OTHER DESCRIPTIVE INFORMATION.

FORMATION DESCRIPTION, CONTENTS, ETC.	TOP	BOTTOM	NAME	DEPTH
See Attached sheets			BSC	2056 (+ 909)
			Herington	2499 (+ 466)
			Krider	2528 (+ 437)
			Winf.	2577 (+ 388)
			Towanda	2642 (+ 323)
			Ft. Riley	2694 (+ 271)
			TD	2756 (+ 209)

RECEIVED
STATE CORPORATION COMMISSION

JUN 20 1991

CONSERVATION DIVISION
Wichita, Kansas

USE ADDITIONAL SHEETS, IF NECESSARY, TO COMPLETE WELL RECORD.

Date Received	
	Vern Haselhorst Signature
	Drilling Manager Title
	January 8, 1980 Date