

STATE CORPORATION COMMISSION OF KANSAS
OIL & GAS CONSERVATION DIVISION
WELL COMPLETION OR RECOMPLETION FORM
ACO-1 WELL HISTORY
DESCRIPTION OF WELL AND LEASE

API NO. 15-..... Comp. 7-8-50.....
County..... Stafford.....
NW WSW NW Sec. 28.. Twp 21S. Rge. 13.. East
..... West

Operator: License # 5238.....
Name Petroleum, Inc.....
Address P.O. Box 1447.....
City/State/Zip Great Bend, KS, 67530.....

..... Ft North from Southeast Corner of Section
..... Ft West from Southeast Corner of Section
(Note: Locate well in section plat below)

Purchaser..... Koch Oil Co.....
..... Wichita, KS.....

Lease Name..... Hufford 'A'..... Well # 2.....
Field Name..... Hazel South.....

Operator Contact Person .. Monte Chadd.....
Phone 316-793-8471.....

Producing Formation..... Comm.....
Elevation: Ground..... 1904'..... KB..... 1909'.....

Contractor: License # 5238.....
Name

Wellsite Geologist..... James D. Morris.....
Phone.....

Designate Type of Completion
___ New Well ___ Re-Entry X Workover
X Oil ___ SWD ___ Temp Abd
___ Gas ___ Inj ___ Delayed Comp.
___ Dry ___ Other (Core, Water Supply etc.)

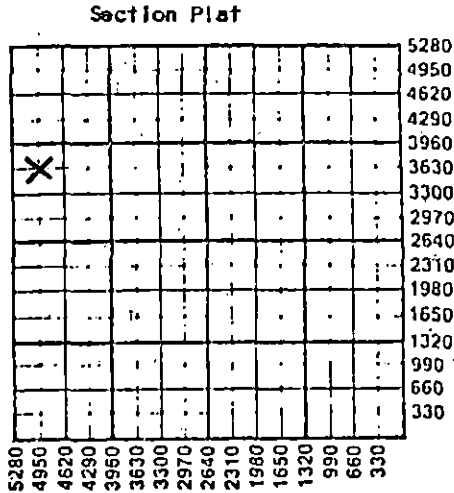

If OWWO: old well info as follows:
Operator,
Well Name,
Comp. Date Old Total Depth.....

WATER SUPPLY INFORMATION

Disposition of Produced Water: X Disposal
Docket # C-2934..... Repressuring

WELL HISTORY

Drilling Method:
X Mud Rotary ___ Air Rotary ___ Cable
6-20-50..... 7-1-50..... 7-8-50.....
Spud Date Date Reached TD Completion Date
3754'..... 3560'.....
Total Depth PBDT

Questions on this portion of the ACO-1 call:
Water Resources Board (913) 296-3717
Source of Water:
Division of Water Resources Permit #.....
Groundwater..... Ft North from Southeast Corner
(Well) Ft West from Southeast Corner of
Sec Twp Rge East West
Surface Water..... Ft North from Southeast Corner
(Stream, pond etc)..... Ft West from Southeast Corner
Sec Twp Rge East West
Other (explain).....
(purchased from city, R.W.D. #)

Amount of Surface Pipe Set and Cemented at 193 feet
Multiple Stage Cementing Collar Used? ___ Yes X No
If yes, show depth set..... feet
If alternate 2 completion, cement circulated
from..... feet depth to..... w/..... SX cmt
Cement Company Name,
Invoice # N/A.....

INSTRUCTIONS: This form shall be completed in triplicate and filed with the Kansas Corporation Commission, 200 Colorado Derby Building, Wichita, Kansas 67202, within 120 days of the spud date of any well. Rule 82-3-130, 82-3-107 and 82-3-106 apply. Information on side two of this form will be held confidential for a period of 12 months if requested in writing and submitted with the form. See rule 82-3-107 for confidentiality in excess of 12 months. One copy of all wireline logs and drillers time log shall be attached with this form. Submit CP-4 form with all plugged wells. Submit CP-111 form with all temporarily abandoned wells.

All requirements of the statutes, rules and regulations promulgated to regulate the oil and gas industry have been fully complied with and the statements herein are complete and correct to the best of my knowledge.

Signature Monte Chadd.....

Title..... Dist. Prod. Supt..... Date 8-28-86.....

Subscribed and sworn to before me this 28th day of August 1986..

Notary Public..... Juan D. Munz.....
Date Commission Expires 11-9-88.....

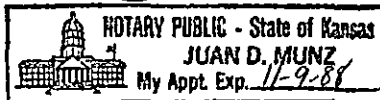

K.C.C. OFFICE USE ONLY
F ___ Letter of Confidentiality Attached
C ___ Wireline Log Received
C ___ Drillers Timelog Received
Distribution
 KCC ___ SWD/Rep ___ NGPA
 KGS ___ Plug ___ Other
(Specify)

Sec 28 Twp 21 Rge 13

Operator Name Petroleum, Inc. Lease Name Hufford 'A' Well # 2

Sec. 28 Twp. 21S Rge. 13 East West County.....

WELL LOG

INSTRUCTIONS: Show important tops and base of formations penetrated. Detail all cores. Report all drill stem tests giving interval tested, time tool open and closed, flowing and shut-in pressures, whether shut-in pressure reached static level, hydrostatic pressures, bottom hole temperature, fluid recovery, and flow rates if gas to surface during test. Attach extra sheet if more space is needed. Attach copy of log.

Drill Stem Tests Taken Yes No
 Samples Sent to Geological Survey Yes No
 Cores Taken Yes No

Formation Description
 Log Sample

DST #1: 3380-91'. Open 1 hr., strong blow, gas at surf. in 10 min., good blow throughout, Rec. 1200' gas & oil, 1050# B.H. S.I.F. in 15 min., 230# FFP.
 DST #2: 3392-3406'. Open 1 hr., med. blow throughout, Rec. 630' G. & 90' VHO&GCM, 990# S.I.G.H.P. in 15 min.
 DST #3: 3420-47'. Open 1 hr., strong blow, gas at surf. in 15 min., Rec. 1460' fluid, 600' oil, 540' HOCM, 320' SW. IFP 190#, FFP 610# 15 min., S.I.B.H.P. 1320#.

Name	Top	Bottom
Heebner Shale	3218'	
Brown Lime	3345'	
Lansing Lime	3357'	
Base KC Lime	3559'	
Penn. Cong.	3595'	
Viola Chert	3615'	
Simpson Shale	3648'	
Arbuckle Dolomite	3704'	

CASING RECORD New Used
 Report all strings set-conductor, surface, intermediate, production, etc.

Purpose of String	Size Hole Drilled	Size Casing Set (in O.D.)	Weight Lbs/Ft.	Setting Depth	Type of Cement	#Sacks Used	Type and Percent Additives
Surface	12 7/8"	8-5/8"	28#	193'	Comm.	175	1% Aquagel
Prod.	7-7/8"	5 1/2"	14#	3753'	Comm.	100	--

PERFORATION RECORD
 Shots Per Foot Specify Footage of Each Interval Perforated
 Acid, Fracture, Shot, Cement Squeeze Record (Amount and Kind of Material Used) Depth

2	3707-13'	250 gal. CA, 1000 gal. XX26W	17	3707-13'
2	3387-90'			
2	3427-33'			
2	3502-28'			

TUBING RECORD
 Size 2-7/8" Set At 3510' Packer at
 Liner Run Yes No

Date of First Production 7-8-50
 Producing Method Flowing Pumping Gas Lift Other (explain).....

Estimated Production Per 24 Hours	Oil Bbls	Gas MCF	Water Bbls	Gas-Oil Ratio	Gravity
	3	None	218		CFPB

METHOD OF COMPLETION Production Interval

Disposition of gas: Vented Open Hole Perforation
 Sold Other (Specify) 3524-28'
 Used on Lease Dually Completed Commingled 3516-20'