

Give All Information Completely
Make Required Affidavit
Mail or Deliver Report to:
Conservation Division
State Corporation Commission
300 Bitting Building
Wichita, Kansas

WELL PLUGGING RECORD

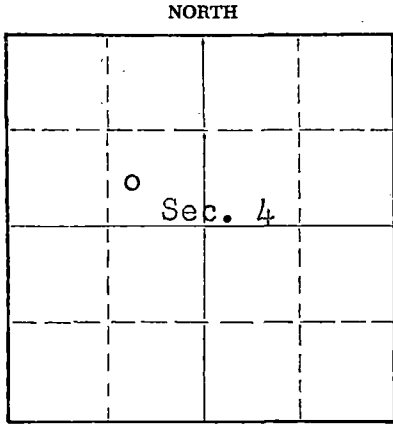

Locate well correctly on above Section Plat

Stafford County, Sec. 4 Twp. 21 Rge. 13 (X) W (W)
Location as "NE/CNW/SW" or footage from lines SW SE NW
Lease Owner PETROLEUM INC.
Lease Name TUCKER "C" Well No. 3
Office Address ROUTE 2, GREAT BEND, KANSAS
Character of Well (completed as Oil, Gas or Dry Hole) DRY HOLE
Date well completed November 29 1956
Application for plugging filed November 29 1956
Application for plugging approved November 29 1956
Plugging commenced November 29 1956
Plugging completed November 29 1956
Reason for abandonment of well or producing formation No Producing Zones

If a producing well is abandoned, date of last production None 19
Was permission obtained from the Conservation Division or its agents before plugging was commenced? Yes

Name of Conservation Agent who supervised plugging of this well R.M. Brundege Hoisington Kansas
Producing formation ----- Depth to top --- Bottom ----- Total Depth of Well 3613 Feet
Show depth and thickness of all water, oil and gas formations.

OIL, GAS OR WATER RECORDS

CASING RECORD

FORMATION	CONTENT	FROM	TO	SIZE	PUT IN	PULLED OUT
				8 5/8"	287	None

Describe in detail the manner in which the well was plugged, indicating where the mud fluid was placed and the method or methods used in introducing it into the hole. If cement or other plugs were used, state the character of same and depth placed, from _____ feet to _____ feet for each plug set.

Mud up with heavy mud to 240', pushed down 1/4 sacks hulls to 240' followed by wooden plug. Placed 20 sacks cement through drill pipe on to plug. Mud up to 40' and place 1/4 sack hulls at 40' followed by wooden plug and 10 sacks cement to base of well cellar.

12-8-56
RECEIVED
STATE OF KANSAS
DEC 10 1956
CONSERVATION DIVISION
WICHITA, KANSAS

(If additional description is necessary, use BACK of this sheet)
Name of Plugging Contractor Garvey Drilling Co.
Address Route 2, Great Bend, Kansas

STATE OF KANSAS, COUNTY OF BARTON, ss.
DON SEARLE (employee of owner) or (owner or operator) of the above-described well, being first duly sworn on oath, says: That I have knowledge of the facts, statements, and matters herein contained and the log of the above-described well as filed and that the same are true and correct. So help me God.
(Signature) Don Searle

SUBSCRIBED AND SWORN to before me this 6 th day of December, 1956
(Address)
Leda T. Brown
Notary Public.

My commission expires July 11, 1960

PLUGGING
FILE SEC. 4 T. 21 R. 13W
BOOK PAGE 121 LINE 4

WELL LOG

15.185.11709.0000

COMPANY PETROLEUM, INCORPORATED

SEC. 4 T. 21S. R. 13W

FARM TUCKER 'C' NO. 3

LOC. SW, SE, NW

TOTAL DEPTH 3613'

COUNTY Stafford Co., Kansas

COMM. November 18, 1956 COMP. November 29, 1956

CONTRACTOR GARVEY DRILLING COMPANY

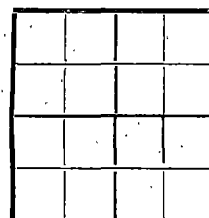

CASING 8 5/8" @ 287' W/225 sax.

ELEVATION

PRODUCTION

D & A

FIGURES INDICATE BOTTOM OF FORMATIONS

260	Shale & sand
770	Shale
790	Anhydrite
1300	Shale & shells
1725	Shale, shells & lime
3250	Shale & lime
3545	Lime
3590	Lime & shale
3613	Lime
3613	T. D.

RECEIVED
STATE CORPORATION COMMISSION
DEC - 8 1956
CONSERVATION DIVISION
Topeka, Kansas

PLUGGING
FILE SEC. 4 T. 21 R. 13W
BOOK PAGE 121 LINE 4

State of KANSAS

County of BARTON

} ss:

I, Verne A. Morris of Garvey Drilling Co.

upon oath state that the above and foregoing is a true and correct copy of the log of the #3 Tucker 'C' well

Verne A. Morris

Subscribed and sworn to before me this 5th day of December 19 56

My Commission Expires November 12, 1958

Beaufort
NOTARY PUBLIC

ORIGINAL

15185.11709.0000

No 53610

FIELD ORDER PETROLEUM, INC.

311 East Third Street
WICHITA 2, KANSAS

SHOW THIS
NUMBER
ON YOUR
INVOICE

Date 12-4, 1956

Please Invoice In Quadruplicate
Show Lease or Well No. On Invoice
Retain Original Of Order For Your Records
Discount Period Will Be Extended Unless Green Copy Of Order Is Attached To Invoice

SUPPLIER	SALES TICKET NO.	ADDRESS	
<i>State Corporation Commission</i>		<i>800 Bitting Building Wichita, Kansas</i>	
QUANTITY	DESCRIPTION		PRICE
	<i>State Plugging Assessment</i>		<i>\$ 25.00</i>

PLUGGING
 FILE SEC 4 R 12W
 BOOK PAGE 121 LINE 4

RECEIVED
 STATE CORPORATION COMMISSION
 DEC 5 1956
 CONSERVATION DIVISION
 Wichita, Kansas

SHIP MATERIAL TO:

VIA:

CARE OF:

DELIVERY DATE REQUESTED:

Lease or Well No:

Tucker #3

Used For:

Plugging New Well

Signed: Authorized Agent

Jack Perkins

VENDOR: Attached Copy Must Accompany Invoice.

Form 32-B