

STATE OF KANSAS
STATE CORPORATION COMMISSION

Give All Information Completely
Make Required Affidavit
Mail or Deliver Report to:
Conservation Division
State Corporation Commission
211 No. Broadway
Wichita, Kansas

WELL PLUGGING RECORD

STAFFORD County. Sec. 28 Twp. 21 Rge. 13 (X) (W)

Location as "NE/CNW/SW" or footage from lines NE NW SW

Lease Owner PETROLEUM, INC.

Lease Name HAZEL L-KC UNIT (P.L. KEENAN #2) Well No. 4-11

Office Address ROUTE #2, GREAT BEND, KANSAS

Character of Well (completed as Oil, Gas or Dry Hole) OIL

Date well completed SEPT. 21 19 50

Application for plugging filed NOV. 20 19 65

Application for plugging approved NOV. 23 19 65

Plugging commenced NOV. 22 19 65

Plugging completed NOV. 24 19 65

Reason for abandonment of well or producing formation DEPLETION OF PRODUCING ZONE

If a producing well is abandoned, date of last production JULY 31 19 65

Was permission obtained from the Conservation Division or its agents before plugging was commenced? YES

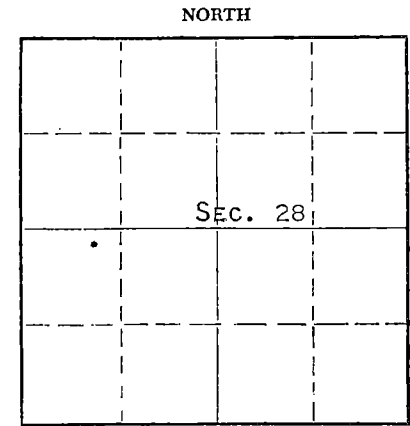

Locate well correctly on above Section Plat

Name of Conservation Agent who supervised plugging of this well ARCHIE ELVING

Producing formation KANSAS CITY Depth to top 3362 Bottom 3578 Total Depth of Well 3746 Feet

Show depth and thickness of all water, oil and gas formations.

OIL, GAS OR WATER RECORDS

CASING RECORD

FORMATION	CONTENT	FROM	TO	SIZE	PUT IN	PULLED OUT
KANSAS CITY	SLIGHT WATER	3377	3381	8-5/8	205'	NONE
				5-1/2	3745'	3015'

Describe in detail the manner in which the well was plugged, indicating where the mud fluid was placed and the method or methods used in introducing it into the hole. If cement or other plugs were used, state the character of same and depth placed, from _____ feet to _____ feet for each plug set.

PLUGGED BACK TO 3455'
FILLED SAND FROM 3455' TO 3360', RAN 5 SACKS OF CEMENT FROM 3360' TO 3330'. MUDDED UP WITH HEAVY MUD FROM 3330' TO 205', SET PLUG, ROCK BRIDGE FROM 205' TO 190', RAN 4 SACKS OF CEMENT FROM 190' TO 115'. MUDDED UP WITH HEAVY MUD FROM 115' TO 40', SET PLUG, PLACED ROCK AND 10 SACKS CEMENT FROM 40' TO BASE OF WELL CELLAR.

RECEIVED
STATE CORPORATION COMMISSION
DEC 10 1965
CONSERVATION DIVISION
Wichita, Kansas

(If additional description is necessary, use BACK of this sheet)

Name of Plugging Contractor GLENN & SMITH PIPE PULLING CO.
Address BOX 156, ELLINWOOD, KANSAS

STATE OF KANSAS, COUNTY OF BARTON, ss. MONTE CHADD (employee of owner) or (owner/proprietor) of the above-described well, being first duly sworn on oath, says: That I have knowledge of the facts, statements, and matters herein contained and the log of the above-described well as filed and that the same are true and correct. So help me God. MONTE CHADD, Dist. Prod. Supt.

(Signature) [Signature]

ROUTE #2, GREAT BEND, KANSAS (Address)

SUBSCRIBED AND SWORN to before me this 6 day of DECEMBER, 19 65

My commission expires MAY 28, 1969 [Signature] Notary Public.

WELL LOG P. L. KEENAN #2

Petroleum, Inc., Lease Owner

Section 28, Twp. 21S, Rge. 13W

Garvey Oil, Contractor

Location: NE NW SW

Rotary Total Depth: 3748'

County: Stafford, Kansas

Commenced: September 3, 1950

Elevation: 1905 D.F.

Completed: September 15, 1950

Casing: 203' of 8 5/8"
3747.25' of 5 1/2"

Figures below indicate bottom of formation

104 Sand & Gravel
 119 Sand & Pyrite
 275 Shale & Shells
 365 Sand
 395 Red Bed
 780 Gyp.
 790 Anhydrite
 1050 Shale & Red Bed
 1275 Shale & Shells
 1725 Lime & Shale
 1835 Br. Lime
 1870 Lime
 2160 Lime & Shale
 2320 Shale & Shells
 2720 Shale
 2723 Soft Sand
 2830 Shale & Lime
 3230 Lime
 3320 Shale & Shells
 3380 Shale & Lime
 3396 Lime
 3615 Cong.
 3625 Viola Lime

3650 Cherty Lime
 3655 Lime
 3689 Shale
 3709 Arb. Lime
 3748 R.T.D.

Tops

767 Schl. Anhydrite
 3222 Heebner
 3241 Toronto
 3349 Brown Lime
 3359 Lansing
 3615 Viola
 3697 1/2 Arbuckle

D.S.T. #1, 3378-96, open 17 min., recovered
 3396' clean gassy oil
 D.S.T. #2, 3396-3407, open 1 hr; recovered
 520' mud and salt water.
 D.S.T. #3, 3482-3511, open 45 min.; rec.
 385' gassy mud and salt water

I hereby certify that this is a true and correct log of the above mentioned well.

PETROLEUM, INC.

Eric H. Jager
 Eric H. Jager

STATE OF KANSAS:

: SS.

SEDGWICK COUNTY:

Subscribed to and sworn to before me, a Notary Public in said County and State this 21st day of September, 1950.

Marjorie Bradshaw
 Notary Public

My commission expires: October 27, 1952