

STATE OF KANSAS
STATE CORPORATION COMMISSION

WELL PLUGGING RECORD

OR

FORMATION PLUGGING RECORD

Strike out upper line
when reporting plug-
ging of formations.

Give All Information Completely
Make Required Affidavit
Mail or Deliver Report to:
Conservation Division
State Corporation Commission
800 Bittling Building
Wichita, Kansas

Rice County, Sec *8* Twp *21* Rge *7* (E) *W* (W)

NORTH

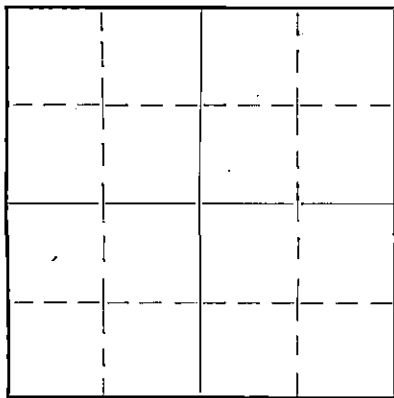

Location as "NE 1/4 NW 1/4 SW 1/4" or footage from lines
Lease Owner *Jay Kornfeld*
Lease Name *Hanneshrath* Well No. *7342*
Office Address *1121 Union Hall Bldg*
Character of Well (Completed as Oil, Gas or Dry Hole) *oil*
Date, well completed *February 8* 193*7*
Application for plugging filed *About May 1st* 193*7*
Application for plugging approved *May 2nd* 193*7*
Plugging Commenced *May 26* 193*7*
Plugging Completed *June 10* 193*7*
Reason for abandonment of well or producing formation *Not Producing*
too small to produce
If a producing well is abandoned, date of last production *February* 193*7*
Was permission obtained from the Conservation Division or its agents before plugging was commenced? *Yes*

Locate well correctly on above
Section Plat

Name of Conservation Agent who supervised plugging of this well *Ruel Rucker*
Producing formation *Conglomerate* Depth to top *3342'* Bottom *3355'* Total Depth of Well *3355'* Feet.

Show depth and thickness of all water, oil and gas formations.

OIL, GAS OR WATER RECORDS

CASING RECORD

Formation	Content	From	To	Size	Put In	Pulled Out
<i>Conglomerate</i>	<i>oil</i>	<i>3342</i>	<i>3355</i>	<i>7"</i>	<i>3342'</i>	<i>2618'</i>

Describe in detail the manner in which the well was plugged, indicating where the mud fluid was placed and the method or methods used in introducing it into the hole. If cement or other plugs were used, state the character of same and depth placed, from *3342'* feet to *3355'* feet for each plug set.

Bottom of Hole 3355'
Plugged with gravel to 3342'
Ran 6 sacks cement at 3342'
Started casing at 2595'
Plugged with Mud from 2595' to 150'
Ran Rock Budget at 150'
Ran 25 sacks cement at 150' to 130'
Filled Big hole with dirt to bottom of cellar
Ran 8 sacks cement at top of hole

(If additional description is necessary, use BACK of this sheet)

Correspondence regarding this well should be addressed to *Jay Kornfeld*
Address *1121 Union Hall Bldg Wichita, Kan*

STATE OF *Kansas* COUNTY OF *Sedgewick* ss.
Jay Kornfeld (employee of owner) or (owner or operator) of the above-described well,
being first duly sworn on oath, says: That I have knowledge of the facts, statements, and matters herein contained and the log of the above-described well as filed and that the same are true and correct. So help me God.
(Signature) *Jay Kornfeld*
1121 Union Hall Bldg (Address)

SUBSCRIBED AND SWORN to before me this _____ day of _____, 19____

My commission expires _____

PLUGGING 17-6058
FILE SEC *8 T 21 R 7W*
BOOK PAGE *107* LINE *32*

10-38-5M

Notary Public.

PRYOR - LOCKHART
 Ann Hanenkratt No. 1.

SEC. 8 T. 21 R. 7W
 SE NE SW

Total Depth. 3367' P.B. 3355
 Comm. 12-29-36 Comp. 2-8-37
 Shot or Treated.
 Contractor.
 Issued. 5-8-37

County. Rice

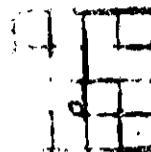

CASING:
 13" 116'
 7" 3342'

Elevation.

Production. Pot. 1008 B.

Figures Indicate Bottom of Formations.

sand	80
shale & shells	700
salt	950
shale & shells	1095
lime shells	1410
lime brkn	1512
lime	1530
shale & shells	1980
shale	2290
shale & shells	2415
lime	2675
lime & shells	2890
lime	2930
shale	3025
lime	3080
shale	3095
lime	3180
shale	3240
shale & lime	3290
lime	3310
shale	3337
red rock	3340
chat	3343
3343-3344 SIM	
chat Sh oil	3346.
Increase oil 3346-50	
chat	3358
conglomerate	3367
Total Depth.	

Plugged back to 3355'

PLUGGING
 FILE SEC 8 T. 21 R. 7W
 BOOK PAGE 107 LINE 32

