

ORIGINAL

SIDE ONE

STATE CORPORATION COMMISSION OF KANSAS  
OIL & GAS CONSERVATION DIVISION  
WELL COMPLETION FORM  
ACO-1 WELL HISTORY  
DESCRIPTION OF WELL AND LEASE

Operator: License # 4656

Name: DAVIS PETROLEUM, INC.

Address R.R. 1 Box 183 B

City/State/Zip Great Bend, Kansas 67530

Purchase: \_\_\_\_\_

Operator Contact Person: L. D. Davis

Phone (316) 793-3051

Contractor: Name: L. D. Drilling, Inc.

License: 6039

Wellsite Geologist: Kim Shoemaker

Designate Type of Completion

New Well  Re-Entry  Workover

Oil  SWD  Temp. Abd.

Gas  Inj  Delayed Comp.

Dry  Other (Core, Water Supply, etc.)

If DAWO old well info as follows:

Operator: \_\_\_\_\_

Well Name: \_\_\_\_\_

Comp. Date \_\_\_\_\_ Old Total Depth \_\_\_\_\_

Drilling Method:

Mud Rotary  Air Rotary  Cable

5-7-90 5-12-90 8-23-90

Spud Date Date Reached TD Completion Date

API NO. 15- 135-23,451-0000

County Ness

NW NW NW Sec. 6 Twp. 20-S Rge. 24  East West

4950' Ft. North from Southeast Corner of Section

4950' Ft. West from Southeast Corner of Section  
(NOTE: Locate well in section plat below.)

Lease Name Schlegel "CC" SWD Well # 1

Field Name Unknown

Producing Formation \_\_\_\_\_

Elevation: Ground 2350' KB 2355'

Total Depth 4425' PBTD 1730'

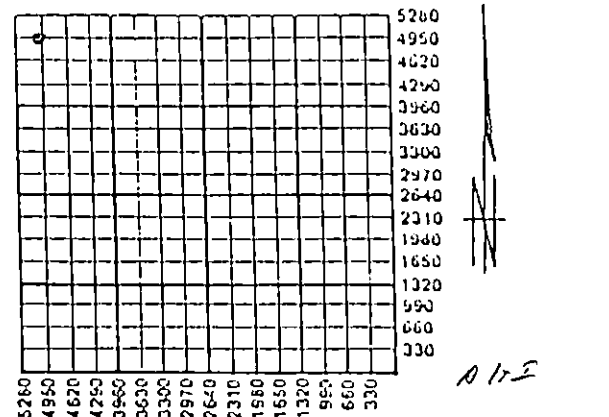

Amount of Surface Pipe Set and Cemented at 802' Feet

Multiple Stage Cementing Collar Used?  Yes  No

If yes, show depth set \_\_\_\_\_ Feet

If Alternate II completion, cement circulated from \_\_\_\_\_

feet depth to \_\_\_\_\_ w/ \_\_\_\_\_ sx cnt.

INSTRUCTIONS: This form shall be completed in triplicate and filed with the Kansas Corporation Commission, 200 Colorado Derby Building, Wichita, Kansas 67202, within 120 days of the spud date of any well. Rule 82-3-130, 82-3-107 and 82-3-106 apply. Information on side two of this form will be held confidential for a period of 12 months if requested in writing and submitted with the form. See rule 82-3-107 for confidentiality in excess of 12 months. One copy of all wireline logs and drillers time log shall be attached with this form. ALL CEMENTING TICKETS MUST BE ATTACHED. Submit CP-4 form with all plugged wells. Submit CP-111 form with all temporarily abandoned wells. Any recompletion, workover or conversion of a well requires filing of ACO-2 within 120 days from commencement date of such work.

All requirements of the statutes, rules and regulations promulgated to regulate the oil and gas industry have been fully complied with and the statements herein are complete and correct to the best of my knowledge.

Signature L. D. Davis  
L. D. Davis

Title President Date 9-7-90

Subscribed and sworn to before me this 7th day of September, 1990.

Notary Public Bessie M. Dewerff  
Bessie M. Dewerff

Date Commission Expires 5-20-93

K.C.C. OFFICE USE ONLY

F  Letter of Confidentiality Attached

C  Wireline Log Received

C  Drillers Timelog Received

Distribution

KCC  SWD/Rep  NGPA

KGS  Plug  Other (Specify)

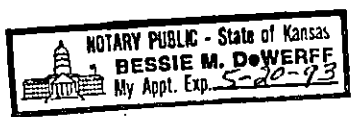

PI

110190

SIDE TWO

Operator Name Davis Petroleum, Inc. Lease Name Schlegel "CC" SWD Well # 1

Sec. 6 Twp. 20 S Rge. 24  East  West County Ness

INSTRUCTIONS: Show important tops and base of formations penetrated. Detail all cores. Report all drill stem tests giving interval tested, time tool open and closed, flowing and shut-in pressures, whether shut-in pressure reached static level, hydrostatic pressures, bottom hole temperature, fluid recovery, and flow rates if gas to surface during test. Attach extra sheet if more space is needed. Attach copy of log.

Drill Stem Tests Taken  Yes  No  
 (Attach Additional Sheets.)  
 Samples Sent to Geological Survey  Yes  No  
 Cores Taken  Yes  No  
 Electric Log Run  Yes  No  
 (Submit Copy.)

No Drill Stem Tests Taken

Name	Formation Description	
	Top	Bottom
Anhy	1615	1656
Heeb	3757	(-1402)
L K/C	3799	(-1444)
B K/C	4172	(-1817)
Ft. Scott	4326	(-1971)
Cherokee	4352	(-1996)
Ero. Miss.	4425	(-2070)
RTD	4445	(-2090)

CASING RECORD  New  Used  
 Report all strings set-conductor, surface, intermediate, production, etc.

Purpose of String	Size Hole Drilled	Size Casing Set (In O.D.)	Weight Lbs./Ft.	Setting Depth	Type of Cement	# Sacks Used	Type and Percent Additives
surface	12 1/4"	8 5/8"	25#	802'	60/40 Poz	300	2% Gel, 3% C
Long String	7 7/8"	5 1/2"	14#	1766'	HLC	225	
					60/40 Poz	75	2% Gel 1/4# Flocele

Shots Per Foot	PERFORATION RECORD	Acid, Fracture, Shot, Cement Squeeze Record (Amount and Kind of Material Used)	Depth
	Specify Footage of Each Interval Perforated		
4 spf	1082-1087		
	1112-1138		
	1168-1174		
	1188-1196		
	1206-1210		

TUBING RECORD Size 2 7/8" Set At 1046.80' Packer At \_\_\_\_\_ Liner Run  Yes  No

Date of First Production \_\_\_\_\_ Producing Method  Flowing  Pumping  Gas Lift  Other (Explain) \_\_\_\_\_  
 Estimated Production Per 24 Hours Oil \_\_\_\_\_ Bbls. Gas \_\_\_\_\_ Mcf Water \_\_\_\_\_ Bbls. Gas-Oil Ratio \_\_\_\_\_ Gravity \_\_\_\_\_

Disposition of Gas:  Vented  Sold  Used on Lease (If vented, submit ACO-18.) METHOD OF COMPLETION:  Open Hole  Perforation  Dually Completed  Commingled  Other (Specify) \_\_\_\_\_ Production Interval \_\_\_\_\_

15.135.23451.0000

Phone 913-483-2627, Russell, Kansas

Phone Plainville 913-434-2812

Phone 316-793-5861, Great Bend, Kansas

Phone Ness City 913-798-3843

# ALLIED CEMENTING CO., INC.

ORIGINAL

No 6940

Home Office P. O. Box 31

Russell, Kansas 67665

New

Date	Sec.	Twp.	Range	Called Out	On Location	Job Start	Finish
5-8-90	6	20	24		5:00 a.m.		9:15 a.m.
Lease	Well No.	Location		County	State		
Schlegel	1	Ness City 75-710-310 1cc		Ness	KS		

Contractor		Owner	
I. D. Drilling		Same	
Type Job		To Allied Cementing Co., Inc.	
Surface Casings		You are hereby requested to rent cementing equipment and furnish cementer and helper to assist owner or contractor to do work as listed.	
Hole Size	T.D.	Charge To	
12 1/4	802	Davis	Per
Csg.	Depth	Street	
8 3/8	808	City	State
Tbg. Size	Depth	The above was done to satisfaction and supervision of owner agent or contractor	
		Purchase Order No.	
Drill Pipe	Depth	X B. Davidson	
		CEMENT	
Tool	Depth	Amount Ordered	300.51 @ 40 322
		Consisting of	
Cement Left in Csg.	Shoe Joint	Common	
10'		Poz. Mix	
Press Max.	Minimum	Gel.	
		Chloride	
Meas Line	Displace	Quickset	
✓	✓	Sales Tax	
Perf.		Handling	
		Mileage	

EQUIPMENT		
# No.	Cementor	
Pumptrk 191	Helper	Allen Mike M.
No.	Cementor	
Pumptrk	Helper	
# 208	Driver	MIKE H.
Bulktrk	Driver	

DEPTH of Job	
Reference:	
	Pump 71k. Chgs.
	Pump 71k. mileage
	8 5/8" R" Plus
	Sub Total
	Tax
	Total

Remarks: Cement Did Circulate  
 Plus was 300' down

Sub Total	
Total	
Floating Equipment	
Stamp	
SEP 10 1990	

FORM 1906 R-11

WELL NO. - FARM OR LEASE NAME #1 Schlegel CC		COUNTY Ness	STATE Ks.	CITY / OFFSHORE LOCATION	DATE 5-14-90
CHARGE TO Davis Petroleum Inc.		OWNER Same		TICKET TYPE (CHECK ONE) SERVICE <input checked="" type="checkbox"/> SALES <input type="checkbox"/>	
ADDRESS RR #1 Box 183 B		CONTRACTOR L. D. Drilling		LOCATION 1 Ness City, Ks. CODE 50353	
CITY, STATE, ZIP Greeat Bend, Ks. 67530		SHIPPED VIA Ness City, Ks.		LOCATION 2 CODE	
WELL TYPE 01		WELL CATEGORY 01		WELL PERMIT NO. B- 848219	
TYPE AND PURPOSE OF JOB 035		ORDER NO.		REFERRAL LOCATION 3	

As consideration, the above-named Customer agrees to pay Halliburton in accord with the rates and terms stated in Halliburton's current price lists. Invoices payable NET by the 20th of the following month after date of invoice. Upon Customer's default in payment of Customer's account by the last day of the month following the month in which the invoice is dated, Customer agrees to pay interest thereon after default at the highest lawful contract rate applicable, but never to exceed 18% per annum. In the event it becomes necessary to employ an attorney to enforce collection of said account, Customer agrees to pay all collection costs and attorney fees in the amount of 10% of the amount of the unpaid account. These terms and conditions shall be governed by the law of the state where services are performed or equipment or materials are furnished.

Halliburton warrants only title to the products, supplies and materials and that the same are free from defects in workmanship and materials. THERE ARE NO WARRANTIES, EXPRESS OR IMPLIED, OF MERCHANTABILITY, FITNESS FOR A PARTICULAR PURPOSE OR OTHERWISE WHICH EXTEND BEYOND THOSE STATED IN THE IMMEDIATELY PRECEDING SENTENCE. Halliburton's liability and customer's exclusive remedy in any cause of action (whether in contract, tort, product liability, breach of warranty or otherwise) arising out of the sale or use of any products, supplies or materials is expressly limited to the replacement of such products, supplies or materials on their return to Halliburton or, at Halliburton's option, to the allowance to the customer of credit for the cost of such items. In no event shall Halliburton be liable for special, incidental, indirect, punitive or consequential damages.

PRICE REFERENCE	SECONDARY REF OR PART NO.	L O C	ACCOUNT	DESCRIPTION	UNITS 1		UNITS 2		UNIT PRICE	AMOUNT	
					QTY	MEAS	QTY	MEAS			
000-117		1		MILEAGE TRUCK #51145	14	mi			220	30	80
001-016		1		Pump Service	1766	Fr				887	00
030-016		1		S-6 Top Plug	1	ea	5 1/2	in		47	00
12 A	825,205	1		Guide Shoe	1	ea				104	00
40	307,93022	1		S-4 Centralizers	2	ea			4400	88	00
24 A	815,19251	1		Insert Float Valve	1	ea				83	00
27	813,19311	1		Auto. Filler Assy.	1	ea				30	00
320	800,8883	1		Cmt. Basket	1	ea				90	00

THIS IS NOT AN INVOICE

SEP 16 1990

AS PER ATTACHED BULK MATERIAL DELIVERY TICKET NO. **B- 848219** 1,949 <sup>32</sup>

WAS JOB SATISFACTORILY COMPLETED?  
 WAS OPERATION OF EQUIPMENT SATISFACTORY?  
 WAS PERFORMANCE OF PERSONNEL SATISFACTORY?  
 CUSTOMER OR HIS AGENT (PLEASE PRINT)  
*Robert D. ...*  
 CUSTOMER OR HIS AGENT (SIGNATURE)

WE CERTIFY THAT THE FAIR LABOR STANDARDS ACT OF 1938, AS AMENDED HAS BEEN COMPLIED WITH IN THE PRODUCTION OF GOODS AND OR WITH RESPECT TO SERVICES FURNISHED UNDER THIS CONTRACT.  
*Roger B. Segler*  
 HALLIBURTON OPERATOR  
 HALLIBURTON APPROVAL  
 CUSTOMER

SUB TOTAL  
 APPLICABLE TAXES WILL BE ADDED ON INVOICE.



**HALLIBURTON SERVICES**  
 Dallas, Oklahoma 75228  
 A Division of Halliburton Company

**BULK MATERIALS DELIVERY**

**AND  
 TICKET CONTINUATION**

FOR INVOICE AND  
 TICKET NO.

910483

**ORIGINAL**

DATE <b>5-14-90</b>	CUSTOMER ORDER NO.	WELL NO. AND FARM <b>#1 Schlegel CC</b>	COUNTY <b>Ness</b>	STATE <b>Kansas</b>
CHARGE TO <b>Davis Petroleum Inc.</b>		OWNER <b>Same</b>	CONTRACTOR <b>No. B 848219</b>	
MAILING ADDRESS <b>RR #1 Box 183 B</b>		DELIVERED FROM <b>Hays, Ks</b>	LOCATION CODE <b>50325</b>	PREPARED BY <b>Kuhn</b>
CITY & STATE <b>Great Bend, Ks 67530</b>		DELIVERED TO <b>S/W Ness City, Ks</b>	TRUCK NO. <b>0530</b>	RECEIVED BY <i>Regis B. J... ..</i>

PRICE REFERENCE	SECONDARY REF. OR PART NO.	CODE		DESCRIPTION	UNITS 1		UNITS 2		UNIT PRICE	AMOUNT	
		L	D		QTY.	MEAS.	QTY.	MEAS.			
<b>504-108</b>		<b>2</b>	<b>B</b>	<b>Halliburton Light Cement</b>	<b>225</b>				<b>4.92</b>	<b>1,107</b>	<b>00</b>
				<b>75 Cu. Ft. Pozmix Cement 2% Gel</b>							
<b>504-308</b>	<b>516.00261</b>	<b>2</b>	<b>B</b>	<b>Standard Cement</b>	<b>45</b>				<b>5.45</b>	<b>245</b>	<b>25</b>
<b>506-105</b>	<b>516.00261</b>	<b>2</b>	<b>B</b>	<b>Pozmix 'A'</b>	<b>30</b>				<b>2.88</b>	<b>86</b>	<b>40</b>
<b>506-121</b>	<b>516.00259</b>	<b>2</b>	<b>B</b>	<b>1 sk Halliburton Gel @2%</b>							<b>n/c</b>
<b>507-210</b>	<b>890.50071</b>	<b>2</b>	<b>B</b>	<b>Floccle Blended</b>	<b>75</b>	<b>lb</b>			<b>1.23</b>	<b>92</b>	<b>25</b>

THIS IS NOT AN INVOICE

			Returned Mileage Charge	TOTAL WEIGHT	LOADED MILES	TON MILES				
				SERVICE CHARGE ON MATERIALS RETURNED		CU. FEET				
<b>500-2 07</b>		<b>2</b>	<b>B</b>		<b>300</b>	<b>.95</b>	<b>285</b>	<b>00</b>		
				SERVICE CHARGE		CU. FEET				
<b>500-306</b>		<b>2</b>	<b>B</b>	Mileage Charge <b>27,270</b>	<b>14</b>	<b>190.890</b>	<b>.70</b>	<b>133</b>	<b>62</b>	
				TOTAL WEIGHT	LOADED MILES	TON MILES				
<b>No. B 848219</b>								CARRY FORWARD TO INVOICE	SUB-TOTAL	<b>1,949 52</b>

CUSTOMER

**HALLIBURTON SERVICES**  
**JOB LOG**

WELL NO. #1 LEASE Schlegel CC TICKET NO. 910483  
 CUSTOMER Davis Petroleum Inc. PAGE NO. 1  
 JOB TYPE Long String DATE 3-14-90

FORM 2013 R-2

ORIGINAL  
 DESCRIPTION OF OPERATION AND MATERIALS

CHART NO.	TIME	RATE (BPM)	VOLUME (BBL) (GAL)	PUMPS		PRESSURE (PSI)		DESCRIPTION OF OPERATION AND MATERIALS
				T	C	TUBING	CASING	
	0240							Called out
	0300							on hoc. Set up truck
	0400							Rig tying down P.P. Start 5 1/2" Csg. 2nd hole Guide Shoe & Insert float valve on 1st Joint Cent. on 1st & 3rd Cement Ballot on top of 3rd Jnt.
	0440							Drop Ball
	0450							Break C.R. Rig pump
	0500							Plug Rest hole 100% cement
	0510	5	73					Start mixing 2 155K H.C 1/4 Flock
		5	17					755K 60-40 2% Gel 1/4 Flock
	0530		90					Finished mixing wash pump & lines + Release top plug
	0533	5	42.6					Start Dis. 42.6 gal
	0540							Plug down 800 psi holding
	0549							Release press. to truck Float held circulated 355 gal Wash + Rack up truck Job Complete
								Thank You Royal

SEP 10 1990

FIELD \_\_\_\_\_ SEC 6 TWP 20S RNG 24W COUNTY Miss STATE MS

ORIGINAL

FORMATION NAME \_\_\_\_\_ TYPE \_\_\_\_\_  
 FORMATION THICKNESS \_\_\_\_\_ FROM \_\_\_\_\_ TO \_\_\_\_\_  
 INITIAL PROD: OIL \_\_\_\_\_ BPD. WATER \_\_\_\_\_ BPD. GAS \_\_\_\_\_ MCFD \_\_\_\_\_  
 PRESENT PROD: OIL \_\_\_\_\_ BPD. WATER \_\_\_\_\_ BPD. GAS \_\_\_\_\_ MCFD \_\_\_\_\_  
 COMPLETION DATE \_\_\_\_\_ MUD TYPE \_\_\_\_\_ MUD WT. \_\_\_\_\_  
 PACKER TYPE \_\_\_\_\_ SET AT \_\_\_\_\_  
 BOTTOM HOLE TEMP. \_\_\_\_\_ PRESSURE \_\_\_\_\_  
 MISC. DATA \_\_\_\_\_ TOTAL DEPTH 4445

	NEW USED	WEIGHT	SIZE	FROM	TO	MAXIMUM PSI ALLOWABLE
CASING	<u>U</u>	<u>14</u>	<u>4 1/2</u>	<u>RB</u>	<u>11166</u>	
LINER						
TUBING						
OPEN HOLE						SHOTS/FT.
PERFORATIONS						
PERFORATIONS						
PERFORATIONS						

JOB DATA

CALLED OUT:	ON LOCATION	JOB STARTED	JOB COMPLETED
DATE <u>5-14-90</u>	DATE <u>5-14-90</u>	DATE <u>5-14-90</u>	DATE <u>5-14-90</u>
TIME <u>17:00</u>	TIME <u>0100</u>	TIME _____	TIME _____

TOOLS AND ACCESSORIES

TYPE AND SIZE	QTY.	MAKE
FLOAT COLLAR <u>Insert 5 1/2"</u>	<u>1</u>	<u>HOUWOO</u>
FLOAT SHOE		
GUIDE SHOE <u>Rg 5 1/2"</u>	<u>1</u>	<u>HOUWOO</u>
CENTRALIZERS <u>2-4 6 1/2"</u>	<u>2</u>	<u>HOUWOO</u>
BOTTOM PLUG		
TOP PLUG <u>S-W 5 1/2"</u>	<u>1</u>	<u>HOUWOO</u>
HEAD		
PACKER		
OTHER <u>Curt. Basket 5 1/2"</u>	<u>1</u>	<u>HOUWOO</u>

PERSONNEL AND SERVICE UNITS

NAME	UNIT NO. & TYPE	LOCATION
<u>R. Regalator</u>	<u>Comb. 51145</u>	<u>Miss City, MS</u>
<u>R. Carter</u>	<u>Build 0530</u>	<u>Hays, MS</u>
<u>A. Weath</u>		

MATERIALS

TREAT. FLUID \_\_\_\_\_ DENSITY \_\_\_\_\_ LB/GAL-API \_\_\_\_\_  
 DISPL. FLUID \_\_\_\_\_ DENSITY \_\_\_\_\_ LB/GAL-API \_\_\_\_\_  
 PROP. TYPE \_\_\_\_\_ SIZE \_\_\_\_\_ LB \_\_\_\_\_  
 PROP. TYPE \_\_\_\_\_ SIZE \_\_\_\_\_ LB \_\_\_\_\_  
 ACID TYPE \_\_\_\_\_ GAL \_\_\_\_\_ % \_\_\_\_\_  
 ACID TYPE \_\_\_\_\_ GAL \_\_\_\_\_ % \_\_\_\_\_  
 ACID TYPE \_\_\_\_\_ GAL \_\_\_\_\_ % \_\_\_\_\_  
 SURFACTANT TYPE \_\_\_\_\_ GAL \_\_\_\_\_ IN \_\_\_\_\_  
 NE AGENT TYPE \_\_\_\_\_ GAL \_\_\_\_\_ IN \_\_\_\_\_  
 FLUID LOSS ADD. TYPE \_\_\_\_\_ GAL-LB \_\_\_\_\_ IN \_\_\_\_\_  
 GELLING AGENT TYPE \_\_\_\_\_ GAL-LB \_\_\_\_\_ IN \_\_\_\_\_  
 FRIC. RED. AGENT TYPE \_\_\_\_\_ GAL-LB \_\_\_\_\_ IN \_\_\_\_\_  
 BREAKER TYPE \_\_\_\_\_ GAL-LB \_\_\_\_\_ IN \_\_\_\_\_  
 BLOCKING AGENT TYPE \_\_\_\_\_ GAL-LB \_\_\_\_\_  
 PERFPAC BALLS TYPE \_\_\_\_\_ QTY \_\_\_\_\_  
 OTHER \_\_\_\_\_  
 OTHER \_\_\_\_\_

DEPARTMENT Cut.  
 DESCRIPTION OF JOB Curt. 5 1/2" Long String  
 JOB DONE THRU: TUBING  CASING  ANNULUS  TBG/ANN.   
 CUSTOMER REPRESENTATIVE Robert J. [Signature]  
 HALLIBURTON OPERATOR Ray B. Regalator COPIES REQUESTED \_\_\_\_\_

CEMENT DATA

STAGE	NUMBER OF SACKS	CEMENT	BRAND	BULK SACKED	ADDITIVES	YIELD CU.FT./SK.	MIXED LBS./GAL.
	<u>225</u>	<u>HLC</u>		<u>B</u>	<u>1/4" Flucide</u>	<u>1.54</u>	<u>12.7</u>
	<u>75</u>	<u>60-40 Poz</u>		<u>B</u>	<u>2% Gel 1/2" Flucide</u>	<u>1.28</u>	<u>14.36</u>

PRESSURES IN PSI \_\_\_\_\_ SUMMARY \_\_\_\_\_ VOLUMES \_\_\_\_\_  
 CIRCULATING \_\_\_\_\_ DISPLACEMENT \_\_\_\_\_ PRESLUSH: BBL-GAL \_\_\_\_\_ TYPE \_\_\_\_\_  
 BREAKDOWN \_\_\_\_\_ MAXIMUM \_\_\_\_\_ LOAD & BKDN: BBL-GAL \_\_\_\_\_ PAD: BBL-GAL \_\_\_\_\_  
 AVERAGE \_\_\_\_\_ FRACTURE GRADIENT \_\_\_\_\_ TREATMENT: BBL-GAL \_\_\_\_\_ DISPL. BBL-GAL 426  
 SHUT-IN: INSTANT \_\_\_\_\_ 5-MIN. \_\_\_\_\_ 15-MIN. \_\_\_\_\_ CEMENT SLURRY: BBL-GAL 90.7  
 HYDRAULIC HORSEPOWER \_\_\_\_\_ TOTAL VOLUME: BBL-GAL \_\_\_\_\_  
 ORDERED \_\_\_\_\_ AVAILABLE \_\_\_\_\_ USED \_\_\_\_\_ AVERAGE RATES IN BPM \_\_\_\_\_  
 REMARKS: See Chart & Job Log  
Thrust Pump  
Log  
 TREATING \_\_\_\_\_ DISPL. \_\_\_\_\_ OVERALL \_\_\_\_\_ CEMENT LEFT IN PIPE \_\_\_\_\_  
 FEET 20 REASON Shut Joint

CUSTOMER: L.D. Drilling  
 LEASE: Schlegel  
 CE  
 WELL NO.: 41  
 JOB TYPE: Long String  
 DATE: 5-14-90

WORK ORDER CONTRACT  
AND PRE-TREATMENT DATA

ORIGINAL

FORM 1908 R-7

A Division of Halliburton Company

ATTACH TO INVOICE & TICKET NO. 910483

DISTRICT Hays, R DATE 5 14 90

TO: HALLIBURTON SERVICES YOU ARE HEREBY REQUESTED TO FURNISH EQUIPMENT AND SERVICEMEN TO DELIVER AND OPERATE THE SAME AS AN INDEPENDENT CONTRACTOR TO: Davis Petroleum Inc. (CUSTOMER) AND DELIVER AND SELL PRODUCTS, SUPPLIES, AND MATERIALS FOR THE PURPOSE OF SERVICING

WELL NO. 211 LEASE Schlegel CC SEC. 6 TWP. 20S RANGE 24W  
FIELD \_\_\_\_\_ COUNTY Ness STATE K OWNED BY Same

THE FOLLOWING INFORMATION WAS FURNISHED BY THE CUSTOMER OR HIS AGENT

FORMATION NAME	TYPE	NEW USED	WEIGHT	SIZE	FROM	TO	MAX. ALLOW. P.S.I.
FORMATION THICKNESS	FROM _____ TO _____						
PACKER TYPE	SET AT _____						
TOTAL DEPTH	MUD WEIGHT						
BORE HOLE							
INITIAL PROD. OIL _____ BPD, H <sub>2</sub> O _____ BPD, GAS _____ MCF							
PRESENT PROD. OIL _____ BPD, H <sub>2</sub> O _____ BPD, GAS _____ MCF							
PERFORATIONS							
PERFORATIONS							
PERFORATIONS							

PREVIOUS TREATMENT DATE \_\_\_\_\_ TYPE \_\_\_\_\_ MATERIALS \_\_\_\_\_

TREATMENT INSTRUCTIONS: TREAT THRU TUBING  ANNULUS  CASING  TUBING/ANNULUS  HYDRAULIC HORSEPOWER ORDERED  
End 5 1/2" Long String with 225 SK HLC with 1/4" Flare / SK  
75 SK 60-40 P. 2 1/2 Gal 1/4" Flare / SK

CUSTOMER OR HIS AGENT WARRANTS THE WELL IS IN PROPER CONDITION TO RECEIVE THE PRODUCTS, SUPPLIES, MATERIALS, AND SERVICES

As consideration, the above-named Customer agrees: THIS CONTRACT MUST BE SIGNED BEFORE WORK IS COMMENCED

- To pay Halliburton in accordance with the rates and terms stated in Halliburton's current price list. Invoices are payable NET by the 20th of the following month after date of invoice. Upon Customer's default in payment of Customer's account by the last day of the month following the month in which the invoice is dated, Customer agrees to pay interest thereon after default at the highest lawful contract rate applicable, but never to exceed 18% per annum. In the event it becomes necessary to employ attorneys to enforce collection of said account, Customer agrees to pay all collection costs and attorney fees in the amount of 20% of the amount of the unpaid account.
- To defend, indemnify, release and hold harmless Halliburton, its divisions, subsidiaries, parent and affiliated companies and the officers, directors, employees, agents and servants of all of them from and against any claims, liability, expenses, attorneys fees, and costs of defense to the extent permitted by law for:
  - Damage to property owned by, in the possession of, or leased by Customer, and/or the well owner (if different from Customer), including, but not limited to, surface and subsurface damage. The term "well owner" shall include working and royalty interest owners.
  - Reservoir, formation, or well loss or damage; subsurface trespass or any action in the nature thereof.
  - Personal injury or death or property damage (including, but not limited to, damage to the reservoir, formation or well), or any damages whatsoever, growing out of or in any way connected with or resulting from pollution, subsurface pressure, losing control of the well and/or a well blowout or the use of radioactive material.

The defense, indemnity, release and hold harmless obligations of Customer provided for in this Section b) and Section c) below shall apply to claims or liability even if caused or contributed to by Halliburton's negligence, strict liability, or the unseaworthiness of any vessel owned, operated, or furnished by Halliburton or any defect in the data, products, supplies, materials, or equipment of Halliburton whether in the preparation, design, manufacture, distribution, or marketing thereof, or from a failure to warn any person of such defect. Such defense, indemnity, release and hold harmless obligations of Customer shall not apply where the claims or liability are caused by the gross negligence or willful misconduct of Halliburton. The term "Halliburton" as used in said Sections b) and c) shall mean Halliburton, its divisions, subsidiaries, parent and affiliated companies, and the officers, directors, employees, agents and servants of all of them.
- That because of the uncertainty of variable well conditions and the necessity of relying on facts and supporting services furnished by others, Halliburton is unable to guarantee the effectiveness of the products, supplies or materials, nor the results of any treatment or service, nor the accuracy of any chart interpretation, research analysis, job recommendation or other data furnished by Halliburton. Halliburton personnel will use their best efforts in gathering such information and their best judgment in interpreting it, but Customer agrees that Halliburton shall not be liable for and Customer shall indemnify Halliburton against any damages arising from the use of such information.
- That Halliburton warrants only title to the products, supplies and materials and that the same are free from defects in workmanship and materials. THERE ARE NO WARRANTIES, EXPRESS OR IMPLIED, OF MERCHANTABILITY, FITNESS OR OTHERWISE WHICH EXTEND BEYOND THOSE STATED IN THE IMMEDIATELY PRECEDING SENTENCE. Halliburton's liability and Customer's exclusive remedy in any cause of action (whether in contract, tort, breach of warranty or otherwise) arising out of the sale or use of any products, supplies or materials is expressly limited to the replacement of such products, supplies or materials on their return to Halliburton or, at Halliburton's option, to the allowance to the Customer of credit for the cost of such items. In no event shall Halliburton be liable for special, incidental, indirect, punitive or consequential damages.
- That Customer shall, at its risk and expense, attempt to recover any Halliburton equipment, tools or instruments which are lost in the well and if such equipment, tools or instruments are not recovered, Customer shall pay Halliburton its replacement cost unless such loss is due to the sole negligence of Halliburton. If Halliburton equipment, tools or instruments are damaged in the well, Customer shall pay Halliburton the lesser of its replacement cost or the cost of repairs, unless such damage is caused by the sole negligence of Halliburton. In the case of equipment, tools or instruments for marine operations, Customer shall, in addition to the foregoing, be fully responsible for loss of or damage to any of Halliburton's equipment, tools or instruments which occurs at any time after delivery to Customer at the landing until returned to the landing, unless such loss or damage is caused by the sole negligence of Halliburton.
- To waive the provisions of the Deceptive Trade Practices - Consumer Protection Act, to the extent permitted by law.
- That this contract shall be governed by the law of the state where services are performed or materials are furnished.
- That Halliburton shall not be bound by any changes or modifications in this contract, except where such change or modification is made in writing by a duly authorized executive officer of Halliburton.

SIGNED [Signature] CUSTOMER

DATE \_\_\_\_\_

certify that the Fair Labor Standards Act of 1938, as amended, has been complied with in the production of goods and/or with respect to services furnished under this contract.

TIME \_\_\_\_\_ A.M. P.M.

CUSTOMER