

STATE OF KANSAS
STATE CORPORATION COMMISSION

WELL PLUGGING RECORD

Give All Information Completely
Make Required Affidavit
Mail or Deliver Report to
Conservation Division
State Corporation Comm.
245 North Water
Wichita, KS 67202

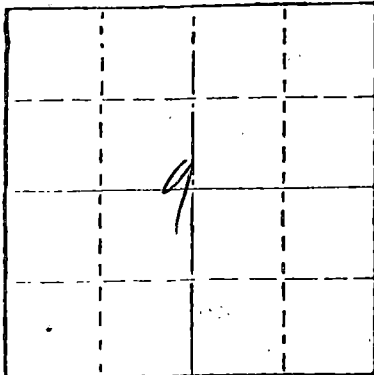

Locate well correctly on above
Section Plot

Ness County, Sec. 9 Twp. 20S Rge. 24 NE/W
Location as "NE/CNW $\frac{1}{4}$ SW $\frac{1}{4}$ " or footage from lines
SW SW
Lease Owner Texaco Inc.
Lease Name B. L. Hoss Well No. 1
Office Address Box 2420, Tulsa, Okla. 74102
Character of Well (Completed as Oil, Gas or Dry Hole)
Dry Hole

Date Well completed 10-24-80 19
Application for plugging filed 10-24-80 (Verbal) 19
Application for plugging approved 10-24-80 (Verbal) 19
Plugging commenced 10-23-80 19
Plugging completed 10-24-80 19
Reason for abandonment of well or producing formation
Dry Hole

If a producing well is abandoned, date of last production
19

Was permission obtained from the Conservation Division or
its agents before plugging was commenced? Yes

Name of Conservation Agent who supervised plugging of this well Marion Schmidt
Producing formation Depth to top Bottom Total Depth of Well
Show depth and thickness of all water, oil and gas formations.

OIL, GAS OR WATER RECORDS

CASING RECORD

FORMATION	CONTENT	FROM	TO	SIZE	PUT IN	PULLED OUT
				8-5/8	604	None

Describe in detail the manner in which the well was plugged, indicating where the mud plug was placed and the method or methods used in introducing it into the hold. If cement or other plugs were used, state the character of same and depth placed, from feet to feet for each plug set.

Spotted 50 sx cement 4390-4194'; 70 sx 800'-534', 30 sx 420-306', 10 sx 40-3' below ground level.

RECEIVED
STATE CORPORATION COMMISSION

OCT 31 1980

CONSERVATION DIVISION
Wichita, Kansas

(If additional description is necessary, use BACK of this sheet)

Name of Plugging Contractor Rotary - Rains & Williamson

STATE OF OKLAHOMA COUNTY OF TULSA, ss.
H. D. Zimmerman (employee of owner) or XXXXXXXXXXXXXXXX

of the above-described well, being first duly sworn on oath, says: That I have knowledge of the facts, statements, and matters herein contained and the log of the above-described well as filed and that the same are true and correct. So help me God.

(Signature) H. D. ZIMMERMAN, Ass't Gen. Supt.
Box 2420, Tulsa, Okla. 74102

(Address)

SUBSCRIBED AND SWORN TO before me this 29th day of October, 1980

My commission expires July 21, 1983

Notary Public.

15-135.21893.0000

KANSAS DRILLERS LOG

API No. 15 — 135 — 21893
County Number

S. 9 T. 20S R. 24 ~~XX~~EX W
Loc. SW SW
County Ness-Kans.

Operator
Texaco Inc.

Address
Box 2420, Tulsa, Okla. 74102

Well No. 1 Lease Name B. L. Hoss

Footage Location
660 feet from ~~XX~~ (S) line 660 feet from ~~XX~~ (W) line

Principal Contractor
Rains & Williamson

Geologist

Spud Date
10-12-80

Total Depth
4509

P.B.T.D.
4374

Date Completed
10-24-80

Oil Purchaser

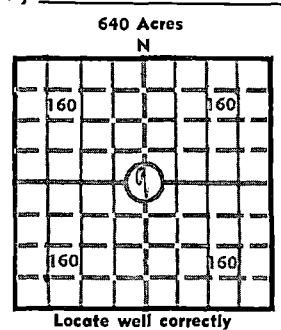

Elev.: Gr. _____
DF _____ KB _____

CASING RECORD

Report of all strings set— surface, intermediate, production, etc.

Purpose of string	Size hole drilled	Size casing set (in O.D.)	Weight lbs/ft.	Setting depth	Type cement	Sacks	Type and percent additives
Surface	12-1/4"	8-5/8"	24	604	Class H 50/50 poz	250 100	3% CC 3% CC

LINER RECORD

PERFORATION RECORD

Top, ft.	Bottom, ft.	Sacks cement	Shots per ft.	Size & type	Depth interval

Size	Setting depth	Packer set at			

ACID, FRACTURE, SHOT, CEMENT SQUEEZE RECORD

Amount and kind of material used

Depth interval treated
RECEIVED
STATE CORPORATION COMMISSION
OCT 31 1980
CONSERVATION DIVISION
Wichita, Kansas

INITIAL PRODUCTION

Date of first production Dry Hole Producing method (flowing, pumping, gas lift, etc.) Well P & A

RATE OF PRODUCTION PER 24 HOURS	Oil	Gas	Water	Gas-oil ratio
	bbls.	MCF	bbls.	CFPB

Disposition of gas (vented, used on lease or sold) Producing interval (s)

INSTRUCTIONS: As provided in KCC Rule 82-2-125, within 90 days after completion of a well, one completed copy of this Drillers Log shall be transmitted to the State Geological Survey of Kansas, 4150 Monroe Street, Wichita, Kansas 67209. Copies of this form are available from the Conservation Division, State Corporation Commission, 3830 So. Meridian (P.O. Box 17027), Wichita, Kansas 66217. Phone AC 316-522-2206. If confidential custody is desired, please note Rule 82-2-125. Drillers Logs will be on open file in the Oil and Gas Division, State Geological Survey of Kansas, Lawrence, Kansas 66044.

Operator Texaco Inc.		DESIGNATE TYPE OF COMP.: OIL, GAS, DRY HOLE, SWDW, ETC.:
Well No. 1	Lease Name B. L. Hoss	Dry Hole
S 9 T20S R 24 ^{XX} _W		

WELL LOG

Show all important zones of porosity and contents thereof; cored intervals, and all drill-stem tests, including depth interval tested, cushion used, time tool open, flowing and shut-in pressures, and recoveries.

SHOW GEOLOGICAL MARKERS, LOGS RUN, OR OTHER DESCRIPTIVE INFORMATION.

FORMATION DESCRIPTION, CONTENTS, ETC.	TOP	BOTTOM	NAME	DEPTH
Shale	0	1760		
Lime	1760	2665		
Lime - Shale	2665	4509 Total Depth		
Completed 10-24-80 Plugged & Abandoned				
Spotted 50 sx cement 4390-4194', 70 sx cmt 800-534'; 30 sx 420-306', 10 sx 40-3' below ground level.				

USE ADDITIONAL SHEETS, IF NECESSARY, TO COMPLETE WELL RECORD.

Date Received	<div> <div><i>H. D. Zimmerman</i></div> <div>H. D. ZIMMERMAN</div> <div>Signature</div> <div>Assistant General Superintendent</div> <div>Title</div> <div>October 28, 1980</div> <div>Date</div> </div>
---------------	---