

STATE CORPORATION COMMISSION OF KANSAS
OIL & GAS CONSERVATION DIVISION
WELL COMPLETION OR RECOMPLETION FORM
ACO-1 WELL HISTORY
DESCRIPTION OF WELL AND LEASE

API NO. 15-145-21,288.0000
County Pawnee
NE/4 SW/4 NW/4 Sec 10 Twp 20S Rge 19W East
..... West

Operator: License # 9971
Name Kodiak Petroleum, Inc.
Address 44 Inverness Drive East
Suite B, Building D
City/State/Zip Englewood, Colorado 80112

3630 Ft North from Southeast Corner of Section
4290 Ft West from Southeast Corner of Section
(Note: Locate well in section plat below)

Purchaser Enron Gas Supply
Houston, Texas

Lease Name Hagerman Well # 10-5
Field Name Oro Field (New Reservoir)

Operator Contact Person Kent A. Johnson
Phone 303-790-7550

Producing Formation Chase
Elevation: Ground 2230 KB 2235

Contractor: License # 5302
Name Red Tiger Drilling Company

Wellsite Geologist Charles W. Cook
Phone 303-790-7550

Designate Type of Completion
 New Well Re-Entry Workover
 Oil SWD Temp Abd
 Gas Inj Delayed Comp.
 Dry Other (Core, Water Supply etc.)
If **OWO**: old well info as follows:
Operator
Well Name
Comp. Date Old Total Depth

RECEIVED
STATE CORPORATION COMMISSION
FEB 7 1989
2-7-89
CONSERVATION DIVISION
Wichita, Kansas

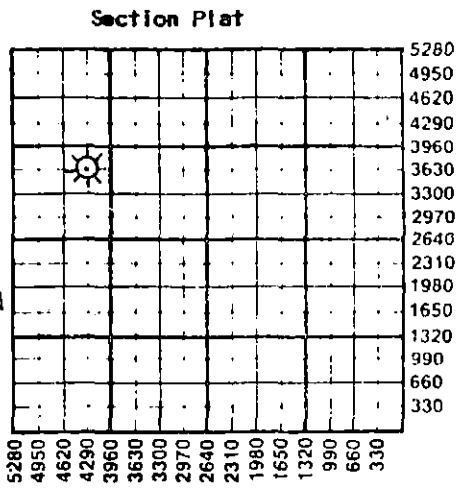

WATER SUPPLY INFORMATION
Disposition of Produced Water: Disposal
Docket # Repressuring

WELL HISTORY
Drilling Method: Mud Rotary Air Rotary Cable
12/6/88 12/10/88 01/10/89
Spud Date Date Reached TD Completion Date
2,495' 2,390'
Total Depth PBTD
Amount of Surface Pipe Set and Cemented at 465 feet
Multiple Stage Cementing Collar Used? Yes No
If yes, show depth set.....feet
If alternate 2 completion, cement circulated
from.....feet depth to.....w/.....SX cmt
Cement Company Name Allied Cementing
Invoice # 53032
A 1 r J

Questions on this portion of the ACO-1 call:
Water Resources Board (913) 296-3717
Source of Water:
Division of Water Resources Permit #.....
 Groundwater.....Ft North from Southeast Corner
(Well)Ft West from Southeast Corner of
Sec Twp Rge East West
 Surface Water 4000 Ft North from Southeast Corner
(Stream, pond etc) 1400 Ft West from Southeast Corner
Sec 10 Twp 20S Rge 19 East West
Anna Josefciak, Kinsley, Ks. 67547
Other (explain).....
(purchased from city, R.W.D. #)

INSTRUCTIONS: This form shall be completed in triplicate and filed with the Kansas Corporation Commission, 200 Colorado Derby Building, Wichita, Kansas 67202, within 120 days of the spud date of any well. Rule 82-3-130, 82-3-107 and 82-3-106 apply.
Information on side two of this form will be held confidential for a period of 12 months if requested in writing and submitted with the form. See rule 82-3-107 for confidentiality in excess of 12 months.
One copy of all wireline logs and drillers time log shall be attached with this form. Submit CP-4 form with all plugged wells. Submit CP-111 form with all temporarily abandoned wells.

All requirements of the statutes, rules and regulations promulgated to regulate the oil and gas industry have been fully complied with and the statements herein are complete and correct to the best of my knowledge.

Signature Kent A. Johnson
Title President Date 02/03/89

Subscribed and sworn to before me this 3rd day of February 1989
Notary Public Kris Ann Rosengren
Date Commission Expires September 18, 1992

K.C.C. OFFICE USE ONLY
 Letter of Confidentiality Attached
 Wireline Log Received
 Drillers Time Log Received
Distribution
 KCC SWD/Rep NGPA
 KGS Plug Other
(Specify)
2-7-89
Form ACO-1 (5-86)

Operator Name **Kodiak Petroleum, Inc.** Lease Name **Hagerman** 10-5

MAR 07 1990

Sec. **10** Twp. **20S** Rge. **19W** East West

County **Pawnee** FROM CONFIDENTIAL...

WELL LOG

INSTRUCTIONS: Show important tops and base of formations penetrated. Detail all cores. Report all drill stem tests giving interval tested, time tool open and closed, flowing and shut-in pressures, whether shut-in pressure reached static level, hydrostatic pressures, bottom hole temperature, fluid recovery, and flow rates if gas to surface during test. Attach extra sheet if more space is needed. Attach copy of log.

Drill Stem Tests Taken Yes No
 Samples Sent to Geological Survey Yes No
 Cores Taken Yes No

Formation Description
 Log Sample

DST #1 - 2313-2369' (Winfield) - Times 2-20-60-60
 1st open: Strong blow, bottom of bucket in 50 sec.
 2nd open: GTS in 10 min. Gauge 78 MCFD building to 171 MCFD at end of test.
 Rec. 310' muddy water (filtrate).
 IFP 63-63; ISIP 644; FFP 73-147; FSIP 686;
 HP 1204, 1161

Name	Top	Datum
Stone Corral	1386'	(+849)
Chase Group:		
Kridler	2281'	(-46)
Winfield	2331'	(-96)
Towanda	2398'	(-163)
Fort Riley	2440'	(-205)
Driller's T.D.	2495'	(-260)
Logger's T.D.	2495'	(-260)

DST #2 - 2389-2424' (Towanda) -Times 3-30-15-45
 1st open: Very weak blow, dead in 1/2 min.
 2nd open: No blow, flushed tool, no blow.
 Rec. 70' muddy water (filtrate).
 IFP 98-98; ISIP 640; FFP 98-127; FSIP 630;
 HP 1136, 1136.

CASING RECORD <input type="checkbox"/> New <input checked="" type="checkbox"/> Used							
Report all strings set-conductor, surface, intermediate, production, etc.							
Purpose of String	Size Hole Drilled	Size Casing Set (In O.D.)	Weight Lbs/Ft.	Setting Depth	Type of Cement	#Sacks Used	Type and Percent Additives
Surface	12 1/4"	8 5/8"	24	465'	60/40 Poz	220	2% Gel 3% CC
Production	7 7/8"	4 1/2"	10.5	2,495'	Surfil	100	8% Gilsontite per sx
PERFORATION RECORD				Acid, Fracture, Shot, Cement Squeeze Record			
Shots Per Foot	Specify Footage of Each Interval Perforated			Amount and Kind of Material Used		Depth	
2 SPF	2408-2420'; 2400-2404'			1200 gal. 15% Hcl x clay stabilizers x inhibitors			
2 SPF	2332-2352'			500 gal. 15% Hcl x clay stabilizers x inhibitors			
2 SPF	2302-2312'; 2286-2294'			200 gal. 15% Hcl x clay stabilizers x inhibitors			
TUBING RECORD				Liner Run <input type="checkbox"/> Yes <input checked="" type="checkbox"/> No			
Date of First Production		Size	Set At	Packer at			
January 26, 1989		2 3/8"	2362'	None			
Date of First Production		Producing Method					
January 26, 1989		<input checked="" type="checkbox"/> Flowing <input type="checkbox"/> Pumping <input type="checkbox"/> Gas Lift <input type="checkbox"/> Other (explain).....					
Estimated Production Per 24 Hours		Oil	Gas	Water	Gas-Oil Ratio	Gravity	
➔		Bbls	500 MCF	5 Bbls		CFPB	

METHOD OF COMPLETION

Production Interval

Disposition of gas: Vented Sold Used on Lease
 Open Hole Perforation Other (Specify)

2286-2420' OA

Dually Completed Conmingled

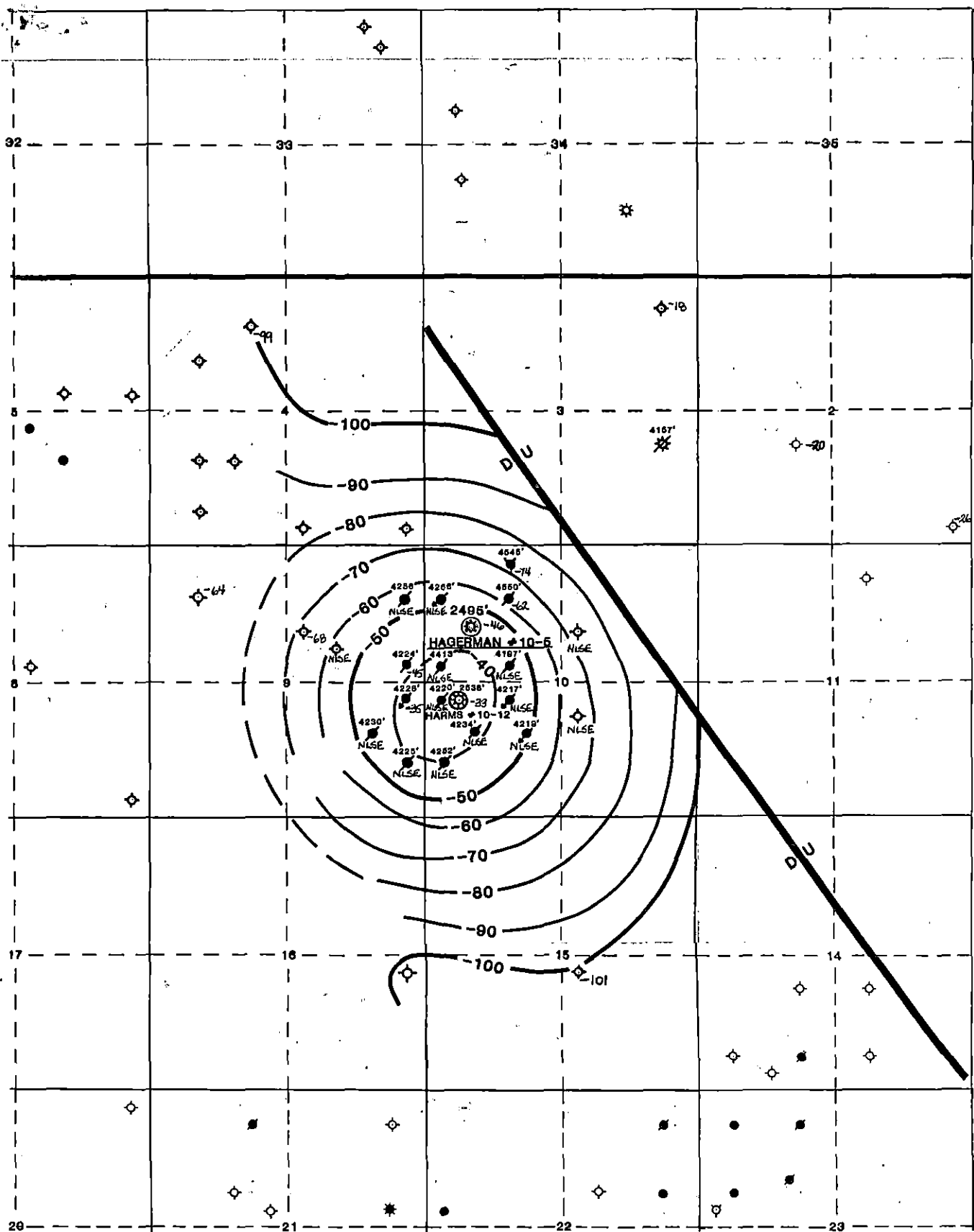

T 20 S

LEGEND

- ◇ Dry Hole
- Abandoned Cherokee Oil Well
- Abandoned Cherokee Injection Well
- ▼ Abandoned Cherokee Salt Water Disposal Well
- ⊛ Abandoned Cherokee Gas Well
- 4250' Total Depth
- ⊕ Chase Gas Well
- 45 Chase Structural Datum
- NLSE Not Logged Shallow Enough

R 19 W
RECEIVED
 STATE CORPORATION COMMISSION
 AUG 20 1983
 CONSERVATION DIVISION
 Wichita, Kansas

KODIAK PETROLEUM, INC.
 44 Inverness Drive East, Suite B, Building D, Englewood, Colorado 80112

CHASE GAS WELL
 NEW POOL DETERMINATION

HAGERMAN #10-5
 Section 10-T20S-R19W
 NE SW NW
 Pawnee County, Kansas

STRUCTURE MAP
 TOP OF PERMIAN CHASE GROUP

CI - 10'

KODIAK PETROLEUM, INC.

HAGERMAN #10-5
 Section 10-T20S-R19W
 Center of NE/SW/NW
 Pawnee County, Kansas

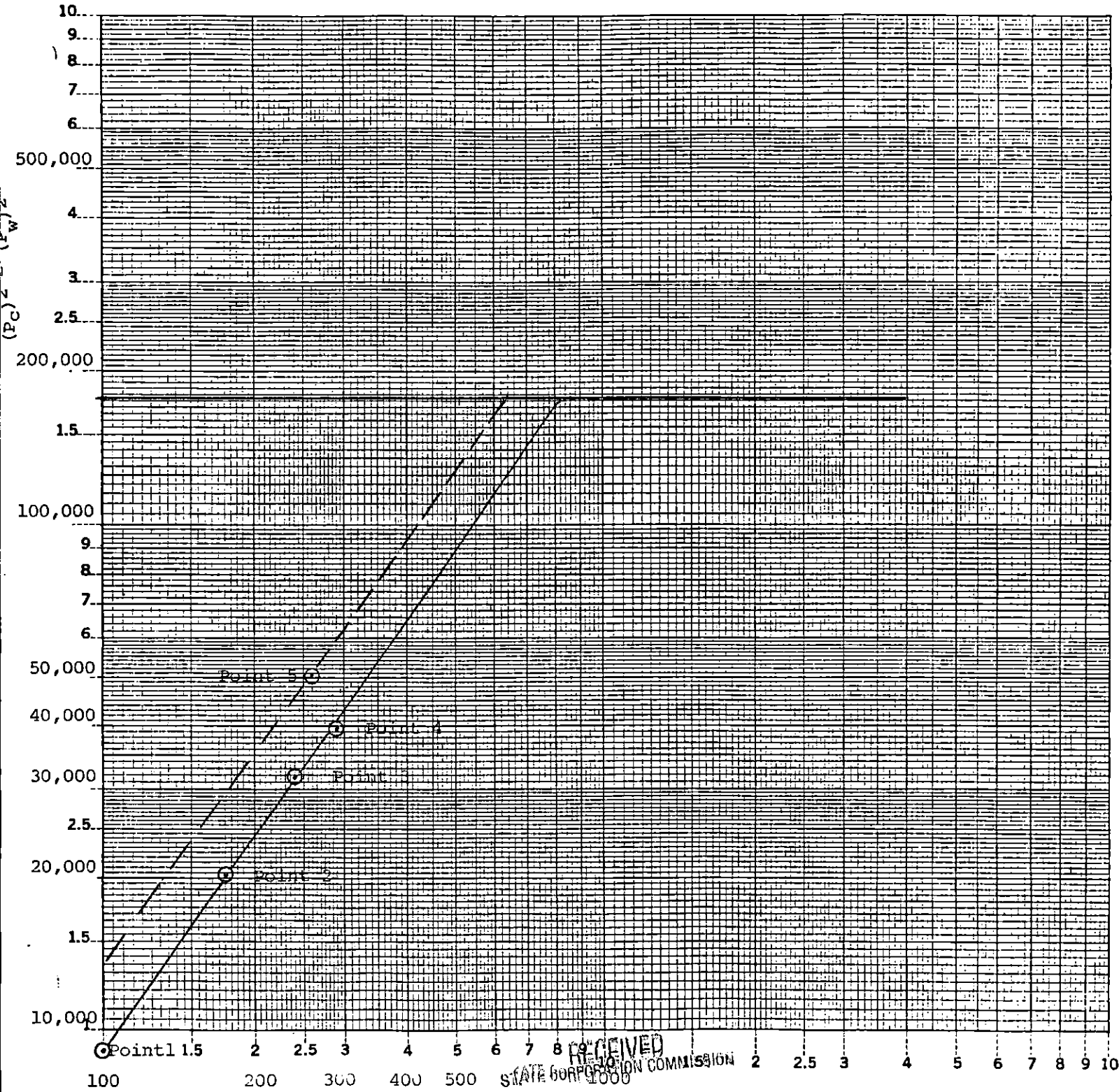

RECEIVED
 STATE CORPORATION COMMISSION
 JUN 29 1955

RATE NOTED 1500

CONSERVATION DIVISION
 Wichita, Kansas

4-Point CAOF = 817 MCF
 1-Point CAOF = 637 MCF