

15-009-01165-00-00

# PLUGGING RECORD

Mail To  
OKLAHOMA CORPORATION COMMISSION  
Oil and Gas Conservation Department  
Oklahoma City, Oklahoma

NOTICE: All questions on this form must be satisfactorily answered.

Company Operating Sterling Drilling Company  
Office Address Sterling, Kansas  
County Barton Sec. 21 Twp. 17S Range. 14W  
Location in Section SW 6 1/4 NE 1/4 NW 1/4  
Farm Name Connor Well No. 1 Field W.C.  
Character of Well (whether oil, gas or dry) DRY

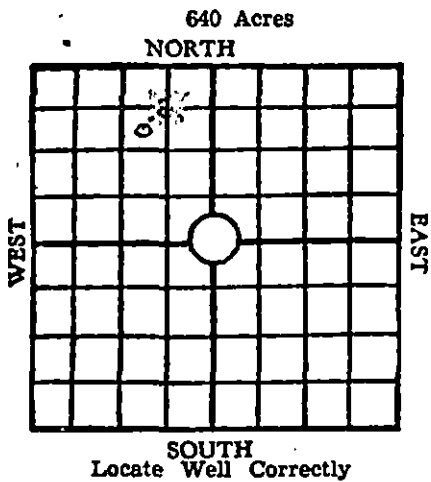

Commenced Plugging 2/17/45 Finished 2/17/45 Total Depth 3488

Was permission obtained from the Corporation Commission or its agents before plugging was commenced yes

Name of Conservation Officer who supervised plugging of this well Herb Kerr

Name of producing sand ----- Depth top ----- Bottom 3488

Show depth and thickness of all fresh water, oil and gas formations.

### SAND OR ZONE RECORDS

### CASING RECORDS

Formation	Content	From	To	Size	Put In	Pulled Out
Shale & Shells		0	715	8 5/8	899	none
Red Bed		715	888	Surface pipe		
Anhydrite		888	915			
Salt		1325	1640	No casing run		
Lansing		3160	3376			
Conglomerate		3376	3453			
Arbuckle		3453				

Describe in detail the manner in which the well was plugged, indicating where the mud fluid was placed and the methods used in introducing it into the hole. If cement or other plugs were used, state the character of same and depth placed:

Placed 20 sacks cement through drill pipe at 880

" 10 " " at top

FEB 21 1945  
2-24-45

Does the above conform strictly to the oil and gas regulations? yes

The Law requires that adjacent lease, royalty and land-owners be notified; give their names with their addresses below:

Wild cat

REMARKS: Why plugged? dry If abandoned oil or gas well, state amount and date of last production none

Correspondence regarding this well should be addressed to Sterling Drilling Company

Address Sterling, Kansas

I, the undersigned, being first duly sworn upon oath, state that this well record is true, correct and complete according to the records of this office and to the best of my knowledge and belief.

Subscribed and sworn to before me this the 23rd day of February, 1945  
My Commission expires January 19 1947  
Name and title of representative of company Herb Kerr  
Herb Kerr  
Notary Public

*State Comm.*

# STERLING DRILLING CO.

STERLING, KANSAS

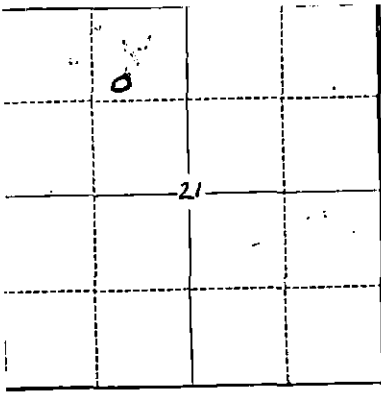

Company- Sterling Drilling Company  
 Farm- Connor  
 Location- ~~SW 1/4~~ NE 1/4 NW 1/4 Sec. 21 T17S R14W (S.W. Corner)  
 Barton County Kansas  
 Total depth- 3488  
 Production- dry  
 Elevation- 1916  
 Drilling commenced January 23, 1945  
 Drilling Completed- February 17, 1945  
 Casing Record- 899'- 8 5/8" Surface pipe-350 sacks cement

<u>Formation</u>	<u>Top</u>	<u>Bottom</u>
Shale & Shells	0	715
Red Bed	715	888
Anhydrate.	888	915
Shale & Shells	915	1325
Salt	1325	1640
Shale & Lime	1640	2060
Lime	2060	2130
Lime & Shale	2130	2645
Broken Lime	2645	2775
Lime	2775	3160
Lansing	3160	
Lime	3160	3376
Conglomerate	3376	3453
Arbuckle	3453	3488
TD	3488	

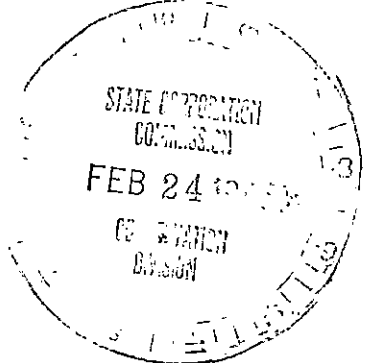

No show oil in Arbuckle

I, the undersigned, being first duly sworn upon oath, state that this well record is true, correct and complete according to the records of this office and to the best of my knowledge and belief.

Sterling Drilling Company

*McAllister*  
 \_\_\_\_\_  
 President

21 17 14W  
 5 32

Subscribed and sworn to before me this the 23rd, day of February, 1945

My Commission Expires January 19 1947

*Raymond*  
 \_\_\_\_\_  
 NOTARY PUBLIC.