

STATE OF KANSAS
STATE CORPORATION COMMISSION

WELL PLUGGING RECORD

Give All Information Completely
Make Required Affidavit
Mail or Deliver Report to
Conservation Division
State Corporation Comm.
245 North Water
Wichita, KS 67202

Pawnee County, Sec. 12 Twp. 20S Rge. 17W E/W
Location as "NE/CNW $\frac{1}{4}$ SW $\frac{1}{4}$ " or footage from lines
C NE/4

Lease Owner Tenneco Oil Company
Lease Name HAGERMAN Well No. 1-12
Office Address Ciudad Bldg, Suite 130, 3000 United Founder Blvd.
Oklahoma City, OK
Character of Well (Completed as Oil, Gas or Dry Hole)

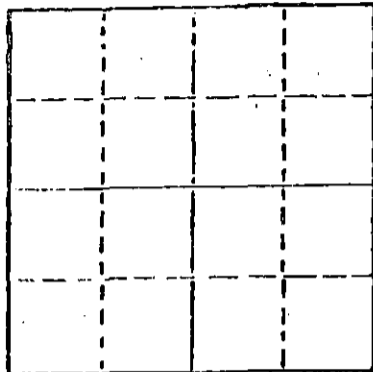

Locate well correctly on above
Section Plot

Dry Hole
Date Well completed 9/07 19 80
Application for plugging filed (Verbally) 9/07 19 80
Application for plugging approved (Verbally) 9/07 19 80
Plugging commenced 9/07 19 80
Plugging completed 9/07 19 80

Reason for abandonment of well or producing formation
No commercial quantity of oil or gas
If a producing well is abandoned, date of last production
19

Was permission obtained from the Conservation Division or
its agents before plugging was commenced? Yes

Name of Conservation Agent who supervised plugging of this well Marion Schmidt
Producing formation Depth to top Bottom Total Depth of Well

Show depth and thickness of all water, oil and gas formations.

OIL, GAS OR WATER RECORDS

CASING RECORD

FORMATION	CONTENT	FROM	TO	SIZE	PUT IN	PULLED OUT

Describe in detail the manner in which the well was plugged, indicating where the mud fluid
was placed and the method or methods used in introducing it into the hold. If cement or other
plugs were used, state the character of same and depth placed, from feet to
feet for each plug set.

T.D. 4010', Pumped 60 sx. of 50/50 posmix, 6% gel
through open end of drill pipe @ 1175', mud to 275',
pumped 30 sx. thru open end drill pipe, mud to 40',
12 sx. hulls & wood plug for solid bridge, pumped
10 sx. to base of cellar, 5 sx. in rathole. Plug was
down @ 1:00 p.m. 9-07-80. Cement by Allied.
State Plugger - Marion Schmidt, Hays.

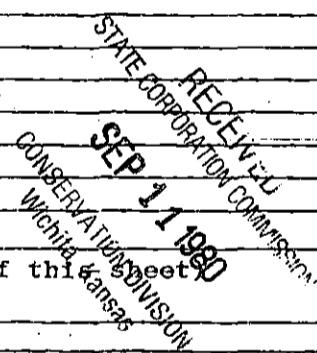

(If additional description is necessary, use BACK of this report)

Name of Plugging Contractor

STATE OF Kansas COUNTY OF Sedgwick, ss.
K.S. Martin, President (employee of owner) or (owner or operator)
of the above-described well, being first duly sworn on oath, says: That I have knowledge of
the facts, statements, and matters herein contained and the log of the above-described well
as filed and that the same are true and correct. So help me God.

(Signature) K.S. Martin
K.S. Martin, President - KAW Drilling Co.
1010 Union Center Address Wichita, Ks. 67202
9th day of September, 1980

SUBSCRIBED AND SWORN TO before me this



My commission expires

Kathy S. Goertz
Kathy S. Goertz Notary Public.

OPERATOR: Tenneco Oil Co.
 CONTRACTOR: KAW Drilling Co., Inc.
 WELL NAME: Hagerman #1
 LOCATION: C NE/4, Section 12-20S-17W
 Pawnee County, Kansas
 SPUD DATE: August 26, 1980
 COMPLETION DATE: September 7, 1980

0	105	Shale - Post Rock
105	590	Shale & Clay
590	754	Dakota Sand
754	1186	Shale & Red Bed
1186	1213	Shale & Shells
1213	1228	Anhydrite
1228	1450	Red Beds
1450	2063	Shale
2063	3715	Shale & Lime
3715	3908	Lime
3908	3920	Cong.-Arbuckle
3920	3937	Lime
3937	3976	Arbuckle
3976	4010	Lime & Arbuckle
	4010	R.T.D.

SAMPLE TOPS:

Anhydrite 1198'
 B/Anhydrite 1228'

Spud hole @ 11:40 a.m. 8/26/80. Drilled 1213' of 12 1/4" hole. Ran 29 jts. of 8 5/8" - 20#, new casing. (Tallied 1212') Set @ 1210' K.B. with 275 sx. of 60/40 posmix, followed with 375 sx. common cement, 2% gel, 3% Ca.Cl. Plug was down @ 12:30 p.m. 8/27/80. Cement did circulate.

T.D. 4010', Pumped 60 sx. of 50/50 posmix, 6% gel, through open end of drill pipe @ 1175', mud to 275', pumped 30 sx. thru open end drill pipe, mud to 40', 12 sx. hulls & wood plug for solid bridge, pumped 10 sx. to base of cellar, 5 sx. in rathole. Plug was down @ 1:00 p.m. 9-07-80. Cement by Allied. State Plugger - Marion Schmidt, Hays.

STATE OF KANSAS)
) SS
 COUNTY OF SEDGWICK)

RECEIVED
 STATE CORPORATION COMMISSION
 SEP 11 1980
 CONSERVATION DIVISION
 Wichita, Kansas

I, K.S. Martin, President of the KAW Drilling Co., Inc., being first duly sworn on oath, state: That I have knowledge of the facts, statements and matters herein contained and that the same are true and correct.

K.S. Martin
 K.S. Martin, President

Subscribed and sworn to before me on this 9th day of September, 1980.



Kathy S. Goertz
 Kathy S. Goertz, Notary Public

KANSAS

WELL COMPLETION REPORT AND
DRILLER'S LOG

API No. 15 - 145 - 20704-0000
County Number

S. 12 T. 20S R. 17 ^E/_W
Loc. C S/2, S/2, NE/4

County Pawnee

640 Acres
N

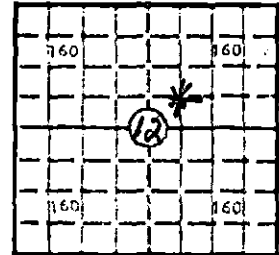

Locate well correctly

Elev.: Gr. _____

DF _____ KB _____

Operator Tenneco Oil Company

Address Suite 139, Ciudad Bldg., 3000 United Founders Blvd.
Oklahoma City, Oklahoma, 73112

Well No. 1-12 Lease Name Hagerman

Footage Location
1320' feet from (N) (X) line 1320 feet from (E) (W) line

Principal Contractor _____ Geologist _____

Spud Date 8-27-80 Date Completed 9-7-80 Total Depth 4010' P.B.T.D. _____

Directional Deviation _____ Oil and/or Gas Purchaser _____

CASING RECORD

Report of all strings set -- surface, intermediate, production, etc.

Purpose of string	Size hole drilled	Size casing set (in O.D.)	Weight lbs./ft.	Setting depth	Type cement	Sacks	Type and percent additives
Surface	12-1/4"	8-5/8"		1210	60/40 Poz Common	275	2% Gel, 3% CACL ₂
						275	2% Gel, 3% CACL ₂
					60/40 Poz Mud	60	2% Gel, 3% CACL ₂
						30	
					Hulls & Wood	27	

LINER RECORD

PERFORATION RECORD

Top, ft.	Bottom, ft.	Sacks cement	Shots per ft.	Size & type	Depth interval

TUBING RECORD

Size	Setting depth	Packer set at

ACID, FRACTURE, SHOT, CEMENT SQUEEZE RECORD

Amount and kind of material used	Depth interval treated

INITIAL PRODUCTION

Date of first production Dry Producing method (flowing, pumping, gas lift, etc.) Dry

RATE OF PRODUCTION PER 24 HOURS
Oil Dry Gas Dry Water Dry Gas-oil ratio _____
bbis. MCF bblis. CFPB

Disposition of gas (vented, used on lease or sold) _____ Producing interval(s) _____

INSTRUCTIONS: As provided in KCC Rule 82-2-125, within 90 days after completion of a well, one completed copy of this Drillers Log shall be transmitted to the State Geological Survey of Kansas, 4150 Monroe Street, Wichita, Kansas 67209. Copies of this form are available from the Conservation Division, State Corporation Commission, 245 No. Water, Wichita, Kansas 67202. Phone AC 316-522-2206. If confidential custody is desired, please note Rule 82-2-125. Drillers Logs will be on an open file in the Oil and Gas Division, State Geological Survey of Kansas, Lawrence, Kansas 66044.

RECEIVED
STATE CORPORATION COMMISSION
JUL 22 1981
CONSERVATION DIVISION
Wichita, Kansas

Operator Tenneco Oil Company		DESIGNATE TYPE OF COMP.: OIL, GAS, DRY HOLE, SWDW, ETC.:
Well No. 1-12	Lease Name Hagerman	Dry
S 12 T 20S R 17 ^K _W		

WELL LOG

Show all important zones of porosity and contents thereof; cased intervals, and all drill-stem tests, including depth interval tested, cushion used, time tool open, flowing and shut-in pressures, and recoveries.

SHOW GEOLOGICAL MARKERS, LOGS RUN, OR OTHER DESCRIPTIVE INFORMATION.

FORMATION DESCRIPTION, CONTENTS, ETC.	TOP	BOTTOM	NAME	DEPTH
Shale-Post Rock	0	105		
Shale & Clay	105	590		
Dakota Sand	590	754		
Shale & Red Bed	754	1186		
Shale & Shells	1186	1213		
Anhydrite	1213	1228		
Red Beds	1228	1450		
Shale	1450	2063		
Shale & Lime	2063	3715		
Lime	3715	3908		
Cong. - Arbuckle	3908	3920		
Lime	3920	3937		
Arbuckle	3937	3976		
Lime & Arbuckle	3976	4010		
RDT		4010		

USE ADDITIONAL SHEETS, IF NECESSARY, TO COMPLETE WELL RECORD.

Date Received	 Signature
	Carolyn S. Arnold Production Analyst Title
	July 17, 1981 Date

KANSAS CORPORATION COMMISSION

WELL RECORD

(Mail to Kansas Geological Survey, 4150 Monroe Street, Wichita, Kansas 67209)

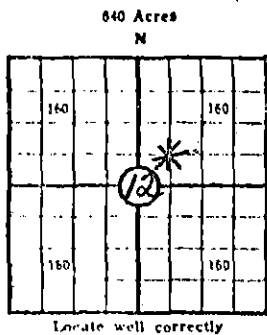

Lease Name: Hagerman Well No. 1-12
 Well Located: C S/2 - S/2 - NE/4
1320 ENL & 1320 FWL SEC 12 TWP 205 RGE 17W
 Operator: Tenneco Oil Company
 Address: Suite 139, Ciudad Bldg., 3000 United Founders Blvd., Okla.
 Elevation: Ground D.F. K.B. City OK, 73112
 Type Well: (Oil, gas, dry hole) Dry Hole

Drilling Commenced: 8-27 19 80 Drilling Completed: 9-7 19 80
 Well Completed: 9-7 19 80 Total Depth 4010'
 Initial Production: _____

Casing Record

Size: 8-5/8" Set at 1210' Size: _____ Set at _____
 Size: _____ Set at _____ Size: _____ Set at _____

Liner Record

Size: _____ Set from _____ To _____

Cementing

Casing Size	Sacks
8-5/8"	275
8-5/8"	275
8-5/8"	60
8-5/8"	30
8-5/8"	12
8-5/8"	10
8-5/8"	5

Type Cement and Additives

60/40 Posmix, 2% Gel, 3% Calc.
 Common W/2% Gel, 3% Calc.
 60/40 Posmix, 2% Gel, 3% Calc.
 Mud
 Hulls & Wood Plug for solid bridge
 Hulls & Wood to base of cellar.
 Hulls & Wood in rathole.

Perforations

Formation

Perforated Interval and Number Shots

<u>Arbuckle</u>	_____
_____	_____
_____	_____
_____	_____

Electric Log Run (Show type log and depths covered)

(Fill in formation and related information on reverse side)

RECEIVED
 STATE CORPORATION COMMISSION
 III 22 1981
 CONSERVATION DIVISION
 Wichita, Kansas

FORMATION, TESTING AND COMPLETION RECORD

Show Drill Stem Tests,
Well Stimulation and
Production Tests

Formation	Top	Bottom	
Shale-Past Rock	0	105	
Shale & Clay	105	590	
Dakota Sand	590	754	
Shale & Red Bed	754	1186	
Shale & Shells	1186	1213	
Anhydrite	1213	1228	
Red Beds	1228	1450	
Shale	1450	2063	
Shale & Lime	2063	3715	
Lime	3715	3908	
Cong.-Arbuckle	3908	3920	
Lime	3920	3937	
Arbuckle	3937	3976	
Lime & Arbuckle	3976	4010	
RTD		4010	