

Give All Information Completely
Make Required Affidavit
Mail or Deliver Report to:
Conservation Division
State Corporation Commission
2 1/2 No. Market
Wichita, Kansas

WELL PLUGGING RECORD

Pawnee County, Sec. 29 Twp. 20S Rge. 20W ~~(E)~~ ~~(W)~~

Location as "NE/CNW/SW" or footage from lines 660' FN&WL

Lease Owner Anadarko Production Co.-Diamond Shamrock Corporation

Lease Name Saxton "A" Well No. 1

Office Address Box 351, Liberal, Kansas 67901

Character of Well (completed as Oil, Gas or Dry Hole) Dry Hole

Date well completed 1-9 19 75

Application for plugging filed Verbal approval 1-8 19 75

Application for plugging approved 1-8 19 75

Plugging commenced 1-9 19 75

Plugging completed 1-9 19 75

Reason for abandonment of well or producing formation Dry Hole

If a producing well is abandoned, date of last production 19

Was permission obtained from the Conservation Division or its agents before plugging was commenced? Yes

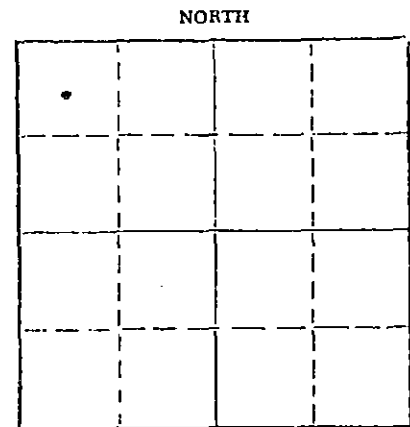

Locate well correctly on above Section Plat

Name of Conservation Agent who supervised plugging of this well Leo Massey

Producing formation _____ Depth to top _____ Bottom _____ Total Depth of Well 4350 Feet

Show depth and thickness of all water, oil and gas formations.

OIL, GAS OR WATER RECORDS

CASING RECORD

FORMATION	CONTENT	FROM	TO	SIZE	PUT IN	PULLED OUT
				9-5/8"	321	None

Describe in detail the manner in which the well was plugged, indicating where the mud fluid was placed and the method or methods used in introducing it into the hole. If cement or other plugs were used, state the character of same and depth placed, from _____ feet to _____ feet for each plug set.

Spotted 50 sacks cement @ 500', 25 sacks @ 240', 10 sacks 40'-0'.

RECEIVED
STATE CORPORATION COMMISSION

JAN 29 1975

CONSERVATION DIVISION
Wichita, Kansas

(If additional description is necessary, use BACK of this sheet)

Name of Plugging Contractor Gabbert-Jones, Inc.

Address 830 Sutton Place, Wichita, Kansas 67202

STATE OF Kansas, COUNTY OF Seward, ss.

T. W. Williams (employee of owner) of the above-described well, being first duly sworn on oath, says: That I have knowledge of the facts, statements, and matters herein contained and the log of the above-described well as filed and that the same are true and correct. So help me God.

(Signature) T. W. Williams, Division Office Supervisor
Box 351, Liberal, Kansas 67901
(Address)

SUBSCRIBED AND SWORN TO before me this 27th day of January, 19 75

My commission expires

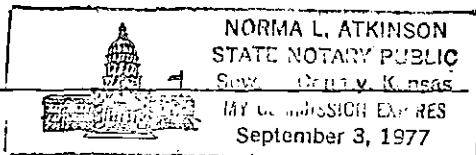

Norma L. Atkinson
Notary Public.

KANSAS DRILLERS LOG

S. 29 T. 20 R. 20 ^R/_W

API No. 15 — 145 — 20,357 · 0000
 County Number

Loc. NW NW

County Pawnee

Operator
Anadarko Production Co. = Diamond Shamrock Corporation

Address
Box 351 Liberal, Kansas

Well No. # 1 Lease Name Saxton "A"

Footage Location
660 feet from (N) (S) line 660 feet from (E) (W) line

Principal Contractor Gabbert-Jones, Inc. Geologist

Spud Date 12-27-74 Total Depth 4350' P.B.T.D.

Date Completed 1-9-75 Oil Purchaser

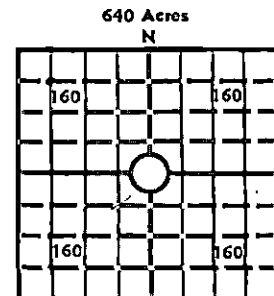

Elev.: Gr. 2161'

DF _____ KB _____

CASING RECORD

Report of all strings set — surface, intermediate, production, etc.

Purpose of string	Size hole drilled	Size casing set (in O.D.)	Weight lbs/ft.	Setting depth	Type cement	Sacks	Type and percent additives
Surface	12-1/4"	9-5/8"		321'	Common	500	3% HA-5

LINER RECORD

PERFORATION RECORD

Top, ft.	Bottom, ft.	Sacks cement	Shots per ft.	Size & type	Depth interval

TUBING RECORD

Size	Setting depth	Packer set at

ACID, FRACTURE, SHOT, CEMENT SQUEEZE RECORD

Amount and kind of material used	Depth interval treated
	RECEIVED STATE CORPORATION COMMISSION JAN 29 1975 CONSERVATION DIVISION Wichita, Kansas

INITIAL PRODUCTION

Date of first production	Producing method (flowing, pumping, gas lift, etc.)				
RATE OF PRODUCTION PER 24 HOURS	Oil	Gas	Water	Gas-oil ratio	
	bbls.	MCF	bbls.	CFPB	
Disposition of gas (vented, used on lease or sold)			Producing interval (s)		

INSTRUCTIONS: As provided in KCC Rule 82-2-125, within 90 days after completion of a well, one completed copy of this Drillers Log shall be transmitted to the State Geological Survey of Kansas, 4150 Monroe Street, Wichita, Kansas 67209. Copies of this form are available from the Conservation Division, State Corporation Commission, 3830 So. Meridian (P.O. Box 17027), Wichita, Kansas 66217. Phone AC 316-522-2206. If confidential custody is desired, please note Rule 82-2-125. Drillers Logs will be on open file in the Oil and Gas Division, State Geological Survey of Kansas, Lawrence, Kansas 66044.

Operator
Anadarko Production Company-Diamond Shamrock Corporation

DESIGNATE TYPE OF COMP.: OIL, GAS,
DRY HOLE, SWDW, ETC.:

Well No. 1
Lease Name Saxton "A"

Dry Hole

S 29 T 20S R 20 E
W

WELL LOG

Show all important zones of porosity and contents thereof; cored intervals, and all drill-stem tests, including depth interval tested, cushion used, time tool open, flowing and shut-in pressures, and recoveries.

SHOW GEOLOGICAL MARKERS, LOGS RUN,
OR OTHER DESCRIPTIVE INFORMATION.

FORMATION DESCRIPTION, CONTENTS, ETC.	TOP	BOTTOM	NAME	DEPTH
Surface	0	95		
Shale	95	337		
Redbed-Shale	337	675		
Shale	675	770		
Sand	770	970		
Shale	970	1347		
Anhydrite	1347	1372		
Shale	1372	1943		
Shale-Lime	1943	2350		
Lime-Shale	2350	2620		
Shale-Lime	2620	2910		
Lime-Shale	2910	3245		
Shale-Lime	3245	3345		
Lime-Shale	3345	3490		
Lime	3490	3575		
Lime-Shale	3575	3700		
Shale-Lime	3700	3795		
Lime	3795	4315		
Lime-Miss	4315	4318		
Lime	4318	4350		
Total Depth		4350		

USE ADDITIONAL SHEETS, IF NECESSARY, TO COMPLETE WELL RECORD.

Date Received

T. W. Williams
T. W. Williams

Signature

Division Office Supervisor

Title

January 27, 1975

Date

S. 29 T. 20 R. 20
 C. NW NW

API No. 15 — 145 — 20,357
 County Number

County Pawnee

Operator Anadarko Production Co. =Diamond Shamrock Corporation

Address Box 351 Liberal, Kansas

Well No. #1 Lease Name Saxton "A"

Footage Location 660 feet from (N) (S) line 660 feet from (E) (W) line

Principal Contractor Gabbert-Jones, Inc.

Geologist

Spud Date 12-27-74

Total Depth 4350'

P.S.T.D.

Date Completed 1-9-75

Oil Purchaser

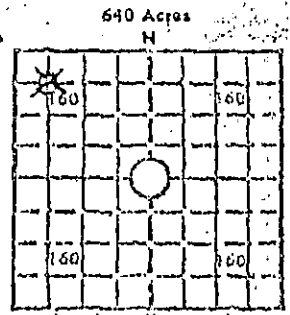

Elev.: Gr. 2161'

DF KB

CASING RECORD

Report of all strings set — surface, intermediate, production, etc.

Purpose of string	Size hole drilled	Size casing set (in O.D.)	Weight lbs/ft.	Setting depth	Type cement	Sacks	Type and percent additives
Surface	12-1/4"	9-5/8"		321'	Common	500	3% HA-5

LINER RECORD

PERFORATION RECORD

Top, ft.	Bottom, ft.	Sacks cement	Shots per ft.	Size & type	Depth interval

TUBING RECORD

ANADARKO PROD. CO. #1 SAXTON "A" 29-20-20W
 BOX 351 LIBERAL, KS. C NW NW
 CONTR. GABBERT-JONES, INC. CTY. PAWNEE
 GEOL. ED DONNELLY FIELD STEFFEN
 # 2159 KB CHG 12/27/74 CARD ISSUED 1/16/75 IP D&A/MISS 1/9/75
 API 15-145-20,357

LOG	TOPS	DEPTH	DATUM
ANH		1337	+ 822
CHASE		2261	- 102
TOP		3321	-1162
HEEL		3679	-1520
TOP		3699	-1540
LANS		3729	-1570
FT. SC		4232	-2073
CHER SH		4248	-2089
MISS		4301	-2142
LTD		4343	-2184
RTO		4350	-2191

9-5/8" 321
 DST (1) 4278-4315/30-45-30-45, 30' OCM, SIP 1069-997#, FP 36-45#, 45-54#
 DST (2) 4308-4318/PKR FAILED
 DST (3) 4308-18/TIMES NOT GIVEN, REC 30' M (NS), SIP NOT VALID, FP NA
 DST (4) 4277-4321/30-45-60-75, REC 3' CO, 75' SOCM, SIP 1051-1087#, FP 45-54#, 55-80#

Depth interval treated	Gas-oil ratio	CFR

INDEPENDENT OIL & GAS SERVICE
 WICHITA, KANSAS

Updated copy of this Drillers Log shall be transmitted to the Conservation Commission, Lawrence, Kansas, if confidential customer information is included.

C-10-197

"OWWO"
 CO: Winona Oil & Gas Co.
 Well: #1 Saxton
 Card Issued: 3-17-77
 IP: P 25 BOPD + WTR
 MISS 4319-25
 New Info: Mirt -co to 4350 & set 4 1/2"
 4350/100sx, pf 4319-25, ac 500,
 swb 4 1/2 BOPD (70% wtr) / 2 hrs, POP

Operator Anadarko Production Company-Diamond Shamrock Corporation	DESIGNATE TYPE OF COMP. OIL, GAS, DRY HOLE, SWD/W, ETC.
Well No. 1	Lease Name Saxton "A"
Dry Hole	
s 29 T 20S R 20 E W	

WELL LOG			SHOW GEOLOGICAL MARKERS, LOGS RUN, OR OTHER DESCRIPTIVE INFORMATION.	
FORMATION DESCRIPTION, CONTENTS, ETC.	TOP	BOTTOM	NAME	DEPTH
Surface	0	95		
Shale	95	337		
Redbed-Shale	337	675		
Shale	675	770		
Sand	770	970		
Shale	970	1347		
Anhydrite	1347	1372		
Shale	1372	1943		
Shale-Lime	1943	2350		
Lime-Shale	2350	2620		
Shale-Lime	2620	2910		
Lime-Shale	2910	3245		
Shale-Lime	3245	3345		
Lime-Shale	3345	3490		
Lime	3490	3575		
Lime-Shale	3575	3700		
Shale-Lime	3700	3795		
Lime	3795	4315		
Lime-Miss	4315	4318		
Lime	4318	4350		
Total Depth		4350		

USE ADDITIONAL SHEETS, IF NECESSARY, TO COMPLETE WELL RECORD.

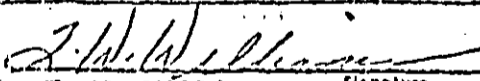
Date Received	<div style="text-align: right;">  T. W. Williams Signature Division Office Supervisor Title January 27, 1975 Date </div>
---------------	--