

FOR KCC USE:

EFFECTIVE DATE: 11-17-92  
DISTRICT # 1  
SSAT... Yes  No

State of Kansas  
NOTICE OF INTENTION TO DRILL

FORM C-1 7/91  
FORM MUST BE TYPED  
FORM MUST BE SIGNED  
ALL BLANKS MUST BE FILLED

Brenham Quad 7.5

Expected Spud Date: November 15, 1992  
month day year

Spot 80'E & 80'S of  
✓ NW SE Sec 18 Twp 28 S Rg 17 East West

OPERATOR: License # 6926 ✓  
Name: ADVANTAGE RESOURCES, INC.  
Address: 1775 Sherman Street - Suite 1375  
City/State/Zip: Denver, Colorado 80203-4316  
Contact Person: Lou Bortz  
Phone: 303/831-1912

✓ 1900 feet from South / North line of Section  
✓ 1900 feet from East / West line of Section  
IS SECTION  REGULAR  IRREGULAR

(NOTE: Locate well on the Section Plat on Reverse Side)

CONTRACTOR: License # 5929 ✓  
Name: DUKE DRILLING CO., INC.

County: Kiowa  
Lease Name: Parnell Well #: #2  
Field Name: Unknown Hardy

Is this a Prorated/Spaced Field? yes  no   
Target Formation(s): Mississippi

Well Drilled For: Well Class: Type Equipment:  
X. Oil ✓ Enh Rec .X Infield X. Mud Rotary  
Gas Storage Pool Ext. Air Rotary  
OWMO Disposal Wildcat Cable  
Seismic: # of Holes Other

Nearest lease or unit boundary: 80' ✓  
Ground Surface Elevation: 2198' est. top of 7.5 min. 80' NSL

Water well within one-quarter mile: yes  no   
Public water supply well within one mile: yes  no

If OWMO: old well information as follows:  
Operator:  
Well Name:  
Comp. Date: Old Total Depth

Depth to bottom of fresh water: 155  
Depth to bottom of usable water: 360'

Surface Pipe by Alternate: X. 1 2  
Length of Surface Pipe Planned to be set: 480

Length of Conductor pipe required: N/A  
Projected Total Depth: 4900

Formation at Total Depth: Mississippi  
Water Source for Drilling Operations:

... well ... farm pond  other

Directional, Deviated or Horizontal wellbore? yes  no   
If yes, true vertical depth:  
Bottom Hole Location:

DWR Permit #:  
Will Cores Be Taken? yes  no

If yes, proposed zone:

AFFIDAVIT

The undersigned hereby affirms that the drilling, completion and eventual plugging of this well will comply with K.S.A. 55-101, et. seq.  
It is agreed that the following minimum requirements will be met:

1. Notify the appropriate district office prior to spudding of well;
2. A copy of the approved notice of intent to drill shall be posted on each drilling rig;
3. The minimum amount of surface pipe as specified below shall be set by circulating cement to the top; in all cases surface pipe shall be set through all unconsolidated materials plus a minimum of 20 feet into the underlying formation;
4. If the well is dry hole, an agreement between the operator and the district office on plug length and placement is necessary prior to plugging;
5. The appropriate district office will be notified before well is either plugged or production casing is cemented in;
6. IF AN ALTERNATE II COMPLETION, PRODUCTION PIPE SHALL BE CEMENTED FROM BELOW ANY USABLE WATER TO SURFACE WITHIN 120 DAYS OF SPUD DATE. IN ALL CASES, NOTIFY DISTRICT OFFICE PRIOR TO ANY CEMENTING.

I hereby certify that the statements made herein are true and to the best of my knowledge and belief.  
Date: 11/10/92 Signature of Operator or Agent: [Signature] Title: Agent

FOR KCC USE:  
API # 15- 097-21,340-0000  
Conductor pipe required None feet  
Minimum surface pipe required 386' feet per Alt. ① X  
Approved by: CB 11-12-92

---

This authorization expires: 4-12-93  
(This authorization void if drilling not started within 6 months of effective date.)  
Spud date: Agent:

RECEIVED  
KANSAS CORPORATION COMMISSION  
NOV 10 1992  
CONSERVATION DIVISION  
WICHITA, KS  
18 28 17

REMEMBER TO:

- File Drill Pit Application (form CDP-1) with Intent to Drill;
- File Completion Form ACO-1 within 120 days of spud date;
- File acreage attribution plat according to field proration orders;
- Notify appropriate district office 48 hours prior to workover or re-entry;
- Submit plugging report (CP-4) after plugging is completed;
- Obtain written approval before disposing or injecting salt water.

Mail to: Conservation Division, 200 Colorado Derby Building, 202 W. First St., Wichita, Kansas 67202-1286.

IN ALL CASES PLOT THE INTENDED WELL ON THE PLAT BELOW

**PLAT OF ACREAGE ATTRIBUTABLE TO A WELL IN A PRORATED OR SPACED FIELD**

If the intended well is in a prorated or spaced field, please fully complete this side of the form. If the intended well is in a prorated or spaced field complete the plat below showing that the well will be properly located in relationship to other wells producing from the common source of supply. Please show all the wells within 1 mile of the boundaries of the proposed acreage attribution unit for gas wells and within 1/2 mile of the boundaries of the proposed acreage attribution unit for oil wells.

API NO. 15- \_\_\_\_\_  
 OPERATOR \_\_\_\_\_  
 LEASE \_\_\_\_\_  
 WELL NUMBER \_\_\_\_\_  
 FIELD \_\_\_\_\_

LOCATION OF WELL: COUNTY \_\_\_\_\_  
 \_\_\_\_\_ feet from south/north line of section  
 \_\_\_\_\_ feet from east/west line of section  
 SECTION \_\_\_\_\_ TWP \_\_\_\_\_ RG \_\_\_\_\_

NUMBER OF ACRES ATTRIBUTABLE TO WELL \_\_\_\_\_  
 QTR/QTR/QTR OF ACREAGE \_\_\_\_\_

IS SECTION \_\_\_\_\_ REGULAR or \_\_\_\_\_ IRREGULAR.  
IF SECTION IS IRREGULAR, LOCATE WELL FROM NEAREST CORNER BOUNDARY.

Section corner used: \_\_\_\_\_ NE \_\_\_\_\_ NW \_\_\_\_\_ SE \_\_\_\_\_ SW

**PLAT**

(Show location of the well and shade attributable acreage for prorated or spaced wells.)  
 (Show footage to the nearest lease or unit boundary line.)

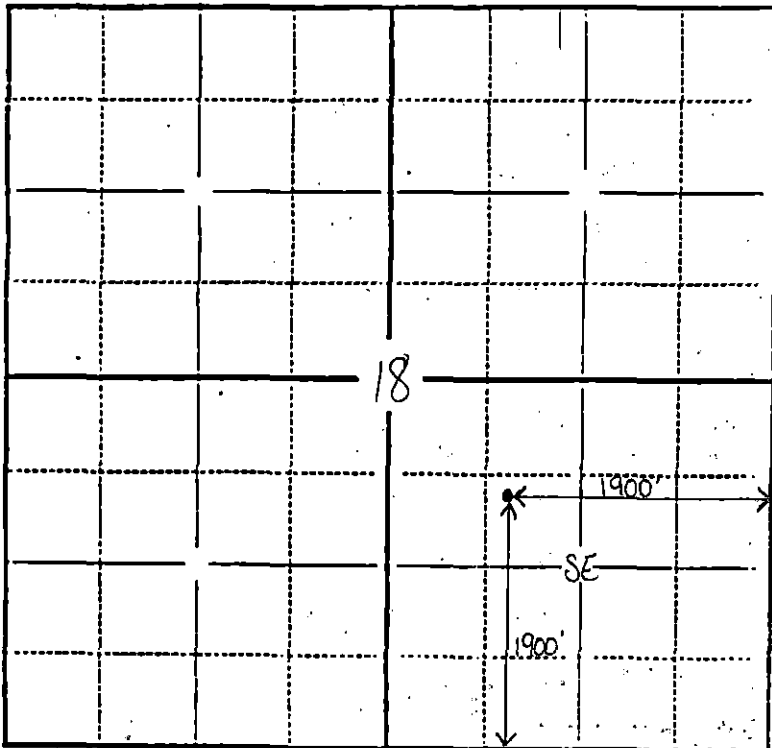

*Kiowa County*

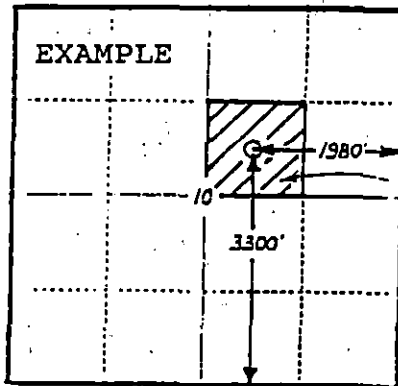

SEWARD CO.

In plotting the proposed location of the well, you must show:

- 1) The manner in which you are using the depicted plat by identifying section lines, i.e. 1 section, 1 section with 8 surrounding sections, 4 sections, etc.;
- 2) the distance of the proposed drilling location from the section's south/north and east/west lines; and
- 3) the distance to the nearest lease or unit boundary line.