

For KCC Use: 9-29-2001
 Effective Date: _____
 District # _____
 SGA? Yes No

KANSAS CORPORATION COMMISSION
 OIL & GAS CONSERVATION DIVISION
NOTICE OF INTENT TO DRILL

Form C-1
 September 1999
 Form must be Typed
 Form must be Signed
 All blanks must be Filled

Must be approved by KCC five (5) days prior to commencing well

Expected Spud Date OCTOBER 1 2001
month day year

OPERATOR: License# 5004 ✓
 Name: VINCENT OIL CORPORATION
 Address: 125 N. MARKET, SUITE 1075
 City/State/Zip: WICHITA, KANSAS 67202
 Contact Person: RICK HIEBSCH
 Phone: 316-262-3573

CONTRACTOR: License# 4958 ✓
 Name: MALLARD J.V., INC.

Well Drilled For:	Well Class:	Type Equipment:
<input type="checkbox"/> Oil	<input type="checkbox"/> Enh Rec	<input type="checkbox"/> Infield
<input checked="" type="checkbox"/> Gas	<input type="checkbox"/> Storage	<input checked="" type="checkbox"/> Mud Rotary
<input type="checkbox"/> OWWO	<input type="checkbox"/> Disposal	<input type="checkbox"/> Air Rotary
<input type="checkbox"/> Seismic; # of Holes _____	<input checked="" type="checkbox"/> Wildcat	<input type="checkbox"/> Cable
<input type="checkbox"/> Other _____	<input type="checkbox"/> Other _____	

If OWWO: old well information as follows:

Operator: _____
 Well Name: _____
 Original Completion Date: _____ Original Total Depth: _____
 Directional, Deviated or Horizontal wellbore? Yes No
 If Yes, true vertical depth: _____
 Bottom Hole Location: _____
 KCC DKT #: _____

Spot _____ East
 _____ West
C NE Sec. 30 Twp. 28 S. R. 17
 _____ feet from S / N (circle one) Line of Section
 _____ feet from E / W (circle one) Line of Section
 Is SECTION Regular Irregular?

(Note: Locate well on the Section Plat on reverse slide)

County: KIOWA
 Lease Name: CULLINS Well #: 1-30
 Field Name: WILDCAT

Is this a Prorated / Spaced Field? Yes No
 Target Formation(s): MISSISSIPPIAN
 Nearest Lease or unit boundary: 1320

Ground Surface Elevation: 2229 feet MSL

Water well within one-quarter mile: Yes No

Public water supply well within one mile: Yes No

Depth to bottom of fresh water: 250 FT ~ 200'

Depth to bottom of usable water: 250 FT.

Surface Pipe by Alternate: X 1 2

Length of Surface Pipe Planned to be set: 410 FT.

Length of Conductor Pipe required: N/A

Projected Total Depth: 4950 FT.

Formation at Total Depth: MISSISSIPPIAN

Water Source for Drilling Operations:

Well _____ Farm Pond _____ Other unknown

DWR Permit #: _____

(Note: Apply for Permit with DWR)

Will Cores be taken? Yes No

If Yes, proposed zone: _____

AFFIDAVIT

The undersigned hereby affirms that the drilling, completion and eventual plugging of this well will comply with K.S.A. 55-101, et. seq.

It is agreed that the following minimum requirements will be met:

1. Notify the appropriate district office **prior** to spudding of well;
2. A copy of the approved notice of intent to drill **shall be** posted on each drilling rig;
3. The minimum amount of surface pipe as specified below **shall be set** by circulating cement to the top; in all cases surface pipe **shall be set** through all unconsolidated materials plus a minimum of 20 feet into the underlying formation.
4. If the well is dry hole, an agreement between the operator and the district office on plug length and placement is necessary **prior to plugging**;
5. The appropriate district office will be notified before well is either plugged or production casing is cemented in;
6. If an ALTERNATE II COMPLETION, production pipe shall be cemented from below any usable water to surface within **120 days** of spud date. **In all cases, NOTIFY district office** prior to any cementing.

I hereby certify that the statements made herein are true and to the best of my knowledge and belief.

Date: 9-20-2001 Signature of Operator or Agent: Richard H. Diebel Title: President

RECEIVED
 SEP 21 2001
 KCC WICHITA

For KCC Use ONLY

API # 15 - 097-21476-0000

Conductor pipe required NONE feet

Minimum surface pipe required 270' feet per Alt. (1) K

Approved by: JK 9-24-2001

This authorization expires: 3-24-2002
(This authorization void if drilling not started within 6 months of effective date.)

Spud date: _____ Agent: _____

Remember to:

- File Drill Pit Application (form CDP-1) with Intent to Drill;
- File Completion Form ACO-1 within 120 days of spud date;
- File acreage attribution plat according to field proration orders;
- Notify appropriate district office 48 hours prior to workover or re-entry;
- Submit plugging report (CP-4) after plugging is completed;
- Obtain written approval before disposing or injecting salt water.

30
 28
 17W

IN ALL CASES PLOT THE INTENDED WELL ON THE PLAT BELOW

Plat of acreage attributable to a well in a prorated or spaced field

If the intended well is in a prorated or spaced field, please fully complete this side of the form. If the intended well is in a prorated or spaced field complete the plat below showing that the well will be properly located in relationship to other wells producing from the common source of supply. Please show all the wells and within 1 mile of the boundaries of the proposed acreage attribution unit for gas wells and within 1/2 mile of the boundaries of the proposed acreage attribution unit for oil wells.

API No. 15 - _____
Operator: Vincent Oil Corporation
Lease: Cullins
Well Number: 1-30
Field: wildcat

Number of Acres attributable to well: _____
QTR / QTR / QTR of acreage: _____ - C - NE

Location of Well: County: Kiowa
_____ 1320 _____ feet from S / N (circle one) Line of Section
_____ 1320 _____ feet from E / W (circle one) Line of Section
Sec. 30 Twp. 28 S. R. 17 East West

Is Section Regular or _____ Irregular

If Section is Irregular, locate well from nearest corner boundary.
Section corner used: ___ NE ___ NW ___ SE ___ SW

PLAT

*(Show location of the well and shade attributable acreage for prorated or spaced wells.)
(Show footage to the nearest lease or unit boundary line.)*

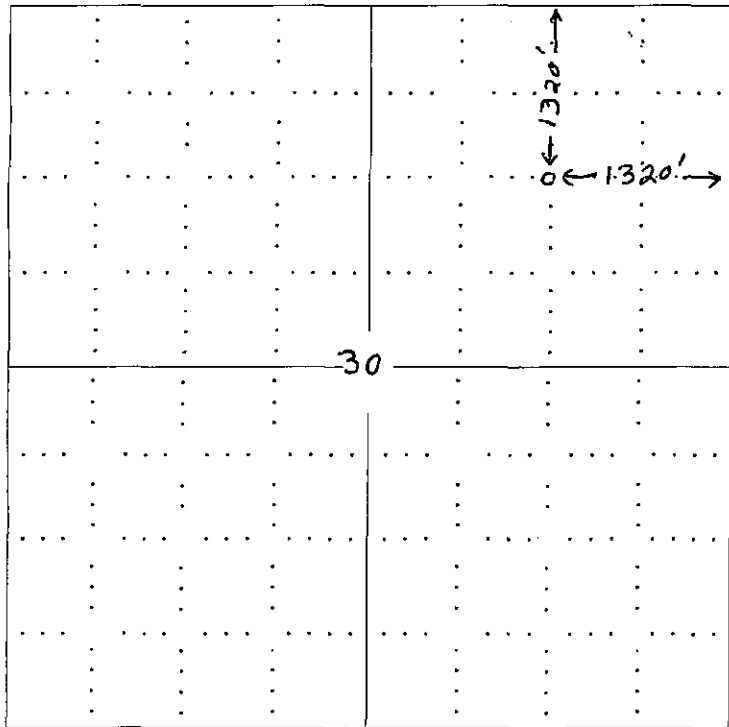

RECEIVED
SEP 21 2001
KCC WICHITA

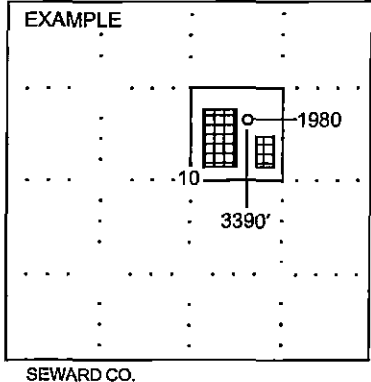

NOTE: in all cases locate the spot of the proposed drilling locaton.

In plotting the proposed location of the well, you must show:

1. The manner in which you are using the depicted plat by identifying section lines, i.e. 1 section, 1 section with 8 surrounding sections, 4 sections, etc.
2. The distance of the proposed drilling location from the section's south / north and east / west.
3. The distance to the nearest lease or unit boundary line.
4. If proposed location is located within a prorated or spaced field a certificate of acreage attribution plat must be attached: (C0-7 for oil wells; CG-8 for gas wells).