

SRM FORM MUST BE TYPED
FORM MUST BE SIGNED
ALL BLANKS MUST BE FILLED

EFFECTIVE DATE: 10-30-91

State of Kansas

DISTRICT # 1
SEAT Yes... No

NOTICE OF INTENTION TO DRILL

Must be approved by the K.C.C. five (5) days prior to commencing well

Expected Spud Date 11 15 91
month day year

Spot C NW SE Sec 3 Twp 28S S, Rg 19 East West

OPERATOR: License # 5118
Name: TGT Petroleum Corp.
Address: 209 E. William
City/State/Zip: Wichita, Ks. 67202
Contact Person: B. Lynn Herrington
Phone: 262-6489

1980 feet from South / West line of Section
1980 feet from East / West line of Section
IS SECTION X REGULAR IRREGULAR?

CONTRACTOR: License #: 5840
Name: Brandt Drilling

(NOTE: Locate well on the Section Plat on Reverse Side)
County: Kiowa
Lease Name: Wheeler Well #: 1
Field Name: Einsel
Is this a Prorated/Spaced Field? yes X no
Target Formation(s): Mississippi
Nearest lease or unit boundary: 660'
Ground Surface Elevation: NA feet MSL
Water well within one-quarter mile: yes X no
Public water supply well within one mile: yes X no
Depth to bottom of fresh water: 170'
Depth to bottom of usable water: 420'
Surface Pipe by Alternate: X 1 2
Length of Surface Pipe Planned to be set: 440' 440'
Length of Conductor pipe required: None
Projected Total Depth: 4850'
Formation at Total Depth: Mississippi
Water Source for Drilling Operations:
X well farm pond other

Well Drilled For: Well Class: Type Equipment:
X Oil ... Enh Rec ... Infield X Mud Rotary
X Gas ... Storage ... Pool Ext. ... Air Rotary
... OWWO ... Disposal X Wildcat ... Cable
... Seismic; ... # of Holes ... Other
If OWWO: old well information as follows:
Operator:
Well Name:
Comp. Date: Old Total Depth

Directional, Deviated or Horizontal wellbore? yes X no
If yes, true vertical depth:
Bottom Hole Location:

AFETDAVIT

*440' of surface pipe required

The undersigned hereby affirms that the drilling, completion and eventual plugging of this well will comply with K.S.A. 55-101, et. seq.
It is agreed that the following minimum requirements will be met:

- 1. Notify the appropriate district office prior to spudding of well;
- 2. A copy of the approved notice of intent to drill shall be posted on each drilling rig;
- 3. The minimum amount of surface pipe as specified below shall be set by circulating cement to the top; in all cases surface pipe shall be set through all unconsolidated materials plus a minimum of 20 feet into the underlying formation;
- 4. If the well is dry hole, an agreement between the operator and the district office on plug length and placement is necessary prior to plugging;
- 5. The appropriate district office will be notified before well is either plugged or production casing is cemented in;
- 6. IF AN ALTERNATE II COMPLETION, PRODUCTION PIPE SHALL BE CEMENTED FROM BELOW ANY USABLE WATER TO SURFACE WITHIN 120 DAYS OF SPUD DATE. IN ALL CASES, NOTIFY DISTRICT OFFICE PRIOR TO ANY CEMENTING.

I hereby certify that the statements made herein are true and to the best of my knowledge and belief.
Date: 9/27/91 Signature of Operator or Agent: B. Lynn Herrington Title: Ex. Vice-President

RECEIVED
STATE CORPORATION COMMISSION

SEP 30 1991

CONSERVATION DIVISION
Wichita, Kansas

FOR KCC USE:
API # 15- 097-21,321-0000
Conductor pipe required None feet
Minimum surface pipe required 440 feet per Alt. 0
Approved by: [Signature] 10-25-91
This authorization expires: 4-25-92
(This authorization void if drilling not started within 6 months of effective date.)
Spud date: Agent:

REMEMBER TO:

- File Drill Pit Application (form CDP-1) with Intent to Drill;
- File Completion Form ACO-1 within 120 days of spud date;
- File acreage attribution plat according to field proration orders;
- Notify appropriate district office 48 hours prior to workover or re-entry;
- Submit plugging report (CP-4) after plugging is completed;
- Obtain written approval before disposing or injecting salt water.

Mail to: Conservation Division, 200 Colorado Derby Building, 202 W. First St., Wichita, Kansas 67202-1286.

3
28
1991

IN ALL CASES PLOT THE INTENDED WELL ON THE PLAT BELOW.

PLAT OF ACREAGE ATTRIBUTABLE TO A WELL IN A PRORATED OR SPACED FIELD

If the intended well is in a prorated or spaced field, please fully complete this side of the form. If the intended well is in a prorated or spaced field complete the plat below showing that the well will be properly located in relationship to other wells producing from the common source of supply. Please show all the wells within 1 mile of the boundaries of the proposed acreage attribution unit for gas wells and within 1/2 mile of the boundaries of the proposed acreage attribution unit for oil wells.

API NO. 15- _____
 OPERATOR TGT Petroleum Corp.
 LEASE Wheeler
 WELL NUMBER 1
 FIELD Einsel

LOCATION OF WELL: COUNTY Kiowa
 _____ feet from south/north line of section
1980
 _____ feet from east/west line of section
1980
 SECTION 3 TWP 28S RG 19W

NUMBER OF ACRES ATTRIBUTABLE TO WELL _____
 QTR/QTR/QTR OF ACREAGE NW - SE - _____

IS SECTION X REGULAR or _____ IRREGULAR
 IF SECTION IS IRREGULAR, LOCATE WELL FROM NEAREST
 CORNER BOUNDARY.

Section corner used: NE NW SE SW

PLAT

(Show location of the well and shade attributable acreage for prorated or spaced wells.)
 (Show footage to the nearest lease or unit boundary line.)

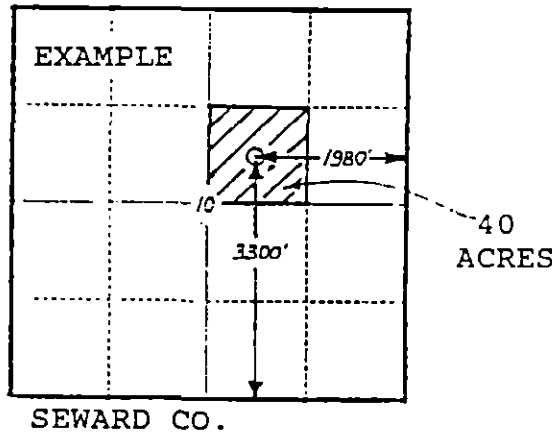
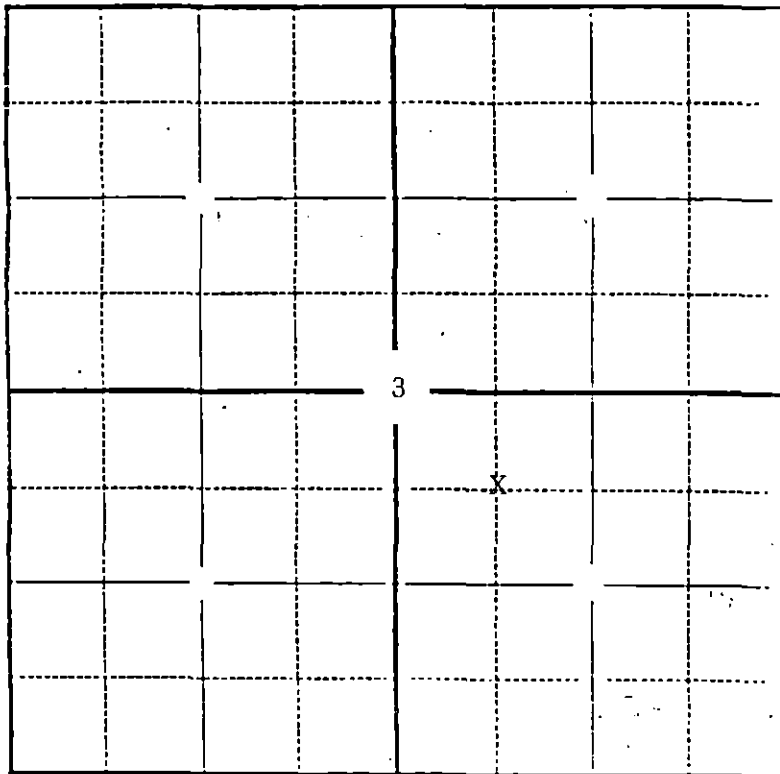

In plotting the proposed location of the well, you must show:

- 1) The manner in which you are using the depicted plat by identifying section lines, i.e. 1 section, 1 section with 8 surrounding sections, 4 sections, etc.;
- 2) the distance of the proposed drilling location from the section's south/north and east/west lines; and
- 3) the distance to the nearest lease or unit boundary line.