

Give All Information Completely
Make Required Affidavit
Mail or Deliver Report to:
Conservation Division
State Corporation Commission
800 Bittling Building
Wichita, Kansas

WELL PLUGGING RECORD

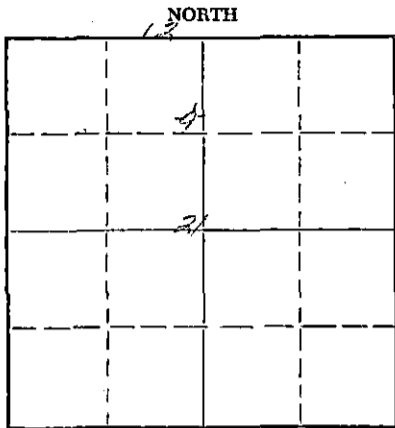

Locate well correctly on above Section Plat

Barton County, Sec. 21 Twp. 16S Rge. 12 (X) (W)
Location as "NE/CNW/SW" or footage from lines C SE NE NW
Lease Owner Kenton S. Stewart
Lease Name Stoskopf Well No. 1
Office Address 1041 North Water, Wichita, Kansas
Character of Well (completed as Oil, Gas or Dry Hole) Dry Hole
Date well completed February 22, 19 56
Application for plugging filed February 22, 19 56
Application for plugging approved February 22, 19 56
Plugging commenced February 23, 19 56
Plugging completed February 23, 19 56
Reason for abandonment of well or producing formation Dry

If a producing well is abandoned, date of last production None 19
Was permission obtained from the Conservation Division or its agents before plugging was commenced? Yes

Name of Conservation Agent who supervised plugging of this well C. D. Stough
Producing formation None Depth to top Bottom Total Depth of Well 3450 KB Feet
Show depth and thickness of all water, oil and gas formations.

OIL, GAS OR WATER RECORDS

CASING RECORD

FORMATION	CONTENT	FROM	TO	SIZE	PUT IN	PULLED OUT
				8 5/8	335	None

Describe in detail the manner in which the well was plugged, indicating where the mud fluid was placed and the method or methods used in introducing it into the hole. If cement or other plugs were used, state the character of same and depth placed, from feet to feet for each plug set.

Filled hole with heavy mud to 240 feet where bottom plug was set. 1/3 sack of hulls were placed on top of the plug and then cemented with 20 sacks regular cement. Filled hole with heavy mud to 40 feet where top plug was set. 1/3 sack of hulls placed on top this plug and cemented with 10 sacks cement. Cellar filled with top soil.

RECEIVED
STATE CORPORATION COMMISSION

3-5-56

(If additional description is necessary, use BACK of this sheet)

Name of Plugging Contractor Braden Drilling Co.
Address 814 Union National Bank Building, Wichita, Kansas

STATE OF Colorado, COUNTY OF Denver, ss.
Louis E. Potucek, Agent (employee of owner) or (owner or operator) of the above-described well, being first duly sworn on oath, says: That I have knowledge of the facts, statements, and the log of the above-described well as filed and that the same are true and correct. So help me God.

(Signature) Louis E. Potucek

360 Denver Club Building
(Address)

SUBSCRIBED AND SWORN TO before me this 2nd day of March, 19 56

Reuben M. Martin
Notary Public.

My commission expires July 15, 1959

PLUGGING
FILE SEC 21 T 16 R 12W
BOOK PAGE 41 LINE 18

Stoskopf #1

SE NE NW
21-16S-12W
Barton County, Kansas

Operator: John J. Darrah

Contractor: Braden Drilling Co.

Test Commenced: February 12, 1956

Test Completed: February 23, 1956

Casing Record: 8 5/8" casing set at 335' cemented with 175 sacks Pozmix cement and 2% C.C.

Clay & Sand	85
Shale & Shells	352
Sand	575
Sand, Shells, Shale	765
Shale & Shells	835
Anhydrite	870
Shale & Shells	935
Shale	1545
Shale & Shells	1830
lime & Shale	1980
Shale & Shells	2140
lime & Shale	2815
lime	3369
Sand & Iron	3376
lime	3397
lime & Sand	3401
Sand	3413
lime	3450 T. D.

RECEIVED
STATE CORP
COMMISSION
MAR 2 - 1956
CONSERVATION DIVISION
Wichita, Kansas

STATE OF COLORADO)
) ss.
COUNTY OF DENVER)

I hereby certify that the above information is true and correct as revealed by the records of the Braden Drilling Company.

Betty R. Sheffield

Subscribed and sworn to before me this 28th day of February, 1956.

Helin M. Martin
Notary Public

My Commission expires July 15, 1959.

PLUGGING
FILE SEC 21-16-12W
BOOK PAGE 41 LINE 18