

WELL PLUGGING RECORD

Give All Information Completely
Make Required Affidavit
Mail or Deliver Report to:
Conservation Division
State Corporation Commission
211 No. Broadway
Wichita, Kansas

Rice County. Sec. 2 Twp. 21S Rge. 8 (E) 8 (W)
Location as "NE/CNW&SW&S" or footage from lines NE/4 SW/4 SW/4
Lease Owner Skelly Oil Company
Lease Name Galen Gibson Well No. 1
Office Address Box 1650, Tulsa, Oklahoma
Character of Well (completed as Oil, Gas or Dry Hole) Dry Hole
Date well completed January 1, 19 58
Application for plugging filed January 2, 19 58
Application for plugging approved January 3, 19 58
Plugging commenced January 2, 19 58
Plugging completed January 2, 19 58
Reason for abandonment of well or producing formation Dry Hole

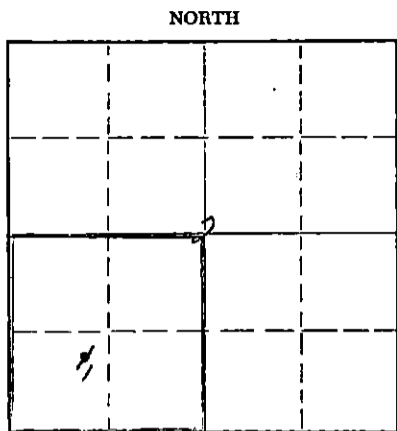

Locate well correctly on above Section Plat

If a producing well is abandoned, date of last production 19
Was permission obtained from the Conservation Division or its agents before plugging was commenced? Yes

Name of Conservation Agent who supervised plugging of this well Mr. J. Lewis Brock
Producing formation _____ Depth to top _____ Bottom _____ Total Depth of Well 3401 Feet
Show depth and thickness of all water, oil and gas formations.

OIL, GAS OR WATER RECORDS

CASING RECORD

FORMATION	CONTENT	FROM	TO	SIZE	PUT IN	PULLED OUT
Mississippi Lime	Dry	3311'	3401'	8-5/8"	277' 0"	None

Describe in detail the manner in which the well was plugged, indicating where the mud fluid was placed and the method or methods used in introducing it into the hole. If cement or other plugs were used, state the character of same and depth placed, from _____ feet to _____ feet for each plug set.

Heavy mud laden fluid 3401' to 250'
Rock bridge 250'
15 sacks of cement 250' to 204'
Mud laden fluid 204' to 15'
5 sacks of cement 15' to 5'
Surface soil 5' to 0'

RECEIVED
STATE CORPORATION COMMISSION
JAN 10 1959
DIVISION
amsas

(If additional description is necessary, use BACK of this sheet)
Name of Plugging Contractor Claude Wentworth Drlg. Co., Inc.
Address 2701 East 15th Street, Tulsa, Oklahoma

STATE OF Kansas, COUNTY OF Reno, ss.
H. E. Wamsley (employee of owner) of the above-described well, being first duly sworn on oath, says: That I have knowledge of the facts, statements, and matters herein contained and the log of the above-described well as filed and that the same are true and correct. So help me God.

(Signature) _____
Box 391, Hutchinson, Kansas
(Address)

SUBSCRIBED AND SWORN TO before me this 9th day of January, 19 58

Jessamine L. Johnson
Notary Public.

My commission expires April 7, 1959

PLUGGING
FIL SEC 2 T 21 R 8W
BOOK PAGE 73 LINE 25

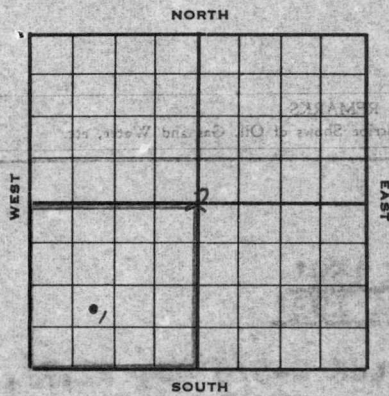

SKELLY OIL COMPANY

Well Record

Lease Name and No. Galen Gibson Well No. 1 Elev. 1640' GR
 Lease Description SW/4 Section 2-218-SW, Rice County,
Kansas (160 Acres)
 Location made December 9, 19 57 by H. V. Morse
 feet from North line _____ feet from East line SW/4
990 feet from South line 990 feet from West line } of Sec. 2

Work com'd 12/16 19 57 Rig comp'd 12/18 19 57 Drlg. com'd 12/18 19 57 Drlg. comp'd 1/1 19 58

Rig Contractor Claude Wentworth Drilling Co., Inc.

Drilling Contractor Claude Wentworth Drilling Co., Inc.

Rotary Drilling from 0' to 3401' Cable Tool Drilling from _____ to _____

Commenced Producing DRY HOLE 19 _____ Initial Prod. before shot or acid _____ Bbls.
 Initial Prod. after shot or acid _____ Bbls.

Dry Gas Well Press _____ Volume _____ Cu. ft.

Casing Head Gas Pressure _____ Volume _____ Cu. ft.

Braden Head (_____ Size) Gas Pressure _____ Volume _____ Cu. ft.

Braden Head (_____ Size) Gas Pressure _____ Volume _____ Cu. ft.

PRODUCING FORMATION DRY HOLE (Name) Top _____ Bottom _____ TOTAL DEPTH 3401'

CASING RECORD

OD Size	Wt.	Thds.	Where Set	PULLED OUT			LEFT IN			KIND	Cond'n	Sacks Used	CEMENTING Method Employed
				Jts.	Feet	In.	Jts.	Feet	In.				
<u>8-5/8"</u>	<u>22.75</u>	<u>284'</u>					<u>8</u>	<u>277</u>	<u>0</u>	<u>Araco 5 1/2 A</u>		<u>250</u>	<u>Halliburton</u>
<u>(8-5/8" casing set 2' in collar)</u>													

Liner Set at _____ Length _____ Perforated at _____

Liner Set at _____ Length _____ Perforated at _____

Packer Set at _____ Size and Kind _____

Packer Set at _____ Size and Kind _____

RECEIVED
 STATE CORPORATION COMMISSION
 JAN 10 1958
 CONSERVATION DIVISION
 Topeka, Kansas

SHOT OR ACID TREATMENT RECORD

Date	FIRST		SECOND		THIRD		FOURTH	
	Size Shot	Gals. Qts.	Size Shot	Gals. Qts.	Size Shot	Gals. Qts.	Size Shot	Gals. Qts.

SIGNIFICANT GEOLOGICAL FORMATIONS

NAME	Top	Bottom	GAS		OIL		REMARKS
			From	To	From	To	
<u>TOPEKA LIMB</u>	<u>2441'</u>						PLUGGING SEC 2 T 21 R 8W BOOK PAGE 73 LINE 25
<u>Heebner Shale</u>	<u>2748'</u>						
<u>Lansing Lime</u>	<u>2922'</u>						
<u>Mississippi Ln.</u>	<u>3311'</u>						

CLEANING OUT RECORDS

	DATE COMMENCED	DATE COMPLETED	PROD. BEFORE	PROD. AFTER	REMARKS
1st					See Reverse for other details.
2nd					" " " " "
3rd					" " " " "
4th					" " " " "

PLUGGING BACK AND DEEPENING RECORDS

	Date Commenced	Date Completed	No. Feet Plugged Back or Deepened	Prod. Before	Prod. After	REMARKS
1st						See Reverse for other details.
2nd						" " " " "
3rd						" " " " "
4th						" " " " "

(See Reverse for Record of Formation)

RECORD OF FORMATIONS

FORMATION	TOP	BOTTOM	REMARKS
Surface soil, clay and sand	0	100	
Sand and gravel	100	125	
Red bed	125	190	TOP ANHYDRITE 159'
Sand	190	200	BASE ANHYDRITE 192'
Red bed and shale	200	270	
Anhydrite	270	320	Set and cemented 4-5/8" ID, 22.75' inner 3.00", S.J. steel casing (A cond.) at 284' with 250 sacks of Pozzix cement. Cement circulated. Finished cementing at 8:30 p.m. 12/18/57.
Shale and shells	320	1120	TOP HALLIBURTON 708'
Shale and lime	1120	2660	TOP HALLIBURTON 1146'
Lime	2660	2754	TOP HALLIBURTON 2441'
Shale and lime	2754	2792	TOP HALLIBURTON 2748'
Shale, lime and shells	2792	2934	TOP HALLIBURTON 2893'
Lime and shale	2934	3015	TOP HALLIBURTON 2922'
Lime	3015	3298	BASE KANSAS CITY LINE 3234'
Cream to light gray crystalline lime	3298	3305	

FORMATION	TOP	BOTTOM	REMARKS
Very grayish colored chert to porous weathered chert	3305	3320	Scattered light chert, trace of poor porosity, no shows. Ran Halliburton drill stem test No. 1, packer set at 3285', used 20' anchor, open 1 hour, weak blow for 20 minutes, recovered 10' drilling mud, LFP-0, FFP-0, BHP-0 after 30 mins. TOP MISSISSIPPI LINE 3311'
Vari-colored chert with opaque chert	3320	3338	Spotted light stain with fragments of weathered chert, spots of free oil in wet sample. Ran Halliburton drill stem test #2, packer set at 3304', used 16' anchor, open 1 hour, weak blow, then quit, pulled tester and found tool plugged, no recovery.
Chert and lime	3338	3362	Scattered dark residue. Ran Halliburton drill stem test No. 3, packer set at 3297', used 41' anchor, open 1 hour, weak blow throughout test, recovered 68' drilling mud, LFP-15, FFP-35, BHP-100 in 30 mins. No shows
Shale, lime and chert	3362	3401	No shows. Ran Schlumberger survey
TOTAL DEPTH 3401'			

Since no oil or gas in commercial quantities was encountered in drilling to the total depth of 3401', regular authority was granted to plug and abandon the well.

The well was plugged as follows:

DESCRIPTION	DEPTH
Heavy mud laden fluid	3401' to 250'
Rock bridge	250'
15 sacks of cement	250' to 204'
Mud laden fluid	204' to 15'
5 sacks of cement	15' to 5'
Surface soil	5' to 0'

Plugged and abandoned January 2, 1958.

SLOPE TEST DATA: 250', 1/4 degree; 500', 1/2 degree; 750', 1/2 degree; 1000', 1/2 degree; 1250', 1/2 degree; 1500', 1/2 degree; 1750', 1/2 degree; 2000', 1/2 degree; 2250', 1/2 degree; 2500', 1/2 degree; 2750', 1/2 degree; 3000', 1/2 degree; 3250', 1/2 degree.

DATE	DEPTH	REMARKS