

STATE CORPORATION COMMISSION OF KANSAS  
OIL & GAS CONSERVATION DIVISION  
WELL COMPLETION OR RECOMPLETION FORM  
ACO-1 WELL HISTORY  
DESCRIPTION OF WELL AND LEASE

API NO. 15-185-22.428:0000  
County... Stafford  
100' N OF  
W/2 W/2. SE. Sec. 13. Twp. 21. Rge. 12. East  
X West

Operator: License # 6039  
Name L.D. Drilling, Inc.  
Address Route 1, Box 183-B  
City/State/Zip Great Bend, KS 67530

1420... Ft North from Southeast Corner of Section  
2310... Ft West from Southeast Corner of Section  
(Note: Locate well in section plat below)

Purchaser

Lease Name Kasselman  
Field Name Sandago West

Operator Contact Person L.D. Davis  
Phone 316-793-3051

Producing Formation  
Elevation: Ground 1816 KB 1821

Contractor: License # 5929  
Name Duke Drilling Co., Inc.

Wellsite Geologist Kim Shoemaker  
Phone (316) 682-1537

Designate Type of Completion  
X New Well Re-Entry Workover  
Oil SWD Temp Abd  
Gas Inj Delayed Comp.  
X Dry Other (Core, Water Supply etc.)

If OWNG: old well info as follows:  
Operator  
Well Name  
Comp. Date Old Total Depth

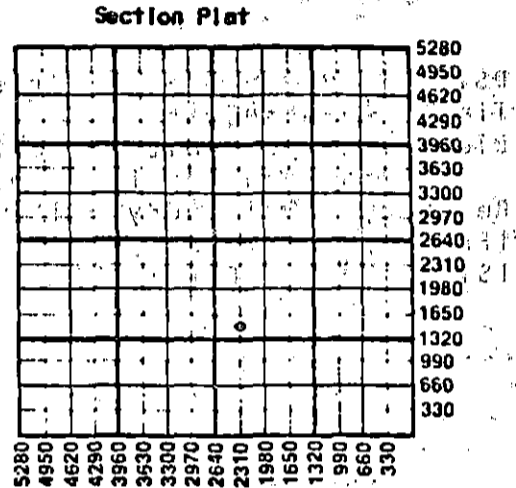

WATER SUPPLY INFORMATION  
Disposition of Produced Water: Disposal  
Docket # Repressuring

WELL HISTORY  
Drilling Method:  
X Mud Rotary Air Rotary Cable

4-2-87 Spud Date  
4-6-87 Date Reached TD  
4-6-87 Completion Date  
3532' Total Depth PBTD

Amount of Surface Pipe Set and Cemented at 300 feet  
Multiple Stage Cementing Collar Used? Yes No  
If yes, show depth set feet  
If alternate 2 completion, cement circulated from feet depth to w/ SX cmt  
Cement Company Name  
Invoice #

Questions on this portion of the ACO-1 call:  
Water Resources Board (913) 296-3717  
Source of Water:  
Division of Water Resources Permit # T-87-80  
X Groundwater 1980... Ft North from Southeast Corner  
(Well) 2640... Ft West from Southeast Corner of  
Sec 13 Twp 21 Rge 12 East X West  
Surface Water... Ft North from Southeast Corner  
(Stream, pond etc)... Ft West from Southeast Corner  
Sec Twp Rge East West  
Other (explain) (purchased from city, R.W.D. #)

INSTRUCTIONS: This form shall be completed in triplicate and filed with the Kansas Corporation Commission, 200 Colorado Derby Building, Wichita, Kansas 67202, within 120 days of the spud date of any well. Rule 82-3-130, 82-3-107 and 82-3-106 apply. Information on side two of this form will be held confidential for a period of 12 months if requested in writing and submitted with the form. See rule 82-3-107 for confidentiality in excess of 12 months. One copy of all wireline logs and drillers time log shall be attached with this form. Submit CP-4 form with all plugged wells. Submit CP-111 form with all temporarily abandoned wells.

All requirements of the statutes, rules and regulations promulgated to regulate the oil and gas industry have been fully complied with and the statements herein are complete and correct to the best of my knowledge.

Signature L.D. Davis  
Title President Date 4-20-87

Subscribed and sworn to before me this 20th day of April 1987  
Notary Public Bessie M. Dewerff  
Date Commission Expires 5-20-89

K.C.C. OFFICE USE ONLY  
F Letter of Confidentiality Attached  
C Wireline Log Received  
C Drillers Time Log Received  
Distribution  
KCC SWD/Rep NGPA  
KGS Plug Other  
RECEIVED  
STATE CORPORATION COMMISSION



4-27-87 APR 27 1987

Sec 13, Twp 21, Rge 12

SIDE TWO

Operator Name L.D. Drilling, Inc. Lease Name Kasselman Well # 4

Sec. 13 Twp. 21 Rge. 12  East  West County Stafford

WELL LOG

INSTRUCTIONS: Show important tops and base of formations penetrated. Detail all cores. Report all drill stem tests giving interval tested, time tool open and closed, flowing and shut-in pressures, whether shut-in pressure reached static level, hydrostatic pressures, bottom hole temperature, fluid recovery, and flow rates if gas to surface during test. Attach extra sheet if more space is needed. Attach copy of log.

Drill Stem Tests Taken  Yes  No  
 Samples Sent to Geological Survey  Yes  No  
 Cores Taken  Yes  No

Formation Description  
 Log  Sample

DST # 1 3430-3525 Arbuckle  
 Times: 45-45-45-45  
 Blow: 1st open: blt to bb in 15 min.  
 2nd open: bb in 25 min.  
 Recovery: 660' Muddy salt water  
 IFP: 157-192 FFP: 333-353  
 ISIP: 888 FSIP: 785

Name	Top	Bottom
Anhy.	584	605
Heebner	3059	(-1238)
Toronto	3078	(-1257)
Douglas	3089	(-1268)
Brn Lime	3182	(-1361)
Lans K/C	3207	(-1386)
Base K/C	3437	(-1616)
Cong.	3460	(-1639)
Arbuckle	3520	(-1699)
R.T.D.	3532	(-1711)

CASING RECORD <input checked="" type="checkbox"/> New <input type="checkbox"/> Used							
Report all strings set-conductor, surface, intermediate, production, etc.							
Purpose of String	Size Hole Drilled	Size Casing Set (In O.D.)	Weight Lbs/Ft.	Setting Depth	Type of Cement	#Sacks Used	Type and Percent Additives
Surface	12 1/2"	8-5/8"	20#	300'	50/50 poz	190	2% gel 3% ca
PERFORATION RECORD				Acid, Fracture, Shot, Cement Squeeze Record			
Shots Per Foot	Specify Footage of Each Interval Perforated			Depth			Depth
TUBING RECORD				Liner Run <input type="checkbox"/> Yes <input type="checkbox"/> No			
Size	Set At	Packer at					
Date of First Production	Producing Method <input type="checkbox"/> Flowing <input type="checkbox"/> Pumping <input type="checkbox"/> Gas Lift <input type="checkbox"/> Other (explain).....						
Estimated Production Per 24 Hours	Oil	Gas	Water	Gas-Oil Ratio	Gravity		
	Bbls	MCF	Bbls	CFPB			

METHOD OF COMPLETION

Production Interval

Disposition of gas:  Vented  Open Hole  Perforation  
 Sold  Other (Specify) .....  
 Used on Lease  Dually Completed  
 Commingled

