

Give All Information Completely
Make Required Affidavit
Mail or Deliver Report to:
Conservation Division
State Corporation Commission
211 No. Broadway
Wichita, Kansas

WELL PLUGGING RECORD

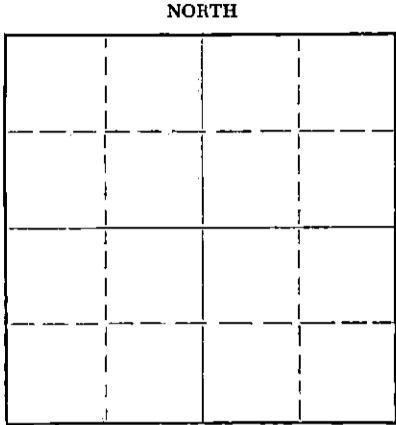

Locate well correctly on above
Section Plat

Rice County, Kans. County. Sec. 14 Twp. 21 Rge. 7 (E) (W)
Location as "NE/CNW%SW%" or footage from lines SW/NE/NE
Lease Owner Jones, Shelburne & Farmer
Lease Name Willis Well No. #1
Office Address Russell, Kansas
Character of Well (completed as Oil, Gas or Dry Hole) _____
Date well completed _____ 19____
Application for plugging filed Yes 19____
Application for plugging approved Yes 19____
Plugging commenced _____ 3-12 1957
Plugging completed _____ 3-16 1957
Reason for abandonment of well or producing formation _____

If a producing well is abandoned, date of last production _____ 19____
Was permission obtained from the Conservation Division or its agents before plugging was commenced? Yes

Name of Conservation Agent who supervised plugging of this well Mr. Ruel Durkee
Producing formation _____ Depth to top _____ Bottom _____ Total Depth of Well 3381' Feet
Show depth and thickness of all water, oil and gas formations.

OIL, GAS OR WATER RECORDS

CASING RECORD

FORMATION	CONTENT	FROM	TO	SIZE	PUT IN	PULLED OUT
				5 1/2"		2679'

Describe in detail the manner in which the well was plugged, indicating where the mud fluid was placed and the method or methods used in introducing it into the hole. If cement or other plugs were used, state the character of same and depth placed, from _____ feet to _____ feet for each plug set.

Measured into TD 3381'.
Plugging started 3-12-57. Finished 3-16-57.
Plugged off bottom with sand to 3360' and dumped 6 sacks cement with bailer.
Shot 5 1/2" casing at 2679'. Pulled pipe out of hole and plugged well with heavy mud to 220' and set permanent rock bridge. Dumped 15 sacks cement.
Filled hole with mud and mixed 5 sacks cement for cap on well.

(If additional description is necessary, use BACK of this sheet)
Name of Plugging Contractor J.O. Forbes d/b/a Forbes Casing Pulling Co.
Address Box 221, Great Bend, Kansas

STATE OF Kansas, COUNTY OF Barton, ss.
J.O. Forbes (employee of owner) or (owner or operator) of the above-described well, being first duly sworn on oath, says: That I have knowledge of the facts, statements, and matters herein contained and the log of the above-described well as filed and that the same are true and correct. So help me God.

(Signature) J.O. Forbes
Box 221, Great Bend, Kansas
(Address)

SUBSCRIBED AND SWORN TO before me this 18th day of March, 1957.
My commission expires November 8, 1960.

Betty RECEIVED Notary Public.
STATE CORPORATION COMMISSION

PLUGGING
FILE SEC. 14 T. 21 R. 7W
BOOK PAGE 147 LINE 38

MAR 19 1957
CONSERVATION DIVISION
Wichita, Kansas

OPERATOR JONES, SHELBURNE & FARMER, INC.ADDRESS RUSSELL, KANSAS

15.159.03433.0000

FORMATION RECORD

Give detailed description and thickness of all formations drilled through, contents of sand, whether dry, water, oil or gas.

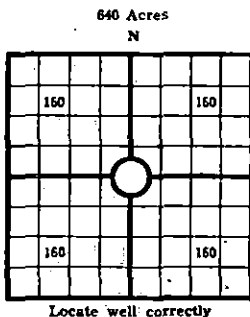
WELL NO. 1 COUNTY RICE SEC. 14 TWP. 21 RGE. 7W
FARM NAME WILLIS

COUNTY Rice SEC. 14 TWP. 21 RGE. 7W
 COMPANY OPERATING Jones, Shelburne & Farmer, Inc.
 OFFICE ADDRESS Russell, Kansas
 FARM NAME WILLIS WELL NO. #1
 DRILLING STARTED 2/6, 1957 DRILLING FINISHED 2/17, 1957
 DATE OF FIRST PRODUCTION _____ COMPLETED _____
 WELL LOCATED SW 1/4 NE 1/4 NE 1/4, North of South
 Line and _____ ft. East of West Line of Quarter Section
 Elevation (Relative to sea level) DERRICK FLOOR 1598 GROUND 1593
 CHARACTER OF WELL (Oil, gas or dryhole) Oil

OIL OR GAS SANDS OR ZONES

Name	From	To	Name	From	To
1			4		
2			5		
3			6		

Perforating Record If Any

Shot Record

Formation	From	To	No. of Shots	Formation	From	To	Size of Shot

CASING RECORD

Amount Set						Amount Pulled		Packer Record			
Size	Wt.	Thds.	Make	Ft.	In.	Ft.	In.	Size	Length	Depth Set	Make
8-5/8				236							

Liner Record: Amount _____ Kind _____ Top _____ Bottom _____

CEMENTING AND MUDDING

Size	Amount Set		Sacks Cement	Chemical		Method of Cementing	Amount	Mudding Method	Results (See Note)
	Ft.	In.		Gal.	Make				
8-5/8	236		175						
5-1/2	3367		75						

Note: What method was used to protect sands if outer strings were pulled? _____

NOTE: Were bottom hole plugs used? _____ If so, state kind, depth set and results obtained _____

TOOLS USED

Rotary Tools were used from _____ feet to _____ Cable tools were used from _____ feet to _____

_____ feet, and from _____ feet to _____ feet, and from _____ feet to _____

Type Rig _____

INITIAL PRODUCTION TEST

Describe initial test: whether by flow through tubing or casing or by pumping _____

Amount of Oil Production _____ bbls. Size of choke, if any _____ Length of test _____ Water

Production _____ bbls. Gravity of oil _____ Type of Pump if pump is used, describe _____

Formation	Top	Bottom	Formation	Top	Bottom
Clay	0	18			
Sand	18	60			
Shale & clay	60	200			
Shale	200	450			
Shale & salt	450	960			
Shale & lime	960	1350			
Shale & lime	1350	2300			
Lime & shale	2300	2495			
Shale & lime	2495	2575			
Lime & shale	2575	2685			
Shale & sand	2685	2785			
Sandy Lime & shale	2785	2865			
Lime & shale	2865	3368			
T.D.		3368			

RECEIVED
CORPORATION COMMISSION
MAR 16 1957 LUGGING
CONSERVATION FILE SEC. 14 T. 21 R. 7W
WICHITA, KANSAS PAGE 147 LINE 38

SAMPLE TOPS:

Elevation: RB	1600
Heebner	2675
Toronto	2690
Douglas shale	2701
Douglas sand	2721
Lansing <u>2895</u>	
B/Kansas City	3240
Conglomerate	3366
T.D.	3368
5-1/2" set at with 75 sacks.	3367

I, the undersigned, being first duly sworn upon oath, state that this well record is true, correct and complete according to the records of this office and to the best of my knowledge and belief.

John W. Farmer Vice-President
Name and title of representative of company

Subscribed and sworn to before me this 19th day of February, 1957My Commission expires 10/11/58

Notary Public