

**WELL PLUGGING RECORD**

Give All Information Completely  
Make Required Affidavit  
Mail or Deliver Report to:  
Conservation Division  
State Corporation Commission  
211 No. Broadway  
Wichita, Kansas

Stafford County. Sec. 28 Twp. 21S Rge. (E) 14 (W) 14  
Location as "NE/CNW/SW" or footage from lines SE/4 SE/4 NW/4  
Lease Owner Skelly Oil Company  
Lease Name Eva Smith Well No. 3  
Office Address Box 1650, Tulsa, Oklahoma  
Character of Well (completed as Oil, Gas or Dry Hole) Dry Hole  
Date well completed June 5, 19 58  
Application for plugging filed June 6, 19 58  
Application for plugging approved June 9, 19 58  
Plugging commenced June 6, 19 58  
Plugging completed June 6, 19 58  
Reason for abandonment of well or producing formation Dry Hole

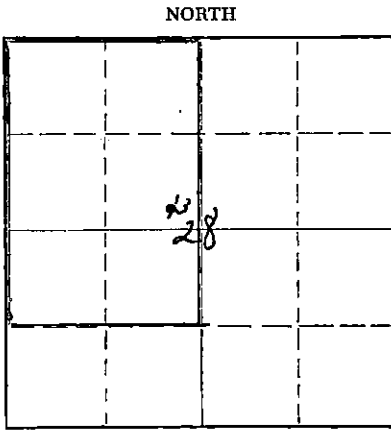

Locate well correctly on above Section Plat

If a producing well is abandoned, date of last production \_\_\_\_\_ 19\_\_\_\_  
Was permission obtained from the Conservation Division or its agents before plugging was commenced? Yes

Name of Conservation Agent who supervised plugging of this well Mr. Frank Broadfoot  
Producing formation \_\_\_\_\_ Depth to top \_\_\_\_\_ Bottom \_\_\_\_\_ Total Depth of Well 3870 Feet  
Show depth and thickness of all water, oil and gas formations.

**OIL, GAS OR WATER RECORDS**

**CASING RECORD**

FORMATION	CONTENT	FROM	TO	SIZE	PUT IN	PULLED OUT
Arbuckle Lime	Dry	3833'	3870'	8-5/8"	857'0"	None

Describe in detail the manner in which the well was plugged, indicating where the mud fluid was placed and the method or methods used in introducing it into the hole. If cement or other plugs were used, state the character of same and depth placed, from \_\_\_\_\_ feet to \_\_\_\_\_ feet for each plug set.

Mud laden fluid 3870' to 240'  
Bridging plug 240'  
20 sacks of cement 240' to 170'  
Mud laden fluid 170' to 40'  
Bridging plug 40'  
10 sacks of cement 40' to 6'  
Rock and surface soil 6' to 0'

RECEIVED  
STATE CORPORATION COMMISSION  
JUN 24 1958  
CONSERVATION DIVISION  
Wichita, Kansas

6-24-58

(If additional description is necessary, use BACK of this sheet)  
Name of Plugging Contractor Claude Wentworth Drlg. Co., Inc.  
Address 2701 East 15th, Tulsa, Oklahoma

STATE OF Kansas, COUNTY OF Reno, ss.  
H. E. Wamsley (employee of owner) owner or operator of the above-described well, being first duly sworn on oath, says: That I have knowledge of the facts, statements, and matters herein contained and the log of the above-described well as filed and that the same are true and correct. So help me God.

(Signature) \_\_\_\_\_  
Box 391, Hutchinson, Kansas  
(Address)

SUBSCRIBED AND SWORN to before me this 23rd day of June, 19 58

My commission expires April 7, 1959

Josephine L. Johnson  
Notary Public.

PLUGGING  
FILE SEC 28 Twp. 21 R. 14 W  
BOOK PAGE 106 LINE 9

# SKELLY OIL COMPANY

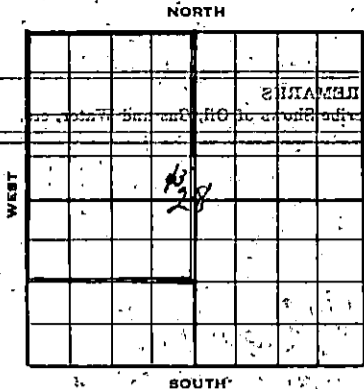

**Well Record**

Lease Name and No. Kva Smith Well No. 3 Elev. 1940' Gr.

Lease Description NW/4 and N/2 SW/4 Sec. 28-218-14W,

Stafford County, Kans. (240 Acres)

Location made May 14, 1958 by H. V. Morse

330 feet from North line 330 feet from East line

330 feet from South line 330 feet from West line of Sec. 28

Work com'd 5/23 19 58 Rig com'd 5/24 19 58 Drlg. com'd 5/24 19 58 Drlg. comp'd 6/5 19 58

Rig Contractor Claude Wentworth Dril. Co., Inc.

Drilling Contractor Claude Wentworth Dril. Co., Inc., Tulsa, Okla.

Rotary Drilling from 0' to 3870' Cable Tool Drilling from \_\_\_\_\_ to \_\_\_\_\_

Commenced Producing DRY HOLE 19 \_\_\_\_\_ Initial Prod. before shot or acid \_\_\_\_\_ Bbls.

Initial Prod. after shot or acid \_\_\_\_\_ Bbls.

Dry Gas Well Press. \_\_\_\_\_ Volume \_\_\_\_\_ Cu. ft.

Casing Head Gas Pressure \_\_\_\_\_ Volume \_\_\_\_\_ Cu. ft.

Braden Head ( \_\_\_\_\_ Size ) Gas Pressure \_\_\_\_\_ Volume \_\_\_\_\_ Cu. ft.

Braden Head ( \_\_\_\_\_ Size ) Gas Pressure \_\_\_\_\_ Volume \_\_\_\_\_ Cu. ft.

PRODUCING FORMATION DRY HOLE (Name) Top \_\_\_\_\_ Bottom \_\_\_\_\_ TOTAL DEPTH 3870'

### CASING RECORD

O.D. Size	Wt.	Thds.	Where Set	PULLED OUT			LEFT IN			KIND	Cond'n	CEMENTING	
				Jts.	Feet.	In.	Jts.	Feet.	In.			Sacks Used	Method Employed
<u>8-5/8"</u>	<u>22.75</u>	<u>1</u>	<u>264'</u>				<u>27</u>	<u>857</u>	<u>0</u>	<u>Araco 51</u>	<u>A</u>	<u>662</u>	<u>Halliburton</u>

Liner Set at \_\_\_\_\_ Length \_\_\_\_\_ Perforated at \_\_\_\_\_

Liner Set at \_\_\_\_\_ Length \_\_\_\_\_ Perforated at \_\_\_\_\_

Packer Set at \_\_\_\_\_ Size and Kind \_\_\_\_\_

Packer Set at \_\_\_\_\_ Size and Kind \_\_\_\_\_

### SHOT OR ACID TREATMENT RECORD

Date	FIRST		SECOND		THIRD		FOURTH	
	Gals. Qts.	Size Shot	Gals. Qts.	Size Shot	Gals. Qts.	Size Shot	Gals. Qts.	Size Shot

### SIGNIFICANT GEOLOGICAL FORMATIONS

NAME	Top	Bottom	GAS		OIL		REMARKS
			From	To	From	To	
<u>Near Topeka</u>	<u>2930'</u>						
<u>Hoebner Shale</u>	<u>3100'</u>						
<u>Toronto Lias</u>	<u>3324'</u>						
<u>Douglas Sand</u>	<u>3344'</u>						
<u>Lansing Lias</u>	<u>3430'</u>						
<u>Conglomerate</u>	<u>3702'</u>						
<u>Viola Lias</u>	<u>3729'</u>						
<u>Simpson Sand</u>	<u>3810'</u>						
<u>Arbuckle Lias</u>	<u>3833'</u>						

### CLEANING OUT RECORDS

	DATE COMMENCED	DATE COMPLETED	PROD. BEFORE	PROD. AFTER	REMARKS
1st					See Reverse for other details.
2nd					" " " " "
3rd					" " " " "
4th					" " " " "

### PLUGGING BACK AND DEEPENING RECORDS

	Date Commenced	Date Completed	No. Feet Plugged Back or Deepened	Prod. Before	Prod. After	REMARKS
1st						See Reverse for other details.
2nd						" " " " "
3rd						" " " " "
4th						" " " " "

(See Reverse for Record of Formation)

RECORD OF FORMATIONS

FORMATION	TOP	BOTTOM	REMARKS
			Indicate Casing Points, Describe Shows of Oil, Gas and Water, etc.
Surface soil and sand	0	242	
Sand and gravel	242	420	
Red bed, sand and shale	420	545	
Shale, shells and anhydrite	545	875	TOP ANHYDRITE 850' Set and cemented 3-5/8" ID, 22.7%, Amco S.W., S.J. steel casing (a cond.) at 364' with 62 sacks of Pozzic cement. Cement circulated. Finished cementing at 12:00 noon 5/26/52.
Red bed and shale	854	1105	BASE ANHYDRITE 876'
Shale and shells	1105	1650	TOP WELLSBORO 1344' BASE WELLSBORO 1321' TOP TARKIO 2721' NEAR WELLSBORO 2930'
Lime and shale	1650	3489	TOP WELLSBORO SHALE 3300' TOP TARKIO LIME 3324' TOP DOUGLAS SAND 3344' TOP BROWN LIME 3420' TOP LANSING LIME 3430'
Lime	3489	3554	
Green, finely crystalline lime	3554	3559	Good oolitic porosity, no shows
Lime	3559	3598	
Green to light gray lime	3598	3601	Fair to good oolitic, slightly vuggy porosity with scattered stain and scattered free oil in wet samples.
Lime	3601	3607	Ran Halliburton drill stem test No. 1, packer set at 3583', used 24" anchor, open 1 hour, weak blow for 7 mins., recovered 10' of drilling mud, IFF-15, FFP-15, FHP-115 in 20 minutes.
Lime and shale	3607	3739	BASE KANSAS CITY LIME 3673' TOP CONGLOMERATE 3702' TOP VIOLA LIME 3729'
White, fresh opaque to aripolitic chert	3739	3770	Scattered porosity, scattered light to black stain, spots of free oil in wet sample. Ran Halliburton drill stem test No. 2, packer set at 3717', used 53" anchor, open 1 hour, very weak blow, dead in 5 mins., recovered 12' of drilling mud and 1/2 gallon of free oil, IFF-25, IFF-05, FFP-05, FHP-15 in 20 mins.
Lime, shale and chert	3770	3812	TOP SIMPSON SHALE 3786' TOP SIMPSON SAND 3810'
White to light gray, medium, sub-rounded dolomitic sand clusters	3812	3814	Trace of very faint poor porosity
Sand	3814	3817	
White to light gray medium, sub-rounded dolomitic sand clusters	3817	3820	
Sand and dolomite	3820	3835	Ran Halliburton drill stem test No. 3, packer set at 3810', used 25" anchor, open 1 hour, good blow diminishing to weak blow, recovered 600' of salt water, IFF-600, IFF-20, FFP-270, FHP-590 in 20 mins.
Lime and sand	3835	3844	TOP ARBUCKLE LIME 3833'
Green to buff, fine to medium crystalline dolomite	3844	3846	Oolitic to slightly vuggy porosity, no shows.
Dolomite	3846	3849	
Buff to light gray, medium coarsely crystalline dolomite	3849	3852	Inter-crystalline porosity, no shows
Dolomite	3852	3870	Ran Halliburton drill stem test, packer set at 3834', used 38" anchor, open 1 hour, fair blow for 30 mins., recovered 340' of muddy salt water, IFF-1260, IFF-40, FFP-205, FHP-1115 in 20 minutes.

TOTAL DEPTH 3870'

Ran Welox Gamma Ray Neutron Survey

Since neither oil nor gas were found in commercial quantities in drilling to the total depth of 3870', regular authority was granted to plug and abandon the well.

On June 6, the well was plugged as follows:

Mud laden fluid	3870' to 240'
Bridging plug	240'
20 sacks of cement	240' to 170'
Mud laden fluid	170' to 40'
Bridging plug	40'
10 sacks of cement	40' to 6'
Rock and surface soil	6' to 0'

Plugged and abandoned June 6, 1958

SLOPE TEST DATA: Tests were taken at 250', 550', 1110', 1450', 1770', 2050', 2350', 2600', 2710', 3275', and 3665' with no deviation from vertical noted.

RECEIVED  
 JUN 24 1958  
 STATE CORPORATION COMMISSION

RECEIVED  
STATE CORPORATION COMMISSION

JUN 24 1958

CONSERVATION DIVISION  
Wichita, Kansas

PLUGGING  
FILE SEC. 20 T. 21 R. 14 W  
BOOK PAGE 106 LINE 9