

WELL PLUGGING RECORD

Give All Information Completely  
Make Required Affidavit  
Mail or Deliver Report to:  
Conservation Division  
State Corporation Commission  
211 No. Broadway  
Wichita, Kansas

KINGMAN County. Sec. 16 Twp. 30S Rge. 9 (X) (W)

Location as "NE/CNW/SW" or footage from lines. SW SE SE  
Lease Owner PETROLEUM, INC.  
Lease Name SWINGLE "I" Well No. 1  
Office Address R.R. #2, GREAT BEND, KANSAS  
Character of Well (completed as Oil, Gas or Dry Hole) DRY HOLE  
Date well completed NOVEMBER 8 19 65  
Application for plugging filed NOVEMBER 8, 19 65  
Application for plugging approved NOVEMBER 8, 19 65  
Plugging commenced NOVEMBER 8, 19 65  
Plugging completed NOVEMBER 8, 19 65  
Reason for abandonment of well or producing formation NO PRODUCIBLE ZONE

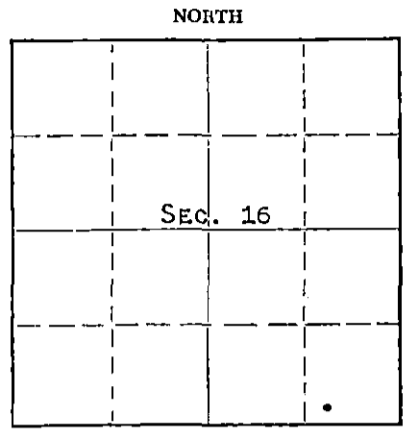

Locate well correctly on above Section Plat

If a producing well is abandoned, date of last production NONE 19  
Was permission obtained from the Conservation Division or its agents before plugging was commenced? YES

Name of Conservation Agent who supervised plugging of this well ARCHIE ELVING  
Producing formation \_\_\_\_\_ Depth to top \_\_\_\_\_ Bottom \_\_\_\_\_ Total Depth of Well 4365' Feet  
Show depth and thickness of all water, oil and gas formations.

OIL, GAS OR WATER RECORDS				CASING RECORD		
FORMATION	CONTENT	FROM	TO	SIZE	PUT IN	PULLED OUT
				8-5/8"	207'	NONE

Describe in detail the manner in which the well was plugged, indicating where the mud fluid was placed and the method or methods used in introducing it into the hole. If cement or other plugs were used, state the character of same and depth placed, from \_\_\_\_\_ feet to \_\_\_\_\_ feet for each plug set.

MUDDED UP WITH HEAVY DRILLING MUD TO 200', FOLLOWED BY WOODEN PLUG, PLACED 1/3 SACKS HULLS AND 25 SACKS CEMENT ON TOP OF PLUG. MUDDED UP WITH HEAVY DRILLING MUD TO 40', FOLLOWED BY WOODEN PLUG, PLACED 1/3 SACK HULLS AND 10 SACKS CEMENT ON TOP OF PLUG TO BASE OF WELL CELLAR.

RECEIVED  
STATE CORPORATION COMMISSION  
NOV 15 1965  
CONSERVATION DIVISION  
Wichita, Kansas

(If additional description is necessary, use BACK of this sheet)  
Name of Plugging Contractor GARVEY DRILLING Co.  
Address R.R. #2, GREAT BEND, KANSAS

STATE OF KANSAS, COUNTY OF BARTON, ss.  
MONTE CHADD (employee of owner) or (owner) of the above-described well, being first duly sworn on oath, says: That I have knowledge of the facts, statements, and matters herein contained and the log of the above-described well as filed and that the same are true and correct. So help me God. MONTE CHADD, DIST. PROD. SUPT.  
(Signature) *Monte Chadd*

SUBSCRIBED AND SWORN TO before me this 12 day of NOVEMBER, 19 65

(Address)  
*Richard N. Duncanson*  
Notary Public.

My commission expires MAY 28, 1969

# WELL LOG IS. 095, 30120.00.00

COMPANY **Petroleum, Inc.**

SEC. 16 T. 30S R. 9W

FARM **Swingle**

NO. "I" #1

LOC. SW SE SE

TOTAL DEPTH **4365'**

COUNTY **Kingman**

COMM. **10-27-65**

COMP. **11-8-65**

CONTRACTOR **Garvey Drilling Company**

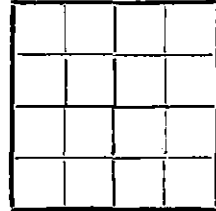

CASING **8 5/8" @ 207' w/200 sx**

ELEVATION **1676' KB**

PRODUCTION **D & A**

FIGURES INDICATE BOTTOM OF FORMATIONS

130' Sand and Red Bed  
 410' Shale  
 1350' Red Bed and Shale  
 1660' Shale and Shells  
 1925' Shale  
 2098' Lime and Shale  
 2325' Shale and Lime  
 3290' Lime and Shale  
 3515' Shale and Lime  
 3635' Shale and Lime Streaks  
 3705' Lime and Shale  
 4266' Lime  
 4315' Lime and Shale  
 4365' Lime  
 4365' RTD

**RECEIVED**  
STATE CORPORATION COMMISSION

**NOV 15 1965**

CONSERVATION DIVISION  
Topeka, Kansas

State of Kansas }  
County of Barton } 85

I, Sam N. Stephens of Garvey Drilling Company

upon oath state the above and foregoing is a true and correct copy of the log of the Swingle "I" #1 well.



Subscribed and sworn to before me this 11th day of November 19 65

My Commission Expires: May 28, 1969

  
NOTARY PUBLIC