

WELL PLUGGING RECORD

STATE OF KANSAS
STATE CORPORATION COMMISSION

Give All Information Completely
Make Required Affidavit
Mail or Deliver Report to:
Conservation Division
State Corporation Commission
800 Biting Building
Wichita, Kansas

~~FORMATION PLUGGING RECORD~~

Strike out upper line
when reporting plug-
ging off formations.

Rush County Sec. 6 Twp. 16S Rge. 18 (E) (W)
Location as "NE 1/4 NW 1/4 SW 1/4" or footage from lines SW 1/4 SW 1/4 SW 1/4
Lease Name Amelia Werth
Lease Owner H. H. & B. Drilling Co., Inc., et al Well No. 1
Office Address 705 Petroleum Bldg., Wichita, Kansas
Character of Well (completed as Oil, Gas or Dry Hole) Dry Hole
Date well completed November 25, 1946
Application for plugging filed November 25, 1946
Application for plugging approved November 25, 1:00 P.M., 1946
Plugging commenced November 25, 1946
Plugging completed November 25, 1946 at 7:00 P.M., 1946
Reason for abandonment of well or producing formation dry hole

If a producing well is abandoned, date of last production -- 19 --
Was permission obtained from the Conservation Division or its agents before plugging was com-
menced? yes

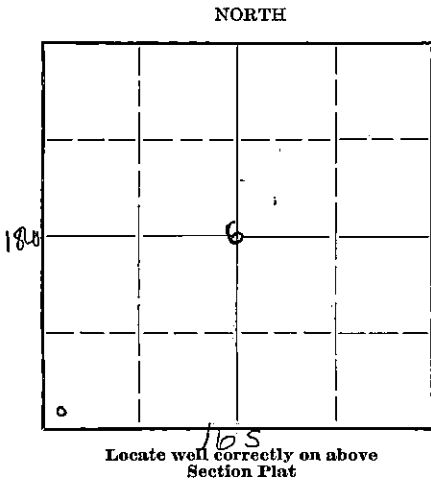

Name of Conservation Agent who supervised plugging of this well
Producing formation none Depth to top -- Bottom -- Total Depth of Well 3642 Feet
Show depth and thickness of all water, oil and gas formations.

OIL, GAS OR WATER RECORDS

CASING RECORD

Formation	Content	From	To	Size	Put In	Pulled Out
none				8-5/8" Surface	39 fts. or 1194'	none
				No oil string run		

Describe in detail the manner in which the well was plugged, indicating where the mud fluid was placed and the method or methods used in introducing it into the hold. If cement or other plugs were used, state the character of same and depth placed, from feet to feet for each plug set.

Filled hole with heavy mud to 300 feet; set bottom hole plug at 300 feet.
Put 15 sacks of cement on it; billed with heavy mud to 30 feet; set top
plug; put in 10 sacks of cement and filled to bottom of cellar.

6 16 18W
84 32

STATE OF KANSAS
COMMISSIONER
705 5-1946

(If additional description is necessary, use BACK of this sheet)

Correspondence regarding this well should be addressed to H. H. & B. Drilling Co., Inc.,
Address 705 Petroleum Bldg., Wichita 2, Kansas

STATE OF Kansas, COUNTY OF Sedgwick, ss:
Jack H. Heathman (an officer or operator) of the above-described well,
being first duly sworn on oath, says: That I have knowledge of the facts, statements, and matters herein contained and the log of the above-
described well as filed and that the same are true and correct. So help me God.

(Signature) Jack H. Heathman
705 Petroleum Bldg., Wichita, Kansas
(Address)

SUBSCRIBED AND SWORN to before me this 2nd day of December, 1946.

My commission expires July 2, 1949.

Richard Hindery
Notary Public.



WERTH WELL NO. 1

Location: G. SW $\frac{1}{2}$ SW $\frac{1}{2}$ SW $\frac{1}{2}$ Section 6-16S-18W
Rush County, Kansas

Owner: H H & B Drilling Co., Inc., et al

Contractor: H H & B Drilling Co., Inc.

Casing Records: Surface Casing - 39 Jts. or 1194' 8-5/8" 8 Rd. Thd. 32# @ 1202'
Cemented with 550 sacks bulk cement and 2 CG.
Oil String - none run
Abandoned - 11-25-45

Commenced: 11-10-45
Oil String Cemented: none run
Total Depth: 3642'

L O G

(Figures indicate bottom of formation)

Shaled lime	0 to 95	Lime and shale	2765
Shale	420	Lime and shale	2835
Sand	445	Lime and shale	2915
Sand, shale and shells	620	Lime and shale	2985
Sand and shale	860	Lime and shale	3010
Shale	950	Lime	3050
Red Rock	990	Lime	3105
Red Bed	1020	Lime and shale	3120
Shale	1120	Lime	3160
Red Bed	1195	Lime and shale	3240
Anhydrite	1194'	lime	3290
Anhydrite	1205	Lime and shale	3300
Anhydrite	1260	Lime	3325
Red Bed, shale and shells	1650	Lime	3360
Shale	1845	Lime	3405
Shale and shells	1955	Lime	3420
Shale and shells	2095	Lime	3450
Shale and shells	2220	Lime	3490
Lime and shale	2280	Lime	3505
Lime and shale	2335	Lime	3540
Lime	2380	Shale	3595
Lime and shale	2495	Top of Conglomerate	3595'
Lime and shale	2565	Shale	3610
Lime and shale	2655	Conglomerate	3620
Lime and shale	2710	Conglomerate sand	3626
		Lime	3640
		Quartzite	3642
Total Depth 3642'			

The undersigned, H H & B DRILLING CO., INC., hereby certifies that the above log is a true and correct log of the formations encountered in drilling the above noted well as reflected by the Daily Drilling Reports.

ATTEST:

H H & B DRILLING CO., INC.

BY: Jack H. Heathman
Vice-President

~~Asst. Secretary~~

STATE OF KANSAS

COUNTY OF SEDGWICK

SS: 6 16 18W
84 32

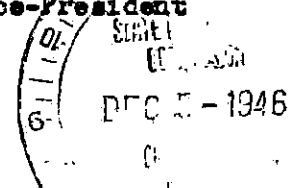

Be it remembered that on this 30th day of November, 1946, before me, the undersigned a Notary Public, duly commissioned, in and for the County and State aforesaid, came JACK H. HEATHMAN, Vice-President of H H & B DRILLING CO., INC., a corporation of the State of Kansas, known to me to be such officer, and to be the same person who executed as such officer the foregoing instrument of writing in behalf of said corporation, and he duly acknowledged the execution of the same for himself and for said corporation.

IN WITNESS WHEREOF, I have hereunto set my hand and official seal on the day and year first above written.

Richard Lindley
Notary Public

My commission expires July 2, 1949.

DRILLING TIME RECORD

H V & B DRILLING CO., INC., et al

SHR. NO. 58; Sec. 3-163-187

No. 1 WHITE

Elev: 2028 (Nelly Bushing)

<u>DEPTH</u>	<u>MINUTES</u>	<u>REMARKS</u>
--------------	----------------	----------------

(1' drilling time from 2000' to T.D.)

2900-2910	6-6-6-7-6-4-5-5-6-5	
2920	6-5-8-7-6-6-7-5-7-5	
2930	8-8-6-7-7-8-8-5-8-7	
2940	6-7-5-5-5-9-5-7-5-8	
2950	4-5-5-5-7-5-5-4-5-4	
2960	4-4-5-5-5-5-5-5-5-5	
2970	5-7-5-5-10-8-8-5-4-5	
2980	5-5-5-5-5-4-5-5-5-5	
2990	5-5-5-5-5-5-5-10-5-7	
3000-3010	6-7-5-5-5-9-10-8-7-8	
3010	6-8-5-9-5-5-5-5-8-10	
3020	10-9-10-7-5-7-5-7-7-7	
3030	7-7-4-3-4-4-4-5-7-7	
3040	7-9-8-7-5-7-5-7-4-4	
3050	3-2-1-1-2-2-1-2-4-7	
3060	6-9-5-7-10-9-11-10-7-9	
3070	6-9-10-7-9-11-12-9-10-10	
3080	10-10-5-5-5-5-5-4-4-4	
3090	5-5-11-5-4-5-10-9-9-9	
3090-3100	10-5-5-5-4-5-5-15-12-12	
3110	8-4-9-10-4-2-2-3-4-5	Trip at 3108'
3120	4-4-5-3-3-2-2-1-4-5	
3130	4-3-5-5-4-5-5-5-5-5	
3140	7-7-5-5-5-7-5-7-9-10	
3150	9-5-4-5-5-4-5-7-5-8	
3160	9-5-7-7-5-7-7-9-7-7	
3170	6-7-10-5-5-9-5-9-5-7	
3180	6-5-5-5-5-5-5-9-7-10	
3190	10-5-5-5-7-7-8-11-8-8	
3190-3200	6-5-5-4-3-4-3-3-4-4	
3210	4-6-9-7-6-6-5-4-5-5	
3220	5-5-7-7-5-4-4-2-4-5	
3230	8-7-5-5-5-5-4-5-6-4	
3240	4-5-5-5-4-2-3-4-3-3	
3250	5-2-2-5-4-5-4-5-5-5	
3260	5-5-5-7-5-5-5-5-5-11	
3270	12-11-9-9-5-7-10-9-11-12	
3280	14-15-12-12-5-5-3-14-10-13	
3290	14-7-9-11-10-15-12-11-12-12	
3290-3300	10-11-11-8-11-14-13-14-15-9	Trip at 3299'
3310	11-9-5-8-10-7-7-8-7-9	
3320	5-7-7-8-5-5-5-5-5-7	
3330	9-9-5-9-9-11-5-5-5-5	
3340	6-7-7-5-5-5-5-5-5-7	
3350	6-5-5-5-12-11-9-5-9-10	
3360	8-10-9-9-7-7-9-5-9-9	
3370	8-8-7-8-10-11-7-7-8-10	
3380	9-9-8-10-9-10-10-5-7-13	
3390	8-11-9-7-7-5-7-6-5-8	
3390-3400	10-10-15-15-16-16-4-2-4-4	
3410	14-9-13-15-10-13-12-13-7-8	
3420	7-8-9-13-5-4-3-5-14-14	
3430	15-14-20-11-16-14-12-10-14-15	

346

Page 2
Time Log
No. 1 Warch

3430-3440	16-12-14-16-18-8-7-7-7-7	Trip at 3436'
3450	6-8-8-7-5-8-7-10-8-8	
3460	8-7-9-11-10-10-10-12-10-11	
3470	11-12-12-12-13-14-17-20-14-22	
3480	16-11-10-13-10-14-10-8-11-8	
3490	11-7-9-8-10-12-11-11-11-10	
3490-3500	8-9-8-9-13-7-2-1-8-7	
3510	8-8-10-7-8-8-8-8-8-8	
3520	4-7-7-8-8-8-8-8-7-8	
3530	7-7-9-8-8-8-8-8-7-8	
3540	8-7-7-6-7-8-9-7-8-8	
3550	6-6-7-8-8-9-8-7-7-7	
3560	8-8-4-5-7-4-5-7-8-7	
3570	7-6-7-10-8-8-11-8-9-10	
3580	10-7-8-5-8-7-7-7-7-8	
3590	8-7-7-8-10-10-8-7-8-8	
3590-3600	7-8-7-13-14-15-8-9-11-10	
3610	12-8-8-4-4-5-8-8-8-8	
3620	8-8-2-2-2-3-9-8-8-8	
3630	1-2-1-1/2-1/2-1-1/2-2-8-8-8	
3640	5-9-7-7-10-13-20-20-20-21	
3642	20-20-	

